

PAGE 1/4	ISSUE 26-04-18A	SERIES DIVERS	PART NUMBER R299763000
----------	-----------------	----------------------	-------------------------------

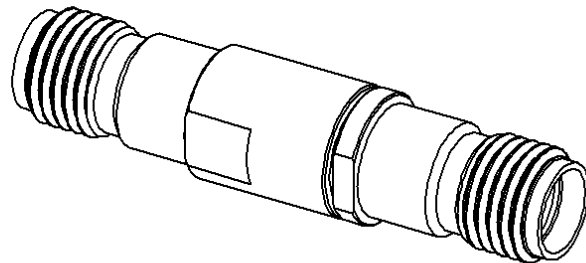

All dimensions are in mm. Tolerances according ISO 2768 m-H

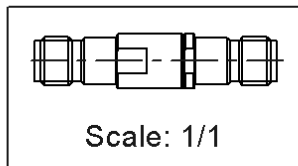
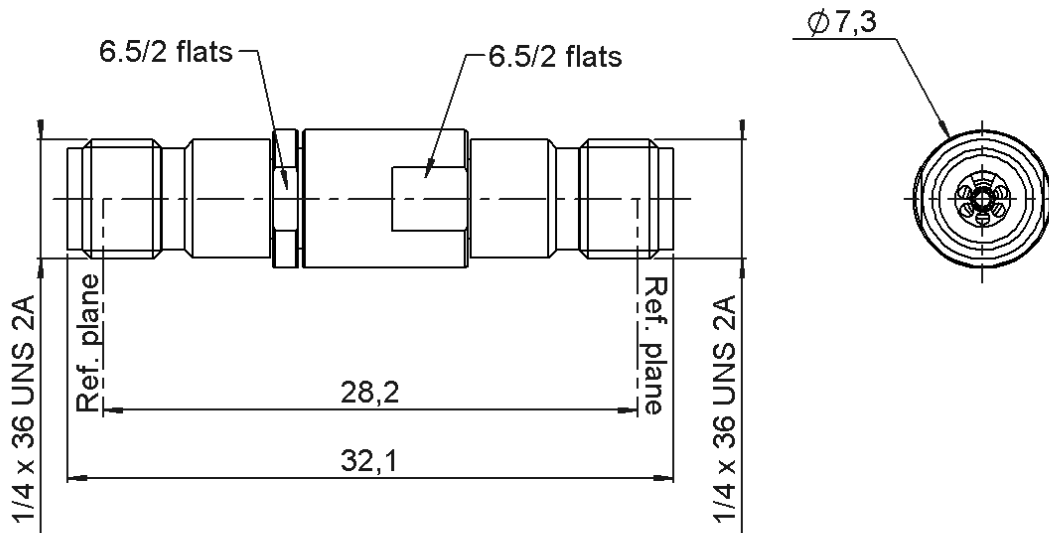
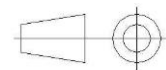

COMPONENTS	MATERIALS	PLATING (μm)
Body	STAINLESS STEEL, BRASS	GOLD OVER NICKEL
Center contact	BERYLLIUM COPPER	GOLD OVER NICKEL
Outer contact		
Insulator	PEEK	
Gasket		
Others parts		
-	-	-
-	-	-

PAGE 2/4	ISSUE 26-04-18A	SERIES DIVERS	PART NUMBER R299763000
----------	------------------------	----------------------	-------------------------------

PACKAGING

Standard	Unit	Other
1	Contact us	Contact us

ELECTRICAL CHARACTERISTICS

Impedance		50	Ω	
Frequency		0-18	GHz	
VSWR	* +	0,0000	x F(GHz) Maxi	
Insertion loss		**	√F(GHz) dB Maxi	
RF leakage	- (NA	- F(GHz) dB Maxi	
Voltage rating		90	Veff Maxi	
Dielectric withstanding voltage		130	Veff mini	
Insulation resistance		5000	MΩ mini	

ENVIRONMENTAL

Operating temperature	-65/+165	°C
Hermetic seal	NA	Atm.cm3/s
Panel leakage	NA	

MECHANICAL CHARACTERISTICS

Center contact retention			
Axial force – Mating End		27	N mini
Axial force – Opposite end		27	N mini
Torque		NA	N.cm mini
Recommended torque			
Mating		NA	N.cm
Panel nut		NA	N.cm
Mating life		500	Cycles mini
Weight		6,0000	g

SPECIFICATION

OTHER CHARACTERISTICS

Assembly instruction:

Others:

- *V.S.W.R: 1.3 max DC-12GHz**
- *V.S.W.R: 1.5 max 12.5-18GHz**
- **0.13 dB max**

PAGE 3/4	ISSUE 26-04-18A	SERIES DIVERS	PART NUMBER R299763000
----------	-----------------	----------------------	-------------------------------

COMPONENTS

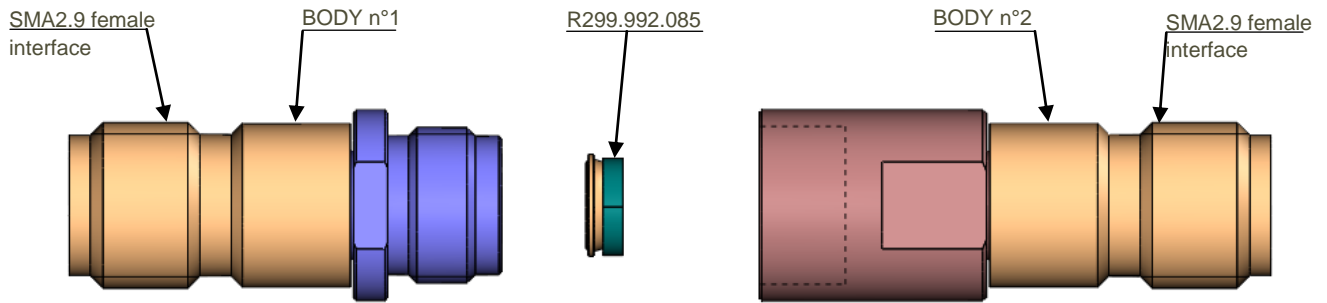

1

- Hold the body 1 of the measuring connector.
- Take the R299.992.085 connector to measure in V.S.W.R.
- Mount the R229.992.085 connector in the body cavity 1.

-Warning
Observe the mounting direction.

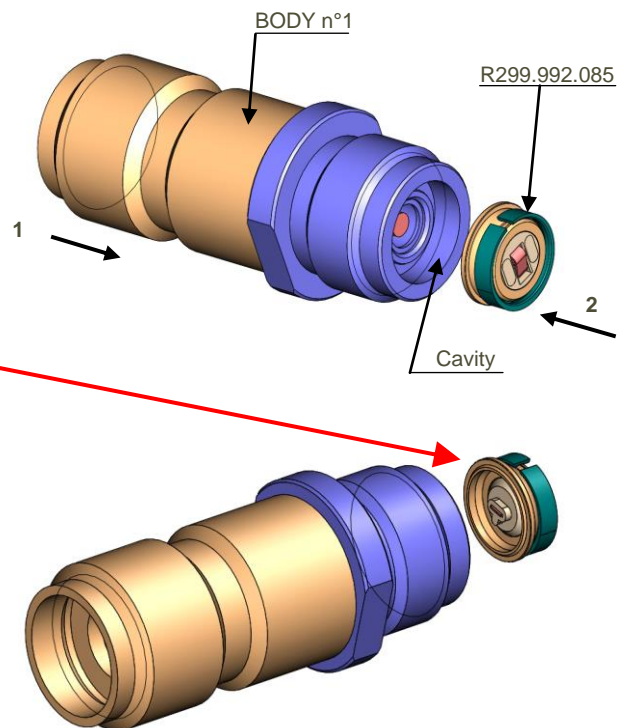

2

- Take the body 2 of the measuring connector.
- Screw the body 2 onto the body 1 of the measuring connector.
- Recommended tightening torque: 90N.cm**

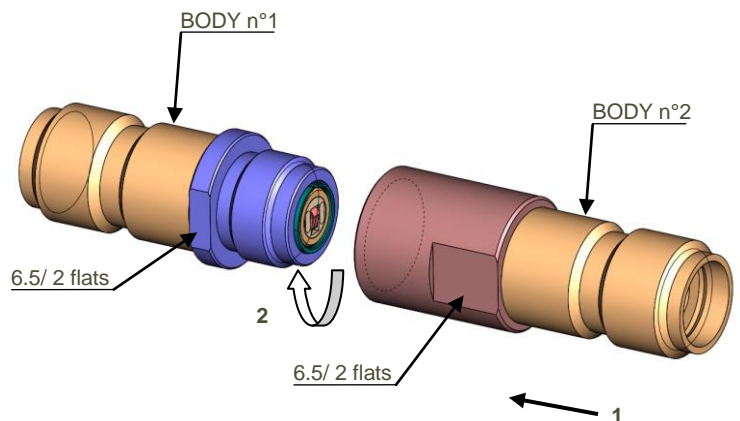

3

- Connect the assembly obtained to the terminals of a spectrum analyzer.
- Measure the V.S.W.R.
- To have V.S.W.R measurement of the R299.992.085 connector, make gates closer to it.

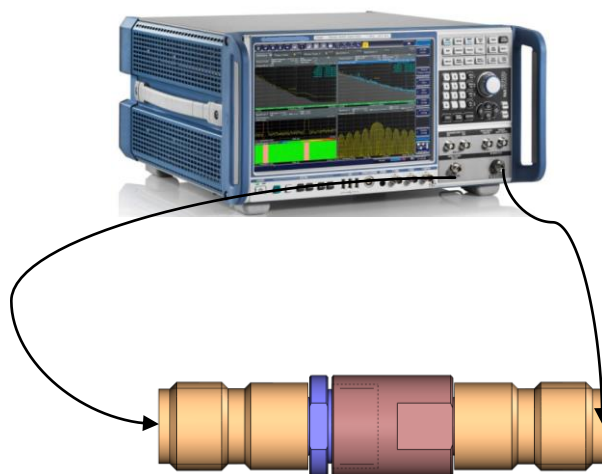

X-ON Electronics

Largest Supplier of Electrical and Electronic Components

Click to view similar products for [RF Adapters - In Series](#) category:

Click to view products by [Radiall](#) manufacturer:

Other Similar products are found below :

[5916-1103-603](#) [5919-1503-000](#) [651A505](#) [82-5552](#) [9030-9523-502](#) [PN2C](#) [A0407000](#) [R114703000W](#) [R125771001](#) [R141710000W](#)
[R141723161](#) [R141730000](#) [R143730700](#) [R143770000](#) [R161703000W](#) [R161753000W](#) [R161791530W](#) [R201705000](#) [R222705200](#)
[R222M40010W](#) [R223703180](#) [R316754000](#) [R405006000](#) [R443162000](#) [AD78TL](#) [HRM-513S](#) [1996352-2](#) [2157155-1](#) [252169-75](#) [AD158](#)
[2101130-1](#) [252186](#) [R114704000W](#) [R114720000W](#) [R125705001](#) [R125705701](#) [R125771000](#) [R125771001W](#) [R127704001](#) [R127.870.001](#)
[R127872001](#) [R141717000](#) [R142710000](#) [R142723000](#) [R143703000](#) [R143704000](#) [R143705700](#) [R161715000W](#) [R161771000W](#) [R176754000](#)