

PAGE 1/2	ISSUE <b>02-02-16B</b>	SERIES <b>DETECTOR</b>	PART NUMBER <b>R451030500</b>
----------	------------------------	---------------------------	-------------------------------

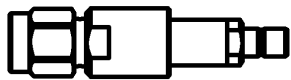

SCALE 1:1

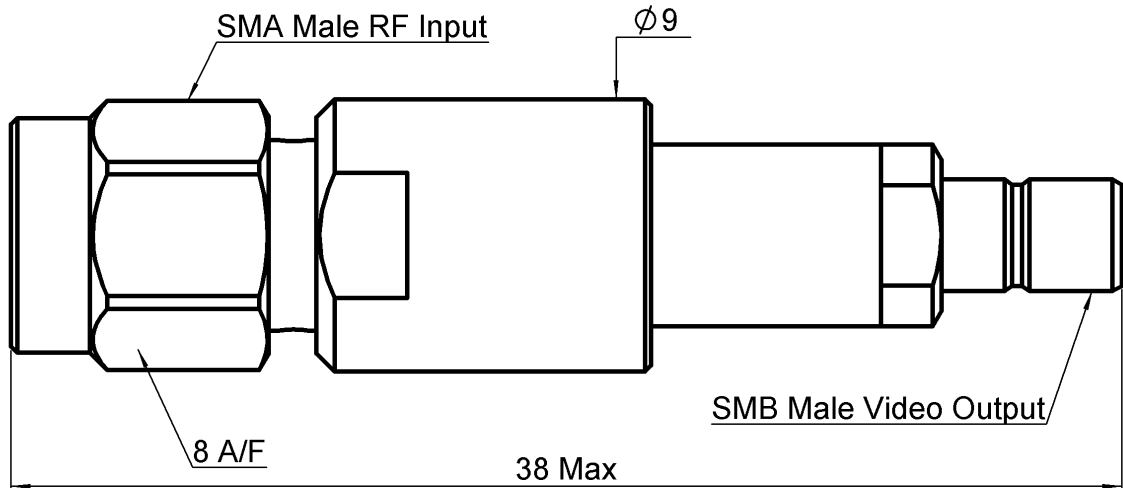
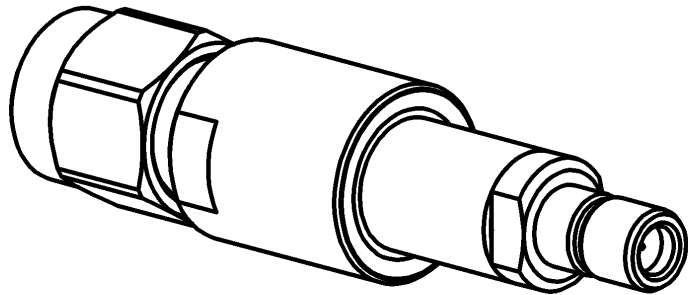

All dimensions are in mm.

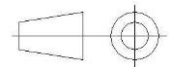

Weight Specification **8,9900** g

PAGE 2/2	ISSUE <b>02-02-16B</b>	SERIES <b>DETECTOR</b>	PART NUMBER <b>R451030500</b>
----------	------------------------	---------------------------	-------------------------------

### ELECTRICAL CHARACTERISTICS

FREQUENCY RANGE (GHz)	1 - 18
IMPEDANCE	50 Ohms
SENSITIVITY LEVEL (Input Power <= -20 dBm)	> 1500 mV / mW
FREQUENCY RESPONSE	± 2 dB
AVERAGE POWER	200 mW at 25°C
PEAK POWER	2W (10 nS , 1mS)
OUTPUT POLARITY	Positive
FILTERING CAPACITY (Typical)	20 pF
DIODE	Schottky "Zero Bias"

### MECHANICAL CHARACTERISTICS

RF INPUT CONNECTOR	SMA Male Per MIL C 39012
VIDEO OUTPUT CONNECTOR	SMB Male Per MIL C 39012

### ENVIRONMENTAL CHARACTERISTICS

OPERATING TEMPERATURE RANGE (°C)	- 25 / +70
STORAGE TEMPERATURE RANGE (°C)	- 40 / +85

## X-ON Electronics

Largest Supplier of Electrical and Electronic Components

*Click to view similar products for* [RF Adapters - Between Series category:](#)

*Click to view products by* [Radiall manufacturer:](#)

Other Similar products are found below :

[5945-9503-000](#) [MCX/F-SMA/M](#) [R192417010](#) [ADBJ20-E1-BJ379](#) [ADM2](#) [ADPL75-A1-PL75](#) [242191](#) [9317505](#) [29-3835P](#) [AD130](#) [ADBJ20-E1-PL74](#) [ADBJ20-E2-BJ79](#) [ADBJ77-A1-PL375](#) [ADBJ77-E1-UPL20](#) [ADRMF370](#) [242215](#) [242228](#) [R125680000W](#) [R192430000](#) [UAD95](#) [1057367-1](#) [8311505](#) [R114704000](#) [R451034500](#) [R451030500](#) [R451543000](#) [HDVDPN](#) [ADBJ20-K1-PL20](#) [R451570000](#) [R451034000](#) [J9](#) [J3WE-5](#) [R451032500](#) [242201RP](#) [17K132-K00S5](#) [AD-RSMAF-RTNC](#) [53K156-K00N5](#) [02K119-K00E3](#) [29S132-K01N5](#) [53S156-K00N5](#) [02S119-S00E3](#) [28K132-K00N5](#) [02S109-K00S3](#) [27-8200TP](#) [242235](#) [ADBJ20-E1-BJ89](#) [000-2900](#) [321-102-003 \(SMA-50/2-H155/W1.03 AU\)](#) [1057377-1](#) [321-350-001 \(SMA-50-R/2-RG316/N2.01\)](#)