



ABOUT US | WHAT'S NEW | CONTACT US | SERVICES | QUALITY | SITE MAP

- HOME
- PRODUCTS
- ONLINE CATALOG
- REQUEST QUOTE
- ORDER ONLINE
- CHECK STOCK
- REQUEST PRINT CATALOG
- REQUEST SAMPLES
- ENGINEERING DATA
- DISTRIBUTORS
- CAPABILITIES BROCHURE

**CALL NOW:**  
203 888-2133

PART NO. SEARCH - ENTER 3-4 CHARS:

ENTER

Catalogs: [ASE](#) | [Metric](#) | [Handles & Ferrules](#)

## 1/4 Hex Male-Female Standoffs

[Home](#) | [Previous](#) | [Next](#)  
[Related Metric](#)

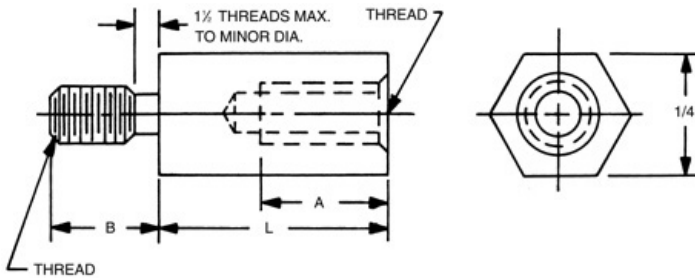

Ordering Code			
xxxx	xxx	x	x
Length	Thread	Material	Finish

**PART: 4530-440-AL-9**

**Enter desired quantities:**  
Qty 1 Qty 2 Qty 3

Request Quote

Check Stock

[Download drawing](#)

Select	Part No.	Length
<input type="radio"/>	4530A	7/32
<input type="radio"/>	4530	1/4
<input type="radio"/>	4530T	9/32
<input type="radio"/>	4531	5/16
<input type="radio"/>	4531T	11/32
<input type="radio"/>	4532	3/8
<input type="radio"/>	4532T	13/32
<input type="radio"/>	4533	7/16
<input type="radio"/>	4533T	15/32
<input type="radio"/>	4534	1/2
<input type="radio"/>	4534T	17/32
<input type="radio"/>	4535	9/16
<input type="radio"/>	4535T	19/32
<input type="radio"/>	4536	5/8
<input type="radio"/>	4536T	21/32
<input type="radio"/>	4537	11/16
<input type="radio"/>	4537T	23/32
<input type="radio"/>	4538	3/4
<input type="radio"/>	4538T	25/32
<input type="radio"/>	4539	13/16
<input type="radio"/>	4539T	27/32
<input type="radio"/>	4540	7/8
<input type="radio"/>	4540T	29/32

Select	Part No.	Length
<input type="radio"/>	4541	15/16
<input type="radio"/>	4541T	31/32
<input type="radio"/>	4542	1"
<input type="radio"/>	4543	1-1/16
<input type="radio"/>	4544	1-1/8
<input type="radio"/>	4545	1-3/16
<input type="radio"/>	4546	1-1/4
<input type="radio"/>	4547	1-5/16
<input type="radio"/>	4548	1-3/8
<input type="radio"/>	4549	1-7/16

Select	Part No.	Length
<input type="radio"/>	4550	1-1/2
<input type="radio"/>	4551	1-9/16
<input type="radio"/>	4552	1-5/8
<input type="radio"/>	4553	1-11/16
<input type="radio"/>	4554	1-3/4
<input type="radio"/>	4555	1-13/16
<input type="radio"/>	4556	1-7/8
<input type="radio"/>	4557	1-15/16
<input type="radio"/>	4558	2"
<input type="radio"/>	4559	2-1/8
<input type="radio"/>	4560	2-1/4
<input type="radio"/>	4561	2-3/8
<input type="radio"/>	4562	2-1/2
<input type="radio"/>	4563	2-5/8
<input type="radio"/>	4564	2-3/4
<input type="radio"/>	4565	2-7/8
<input type="radio"/>	4566	3"
<input type="radio"/>	4567	3-1/4
<input type="radio"/>	4568	3-1/2
<input type="radio"/>	4569	3-3/4
<input type="radio"/>	4570	4"

Select	Code	Thread
<input type="radio"/>	256	2-56
<input type="radio"/>	440	4-40
<input type="radio"/>	632	6-32
<input type="radio"/>	832	8-32

Thread Length Code		
Thread	A	B
2-56	3/16	5/32
4-40	1/4	3/16
6-32	3/8	1/4
8-32	7/16	3/8

Select	Code	Material	RoHS
<input type="radio"/>	AL	Aluminum	YES
<input type="radio"/>	B	Brass	YES
<input type="radio"/>	SS	Stainless Steel	YES
<input type="radio"/>	S	Steel	YES
<input type="radio"/>	N	Nylon	YES

[Material Specifications](#)

**SELECT FINISH:**

9-Alodine 1200\*

\* Finishes ending with an asterisk are not RoHS Compliant

[Ordering non-standard items](#)

In short lengths, 'A' will be tapped to maximum depth

## X-ON Electronics

Largest Supplier of Electrical and Electronic Components

*Click to view similar products for [Standoffs & Spacers](#) category:*

*Click to view products by [RAF Electronic Hardware](#) manufacturer:*

Other Similar products are found below :

[588-6208-02](#) [599-9844-02](#) [M0516-3-N](#) [M0518-3-N](#) [M0521-3-N](#) [M0524-3-N](#) [M0532-35-N](#) [M0543-4-AL](#) [M0544-35-N](#) [M0544-3-N](#) [M0545-3-AL](#) [M0553-3-N](#) [M0608-5-SS](#) [M0609-5-SS](#) [M0651-5-SS](#) [M0653-35-N](#) [M0654-4-SS](#) [M0655-5-AL](#) [M0658-35-AL](#) [M0660-4-AL](#) [M0670-35-N](#) [M0671-5-N](#) [M0671-5-SS](#) [M0722-5-N](#) [M0725-6-N](#) [M0904-B-25-AL](#) [M1273-2545-AL](#) [M1273-2545-SS](#) [M1273-3005-AL](#) [M1273-3005-SS](#) [M1274-3005-AL](#) [60187](#) [60202-SP](#) [60273](#) [60335-SP](#) [60348-SP](#) [60419-SP](#) [60425-SP](#) [60473-SP](#) [60475-SP](#) [60477-SP](#) [60489-SP](#) [60491-SP](#) [60585-SP](#) [60762-SP](#) [60763-SP](#) [60872-SP](#) [M1303-3506-AL](#) [M1307-3506-AL](#) [M1314-3005-AL](#)