



ABOUT US | WHAT'S NEW | CONTACT US | SERVICES | QUALITY | SITE MAP

- HOME
- PRODUCTS
- ONLINE CATALOG
- REQUEST QUOTE
- ORDER ONLINE
- CHECK STOCK
- REQUEST PRINT CATALOG
- REQUEST SAMPLES
- ENGINEERING DATA
- DISTRIBUTORS
- CAPABILITIES BROCHURE

CALL NOW:
203 888-2133

PART NO. SEARCH - ENTER 3-4 CHARS:

ENTER

Catalogs: [ASE](#) | [Metric](#) | [Handles & Ferrules](#)

4.5mm Hex Male-Female Standoffs

[Home](#) [Previous](#) [Next](#)
[Related ASE](#)

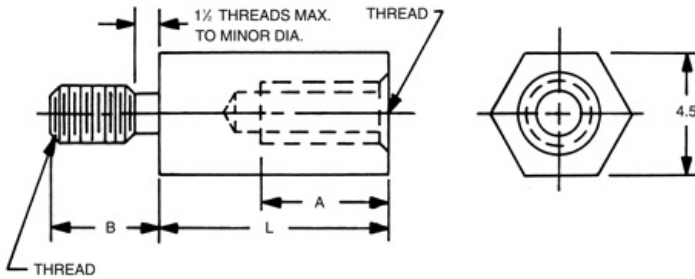

Ordering Code			
mxxxx	xxxx	xx	xx
Length	Thread	Material	Finish

PART: M2106-2545-N

Enter desired quantities:
Qty 1 Qty 2 Qty 3

Request Quote

Check Stock

[Download drawing](#)



Select	Part No.	Length	Select	Part No.	Length
<input type="radio"/>	M2100	5	<input type="radio"/>	M2115	20
<input type="radio"/>	M2101	6	<input type="radio"/>	M2116	21
<input type="radio"/>	M2102	7	<input type="radio"/>	M2117	22
<input type="radio"/>	M2103	8	<input type="radio"/>	M2118	23
<input type="radio"/>	M2104	9	<input type="radio"/>	M2119	24
<input type="radio"/>	M2105	10	<input type="radio"/>	M2120	25
<input checked="" type="radio"/>	M2106	11	<input type="radio"/>	M2121	28
<input type="radio"/>	M2107	12	<input type="radio"/>	M2122	31
<input type="radio"/>	M2108	13	<input type="radio"/>	M2123	34
<input type="radio"/>	M2109	14	<input type="radio"/>	M2124	37
<input type="radio"/>	M2110	15	<input type="radio"/>	M2125	40
<input type="radio"/>	M2111	16	<input type="radio"/>	M2126	43
<input type="radio"/>	M2112	17	<input type="radio"/>	M2127	46
<input type="radio"/>	M2113	18	<input type="radio"/>	M2128	49
<input type="radio"/>	M2114	19	<input type="radio"/>	M2129	52

Thread Length Code				
Select	Code	Thread	A	B
<input checked="" type="radio"/>	2545	M2.5x0.45	4.8	3.97
<input type="radio"/>	3005	M3x0.5	6.4	4.76

Minimum Thread Depth 'A'
Body Length 'L'

Minimum Thread Depth 'A' & Body Length 'L'					
Thread	'L' 5	'L' 6	'L' 7	'L' 8	'L' 9
M2.5x0.45	1.9	2.9	3.9		
M3x0.5	1.8	2.8	3.8	4.8	5.8

Select	Code	Material	RoHS
<input type="radio"/>	AL	Aluminum	YES
<input type="radio"/>	B	Brass	YES
<input type="radio"/>	SS	Stainless Steel	YES
<input type="radio"/>	S	Steel	YES
<input checked="" type="radio"/>	N	Nylon	YES

[Material Specifications](#)

SELECT FINISH:

select a finish

* Finishes ending with an asterisk are not RoHS Compliant

[Ordering non-standard items](#)

X-ON Electronics

Largest Supplier of Electrical and Electronic Components

Click to view similar products for [Standoffs & Spacers](#) category:

Click to view products by [RAF Electronic Hardware](#) manufacturer:

Other Similar products are found below :

[588-6208-02](#) [599-9844-02](#) [M0516-3-N](#) [M0518-3-N](#) [M0521-3-N](#) [M0524-3-N](#) [M0532-35-N](#) [M0543-4-AL](#) [M0544-35-N](#) [M0544-3-N](#) [M0545-3-AL](#) [M0553-3-N](#) [M0608-5-SS](#) [M0609-5-SS](#) [M0651-5-SS](#) [M0653-35-N](#) [M0654-4-SS](#) [M0655-5-AL](#) [M0658-35-AL](#) [M0660-4-AL](#) [M0670-35-N](#) [M0671-5-N](#) [M0671-5-SS](#) [M0722-5-N](#) [M0725-6-N](#) [M0904-B-25-AL](#) [M1273-2545-AL](#) [M1273-2545-SS](#) [M1273-3005-AL](#) [M1273-3005-SS](#) [M1274-3005-AL](#) [60187](#) [60202-SP](#) [60273](#) [60335-SP](#) [60348-SP](#) [60419-SP](#) [60425-SP](#) [60473-SP](#) [60475-SP](#) [60477-SP](#) [60489-SP](#) [60491-SP](#) [60585-SP](#) [60762-SP](#) [60763-SP](#) [60872-SP](#) [M1303-3506-AL](#) [M1307-3506-AL](#) [M1314-3005-AL](#)