

# C Series Chevron Inserts

## Most popular, most overall length choices



Some thermoplastics, like polycarbonates and structural foams, are brittle – especially in thin-wall applications. Our chevron inserts add considerable strength.

Two opposing bands of sharp diagonal knurls provide high tensile pull-out load carrying capability. Little or no stress is applied to the walls of the molded holes.

Recommended Hole Size – See chart for installation hole size.

Additional information can be found on page 5, Design Guidelines.

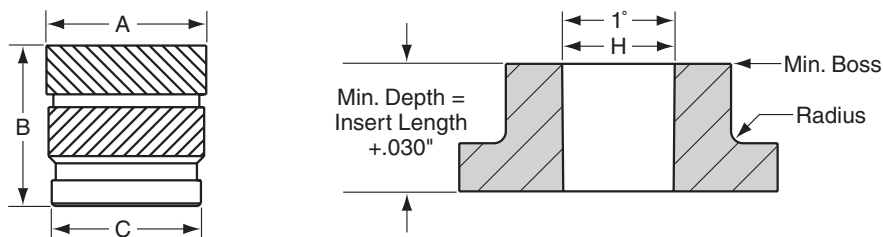

INCH		METRIC		A	B	C	Hole H	Min. Boss
Thread Size	Part Number	Thread Size	Part Number	±.004	±.004	±.004	+ .003 – .000	
2-56	256 x 100C	M2.0 x 0.4	M20 x 100C	.143	.100	.123	.126	.252
	256 x 125C	M2.0 x 0.4	M20 x 125C	.143	.125	.123	.126	.252
	256 x 157C	M2.0 x 0.4	M20 x 157C	.143	.157	.123	.126	.252
4-40	440 x 135C	M2.5 x 0.45	M25 x 135C	.186	.135	.154	.157	.314
		M3.0 x 0.5	M30 x 118C	.186	.118	.154	.157	.314
		M3.0 x 0.5	M30 x 135C	.186	.135	.154	.157	.314
	440 x 157C	M2.5 x 0.45	M25 x .157C	.186	.157	.154	.157	.314
		M3.0 x 0.5	M30 x 157C	.186	.157	.154	.157	.314
	440 x 170C	M2.5 x 0.45	M25 x 170C	.186	.170	.154	.157	.314
		M3.0 x 0.5	M30 x 170C	.186	.170	.154	.157	.314
		M3.0 x 0.5	M30 x 197C	.186	.197	.154	.157	.314
440 x 226C	M2.5 x 0.45	M25 x 226C	.186	.226	.154	.157	.314	
	M3.0 x 0.5	M30 x 226C	.186	.226	.154	.157	.314	
6-32	632 x 125C			.218	.125	.185	.188	.376
	632 x 150C	M3.0 x 0.5	M30 x 150C	.218	.150	.185	.188	.376
		M3.5 x 0.6	M35 x 150C	.218	.150	.185	.188	.376
	632 x 226C			.218	.226	.185	.188	.376
	632 x 250C	M3.0 x 0.5	M30 x 250C	.218	.250	.185	.188	.376
		M3.5 x 0.6	M35 x 250C	.218	.250	.185	.188	.376
632 x 281C	M3.5 x 0.6	M35 x 281C	.218	.281	.185	.188	.376	

continued on next page

# C Series Chevron Inserts

INCH		METRIC		A	B	C	Hole H	Min. Boss
Thread Size	Part Number	Thread Size	Part Number	±.004	±.004	±.004	+ .003 – .000	
8-32	832 x 185C	M4.0 x 0.7	M40 x 185C	.249	.185	.218	.221	.442
	832 x 250C		M40 x 250C	.249	.250	.218	.221	.442
	832 x 321C		M40 x 321C	.249	.321	.218	.221	.442
10-24	1024 x 185C <sup>†</sup>	M5.0 x 0.8	M50 x 185C <sup>†</sup>	.280	.185	.249	.252	.504
	1024 x 225C		M50 x 225C	.280	.225	.249	.252	.504
	1024 x 250C		M50 x 250C	.280	.250	.249	.252	.504
	1024 x 310C		M50 x 310C	.280	.310	.249	.252	.504
	1024 x 375C		M50 x 375C	.280	.375	.249	.252	.504
10-32	1032 x 185C			.280	.185	.249	.252	.504
	1032 x 225C			.280	.225	.249	.252	.504
	1032 x 250C			.280	.250	.249	.252	.504
	1032 x 310C			.280	.310	.249	.252	.504
	1032 x 375C			.280	.375	.249	.252	.504
1/4-20	2520 x 226C	M6.0 x 1.0	M60 x 226C <sup>†</sup>	.342	.226	.312	.315	.630
	2520 x 250C		M60 x 250C	.342	.250	.312	.315	.630
	2520 x 312C		M60 x 312C	.342	.312	.312	.315	.630
	2520 x 375C		M60 x 375C	.342	.375	.312	.315	.630
	2520 x 500C		M60 x 500C	.342	.500	.312	.315	.630
1/4-28	2528 x 226C <sup>†</sup>			.342	.226	.312	.315	.630
	2528 x 250C			.342	.250	.312	.315	.630
	2528 x 312C			.342	.312	.312	.315	.630
	2528 x 375C			.342	.375	.312	.315	.630
	2528 x 500C			.342	.500	.312	.315	.630
5/16-18	3118 x 250C	M8.0 x 1.25	M80 x 250C	.406	.250	.374	.377	.754
	3118 x 500C		M80 x 500C	.406	.500	.374	.377	.754
5/16-24	3124 x 250C			.406	.250	.374	.377	.754
	3124 x 500C			.406	.500	.374	.377	.754
3/8-16	3816 x 500C	M10.0 x 1.5	M100 x 500C	.498	.500	.465	.468	.936
3/8-24	3824 x 500C			.498	.500	.465	.468	.936
1/2-13	5013 x 625C			.659	.625	.623	.627	1.254
1/2-20	5020 x 625C							
1/8-NPT	1227 x 375C			.480	.375	.450	.453	.906
	1227 x 625C			.480	.625	.450	.453	.906

† Non-Stocking Item – Minimum Order May Apply

*Stainless Steel Inserts – Class 3A/4H screw must pass with finger torque, standard class go gage may stop on last thread. • Part numbers for Stainless Steel Inserts are the same as listed in the chart, but ending with -SS.*

## X-ON Electronics

Largest Supplier of Electrical and Electronic Components

*Click to view similar products for [Mounting Fixings](#) category:*

*Click to view products by [RAF Electronic Hardware](#) manufacturer:*

Other Similar products are found below :

[5912235-2](#) [007541](#) [627](#) [M3783-7001](#) [71-074914-006](#) [71-441549-19S](#) [75-69211-3P](#) [75-69214-6P](#) [75-69220-27S](#) [75-69224-5S](#) [7717-8DAP](#)  
[85047GULPT](#) [FPK-02-R10](#) [PMS27488-001-01](#) [1-18023-0](#) [H-118-2](#) [D83999/20WC8SN](#) [DB1](#) [1302030464](#) [DC31-14W19PN](#) [DC31-14W19PW](#) [DC32-18W32SN](#) [DC36-18-32SW](#) [DC36-18-32SX](#) [DC37-14-19PW](#) [DC37-22-21PX](#) [1302010957](#) [1302263564](#) [1302340393](#)  
[1404-0016-78](#) [14540](#) [149331-9811](#) [1561-60](#) [1566](#) [1566](#) [17542](#) [BR16A](#) [HS5659MB98PN](#) [NT20SATT01](#) [201C5058-01-201 REV E](#) [22594-8](#)  
[KBB-141](#) [915060](#) [SF4011-60101](#) [97-CS-50](#) [1671](#) [LS10215R14-15PN](#) [LS10215R14-7PN L/C](#) [1855-54](#) [T-2085-SP](#)