

MICROMECC - Keylock switch IP54

3.13.026.016/0000

2 keys included.



Other lock variants available on request.

General information

| | |
|----------------|---------------|
| Color | charcoal grey |
| Form of collar | square |

Dimensions

| | |
|------------------|---------|
| Length of collar | 19 mm |
| Width of collar | 19 mm |
| Overall height | 19.5 mm |

Mechanical design

| | |
|-----------------------------|-----------------------------|
| Mounting | soldering |
| Terminals | tin-plated |
| Contact system | cross contact self cleaning |
| Contact function | latching |
| Contact materials | Au alloy |
| Illuminability | no |
| Lock | Micromec |
| Wafers | 5 |
| Lock type | 001 |
| Number of locking positions | 500 |
| Main key | on request |
| Key removal position | 0+1+2 |

Mechanical characteristics

| | |
|-----------------------------|------------------|
| Switching torque | 0.04 ... 0.10 Nm |
| Robustness max. | 2 Nm |
| Dielectric strength AC min. | 500 V |
| Rated power max. | 1 W |

Electrical characteristics

| | |
|--------------------------------------|-------------------|
| Rated voltage | 2 ... 35 V |
| Rated current max. | 100 mA |
| Contact resistance when new max. | 100 mΩ |
| Contact resistance acc. to life max. | 200 mΩ |
| Insulation resistance | 10 ⁹ Ω |
| ESD strength max. | 8 kV |

Other specifications

| | |
|--------------------------------------|--|
| Rotating angle | 2 x 90° |
| Operating life | 10,000 cycle |
| Degree of protection from front side | IP54 |
| Ambient temp. operating min. | -25 °C |
| Ambient temp. operating max. | +70 °C |
| Storage temperature min. | -40 °C |
| Storage temperature max. | +80 °C |
| Environmental resistance | acc. to IEC 60068-2-14, -30, -33 and -78 |
| Flammability of materials | UL 94 HB |
| ROHS compliant | yes |
| REACH compliant | yes |

PCB hole pattern, component side

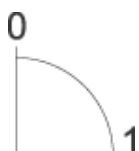
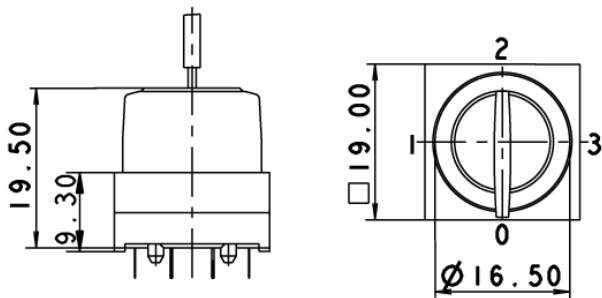
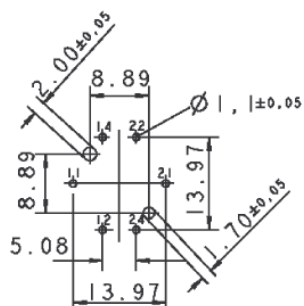

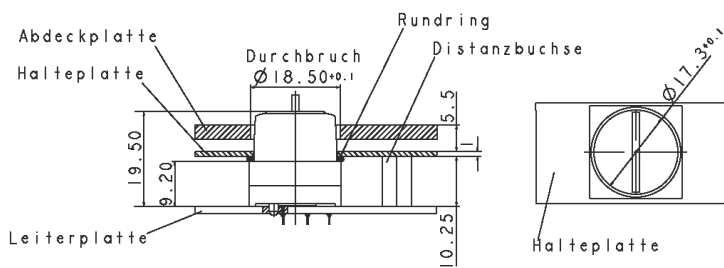
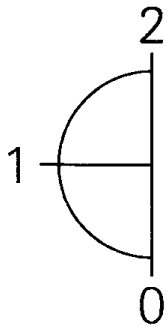

X-ON Electronics

Largest Supplier of Electrical and Electronic Components

Click to view similar products for [Keylock Switches](#) category:

Click to view products by [Rafi](#) manufacturer:

Other Similar products are found below :

[89496-09](#) [58J1007](#) [58J8A45-01B05N](#) [719-0201-000](#) [719-0202-000](#) [719-0702-000](#) [719-5504-000](#) [84800-04](#) [GKNC33L](#) [GKNC3L](#)
[PVA2OAH5](#) [HA1K-2C2VA-2](#) [14-235.022K](#) [AS6H-2K2A](#) [AS6M-2K1B](#) [AS6Q-2K2A](#) [AS6Q-3K2A](#) [1571487-1](#) [KEY-AS6](#) [KH3C-20C](#)
[8928K493](#) [2SWK131AL102](#) [AS6M-2K1A](#) [AS6Q-2K1PB](#) [51-401.036D](#) [51-414.036D](#) [HW1K-31BF20](#) [HW1K-3HF20](#) [Y1112-2027CLFT](#)
[51-195.025D](#) [51-378.AD](#) [51-404.036D](#) [51-405.036D](#) [1-1437597-8](#) [58J8A36-01B04N](#) [58M1422](#) [86945-05](#) [719-0204-000](#) [719-0205-000](#)
[719-0801-000](#) [719-0804-000](#) [719-0805-000](#) [88422-18](#) [58J8A90-01B02N](#) [58J8A90-01C02N](#) [58J9P36-01B09N](#) [58J8A36-01C03N](#)
[GKRA3K1A2-F03-C](#) [GKBB14L6](#) [14-236.025K1020](#)