

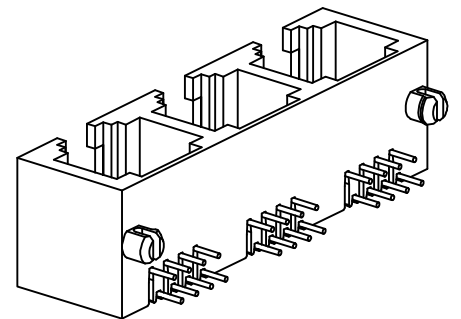

**General Specification**  
 Current Rating: 1.5A DC /Contact, 20mA DC for LED signals  
 Voltage Rating: 125V AC /Contact, 2.0 volts DC for LED signals  
 Operating Environment  
 Standard Temperature: -20°C~+70°C  
 Industrial Temperature: -40°C~+85°C  
 Humidity: 20~70%  
 Contact Resistance: ≤30mΩ  
 Insulation Resistance: ≥500MΩ  
 Dielectric Strength: 500V AC/(50HZ)/Min  
 Mating And Unmating Force: 3~20N  
 Durability: 750 Cycles Min

**Material Specification**  
 Housing :Thermo-plastic, UL94V-0.  
 Contact :Alloy Copper  
 Shield :Alloy Copper  
 Please refer to the customer drawing when customer has specified

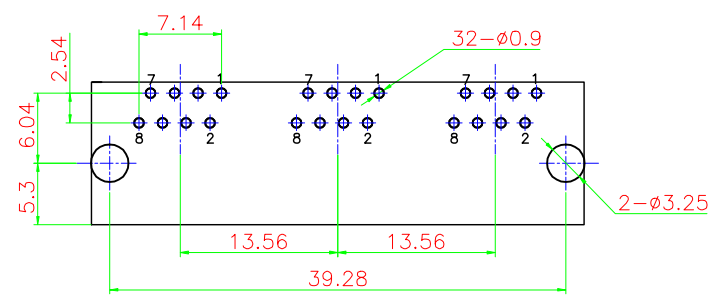
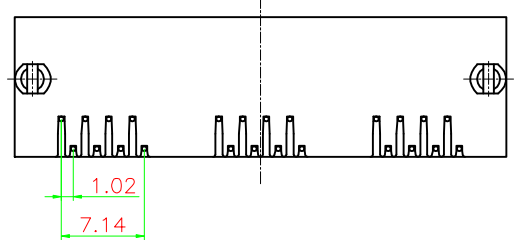
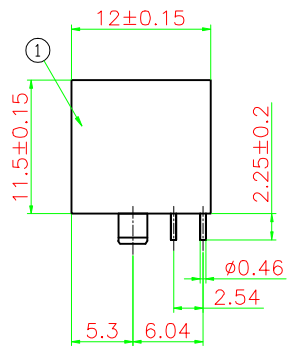
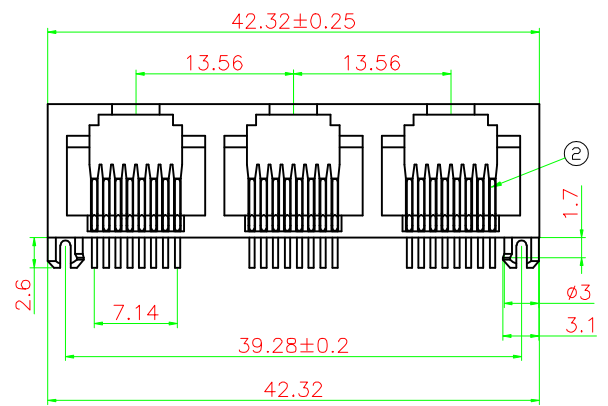
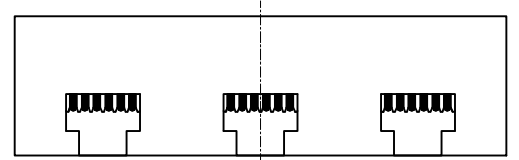

PCB LAYOUT (TOP VIEW)

|    |    |                 |    |                 |    |
|----|----|-----------------|----|-----------------|----|
| 2  | 插针 | PHOSPHOR BRONZE | 24 | FU <sup>o</sup> |    |
| 1  | 塑座 | PA46            | 1  | BLACK           |    |
| 序号 | 名称 | 材料              | 数量 | 镀层/颜色           | 备注 |

网络插座外形图



|       |       |     |                               |         |        |
|-------|-------|-----|-------------------------------|---------|--------|
| 一般公差  |       | 品名: | RCH-5366-13 全塑 黑座             |         |        |
| 30~   | ±0.25 | 料号: | 536613-80000010AB22 (WR44069) |         |        |
| 10~30 | ±0.20 | 型号: | RJ45                          | 图号:     |        |
| ~10   | ±0.15 | 版本: | 单位:mm                         | 比例: 1:1 | 纸张: A4 |
| 角度:   | ±2°   | 页面: | 1 of 1                        |         |        |

|     |     |     |           |
|-----|-----|-----|-----------|
| 绘图: | 吴素飞 | 日期: | 2022.5.18 |
| 审核: | 周清德 | 日期: |           |
| 核准: | 李生  | 日期: |           |

改 涂 意 随 面 上 在 止 兼 版 次

|      |       |           |
|------|-------|-----------|
| A/0  | 新出版发行 | 2022.5.18 |
| 变更单号 | 变更履历  | 日期        |

## X-ON Electronics

Largest Supplier of Electrical and Electronic Components

*Click to view similar products for [Modular Connectors](#) / [Ethernet Connectors](#) category:*

*Click to view products by [RCH](#) manufacturer:*

Other Similar products are found below :

[8949-H88/06BLKA/SN](#) [74441-0010/BKN](#) [PHP-6P6C-5](#) [GAX-3-66](#) [GDCX-PN-66](#) [GLX-A-44](#) [GLX-N-1010M-BLK](#) [GLX-S-88M-BLK](#)  
[GMX-SMT4-N-88](#) [GSGX-N-2-88](#) [GSGX-N-4-88](#) [GSX-NS2-88-3.05](#) [GSX-NS-88-3.68](#) [PT-108A-8C-UL](#) [PTS-J531-8CS-50UL](#) [A-2014-0-4](#)  
[GWLX-S9-88-YG](#) [DC-1021-8-WH-6](#) [1300530003](#) [1324640-4](#) [132764-001](#) [1413235](#) [MPS88RX-5000](#) [E5288-S000K3-L](#) [155302-001](#)  
[AX101050](#) [AX101063](#) [AX101065](#) [AX101072](#) [AX101307](#) [AX101315](#) [AX101318](#) [AX102271](#) [AX102277](#) [AX102651](#) [AX102660](#) [AX104024](#)  
[203475](#) [PC4D0018P](#) [KIT38082NI](#) [8949-B88/6](#) [2-6609208-5](#) [30-8956](#) [30-8964-100](#) [SM85](#) [SM99S01VBNN04G7](#) [17-103540](#) [191587](#) [PDI-68-RV](#) [PHP-8P8C-S-5](#)