

Battery Holders

Surface Mounting Technology (SMT)



Horizontal mounting

Features

- Easy and fast replacement of the battery
- Designed for automatic pick&place mounting
- Safe retention of coin cell
- Automated battery mounting possible
- Clear separation of connections
- Protection against short-circuits
- Protection against inverse polarity (polarized)
- Protection against leak currents
- Robust design
- Suitable for reflow-soldering

Specifications

- Holder material: heat-resistant, glass fibre filled LCP
- Flammability rating UL 94 V-0
- Battery contacts: spring stainless steel AISI 301, nickel-plated throughout. Solder area tin-plated throughout, min. thickness 5 μm .
- Contact resistance between contacts and the cell is less than 100 $\text{m}\Omega$ (measured through AC 1kHz; depending on the case material of the cell).
-  UL recognition, file E218732
- Operating temperature range: $-40/+100^\circ\text{C}$

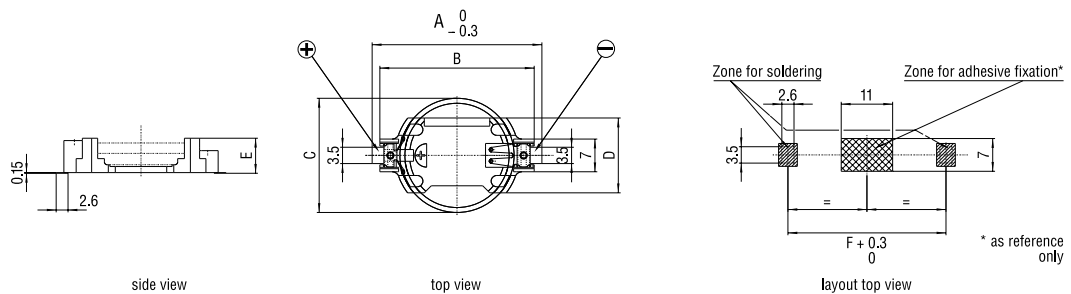
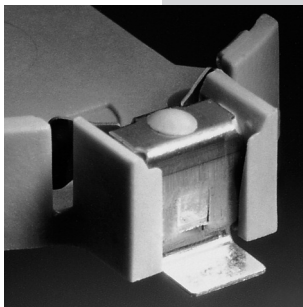

Dimensions

Model	For use with Renata cell	Dimensions (mm)						Weight (g)	Part.No.*
		A	B	C	D	E	F		
SMTU357-LF	357 (SR44W)	23.3	19.9	11.6	12.0	7.55	20.7	0.85	701132
SMTU1220-LF	CR1220	23.7	20.3	12.5	12.7	4.8	21.1	0.80	701114
SMTU1225-LF	CR1225	23.7	20.3	12.5	12.7	4.8	21.1	0.70	701115
SMTU1632-LF	CR1632	27.7	24.3	16.0	14.5	5.4	25.1	0.80	701130
SMTU2032-LF	CR2032	32.0	28.5	20.0	16.1	5.4	29.4	0.95	701116
SMTU2430-LF	CR2430	36.4	33.0	24.5	16.1	4.9	33.8	1.05	701117
SMTU2450N-LF	CR2450N ¹⁾	36.4	33.0	24.5	16.1	7.5	33.8	1.45	701118
SMTU2477N-LF	CR2477N	36.4	33.0	24.5	16.1	10.3	33.8	1.65	701119
SM2X2016-LF	CR2016	32.0	28.5	20.0	16.1	5.4	29.4	0.95	701113

*Packaging: Industrial Bulk (B-Trays)

1) Not suitable for CR2450HT

Battery Holders

Through-hole mounting

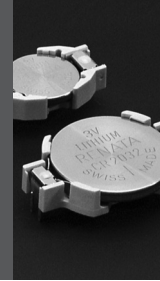

Horizontal mounting

Features

- Easy and fast replacement of the battery
- Designed for automatic pick&place mounting
- Safe retention of coin cell
- Automated battery mounting possible
- Clear separation of connections
- Protection against short-circuits
- Protection against inverse polarity (polarized)
- Protection against leak currents
- Robust design
- Suitable for wave-soldering

Specifications

- Holder material: heat-resistant, glass fibre filled LCP
- Flammability rating UL 94 V-0
- Battery contacts: spring stainless steel AISI 301, nickel-plated throughout. Solder area tin-plated throughout, min. thickness 5 μm .
- Contact resistance between contacts and the cell is less than 100 $\text{m}\Omega$ (measured through AC 1kHz; depending on the case material of the cell).
-  UL recognition, file E218732
- Operating temperature range: $-40/+100^{\circ}\text{C}$

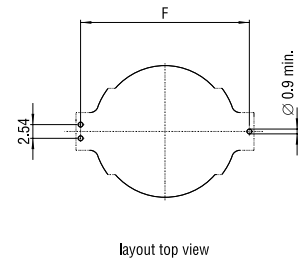
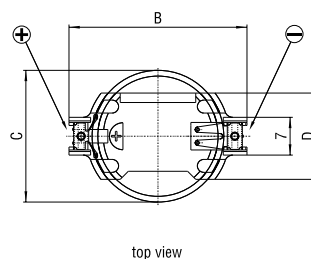
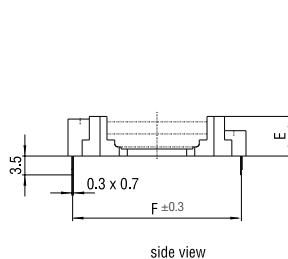
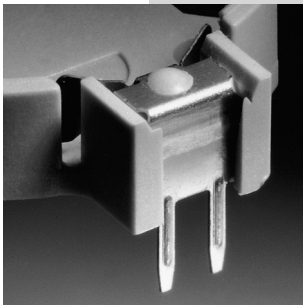

Dimensions

Model	For use with Renata cell	Dimensions (mm)					Weight (g)	Part.No.*
		B	C	D	E	F		
HU357-LF	357 (SR44W)	19.9	11.6	12.0	7.4	18.65	0.84	701133
HU1225-LF	CR1225	20.3	12.5	12.7	4.5	19.1	0.70	701105
HU1632-LF	CR1632	24.3	16.0	14.5	5.2	23.0	0.80	701131
HU2032-LF	CR2032	28.5	20.0	16.1	5.2	27.2	0.95	701106
HU2430-LF	CR2430	33.0	24.5	16.1	4.7	31.7	1.05	701107
HU2450N-LF	CR2450N ¹⁾	33.0	24.5	16.1	7.3	31.75	1.45	701108
HU2477N-LF	CR2477N	33.0	24.5	16.1	10.1	31.8	1.65	701109

*Packaging: Industrial Bulk (IB-Trays)

1) Not suitable for CR2450HT

Battery Holders

Through-hole mounting

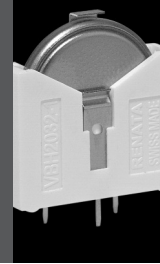

Vertical mounting

VBH2032-1 - Vertical battery holder for Renata coin cell CR2032 / CR2032MFR

Features

- Small PCB footprint
- Easy and fast replacement of the battery
- Safe retention of coin cell
- Protection against short-circuits
- Protection against inverse polarity (polarized)
- Protection against leak currents
- Robust design
- Suitable for wave-soldering

Specifications

- Holder material: polyamide
- Flammability rating UL 94 V-0
- Battery contacts: spring stainless steel AISI 301, nickel-plated throughout.
-  UL recognition, file E218732
- Operating temperature range: -40/+85°C

Dimensions (mm)

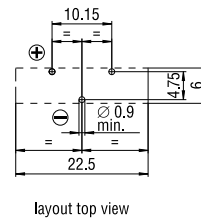
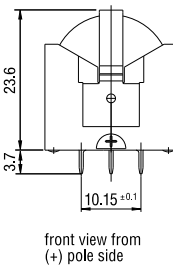
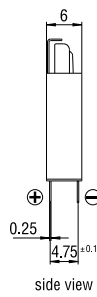
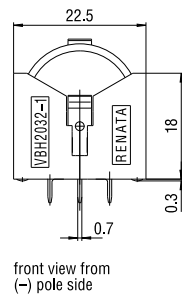
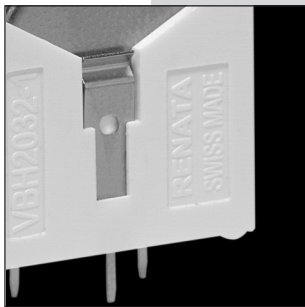

Model	For use with Renata cell	Weight (g)	Part. No.*
VBH2032-1	CR2032	1.6	700579

*Packaging: Industrial Bulk (IB-Trays)

Battery Holders

Through-hole mounting with positioning pins



Battery holders for CR2450N or CR2477N
Vertical and horizontal versions

Features

- Easy and fast replacement of the battery
- Snap-on fixing for coin cells
- Safe retention of coin cell
- Automated battery mounting possible
- Clear separation of connections
- Protection against short-circuits
- Protection against inverse polarity
- Protection against leak currents
- Robust design
- Easy and safe PCB mounting due to additional positioning pins
- Suitable for wave-soldering

Specifications

- Holder material: polyamide
- Flammability rating UL 94 V-2
- Battery contacts: Nickel 99.6 DIN 17740
- Contact resistance between contacts and the cell is less than 100 mΩ (measured through AC 1kHz).
- Solder and positioning pins tin plated through-out, min. thickness 5 μm.
- UL recognition, file E218732
- Operating temperature range: -40/+85°C

NH5077-LF Vertical version

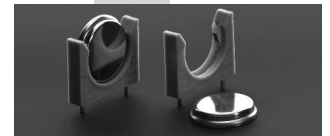
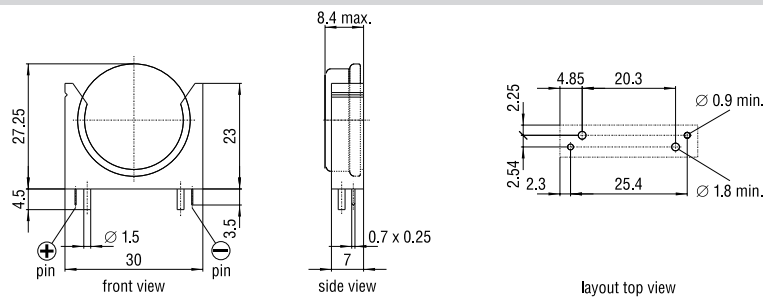
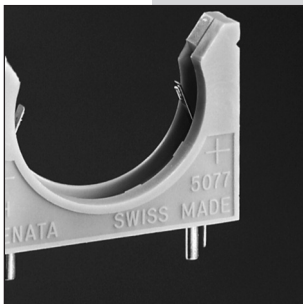

NL5077-LF Horizontal version

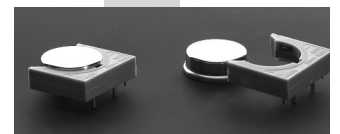
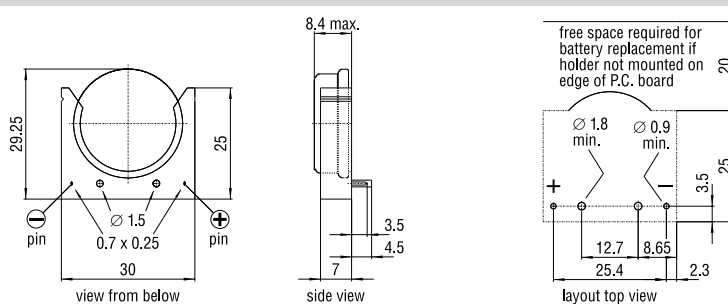
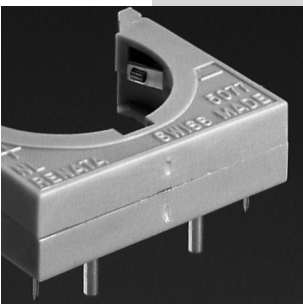

Model	For use with Renata cell	Weight (g)	Part.No.*
NH5077-LF	CR2450N ¹⁾ , CR2477N	2.4	701111
NL5077-LF	CR2450N ¹⁾ , CR2477N	2.9	701112

*Packaging: Industrial Bulk (IB-Trays)

1) Not suitable for CR2450HT

Battery Holders

Packaging options

Battery holders can be supplied in different packaging

Industrial Bulk multi-cell trays

Packaging Code: **IB**

Industrial Bulk packaging is the standard packaging for manufacturers.

The number of battery holders per tray depends on the respective model. So does the number of trays per shrink pack.

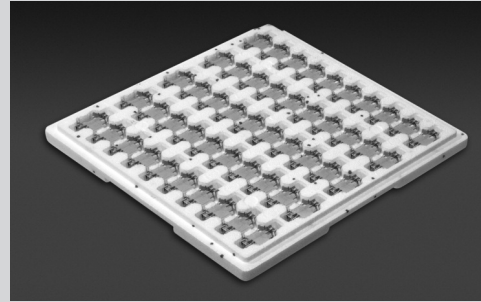

Tape&Reel packaging

Packaging Code: **TR**

For SMT-battery holders there is a Tape&Reel packaging solution available.

Tape&Reel packaging is ideal for high-speed, automated manufacturing lines.

The number of battery holders per reel depends on the respective model.

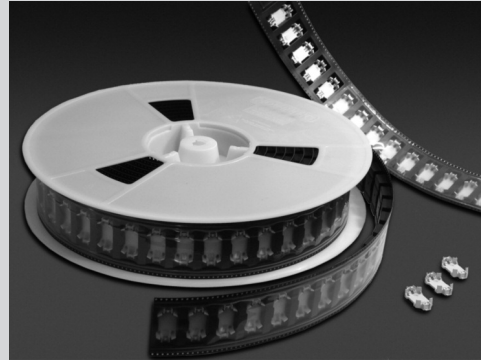

Quantity per reel:

Model	Quantity per Reel	Part.No.*
SMTU1225-LF TR	750 pieces	701230
SMTU1632-LF TR	520 pieces	701231
SMTU2032-LF TR	485 pieces	701232
SMTU2430-LF TR	490 pieces	701233
SMTU2450N-LF TR	350 pieces	701234
SMTU2477N-LF TR	250 pieces	701235
SM2X2016-LF TR	485 pieces	701236

*Packaging: Tape&Reel (TR)

X-ON Electronics

Largest Supplier of Electrical and Electronic Components

Click to view similar products for [Coin Cell Battery Holders](#) category:

Click to view products by [Renata](#) manufacturer:

Other Similar products are found below :

[PDSN-11-D](#) [1058](#) [1052](#) [799-2007](#) [BH44AAB](#) [BH48DL](#) [BH8000](#) [BS-6-1](#) [79573231](#) [101](#) [3035](#) [1025](#) [1026](#) [1027](#) [103](#) [1059](#) [1060](#) [1063](#)
[1065](#) [D3](#) [46400000](#) [BC-0403](#) [BH-121-1B](#) [BH-1/2AA-2A](#) [BH-131A](#) [BH-3101A](#) [BH-3103B](#) [BH-311-1A](#) [BH-311-1D](#) [BH-321-1A](#) [BH-321-1B](#) [BH-321-1D](#) [BH-331-3D](#) [BH-333A](#) [BH-341-1P](#) [BH-351A](#) [BH-362B](#) [BH-383A](#) [BH-421A](#) [BH-422A](#) [BH-425A](#) [BH-431-1B](#) [BH-463A](#)
[BH-511A](#) [BHC-18650-1P](#) [46300000](#) [46600000](#) [799-2001](#) [SBH-331A](#) [SBH-341-1A](#)