

### E-Box EB

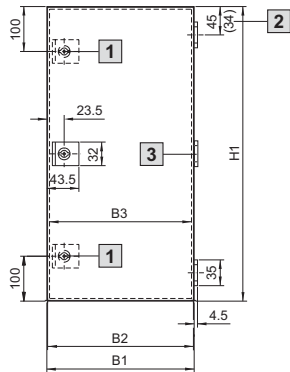

- 1** For EB 1557.500/  
EB 1578.500/EB 1579.500  
two locks
- 2** For EB 1551.500  
and EB 1553.500
- 3** Only for EB 1579.500

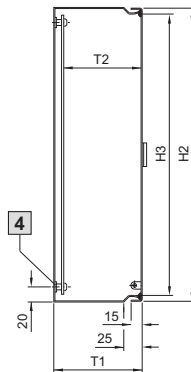

- 4** View A

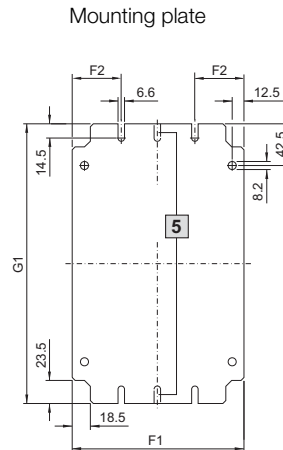

- 5** For 125 mm wide mounting  
plates, attachment is in the  
centre only

View A  
for  
wall mounting

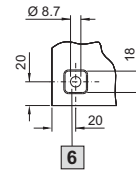

- 6** Knockout 2 mm  
recessed

Model No. EB	Width dimensions mm			Height dimensions mm			Depth dimensions mm		Mounting plate dimensions mm		
	B1	B2	B3	H1	H2	H3	T1	T2	F1	F2	G1
<b>1551.500</b>	150	148	132	150	148	132	80	65	125	62.5	135
<b>1545.500</b>	150	148	132	300	298	282	80	65	125	62.5	285
<b>1546.500</b>	200	198	182	200	198	182	80	65	175	50	185
<b>1552.500</b>	200	198	182	300	298	282	80	65	175	50	285
<b>1547.500</b>	200	198	182	400	398	382	80	65	175	50	385
<b>1553.500</b>	150	148	132	150	148	132	120	105	125	62.5	135
<b>1548.500</b>	150	148	132	300	298	282	120	105	125	62.5	285
<b>1549.500</b>	200	198	182	200	198	182	120	105	175	50	185
<b>1554.500</b>	200	198	182	300	298	282	120	105	175	50	285
<b>1550.500</b>	200	198	182	400	398	382	120	105	175	50	385
<b>1555.500</b>	300	298	282	300	298	282	120	105	275	50	285
<b>1556.500</b>	300	298	282	400	398	382	120	105	275	50	385
<b>1557.500</b>	200	198	182	500	498	482	120	105	175	50	485
<b>1577.500</b>	300	298	282	400	398	382	155	140	275	50	385
<b>1578.500</b>	300	298	282	600	598	582	155	140	275	50	585
<b>1579.500</b>	300	298	282	800	798	782	155	140	275	50	785

- B1 = Overall width
- B2 = Door width
- B3 = Clearance width
- H1 = Overall height
- H2 = Door height
- H3 = Clearance height
- T1 = Overall depth
- T2 = Clearance depth  
available for installation
- F1 = Mounting plate width
- F2 = Outer edge to centre  
mounting holes
- G1 = Mounting plate height

## X-ON Electronics

Largest Supplier of Electrical and Electronic Components

*Click to view similar products for [Mounting Fixings](#) category:*

*Click to view products by [Rittal](#) manufacturer:*

Other Similar products are found below :

[007310](#) [007541](#) [6-141-P](#) [620HA038NF09](#) [620HA038NF11](#) [71-074914-006](#) [71-146610-6H](#) [712HA170B23128-N](#) [71-441549-19S](#) [71-490451-4H](#) [75-69116-8S](#) [75-69211-3P](#) [75-69224-28P](#) [75-69224-5S](#) [770-006A109](#) [770-006A109R](#) [770-006A207](#) [770-006A208W1](#) [770-006A209](#) [770-006A306](#) [770-006A703W1](#) [770-006A704](#) [770-006A704W1](#) [770-006A705](#) [770-006A706](#) [770-006A706W1](#) [770-006A707](#) [770-006A709](#) [770-007A203](#) [770-007A203W1](#) [770-007A204W1](#) [770-007A207W1](#) [770-007A703](#) [770-007A704W1](#) [770-007A706](#) [770-007A707W1](#) [770-010Y208](#) [770-010Y308](#) [770-010Y705](#) [770-010Y706](#) [770-010Y707W1](#) [770-011T201](#) [770-011T203](#) [770-011T701W1](#) [770-011T702](#) [770-011T702W1](#) [770-011T703](#) [770-013210W1](#) [770-013311](#) [770-013312](#)