

CIRCUIT DIAGRAM

1. Maximum rating: 50mA 12V DC
1.最大额定值: 50mA 12V DC
Minimum rating: 10μA 1V DC
最小额定值: 10μA 1V DC
2. Insulation resistance: ≥ 100M Ω
2.绝缘电阻: ≥100MΩ
3. Contact resistance: ≤ 100m Ω
3.接触电阻: ≤100mΩ
4. Withstand voltage: 250V AC
4.耐压: 250V AC
5. Operating temperature: - 20 °C ~ + 70 °C
5.使用温度: -20°C ~ + 70°C
6. Action force: 260 ± 50gf
6.动作力: 260±50gf
7. Service life: 1,000,000 times
7.寿命: 1,000,000次
8. Stroke: 0.35 ± 0.10mm
8.行程: 0.35±0.10mm

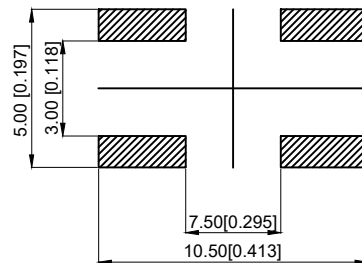

P.C.B LAND DIMENSION

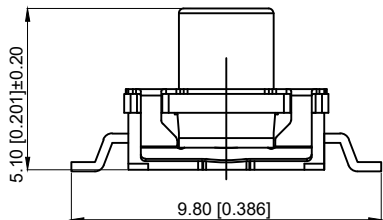
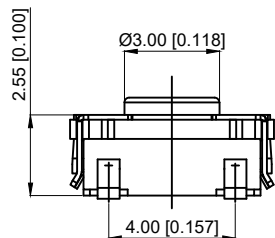

6	Terminal 端子	BASS 黄铜	4	Ag plating 镀银
5	Housing 外壳	SUS	1	
3	Handle 按柄	silica gel 硅胶	1	Blue 蓝色
2	Shrapnel 弹片	SUS	1	Ag plating 镀银
1	Base 基座	PA46	1	Black 黑色
NO 序号	Part name 部件名	Material 材料	QTY 数量	Remark 备注

A4				<p>台普 ROCPCU</p>	<p>COMMON TOLERANCE</p> <table border="1"> <tr> <td>X.XX</td> <td>± 0.10</td> </tr> <tr> <td>X.X</td> <td>± 0.15</td> </tr> <tr> <td>X</td> <td>± 0.25</td> </tr> <tr> <td>ANGULAR</td> <td>—</td> </tr> </table>	X.XX	± 0.10	X.X	± 0.15	X	± 0.25	ANGULAR	—	UNIT	MM	PROJECTED		PRODUCT NAME:
X.XX	± 0.10																	
X.X	± 0.15																	
X	± 0.25																	
ANGULAR	—																	
A3				DRAWN BY	FUYUAN	CHECKED BY	COCO	MODEL NO: TP11222651										
A2				DATE	2019	APPROVAL B	ALEN	Https: www.rocpcu.tw										
A1				<h1>ROCPCU TECHNOLOGY CO.,LTD</h1>														
REV	DATE	REVISION	DESCRIPTION	ISSUE	<p>Copies are issued in strict confidence and shall not be reproduced or copied, or used as the basic of manufacture or sale of apparatus without permission</p>													

X-ON Electronics

Largest Supplier of Electrical and Electronic Components

Click to view similar products for [Tactile Switches](#) category:

Click to view products by [ROCPU Technology](#) manufacturer:

Other Similar products are found below :

[5GTH92001](#) [5GTH9202242](#) [6407-250V-25273P](#) [ADTSA62NV](#) [ADTSA62RV](#) [B3F-3123](#) [1977177-8](#) [1977266-1](#) [ADTSA63NV](#)
[ADTSM21NSVTR](#) [ADTSM25RVTR](#) [ADTSM32NVTR](#) [ADTSMW64RV](#) [FSMRA4JHA04](#) [GS4.70F300QP](#) [KSC241J SP DELTA LFS](#)
[3FTL600RAS](#) [3FTL640RAS](#) [Y96K132V0FPLFS](#) [5GTH9658222](#) [6407-250V-25343P](#) [ADTSM31NVTR](#) [2-1977120-7](#) [TSJW-5.2-260-TR](#)
[KMT011MNGJLHS](#) [B3WN6002S](#) [70-201.0](#) [ADTSG648NV](#) [ADTSM62KSVTR](#) [ADTSM648NV](#) [95C06E3RAT](#) [5GTH96561](#) [3ATH9Q](#)
[FSMRA8JHA04](#) [HARS0073](#) [Y97HS12A5RAFP](#) [Y97BT23B2HAFP](#) [Y33R411N9FPLFT](#) [Y31C01402FPLFS](#) [PTS645SK50SMTR92](#)
[ADTSM32NVB](#) [KMS233GPWTLFG](#) [Y78B64124FP](#) [PTS638SK25SMTR2LFS](#) [Y96D113G0FP LFS](#) [Y33A812C5FP LFT](#) [Y56B2D120FP](#)
[LFS](#) [PTS645 DVM83-BN125-2 LFS](#) [B3W 1000G](#) [KSC621G OL LFS](#)