

P.C.B LAND DIMENSION

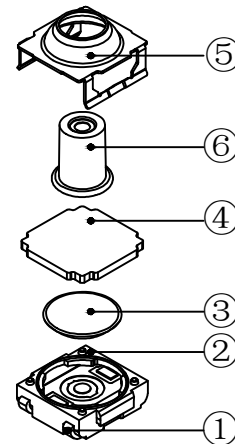

NOTES:

1. Rating: 12VDC 50mA
1. 额定值: 12VDC 50mA
2. Dielectric Strength: 250V AC
2. 耐电压: 250V AC
3. Contact Resistance: ≤100mΩ Max
3. 接触电阻: ≤100mΩ
4. Insulation Resistance: ≥100MΩ
4. 绝缘电阻: ≥100MΩ
5. Working temperature: -40 °C ~ +80 °C
5. 工作温度: -40 °C ~ +80 °C
6. Stroke: 0.40 ± 0.20mm
6. 行程: 0.40 ± 0.20mm
7. Waterproof grade: IP67
7. 防水等级: IP67
8. Operating Force: 160 ± 80gf
8. 操作力: 160 ± 80gf
9. Life: 300,000 times
9. 寿命: 300,000 次

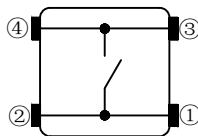
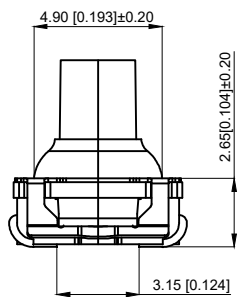

CIRCUIT DIAGRAM

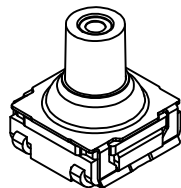
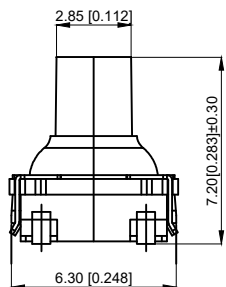

|          |                  |                |           |                  |
|----------|------------------|----------------|-----------|------------------|
| 6        | Stem<br>按钮       | LCP            | 1         | Black<br>黑色      |
| 5        | Cover<br>盖板      | SUS            | 1         |                  |
| 4        | Plunger<br>垫片    | RUBBER         | 1         | Sky Blue<br>天蓝色  |
| 3        | Shrapnel<br>弹片   | SUS            | 1         | Ag plating<br>镀银 |
| 2        | Pedestal<br>基座   | PA6T           | 1         | Black<br>黑色      |
| 1        | Terminal<br>端子   | Brass          | 1         | Ag plating<br>镀银 |
| NO<br>序号 | Part name<br>部件名 | Material<br>材料 | QTY<br>数量 | Remark<br>备注     |

|     |      |          |             |       |
|-----|------|----------|-------------|-------|
| A4  |      |          |             |       |
| A3  |      |          |             |       |
| A2  |      |          |             |       |
| A1  |      |          |             |       |
| REV | DATE | REVISION | DESCRIPTION | ISSUE |



COMMON TOLERANCE

|         |        |
|---------|--------|
| X.XX    | ± 0.10 |
| X.X     | ± 0.15 |
| X       | ± 0.25 |
| ANGULAR | —      |

|   |        |            |      |                      |
|---|--------|------------|------|----------------------|
| UNIT  | MM     | PROJECTED  |      | PRODUCT NAME:        |
| DRAWN BY  | FUYUAN | CHECKED BY | COCO | MODEL NO: TP14321672 |
| DATE  | 2019   | APPROVAL   | B    | Https: www.rocpcu.tw |
| <b>ROCPCU TECHNOLOGY CO.,LTD</b>  |        |            |      |                      |
| Copies are issued in strict confidence and shall not be reproduced or copied, or used as the basic of manufacture or sale of apparatus without permission |        |            |      |                      |

## X-ON Electronics

Largest Supplier of Electrical and Electronic Components

*Click to view similar products for [Tactile Switches](#) category:*

*Click to view products by [ROCPU Technology](#) manufacturer:*

Other Similar products are found below :

[5GTH92001](#) [5GTH9202242](#) [6407-250V-25273P](#) [ADTSA62NV](#) [ADTSA62RV](#) [B3F-3123](#) [1977177-8](#) [1977266-1](#) [ADTSA63NV](#)  
[ADTSM21NSVTR](#) [ADTSM25RVTR](#) [ADTSM32NVTR](#) [ADTSMW64RV](#) [FSMRA4JHA04](#) [GS4.70F300QP](#) [KSC241J SP DELTA LFS](#)  
[3FTL600RAS](#) [3FTL640RAS](#) [Y96K132V0FPLFS](#) [5GTH9658222](#) [ADTSM31NVTR](#) [2-1977120-7](#) [TSJW-5.2-260-TR](#) [KMT011MNGJLHS](#)  
[B3WN6002S](#) [70-201.0](#) [ADTSG648NV](#) [ADTSM62KSVTR](#) [ADTSM648NV](#) [95C06E3RAT](#) [5GTH96561](#) [3ATH9Q](#) [FSMRA8JHA04](#)  
[HARS0073](#) [Y33R411N9FPLFT](#) [Y31C01402FPLFS](#) [PTS645SK50SMTR92](#) [ADTSM32NVB](#) [KMS233GPWTLFG](#) [Y78B64124FP](#)  
[Y96D113G0FP LFS](#) [Y33A812C5FP LFT](#) [Y56B2D120FP LFS](#) [PTS645 DVM83-BN125-2 LFS](#) [B3W 1000G](#) [KSC621G OL LFS](#) [B3F 1002C](#)  
[B3F 0047H](#) [B3F 1000G](#) [B3W 1002C](#)