

Circuit diagram

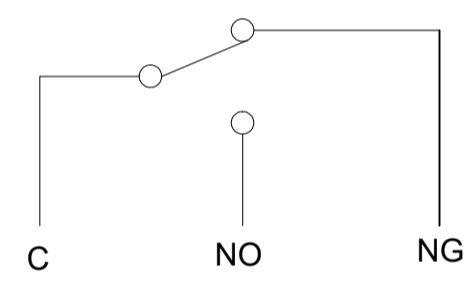

Technical Parameters

技术参数

- 1. Electrical Rating: 3A/12VDC; 0.1A/48vdc
- 1. 电气额定值: 3A/12VDC; 0.1A/48vdc
- 2. Electrical lifetime: 100,000 cycles
- 2. 电气寿命: 100,000 cycles
- 3. Mechanical lifetime: 100,000 cycles
- 3. 机械寿命: 100,000 cycles
- 4. Contact Resistance: ≤50mΩ
- 4. 接触电阻: ≤50兆欧
- 5. Operating force: 1.95N MAX
- 5. 操作力: 1.95N MAX
- 6. Free Position: 7.0mm
- 6. 自由位置: 7.0mm
- 7. Operation Position: 3.7±0.6mm
- 7. 动作位置: 3.7±0.6mm
- 8. Pretravel: 3.5mm
- 8. 动作行程: 3.5mm
- 9. Withstand Voltage: Feet and Feet 500V/5S/5mA  
Feet and Shell 1500/5S/5mA
- 9. 耐压: 脚与脚 500/5s/5mA  
脚与壳 1500/5S/5mA
- 10. Insulation Resistance: ≥100MΩ
- 10. 绝缘电阻: ≥100MΩ
- 11. Proof Tracking Index (PTI): 175V
- 11. 漏电起痕指数 (PTI): 175V
- 12. Ambient temperature: 125°
- 12. 环境温度: 125°
- 13. Waterproof grade: IP67
- 13. 防水等级: IP67
- 14. working temperature: -25~ + 105°C
- 14. 工作温度: -25~ + 105°C

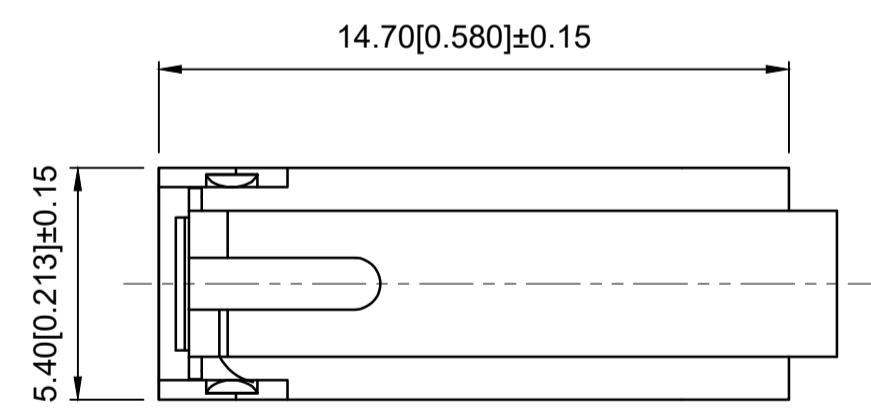

1	Rubber shell	PA66
2	Seal ring	Silica gel
3	Base	Brass+PA66
4	According to sincerity	Pom
5	Contact moving plate	Phosphor bronze
6	Strut	SUS

A4				
A3				
A2				
A1				
REV	DATE	REVISION	DESCRIPTION	ISSUE

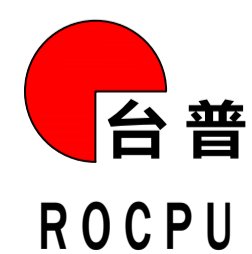

COMMON TOLERANCE	
X.XX	± 0.10
X.X	± 0.15
X	± 0.25
ANGULAR	—

UNIT	MM	PROJECTED		PRODUCT NAME:
DRAWN BY	FUYUAN	CHECKED BY	COCO	MODEL NO: TP3302111530
DATE	2019	APPROVAL B	ALEN	Https: www.rocpcu.tw

ROCPCU TECHNOLOGY CO., LTD

Copies are issued in strict confidence and shall not be reproduced or copied, or used as the basis of manufacture or sale of apparatus without permission

## X-ON Electronics

Largest Supplier of Electrical and Electronic Components

*Click to view similar products for [Basic / Snap Action Switches](#) category:*

*Click to view products by [ROCPU Technology](#) manufacturer:*

Other Similar products are found below :

[5SM901-S12](#) [5SM9-S12N195](#) [602EN532](#) [602EN535-RB](#) [602HE5-RB1](#) [604HE223-6B](#) [624HE17-RB](#) [6HM82](#) [6SE1](#) [6SX1-H58](#) [71051](#) [714-0293](#) [MBH2731](#) [79211923](#) [79218589](#) [MIL30126AB6BBMD4A12XAU](#) [ML-1155](#) [ML-1376](#) [831010C3.0](#) [831090C2.EL](#) [83131904](#) [84212012](#) [8AS239](#) [8HM73-3](#) [8SX26-H33](#) [914CE1-6G](#) [11SM1077-H4](#) [11SM1077-H58](#) [11SM1-TN107](#) [11SM405](#) [11SM703-T](#) [11SM8423-H2](#) [11SX37-T](#) [11SX48-H58](#) [11SM2442-T](#) [11SM76-T](#) [11SM77-H58](#) [11SM77-T](#) [11SM863-T](#) [11SM866](#) [121EN188-R](#) [1245.0120](#) [125EN56-RB](#) [D433V3RD](#) [1267.0101](#) [1267.7101](#) [D4BFC1](#) [12SM4-T2](#) [12SX2-T2](#) [1298.0101](#)