

A

B

C

D

E

F

G

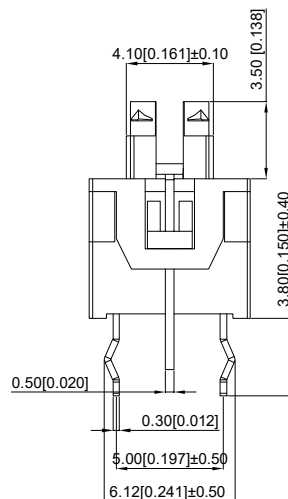
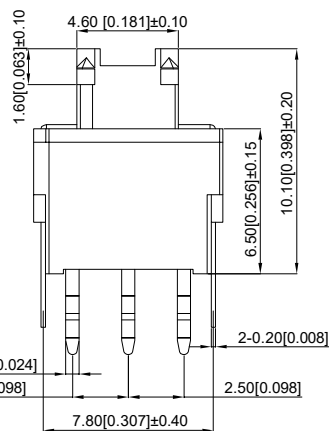
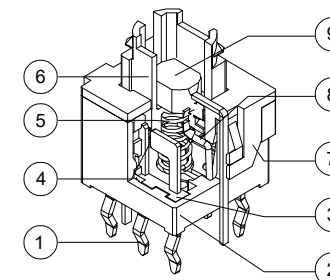
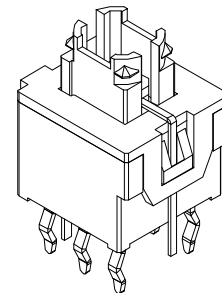
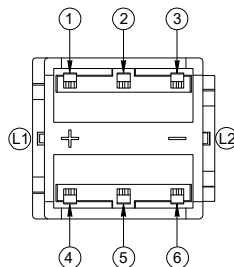
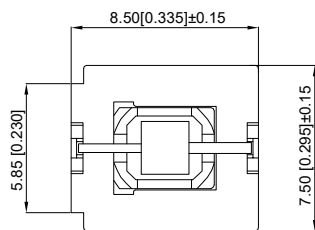

Technical parameter

技术参数

1. Rated current: DC12V 50mA
1. 额定电流: DC12V 50mA
2. Withstand voltage: AC250V (50-60Hz) for 1 minute
2. 耐压: AC250V(50-60Hz)持续1分钟
3. Contact impedance: 100M Ω Max
3. 接触阻抗: 100mΩmax
4. Insulation impedance: 100M Ω min.500v DC
4. 绝缘阻抗: 100MΩmin.500V DC
5. Operating force: 200 ± 100gf
5. 操作力: 200±100gf

6. Full stroke 2.0mm ± 0.4mm
6. 全行程2.0mm±0.4mm
7. Conduction stroke: 0.8mm ± 0.4mm
7. 导通行程0.8mm±0.4mm
8. Working temperature: -40 °C ~ +85 °C
8. 工作温度: -40℃~+85℃
9. Operation type: self-locking
9. 运行类型: 自锁
10. Service life: 10,000 times
10. 寿命: 10,000次

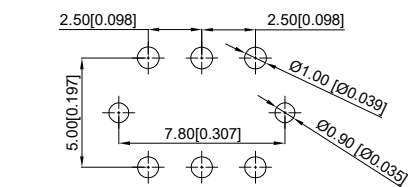

PCB LAYOUT

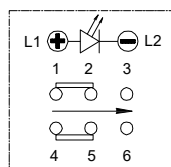

Circuit diagram

9	LED		1	Red 红灯
8	Crochet hook 钩针	Steel wire 钢丝	1	
7	Cover 盖板	POM	1	Black 黑色
6	Guide core 导芯	POM	1	White 白色
5	Spring 弹簧	Steel wire 钢丝	1	
4	Reed 簧片	Phosphor copper 磷铜	2	Ag plating 镀银
3	Injection molding terminal 注塑端子	PA66	2	Black 黑色
2	Base 底座	PA66	1	Black 黑色
1	Terminal 端子	Brass 黄铜	6	Ag plating 镀银
NO 序号	Part name 部件名	Material 材料	QTY 数量	Remark 备注

A4				
A3				
A2				
A1				
REV	DATE	REVISION	DESCRIPTION	ISSUE



COMMON TOLERANCE

X.XX	± 0.10
X.X	± 0.15
X	± 0.25
ANGULAR	—

UNIT

MM

PROJECTED



PRODUCT NAME:

DRAWN BY

FUYUAN

CHECKED BY

COCO

MODEL NO: TP5851111010

DATE

2019

APPROVAL B

ALEN

Https: www.rocpu.tw

ROCPU TECHNOLOGY CO.,LTD

Copies are issued in strict confidence and shall not be reproduced or copied, or used as the basis of manufacture or sale of apparatus without permission

X-ON Electronics

Largest Supplier of Electrical and Electronic Components

Click to view similar products for [Pushbutton Switches](#) category:

Click to view products by [ROCPU Technology](#) manufacturer:

Other Similar products are found below :

[8971K1133](#) [LW2L-M1C20M-A](#) [M22-D-R-GB0/K11](#) [67021K512](#) [701PB580](#) [7199K101](#) [810K12910](#) [810KSV30B](#) [FLT 2U EE 01A](#)
[MML21EA2ADK](#) [MML21KA3ABK](#) [MML23KA3AC05K-001](#) [MML23KW3AA01W](#) [8418K2](#) [8442K3](#) [8450K1](#) [860K11911T01A](#) [861901](#)
[861K11911T01A07](#) [861K13810T00A14](#) [861K13911](#) [8646AB6X718UL](#) [9533CD4+U574+U4922](#) [99-450.837](#) [99-453.837](#)
[A2PMA1X03EC56](#) [A3A-7310](#) [A3A-7340](#) [12037A2ULCSA](#) [1203A2UL](#) [ABGW410-R](#) [1211390004](#) [ABN400-R](#) [121382](#) [1213C3](#) [HE3B-M2](#)
[1211500044](#) [121194](#) [1212MRA](#) [1232A6NF](#) [1241.1183.7047](#) [121489](#) [1223A2ULCSA](#) [1241.1183.8000](#) [1241.1183.8029](#) [D5P-MT4](#)
[13435AG](#) [13445AD29GX768](#) [AG23-L2](#) [AH165-2SGLG1TE3](#)