

TXW series

105°C 長寿命(7000~12000時間) 小形化品 -40°C対応
105°C 7000~12000 hours, Miniaturized, -40°C~105°C



◆規格表/SPECIFICATIONS

| 項目 Item | 特性 Characteristics | | | | | | | | | | |
|--|--|--|--|------|------|---|----------|---------|---------------------|----------------------|------------|
| カテゴリ温度範囲 Category Temperature Range | -40~+105°C | | | | | | | | | | |
| 定格電圧範囲 Rated Voltage Range | 35~100Vdc | 160~450Vdc | | | | | | | | | |
| 静電容量許容差 Capacitance Tolerance | ±20%(20°C, 120Hz) | | | | | | | | | | |
| 漏れ電流 Leakage Current (MAX) | 35~100Vdc | 160~450Vdc | | | | | | | | | |
| | I=0.01CV又は3µAのいずれか大なる値以下 (定格電圧印加2分後) I=0.01CV or 3µA whichever is greater. (After 2 minutes) | I=3√CV以下(定格電圧印加5分後) I=3√CV (After 5 minutes application of rated voltage) | | | | | | | | | |
| I=漏れ電流(µA) C=静電容量(µF) V=定格電圧(Vdc) Leakage Current Capacitance Rated Voltage | | | | | | | | | | | |
| 損失角の正接(tan δ) Dissipation Factor (MAX) | 定格電圧(Vdc) Rated Voltage | | | | | | | | (20°C, 120Hz) | | |
| | 35 | 50 | 63 | 80 | 100 | 160~400 | 420, 450 | | | | |
| | | tan δ | 0.12 | 0.10 | 0.09 | 0.08 | 0.08 | 0.20 | 0.25 | | |
| 耐久性 Endurance | 105°C中で右表の時間定格電圧(リプル重畳)印加後、下記項目を満足すること。 After applying rated voltage with rated ripple current for specified time at 105°C, the capacitors shall meet the following requirements. | | | | | | | | | | |
| | | | 35~100Vdc | | | 160~450Vdc | | | ケースサイズ Case Size | 時間(hrs) Time(hrs) | |
| | 静電容量変化率 Capacitance Change | | 初期値の±25%以内 Within ±25% of the initial value. | | | 初期値の±20%以内 Within ±20% of the initial value. | | | | 35~100Vdc | 160~450Vdc |
| | 損失角の正接 Dissipation Factor | | 規格値の200%以下 Not more than 200% of the specified value. | | | | | | | | |
| 漏れ電流 Leakage Current | | 規格値以下 Not more than the specified value. | | | | | | | | | |
| 低温特性 Low Temperature Stability (インピーダンス比) Impedance Ratio (MAX) | 定格電圧(Vdc) Rated Voltage | | 35 | 50 | 63 | 80 | 100 | 160~250 | 350, 400 | 420, 450 | (120Hz) |
| | Z(-25°C)/Z(+20°C) | | 2 | 2 | 2 | 2 | 2 | 3 | 5 | 6 | |
| | Z(-40°C)/Z(+20°C) | | 3 | 3 | 3 | 3 | 3 | - | - | - | |

◆呼称方法/PART NUMBER

□□□ TXW □□□□□ M □□□ □□ D x L
 定格電圧 シリーズ名 静電容量 静電容量許容差 副記号 リード加工記号 ケースサイズ
 Rated Voltage Series Capacitance Capacitance Tolerance Option Lead Forming Case Size

◆副記号/OPTION

35~100Vdc : EFC
160~450Vdc : EFR

◆リプル電流補正係数/MULTIPLIER FOR RIPPLE CURRENT

| 35~100Vdc | | | | | | 160~450Vdc | | | | | | |
|-------------------|------------|------|------|------|------|-------------------|------------|------|------|------|------|------|
| Frequency (Hz) | 120 | 1k | 10k | 100k | ≤ | Frequency (Hz) | 60(50) | 120 | 500 | 1k | 10k | ≤ |
| 係数 Coefficient | 33µF | 0.42 | 0.70 | 0.90 | 1.00 | 係数 Coefficient | 160~250Vdc | 0.80 | 1.00 | 1.20 | 1.30 | 1.40 |
| | 39~270µF | 0.50 | 0.73 | 0.92 | 1.00 | | 350~450Vdc | 0.80 | 1.00 | 1.25 | 1.40 | 1.50 |
| | 330~680µF | 0.55 | 0.77 | 0.94 | 1.00 | | | | | | | |
| | 820~1800µF | 0.60 | 0.80 | 0.96 | 1.00 | | | | | | | |

◆寸法図／DIMENSIONS

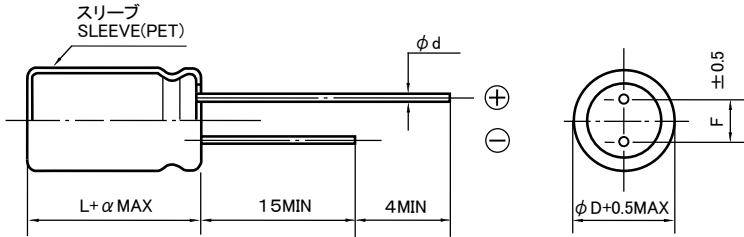

(mm)

| | | | | | | |
|-----|------------|-----|-----|------|-----|----|
| φ D | 6.3 | 8 | 10 | 12.5 | 16 | 18 |
| φ d | 0.5 | 0.6 | | | 0.8 | |
| F | 2.5 | 3.5 | 5.0 | | 7.5 | |
| α | 35~100Vdc | 2.0 | | | - | |
| | 160~450Vdc | - | 2.5 | | | |

◆標準品一覧表／STANDARD SIZE

Rated Ripple Current (A r.m.s./105°C)

| 定格電圧 Rated Voltage (Vdc) | 静電容量 Capacitance (μF) | 外形寸法 Size φD×L (mm) | 定格リップル電流 Rated Ripple Current | |
|--------------------------------|-----------------------------|---------------------------|----------------------------------|--------|
| | | | 120Hz | 100kHz |
| 35 | 180 | 6.3×25 | 0.605 | 1.21 |
| | 220 | 6.3×30 | 0.685 | 1.37 |
| | 330 | 6.3×40 | 0.924 | 1.68 |
| | 390 | 6.3×50 | 1.11 | 2.02 |
| | 390 | 8×25 | 0.951 | 1.73 |
| | 470 | 8×30 | 1.11 | 2.03 |
| | 680 | 8×40 | 1.41 | 2.57 |
| | 820 | 8×50 | 1.82 | 3.04 |
| | 820 | 10×30 | 1.48 | 2.47 |
| | 1000 | 8×60 | 2.08 | 3.48 |
| | 1200 | 10×40 | 1.87 | 3.12 |
| | 1500 | 10×50 | 2.21 | 3.69 |
| 1800 | 10×60 | 2.50 | 4.17 | |
| 50 | 100 | 6.3×25 | 0.51 | 1.02 |
| | 120 | 6.3×30 | 0.58 | 1.16 |
| | 180 | 6.3×40 | 0.71 | 1.42 |
| | 220 | 6.3×50 | 0.86 | 1.72 |
| | 220 | 8×25 | 0.74 | 1.48 |
| | 270 | 8×30 | 0.87 | 1.74 |
| | 390 | 8×40 | 1.22 | 2.23 |
| | 470 | 8×50 | 1.45 | 2.65 |
| | 470 | 10×30 | 1.22 | 2.22 |
| | 560 | 8×60 | 1.68 | 3.07 |
| | 680 | 10×40 | 1.55 | 2.82 |
| | 820 | 10×50 | 2.02 | 3.37 |
| | 1000 | 10×60 | 2.31 | 3.86 |
| | 63 | 82 | 6.3×25 | 0.455 |
| 100 | | 6.3×30 | 0.515 | 1.03 |
| 150 | | 6.3×40 | 0.635 | 1.27 |
| 180 | | 6.3×50 | 0.775 | 1.55 |
| 180 | | 8×25 | 0.665 | 1.33 |
| 220 | | 8×30 | 0.785 | 1.57 |
| 330 | | 8×40 | 1.11 | 2.02 |
| 390 | | 8×50 | 1.32 | 2.41 |
| 390 | | 10×30 | 1.16 | 2.10 |
| 470 | | 8×60 | 1.54 | 2.80 |
| 560 | | 10×40 | 1.43 | 2.60 |
| 680 | | 10×50 | 1.71 | 3.12 |
| 820 | | 10×60 | 2.15 | 3.59 |
| 80 | | 47 | 6.3×25 | 0.455 |
| | 56 | 6.3×30 | 0.515 | 1.03 |
| | 82 | 6.3×40 | 0.635 | 1.27 |
| | 100 | 6.3×50 | 0.775 | 1.55 |
| | 100 | 8×25 | 0.665 | 1.33 |
| | 120 | 8×30 | 0.785 | 1.57 |
| | 180 | 8×40 | 1.01 | 2.02 |
| | 220 | 8×50 | 1.20 | 2.41 |
| | 220 | 10×30 | 1.05 | 2.10 |
| | 270 | 8×60 | 1.40 | 2.80 |
| | 270 | 10×40 | 1.30 | 2.60 |

| 定格電圧 Rated Voltage (Vdc) | 静電容量 Capacitance (μF) | 外形寸法 Size φD×L (mm) | 定格リップル電流 Rated Ripple Current | |
|--------------------------------|-----------------------------|---------------------------|----------------------------------|--------|
| | | | 120Hz | 100kHz |
| 80 | 390 | 10×50 | 1.71 | 3.12 |
| | 470 | 10×60 | 1.97 | 3.59 |
| 100 | 33 | 6.3×25 | 0.382 | 0.91 |
| | 39 | 6.3×30 | 0.515 | 1.03 |
| | 56 | 6.3×40 | 0.635 | 1.27 |
| | 68 | 6.3×50 | 0.775 | 1.55 |
| | 82 | 8×25 | 0.665 | 1.33 |
| | 100 | 8×30 | 0.785 | 1.57 |
| | 120 | 8×40 | 1.01 | 2.02 |
| | 150 | 8×50 | 1.20 | 2.41 |
| | 150 | 10×30 | 1.05 | 2.10 |
| | 220 | 8×60 | 1.40 | 2.80 |
| | 220 | 10×40 | 1.30 | 2.60 |
| | 270 | 10×50 | 1.56 | 3.12 |
| | 330 | 10×60 | 1.97 | 3.59 |
| | 160 | 56 | 8×25 | 0.32 |
| 68 | | 8×30 | 0.37 | 0.518 |
| 82 | | 8×35 | 0.43 | 0.602 |
| 82 | | 10×25 | 0.43 | 0.602 |
| 100 | | 8×40 | 0.49 | 0.686 |
| 120 | | 8×55 | 0.57 | 0.798 |
| 120 | | 10×30 | 0.54 | 0.756 |
| 150 | | 10×40 | 0.67 | 0.938 |
| 150 | | 12.5×25 | 0.66 | 0.924 |
| 180 | | 10×50 | 0.80 | 1.12 |
| 180 | | 12.5×30 | 0.77 | 1.07 |
| 220 | | 10×60 | 0.94 | 1.31 |
| 220 | | 12.5×35 | 0.89 | 1.24 |
| 220 | | 16×25 | 0.93 | 1.30 |
| 270 | | 12.5×40 | 1.01 | 1.41 |
| 330 | | 12.5×50 | 1.20 | 1.68 |
| 330 | | 16×30 | 1.20 | 1.68 |
| 330 | | 18×25 | 1.18 | 1.65 |
| 390 | 12.5×55 | 1.35 | 1.89 | |
| 390 | 16×35 | 1.34 | 1.87 | |
| 390 | 18×30 | 1.40 | 1.96 | |
| 470 | 16×40 | 1.52 | 2.12 | |
| 470 | 18×35 | 1.58 | 2.21 | |
| 560 | 16×50 | 1.79 | 2.50 | |
| 560 | 18×40 | 1.78 | 2.49 | |
| 680 | 18×45 | 2.00 | 2.80 | |
| 820 | 18×50 | 2.23 | 3.12 | |
| 200 | 39 | 8×25 | 0.30 | 0.42 |
| | 56 | 8×30 | 0.37 | 0.518 |
| | 68 | 8×40 | 0.45 | 0.63 |
| | 68 | 10×25 | 0.43 | 0.602 |
| | 82 | 8×45 | 0.51 | 0.714 |
| | 82 | 10×30 | 0.50 | 0.70 |
| | 100 | 8×55 | 0.60 | 0.84 |
| | 100 | 10×40 | 0.63 | 0.882 |

◆標準品一覧表／STANDARD SIZE

| 定格電圧 Rated Voltage (Vdc) | 静電容量 Capacitance (μ F) | 外形寸法 Size ϕ DxL (mm) | 定格リプル電流 RatedRipple Current | |
|--------------------------------|-----------------------------------|---------------------------------|--------------------------------|--------|
| | | | 120Hz | 100kHz |
| 200 | 120 | 10×45 | 0.75 | 1.05 |
| | 120 | 12.5×25 | 0.65 | 0.91 |
| | 150 | 10×50 | 0.83 | 1.16 |
| | 150 | 12.5×30 | 0.8 | 1.12 |
| | 180 | 10×60 | 0.91 | 1.27 |
| | 180 | 12.5×35 | 0.92 | 1.28 |
| | 180 | 16×25 | 0.85 | 1.19 |
| | 220 | 12.5×45 | 1.09 | 1.52 |
| | 220 | 16×30 | 1.01 | 1.41 |
| | 220 | 18×25 | 1.00 | 1.40 |
| | 270 | 12.5×50 | 1.26 | 1.76 |
| | 270 | 16×30 | 1.18 | 1.65 |
| | 270 | 18×30 | 1.16 | 1.62 |
| | 330 | 12.5×60 | 1.36 | 1.90 |
| | 330 | 16×40 | 1.31 | 1.83 |
| | 330 | 18×30 | 1.30 | 1.82 |
| | 390 | 16×45 | 1.43 | 2.00 |
| | 390 | 18×35 | 1.43 | 2.00 |
| 470 | 16×50 | 1.58 | 2.21 | |
| 470 | 18×40 | 1.58 | 2.21 | |
| 560 | 18×45 | 1.77 | 2.47 | |
| 220 | 100 | 10×40 | 0.66 | 0.924 |
| | 120 | 10×45 | 0.75 | 1.05 |
| | 120 | 12.5×30 | 0.74 | 1.03 |
| | 150 | 12.5×35 | 0.86 | 1.20 |
| | 150 | 16×25 | 0.80 | 1.12 |
| | 180 | 12.5×40 | 0.99 | 1.38 |
| | 180 | 16×30 | 0.94 | 1.31 |
| | 220 | 12.5×50 | 1.08 | 1.51 |
| | 220 | 16×30 | 1.01 | 1.41 |
| | 220 | 18×25 | 0.94 | 1.31 |
| | 270 | 16×35 | 1.19 | 1.66 |
| | 270 | 18×30 | 1.13 | 1.58 |
| | 330 | 18×35 | 1.3 | 1.82 |
| | 390 | 18×40 | 1.49 | 2.08 |
| 470 | 18×45 | 1.69 | 2.36 | |
| 250 | 27 | 8×25 | 0.30 | 0.42 |
| | 39 | 8×30 | 0.37 | 0.518 |
| | 47 | 8×35 | 0.45 | 0.63 |
| | 47 | 10×25 | 0.37 | 0.518 |
| | 56 | 8×40 | 0.51 | 0.714 |
| | 56 | 10×30 | 0.42 | 0.588 |
| | 68 | 8×50 | 0.59 | 0.826 |
| | 68 | 10×35 | 0.49 | 0.686 |
| | 82 | 10×40 | 0.61 | 0.854 |
| | 82 | 12.5×25 | 0.54 | 0.756 |
| | 100 | 10×45 | 0.68 | 0.952 |
| | 100 | 12.5×30 | 0.69 | 0.966 |
| | 120 | 10×55 | 0.73 | 1.02 |
| | 120 | 12.5×35 | 0.79 | 1.10 |
| | 120 | 16×25 | 0.74 | 1.03 |
| | 150 | 12.5×40 | 0.92 | 1.28 |
| | 150 | 16×30 | 0.89 | 1.24 |
| | 180 | 12.5×50 | 0.97 | 1.35 |
| | 180 | 16×30 | 0.95 | 1.33 |
| | 180 | 18×25 | 0.88 | 1.23 |
| 220 | 12.5×55 | 1.13 | 1.58 | |
| 220 | 16×35 | 1.11 | 1.55 | |
| 220 | 18×30 | 1.10 | 1.54 | |
| 270 | 16×40 | 1.27 | 1.77 | |

Rated Ripple Current (A r.m.s./105°C)

| 定格電圧 Rated Voltage (Vdc) | 静電容量 Capacitance (μ F) | 外形寸法 Size ϕ DxL (mm) | 定格リプル電流 RatedRipple Current | |
|--------------------------------|-----------------------------------|---------------------------------|--------------------------------|--------|
| | | | 120Hz | 100kHz |
| 250 | 270 | 18×35 | 1.23 | 1.72 |
| | 330 | 16×50 | 1.48 | 2.07 |
| | 330 | 18×40 | 1.42 | 1.98 |
| | 390 | 18×45 | 1.59 | 2.22 |
| | 470 | 18×50 | 1.83 | 2.56 |
| | 350 | 22 | 8×30 | 0.25 |
| 27 | | 8×35 | 0.29 | 0.435 |
| 33 | | 8×40 | 0.33 | 0.495 |
| 33 | | 10×25 | 0.31 | 0.465 |
| 39 | | 8×45 | 0.37 | 0.555 |
| 39 | | 10×30 | 0.36 | 0.54 |
| 47 | | 8×60 | 0.43 | 0.645 |
| 47 | | 10×35 | 0.41 | 0.615 |
| 56 | | 10×40 | 0.47 | 0.705 |
| 68 | | 10×55 | 0.55 | 0.825 |
| 12 | | 8×25 | 0.17 | 0.255 |
| 15 | | 8×30 | 0.20 | 0.300 |
| 18 | | 8×35 | 0.23 | 0.345 |
| 22 | | 8×40 | 0.26 | 0.39 |
| 22 | 10×25 | 0.24 | 0.36 | |
| 27 | 8×45 | 0.30 | 0.45 | |
| 27 | 10×30 | 0.29 | 0.435 | |
| 33 | 8×55 | 0.35 | 0.525 | |
| 33 | 10×35 | 0.33 | 0.495 | |
| 39 | 10×40 | 0.40 | 0.60 | |
| 39 | 12.5×25 | 0.36 | 0.54 | |
| 47 | 10×45 | 0.45 | 0.675 | |
| 47 | 12.5×30 | 0.44 | 0.66 | |
| 56 | 10×50 | 0.52 | 0.78 | |
| 56 | 12.5×35 | 0.50 | 0.75 | |
| 68 | 12.5×40 | 0.58 | 0.87 | |
| 68 | 16×25 | 0.51 | 0.765 | |
| 82 | 12.5×45 | 0.65 | 0.975 | |
| 82 | 16×30 | 0.61 | 0.915 | |
| 82 | 18×25 | 0.61 | 0.915 | |
| 100 | 12.5×60 | 0.75 | 1.12 | |
| 100 | 16×35 | 0.74 | 1.11 | |
| 100 | 18×30 | 0.74 | 1.11 | |
| 120 | 16×40 | 0.80 | 1.20 | |
| 120 | 18×35 | 0.79 | 1.18 | |
| 150 | 16×50 | 0.95 | 1.42 | |
| 150 | 18×40 | 0.91 | 1.36 | |
| 180 | 18×45 | 1.04 | 1.56 | |
| 400 | 12 | 8×30 | 0.13 | 0.195 |
| | 15 | 8×35 | 0.17 | 0.255 |
| | 18 | 8×40 | 0.20 | 0.30 |
| | 22 | 8×50 | 0.25 | 0.375 |
| | 33 | 10×40 | 0.37 | 0.555 |
| | 39 | 10×45 | 0.41 | 0.615 |
| | 39 | 12.5×30 | 0.39 | 0.585 |
| | 47 | 12.5×35 | 0.45 | 0.675 |
| | 56 | 12.5×40 | 0.52 | 0.78 |
| | 56 | 16×25 | 0.46 | 0.69 |
| | 68 | 12.5×45 | 0.58 | 0.87 |
| | 68 | 16×30 | 0.55 | 0.825 |
| | 82 | 12.5×50 | 0.66 | 0.990 |
| | 82 | 16×35 | 0.63 | 0.945 |
| | 82 | 18×25 | 0.56 | 0.84 |
| | 100 | 16×40 | 0.73 | 1.09 |
| | 100 | 18×30 | 0.67 | 1.00 |
| | 420 | 12 | 8×30 | 0.13 |
| 15 | | 8×35 | 0.17 | 0.255 |
| 18 | | 8×40 | 0.20 | 0.30 |
| 22 | | 8×50 | 0.25 | 0.375 |
| 33 | | 10×40 | 0.37 | 0.555 |
| 39 | | 10×45 | 0.41 | 0.615 |
| 39 | | 12.5×30 | 0.39 | 0.585 |
| 47 | | 12.5×35 | 0.45 | 0.675 |
| 56 | | 12.5×40 | 0.52 | 0.78 |
| 56 | | 16×25 | 0.46 | 0.69 |
| 68 | | 12.5×45 | 0.58 | 0.87 |
| 68 | | 16×30 | 0.55 | 0.825 |
| 82 | | 12.5×50 | 0.66 | 0.990 |
| 82 | | 16×35 | 0.63 | 0.945 |
| 82 | | 18×25 | 0.56 | 0.84 |
| 100 | | 16×40 | 0.73 | 1.09 |
| 100 | | 18×30 | 0.67 | 1.00 |

◆標準品一覧表／STANDARD SIZE

Rated Ripple Current(A r.m.s./105°C)

| 定格電圧 Rated Voltage (Vdc) | 静電容量 Capacitance (μ F) | 外形寸法 Size ϕ DxL (mm) | 定格リップル電流 RatedRipple Current | |
|--------------------------------|-----------------------------------|---------------------------------|------------------------------------|--------|
| | | | 120Hz | 100kHz |
| 420 | 120 | 18×35 | 0.77 | 1.15 |
| | 150 | 18×40 | 0.90 | 1.35 |
| 450 | 12 | 8×30 | 0.15 | 0.225 |
| | 15 | 8×40 | 0.19 | 0.285 |
| | 18 | 8×45 | 0.21 | 0.315 |
| | 33 | 10×40 | 0.36 | 0.540 |
| | 33 | 12.5×30 | 0.37 | 0.555 |
| | 39 | 10×50 | 0.41 | 0.615 |
| | 39 | 12.5×35 | 0.42 | 0.63 |
| | 47 | 12.5×40 | 0.48 | 0.72 |
| | 47 | 16×25 | 0.44 | 0.66 |
| | 56 | 12.5×45 | 0.53 | 0.795 |
| | 56 | 16×30 | 0.51 | 0.765 |
| | 68 | 12.5×50 | 0.62 | 0.930 |
| | 68 | 16×35 | 0.59 | 0.885 |
| | 68 | 18×25 | 0.57 | 0.855 |
| | 82 | 16×40 | 0.68 | 1.020 |
| | 82 | 18×30 | 0.65 | 0.975 |
| 100 | 18×35 | 0.74 | 1.11 | |
| 120 | 18×40 | 0.83 | 1.24 | |
| 150 | 18×45 | 0.95 | 1.42 | |

X-ON Electronics

Largest Supplier of Electrical and Electronic Components

Click to view similar products for [Aluminium Electrolytic Capacitors - Radial Leaded](#) category:

Click to view products by [Rubycon](#) manufacturer:

Other Similar products are found below :

[LXY50VB4.7M-5X11](#) [RFO-100V471MJ7P#](#) [ECE-A1EGE220](#) [B41041A2687M8](#) [B41041A7226M8](#) [B41044A7157M6](#)
[EKXG201EC3101ML20S](#) [EKZM160ETD471MHB5D](#) [NCD681K10KVY5PF](#) [NEV1000M25EF-BULK](#) [NEV100M35DC](#) [NEV100M63DE](#)
[NEV220M25DD-BULK](#) [NEV.33M100AA](#) [NEV4700M50HB](#) [NEV.47M100AA](#) [NEVH1.0M250AB](#) [NEVH3.3M250BB](#) [NEVH3.3M450CC](#)
[KM4700/16](#) [KME50VB100M-8X11.5](#) [SG220M1CSA-0407](#) [ES5107M016AE1DA](#) [ESMG160ETD102MJ16S](#) [ESX472M16B](#) [227RZS050M](#)
[476CKH100MSA](#) [477RZS050M](#) [UVX1V101KPA1FA](#) [UVX1V222MHA1CA](#) [KME25VB100M-6.3X11](#) [VTL100S10](#) [VTL470S10](#)
[VTL470S16A](#) [511D336M250EK5D](#) [052687X](#) [ECE-A1CF471](#) [EKMA500ELL4R7ME07D](#) [NRE-S560M16V6.3X7TBSTF](#) [RGA221M1CTA-](#)
[0611G](#) [ERZA630VHN182UP54N](#) [UPL1A331MPH](#) [SK035M0100AZS-0611](#) [MAL214658821E3](#) [NEV1000M6.3DE](#) [NEV100M16CB](#)
[NEV100M50DD-BULK](#) [NEV2200M16FF](#) [NEV220M50EE](#) [NEV2.2M50AA](#)