

REED SWITCH MKA-50202

CONTACT FORM A NORMALLY OPEN CONTACTS

Switching current 5 A

Switching power 250 W, VA

Switching voltage 250 V

Pull in range 40...100 AT

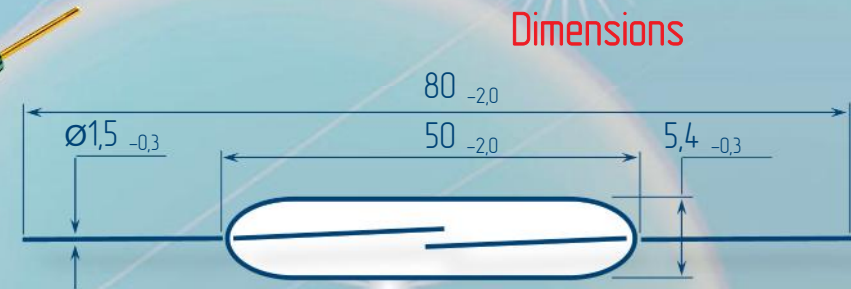
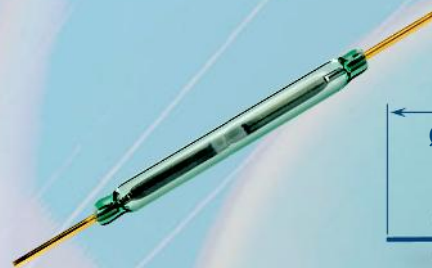

Electrical Data

| | |
|---|--|
| Release range, AT, min | 16 |
| Carry current, A | 5 |
| Breakdown voltage, V, not less, AC/DC | less 50 A more 50 A 360/500 500/700 |
| Resetting Ratio | 0,4...0,9 |
| Contact resistance, Ω, not more | 0,15 |
| Operating time including bounce, ms, not more | 2 |
| Release time including bounce ms, not more | 1 |
| Capacitance, pF, not more | 1 |
| Insulation resistance, GΩ, not less | 1 |
| Operating frequency, Hz | 25 |
| Switching current frequency, kHz, not more | 10 |

Environmental Data

| | |
|--|-----------|
| Contact material | Mo |
| Life expectancy, switching cycles x10 ⁶ max load power... low load power | 0,005...2 |
| Vibration (1...500 Hz), g, not more | 10 |
| Resonant frequency, Hz | 700 |
| Shock (1±0,3) ms, g, not more | 150 |
| Weight, g, not more | 2,0 |
| Operating temperature, °C | -60...100 |
| Humidity, %, not more | 98 |

Certificates



Test Coil

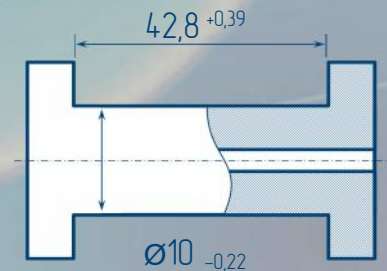

5000 turns, wire Ø0,112 mm
coil resistance 335

Order information

Delivery of reed switches with formed and/or cropped leads and with narrow pull in ranges is available by agreements.



RYAZAN METAL CERAMICS INSTRUMENTATION PLANT, JSC
51V, Novaya St., 390027, Ryazan, Russia
Phone: +7 (4912) 240-234, Факс: +7 (4912) 240-234 E-mail: ives@rmcip.ru

Update on 19 November 2013



X-ON Electronics

Largest Supplier of Electrical and Electronic Components

Click to view similar products for [Board Mount Hall Effect/Magnetic Sensors](#) category:

Click to view products by [Ryazan](#) manufacturer:

Other Similar products are found below :

[HGPRDT005A](#) [AH1894-FA-7](#) [AH277AZ4-AG1](#) [AV-10448](#) [SS41C](#) [AH1894-Z-7](#) [TLE4946-1L](#) [TLE4976L](#) [SS85CA](#) [BU52003GUL-E2](#)
[AH277AZ4-BG1](#) [AH3376-P-B](#) [TLE4941](#) [TLE4945-2L](#) [AH3360-FT4-7](#) [TLE4941-1](#) [AH374-P-A](#) [SS41-JL](#) [AH1913-W-7](#) [AH3373-P-B](#)
[MA732GQ-Z](#) [MA330GQ-Z](#) [S-57K1NBL2A-M3T2U](#) [S-57P1NBL9S-M3T4U](#) [S-576ZNL2B-L3T2U](#) [S-576ZNL2B-A6T8U](#) [S-57P1NBL0S-](#)
[M3T4U](#) [S-57A1NSL1A-M3T2U](#) [S-57K1RBL1A-M3T2U](#) [S-57P1NBH9S-M3T4U](#) [S-57P1NBH0S-M3T4U](#) [S-57A1NSH1A-M3T2U](#) [S-](#)
[57A1NSH2A-M3T2U](#) [S-57K1NBH1A-M3T2U](#) [S-57A1NNL1A-M3T2U](#) [S-5701BC11B-L3T2U5](#) [S-57GNNL3S-A6T8U](#) [S-57TZ1L1S-](#)
[A6T8U](#) [S-57GSNL3S-A6T8U](#) [S-5716ANDH0-I4T1U](#) [S-57GSNL5S-L3T2U](#) [S-57GDNL3S-L3T2U](#) [S-57GNNL3S-L3T2U](#) [S-57RBNL8S-](#)
[L3T2U](#) [S-57RBNL9S-A6T8U](#) [S-57RB1L8S-L3T2U](#) [S-57GDNL5S-L3T2U](#) [S-57RBNL9S-L3T2U](#) [S-57TZ1L1S-L3T2U](#) [S-57TZNL1S-](#)
[A6T8U](#)