

REED SWITCH MKC-27103

CONTACT FORM C TRANSFER

Switching current 1 A

Switching power 30 W, VA

Switching voltage 220 V

Pull in range 40...90 AT

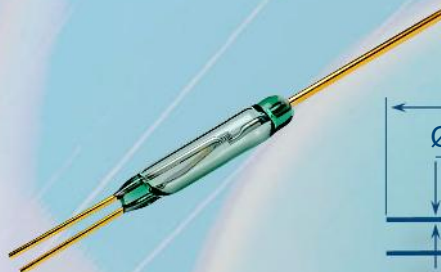

Dimensions



Electrical Data

Release range, AT, min	14
Carry current, A	1
Breakdown voltage	less 50 A more 50 A
V, not less, AC/DC	160/220 250/350
Resetting Ratio	0,35...0,9
Contact resistance, Ω, not more	0,15
Operating time including bounce, ms, not more	1,5
Release time including bounce ms, not more	2,5
Capacitance, pF, not more	3,0(N.C.) 1,5 (N.O.)
Insulation resistance, GΩ, not less	0,5 (N.C.) 1 (N.O.)
Operating frequency, Hz	50
Switching current frequency, kHz, not more	10

Environmental Data

Contact material	Ru
Life expectancy, switching cycles x10 ⁶ max load power... low load power	0,01...5
Vibration (1...2000 Hz), g, not more	10
Resonant frequency, Hz	2200
Shock (1±0,3) ms, g, not more	150
Weight, g, not more	1,5
Operating temperature, °C	-60...125
Humidity, %, not more	98

Certificates



Test Coil

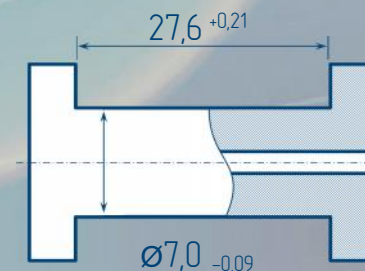

5000 turns, wire Ø0.08 mm
coil resistance 450

Order information

Delivery of reed switches with formed and/or cropped leads and with narrow pull in ranges is available by agreements.



RYAZAN METAL CERAMICS INSTRUMENTATION PLANT, JSC
51V, Novaya St., 390027, Ryazan, Russia
Phone: +7 (4912) 240-234, Факс: +7 (4912) 240-234 E-mail: oves@rmcip.ru

Update on 27 November 2013



X-ON Electronics

Largest Supplier of Electrical and Electronic Components

Click to view similar products for [Board Mount Hall Effect/Magnetic Sensors](#) category:

Click to view products by [Ryazan](#) manufacturer:

Other Similar products are found below :

[HGPRDT005A](#) [AH1894-FA-7](#) [AH277AZ4-AG1](#) [AV-10448](#) [SS41C](#) [AH1894-Z-7](#) [TLE4946-1L](#) [TLE4976L](#) [SS85CA](#) [BU52003GUL-E2](#)
[AH277AZ4-BG1](#) [AH3376-P-B](#) [TLE4941](#) [TLE4945-2L](#) [AH3360-FT4-7](#) [TLE4941-1](#) [AH374-P-A](#) [SS41-JL](#) [AH1913-W-7](#) [AH3373-P-B](#)
[MA732GQ-Z](#) [MA330GQ-Z](#) [S-57K1NBL2A-M3T2U](#) [S-57P1NBL9S-M3T4U](#) [S-576ZNL2B-L3T2U](#) [S-576ZNL2B-A6T8U](#) [S-57P1NBL0S-](#)
[M3T4U](#) [S-57A1NSL1A-M3T2U](#) [S-57K1RBL1A-M3T2U](#) [S-57P1NBH9S-M3T4U](#) [S-57P1NBH0S-M3T4U](#) [S-57A1NSH1A-M3T2U](#) [S-](#)
[57A1NSH2A-M3T2U](#) [S-57K1NBH1A-M3T2U](#) [S-57A1NNL1A-M3T2U](#) [S-5701BC11B-L3T2U5](#) [S-57GNNL3S-A6T8U](#) [S-57TZ1L1S-](#)
[A6T8U](#) [S-57GSNL3S-A6T8U](#) [S-5716ANDH0-I4T1U](#) [S-57GSNL5S-L3T2U](#) [S-57GDNL3S-L3T2U](#) [S-57GNNL3S-L3T2U](#) [S-57RBNL8S-](#)
[L3T2U](#) [S-57RBNL9S-A6T8U](#) [S-57RB1L8S-L3T2U](#) [S-57GDNL5S-L3T2U](#) [S-57RBNL9S-L3T2U](#) [S-57TZ1L1S-L3T2U](#) [S-57TZNL1S-](#)
[A6T8U](#)