

2.92 mm TO 40 GHz

2.92 mm Cable Assemblies

RF047-A, RF086, RF085, RF23C, RF120



VSWR

RF047-A: 1.35 max.
RF086: 1.40 max.
RF085: 1.40 max.
RF23C: 1.40 max.
RF120: 1.40 max.

SERIES

RF047-A
 = (1.2 mm) .047" overshield DIA
 29 AWG millimeter wave cable

RF086
 = (2.18 mm) .086" overshield DIA
 23 AWG millimeter wave cable

RF085
 = (2.16 mm) .085" overshield DIA
 24 AWG millimeter wave cable

RF23C
 = MWC-2350CU-01 millimeter wave
 cable with copper foil shield

RF120
 = MWC-19550-FCU-01 19 AWG
 millimeter wave cable

END 1 CONNECTOR

-92SJ
 = 2.92 mm Straight Jack

-92SP
 = 2.92 mm Straight Plug

ALSO AVAILABLE

1.35 mm, 1.85 mm, 2.40 mm, SMPM = RF047-A

1.85 mm, 2.40 mm, SMPM = RF086

2.40 mm = RF085

2.40 mm, SMPM = RF23C

2.40 mm = RF120

OVERALL LENGTH

-"XXXX"
 = Overall Length in
 millimeters

-0100 (100 mm) 3.94"
 minimum (RF047-A, RF085,
 RF086, RF120)

-0152 (0152 mm) 5.984"
 minimum (RF23C)

2.92 mm Cable Connectors

PRF92



CONNECTORS FOR INDUSTRY STANDARD CABLES

PRF92-P-C-EE-405-SD	RG 405, .085, semi-rigid
PRF92-P-C-EE-085A-SD	.085, semi-rigid, 23AWG
PRF92-P-C-EP-160-SS	Semflex HP160, low loss flexible
PRF92-P-C-EP-150B-SS	IW 1501, low loss flexible
PRF92-P-C-EP-142-SS	Harbour LL142, low loss flexible
PRF92-J-C-EP-085-SS	Harbour SS405, flexible alternative to RG 405
PRF92-J-C-EP-085-BS	Harbour SS405, flexible alternative to RG 405
PRF92-P-C-EP-085-SS	Harbour SS405, flexible alternative to RG 405
PRF92-P-C-EE-402-SD	RG 402, .141, semi-rigid
PRF92-P-C-EP-190-SS	Semflex HP190, low loss flexible
PRF92-J-C-EP-160-SS	Semflex HP160, low loss flexible
PRF92-P-C-EP-120A-SS	Semflex HP120, low loss flexible
PRF92-P-C-EP-140-SS	Dynawave DF140, low loss flexible
PRF92-P-C-EP-047D-SS	.047, semi-rigid
PRF92-J-C-EP-047D-SS	.047, semi-rigid
PRF92-P-C-EP-150-SS	Dynawave DF150, low loss flexible
PRF92-P-C-EE-118-SD	Haverhill HC35004, .118, semi-rigid
PRF92-J-C-EP-402-SS	RG 402, .141, semi-rigid
PRF92-J-C-EP-047D-4S	.047, semi-rigid
PRF92-J-C-EP-405-4S	RG 405, .085, semi-rigid
PRF92-P-C-EE-405-SD	RG 405, .085, semi-rigid
PRF92-P-C-EP-086-SS	.086 Temp-Flex, low loss flexible
PRF92-P-C-EP-200-SS	Times Max Gain 200, low loss flexible

INTERFACE STANDARD

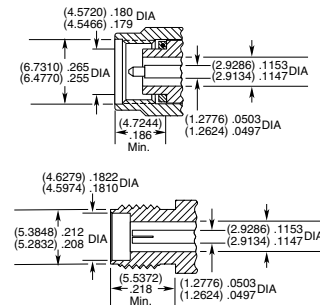

P-C = Cable Plug

J-P = Cable Jack

EE = Plating (50 μ" Gold center contact & outer contact)

EP = Plating (50 μ" Gold center contact, passivated outer contact)

SS = Straight, Solder Clamp

SD = Straight, Direct Solder

BS = Bulkhead, Solder Clamp

4S = 4-hole flange, Solder Clamp

2.92 mm Board Connectors

292

Cable Mates:

RF047-A, RF085, RF086, RF23C, RF120



292

GENDER

-J
 = Jack

TYPE

-P
 = PCB
 Mount

PLATING

-EP
 = 50 μ" (1.27 μm)
 Gold center
 contact,
 Passivated
 outer contact

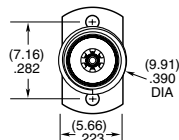

ORIENTATION

-ST
 = Straight

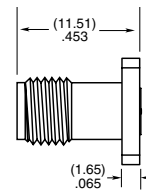

TERMINATION

-CM
 = Compression
 Mount Stripline

-CMM
 = Compression
 Mount Microstrip

OPTION

-1
 = Without
 Screws

-2
 = With
 Screws

X-ON Electronics

Largest Supplier of Electrical and Electronic Components

Click to view similar products for [RF Connectors / Coaxial Connectors](#) category:

Click to view products by [Samtec](#) manufacturer:

Other Similar products are found below :

[8915-1511-000](#) [89674-0827](#) [6001-7071-019](#) [6002-7051-003](#) [6002-7551-202](#) [6059674-1](#) [619550-1](#) [630059-000](#) [M39030/3-01N](#) [6500-7071-046](#) [6769](#) [CX050L2AQ](#) [7002-1541-010](#) [7002-1542-011](#) [7004-1512-000](#) [7009-1511-004](#) [7010-1511-000](#) [7029-1511-060](#) [7101-1541-010](#) [7101-1571-002](#) [7145-1521-002](#) [7203-1571-003](#) [7209-1511-011](#) [7210-1511-015](#) [7210-1511-019](#) [73137-5015](#) [73216-2241](#) [73404-2300](#) [7405-1521-005](#) [7405-1521-802](#) [8527](#) [8547](#) [FS11V](#) [877931](#) [8808-1511-001](#) [9049-9513-000](#) [9074-9513-000](#) [9101-9573-002](#) [910A205F](#) [9130-9573-002](#) [PL11SC-026](#) [PL375-33](#) [PL40-5](#) [PL74C-221](#) [PL75MC-217](#) [PL803-7](#) [1200690078](#) [1-201144-1](#) [R107003010W](#) [R110A172100](#)