

# SMT MICRO BOARD STACKER

(0.80 mm) .0315" PITCH • AW SERIES

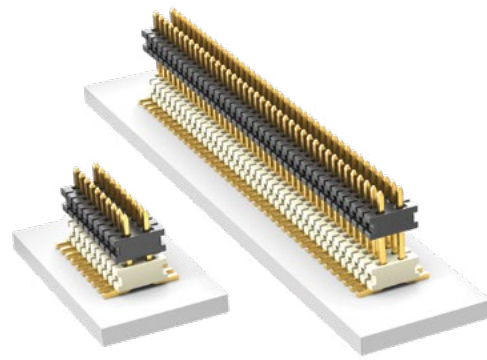

## AW

Mates:  
CLE

### SPECIFICATIONS

#### Insulator Material:

Top: Black LCP  
Bottom: Natural LCP

#### Terminal Material:

Phosphor Bronze

#### Plating:

Au over 50  $\mu$ " (1.27  $\mu$ m) Ni

#### Operating Temp Range:

-55 °C to +125 °C

### PROCESSING

#### Lead-Free Solderable:

Yes

#### SMT Lead Coplanarity:

(0.10 mm) .004" max (05-40)

(0.15 mm) .006" max (41-90)\*

\*(.004" stencil solution

may be available; contact

IPG@samtec.com)

### OPTIONS

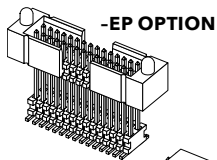

-EP OPTION

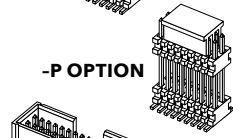

-P OPTION

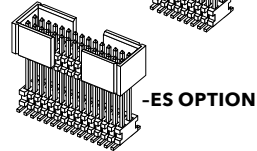

-ES OPTION

#### Notes:

For added mechanical stability, Samtec recommends mechanical board spacers be used in applications with gold or selective gold plated connectors. Contact ipg@samtec.com for more information.

Some lengths, styles and options are non-standard, non-returnable.

AW	NO. PINS PER ROW	03	PLATING OPTION	D	STACKER HEIGHT	POST HEIGHT	OTHER OPTION
----	------------------	----	----------------	---	----------------	-------------	--------------

05 thru 90

**-G**  
= 10  $\mu$ "  
(0.25  $\mu$ m)  
Gold

**-"XXX"**  
= Stacker Height  
(in inches)  
(3.09 mm)  
.122" to  
(5.84 mm)  
.230"

Example:  
-175  
= (4.45 mm)  
.175"

**-"XXX"**  
= Post Height  
(in inches)  
(1.91 mm)  
.075"  
minimum

Example:  
-075  
= (1.91 mm)  
.075"

**-ES**  
= End Shroud  
11 pins/row min.  
(-075 Post  
Height only)

**-EP**  
= End Shroud  
with Guide Post  
(-075 Post  
Height only)  
11 pins/row min.

**-A**  
= Alignment Pin  
(4 positions min.)  
(Available for  
board stacks  
between  
(4.06 mm) .160" to  
(5.84 mm) .230")  
(Metal or plastic at  
Samtec discretion.)

**-P**  
= Pick & Place Pad  
(8 positions min.)

**-TR**  
= Tape & Reel  
(84 positions max.)

**-FR**  
= Full Reel  
Tape & Reel  
(must order max.  
quantity per reel;  
contact Samtec for  
quantity breaks)  
(84 positions max.)

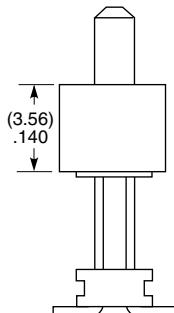
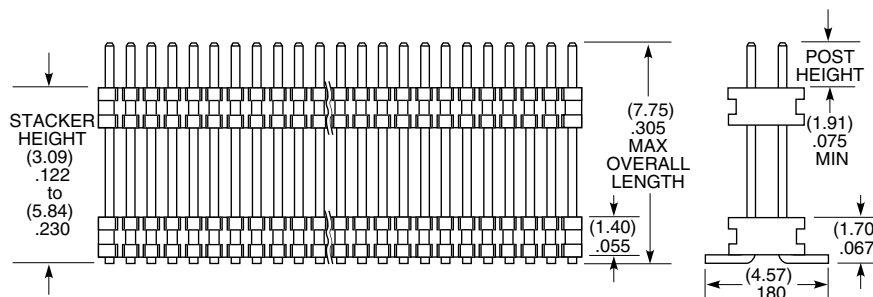
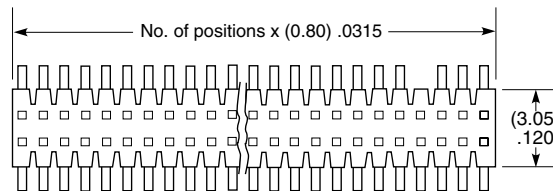

-EP OPTION

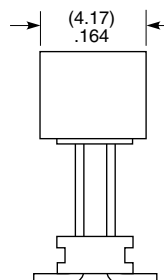

-ES OPTION

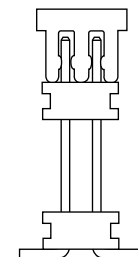

-P OPTION

## X-ON Electronics

Largest Supplier of Electrical and Electronic Components

*Click to view similar products for [Board to Board & Mezzanine Connectors](#) category:*

*Click to view products by [Samtec](#) manufacturer:*

Other Similar products are found below :

[589158040000018](#) [MDF7C-18P-2.54DSA\(55\)](#) [FCN-230C068-11](#) [FCN-268F012-G/BD](#) [FCN-268F036-G/BD](#) [FCN-268M012-G/0D](#) [FCN-268M024-G/1D](#) [FCN-723J004/1](#) [MIS-048-01-F-D-DP-K](#) [832-10-034-10-001000](#) [FX4C-80S-1.27DSA](#) [FCN-214Q030-G/0](#) [FCN-234P048-G/0](#) [FCN-235D050-G/C](#) [210-93-314-41-105000](#) [2-22603-0](#) [MDF7-40DP-2.54DSA\(55\)](#) [AXG720047](#) [5031084030](#) [MIT-114-03-F-D-K](#) [55323-1519](#) [DF33-2P-3.3DSA\(24\)](#) [YFT-20-05-H-03-SB-K](#) [503308-3040](#) [026-6203-PDB](#) [027-6203-PDB](#) [069159702701000](#) [10123981-102LF](#) [101A10019X](#) [55650-0588-C](#) [68684-306](#) [75140-7012](#) [589159005003045](#) [194261-1](#) [FCN-268F024-G0D](#) [10124054-515LF](#) [68685-603](#) [8-1616154-3](#) [MIS-019-01-F-D](#) [589159005002045](#) [541371078](#) [IL-WX-10PB-HF-B-E1000E](#) [FCN-268M024-G/3D](#) [20021832-06016C1LF](#) [KX15-20KLDL-E1000E](#) [MDF7-16DP-2.54DSA\(55\)](#) [AXE810124](#) [FCN-214J100-G/0](#) [FCN-230C068-E/S](#) [AXE812124](#)