

RUGGED LATCHING HIGH-SPEED SYSTEM



(0.80 mm) .0315" PITCH • EPLSP/ERI8/ERC SERIES

EPLSP

Mates:
ERI8

SPECIFICATIONS

Cable:
32 AWG Low Skew Pair/
28 AWG Power
Bend Radius:
(25.40 mm) 1.00"
Signal Routing:
100 Ω Differential
Pinout Map:
1:1 Map Standard
(See web address below
for additional information)
Operating Temp Range:
-20 °C to +105 °C
Current Rating:
1.7 A per pin
(2 pins powered)

Note:
This Series is non-standard,
non-returnable.

SERIES	NO. OF POSITIONS	LENGTH
--------	------------------	--------

EPLSP
= Eye Speed® I/O Cable

-019
= 9 Pairs, 5 Power, 19 positions

-"XXXX"
= Length in millimeters
-1000, -2000, -3000
(Standard lengths)

-031
= 17 Pairs, 5 Power, 31 positions

NO. OF POSITIONS	A
-019	(23.85) .939
-031	(32.95) 1.30

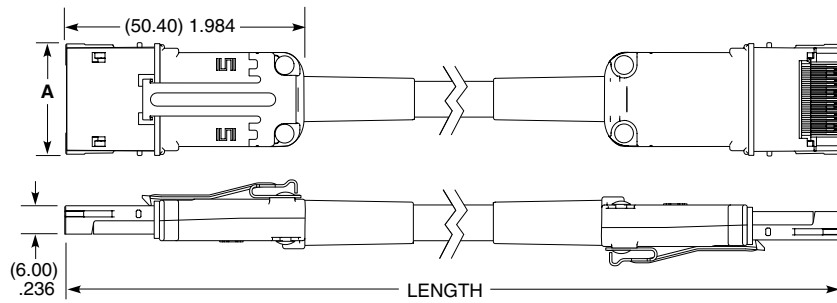

ERI8

Mates:
EPLSP

SPECIFICATIONS

Insulator Material:
Black LCP
Terminal Material:
BeCu
Plating:
Au or Sn over
50 μ" (1.27 μm) Ni
Current Rating:
1.7 A per pin
(2 pins powered)
Voltage Rating:
225 VAC/320 VDC
Operating Temp Range:
-55 °C to +125 °C



PROCESSING

Lead-Free Solderable:
Yes
SMT Lead Coplanarity:
(0.10 mm) .004" max

Notes:
Active equalization
reference design for
Eye Speed® I/O system
see www.samtec.com?EPLSP

Some lengths, styles and
options are non-standard,
non-returnable.

ERI8	NO. OF POSITIONS	PLATING OPTION	D	RA	OTHER OPTION
------	------------------	----------------	---	----	--------------

-019
= 9 Pairs,
5 Power,
19 positions

-S
= 30 μ"
(0.76 μm)
Gold on
contact,
Matte Tin
on tail

-TR
= Tape
& Reel

-031
= 17 Pairs,
5 Power,
31 positions

-FR
= Full Reel
Tape &
Reel
(must
order
max.
quantity
per reel;
contact
Samtec
for
quantity
breaks)

NO. OF POSITIONS	A
-019	(19.08) .751
-031	(28.68) 1.13

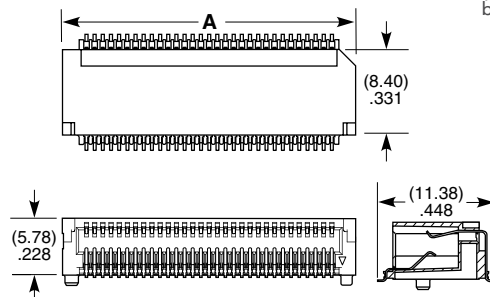

SERIES	NO. OF POSITIONS	01	OPTION
--------	------------------	----	--------

ERC
= Cage

**-019,
-031**
= Number of
Positions

-01
= Without
Gasket

-02
= With
Gasket

NO. OF POSITIONS	A
-019	(30.55) 1.203
-031	(40.15) 1.58

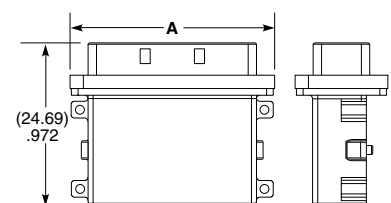

X-ON Electronics

Largest Supplier of Electrical and Electronic Components

Click to view similar products for [Standard Card Edge Connectors](#) category:

Click to view products by [Samtec](#) manufacturer:

Other Similar products are found below :

[CR7E-30DB-3.96E\(72\)](#) [6364499-1](#) [6565204-6](#) [PKC-156](#) [1437274-4](#) [147889-1](#) [1489165-4](#) [EBT15622B2X](#) [1-582587-1](#) [284-0102-12100](#)
[286-0052-12101A](#) [306022901000000](#) [307-012-502-202](#) [307-056-520-300](#) [2129318-1](#) [245-062-520-350](#) [287-0032-12101](#) [306-028-525-102](#)
[307-072-526-202](#) [345-060-559-303](#) [392-008-559-201](#) [534671-1](#) [341-240-317](#) [345-044-500-300](#) [346-240-318](#) [395-100-524-300](#) [09-07-2032](#)
[10035388-802LF](#) [10115859-011LF](#) [10122859-009LF](#) [10127905-B04B24BLF](#) [530555-1](#) [5-678046-1](#) [73726-0005](#) [66308-1](#) [1-1437275-6](#)
[PEC-07-02-T-S-A](#) [346-014-520-801](#) [307-048-502-202](#) [CE100F22-9-C](#) [CE100F26-7-C](#) [CE100F28-3-D](#) [CE156F18-9-C](#) [CE156F22-5-D](#)
[CE156F22-9-C](#) [CT100F22-2-D](#) [CT100F22-3-D](#) [CT100F24-2-D](#) [CT100F24-3-D](#) [CT100F24-6-C](#)