

# LOW-PROFILE BLADE AND BEAM

(0.50 mm) .0197" PITCH • LTH/LSH SERIES



**LTH**  
Mates:  
LSH

**LSH**  
Mates:  
LTH

<b>LTH</b>	<b>NO. OF POSITIONS PER ROW</b>	<b>01</b>	<b>PLATING OPTION</b>	<b>D</b>	<b>A</b>	<b>OTHER OPTION</b>
------------	---------------------------------	-----------	-----------------------	----------	----------	---------------------

-010, -020,  
-030, -040, -050

**-G**  
= 10 μm  
(0.25 μm)  
Gold

**-K**  
= (5.50 mm)  
.217" DIA  
Polyimide  
film Pick &  
Place Pad

**-TR**  
= Tape & Reel

**-FR**  
= Full Reel  
Tape & Reel  
(must order max.  
quantity per reel;  
contact Samtec for  
quantity breaks)

## SPECIFICATIONS

### Insulator Material:

Liquid Crystal  
Polymer

### Terminal Material:

Phosphor Bronze

### Contact Material:

BeCu

### Plating:

Au over 50 μm (1.27 μm) Ni

### Current Rating:

2.6 A per pin  
(2 pins powered)

### Operating Temp Range:

-55 °C to +125 °C

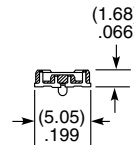
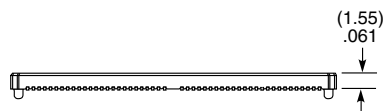
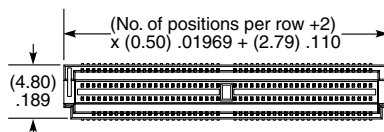

## PROCESSING

### Lead-Free Solderable:

Yes

### SMT Lead Coplanarity:

(0.10 mm) .004" max

### Board Stacking:

For applications requiring more than two connectors per board, contact ipg@samtec.com

<b>LSH</b>	<b>NO. OF POSITIONS PER ROW</b>	<b>01</b>	<b>PLATING OPTION</b>	<b>D</b>	<b>A</b>	<b>OTHER OPTION</b>
------------	---------------------------------	-----------	-----------------------	----------	----------	---------------------

-010, -020,  
-030, -040, -050

**-G**  
= 10 μm  
(0.25 μm)  
Gold

**-K**  
= (7.50 mm)  
.295" DIA  
Polyimide  
film Pick &  
Place Pad

**-TR**  
= Tape & Reel

**-FR**  
= Full Reel  
Tape & Reel  
(must order max.  
quantity per reel;  
contact Samtec for  
quantity breaks)

## MATED HEIGHT

LEAD STYLE	MATED HEIGHT*
-01	(2.31 mm) .091"

\*Processing conditions will affect mated height.

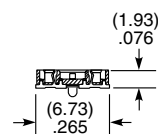
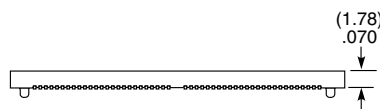
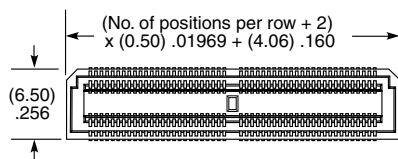

**Note:**  
Some lengths, styles and options are non-standard, non-returnable.

## X-ON Electronics

Largest Supplier of Electrical and Electronic Components

*Click to view similar products for [Board to Board & Mezzanine Connectors](#) category:*

*Click to view products by [Samtec](#) manufacturer:*

Other Similar products are found below :

[589158040000018](#) [MDF7C-18P-2.54DSA\(55\)](#) [FCN-230C068-11](#) [FCN-268F012-G/BD](#) [FCN-268F036-G/BD](#) [FCN-268M012-G/0D](#) [FCN-268M024-G/1D](#) [FCN-723J004/1](#) [MIS-048-01-F-D-DP-K](#) [832-10-034-10-001000](#) [FX4C-80S-1.27DSA](#) [FCN-214Q030-G/0](#) [FCN-234P048-G/0](#) [FCN-235D050-G/C](#) [210-93-314-41-105000](#) [2-22603-0](#) [MDF7-40DP-2.54DSA\(55\)](#) [AXG720047](#) [5031084030](#) [MIT-114-03-F-D-K](#) [55323-1519](#) [DF33-2P-3.3DSA\(24\)](#) [YFT-20-05-H-03-SB-K](#) [503308-3040](#) [026-6203-PDB](#) [027-6203-PDB](#) [069159702701000](#) [10123981-102LF](#) [101A10019X](#) [55650-0588-C](#) [68684-306](#) [75140-7012](#) [589159005003045](#) [194261-1](#) [FCN-268F024-G0D](#) [10124054-515LF](#) [68685-603](#) [8-1616154-3](#) [MIS-019-01-F-D](#) [589159005002045](#) [541371078](#) [IL-WX-10PB-HF-B-E1000E](#) [FCN-268M024-G/3D](#) [20021832-06016C1LF](#) [KX15-20KLDL-E1000E](#) [MDF7-16DP-2.54DSA\(55\)](#) [AXE810124](#) [FCN-214J100-G/0](#) [FCN-230C068-E/S](#) [AXE812124](#)