

MMCX7-J-P-GF-RA-TH1



MMCX7-J-P-GF-ST-TH1



MMCX7-P-P-GF-ST-TH1

MMCX7 SERIES

75 Ω MICRO-MINI SYSTEMS

SPECIFICATIONS

For complete specifications and recommended PCB layouts see www.samtec.com?MMCX7-TH

Shell Material:

Brass

Insulator Material:

PTFE

Contact Material:

BeCu

Pin Material:

Brass

Operating Temp Range:

-65 °C to +125 °C

Impedance:

75 Ω

Dielectric Withstanding Voltage:

500 Vrms, 50 Hz

Dielectric Working Voltage:

170 Vrms, 50 Hz

Frequency Range:

0~6 GHz

RoHS Compliant:

Yes

PROCESSING

Lead-Free Solderable:

Yes

MMCX7

GENDER

TYPE

PLATING

ORIENTATION

TERMINATION

Mates with:

MMCX7-P, RF179, GRF7H-C

-J

= Jack

-P

= PCB Mount

-GF

= 10 μ" (0.25 μm) Gold center contact, 3 μ" (0.08 μm) Gold outer contact

-RA

= Right-angle

-ST

= Straight

-TH1

= Through-hole

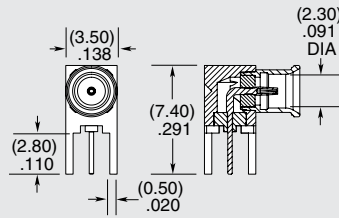

-RA

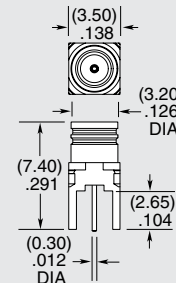

-ST

OTHER SOLUTIONS

- 75 Ω Cable Components available Contact Samtec.

MMCX7

GENDER

TYPE

PLATING

ST

TH1

Mates with:

MMCX7-J, RF179, GRF7H-C

-P

= Plug

-P

= PCB Mount

-GF

= 10 μ" (0.25 μm) Gold center contact, 3 μ" (0.08 μm) Gold outer contact

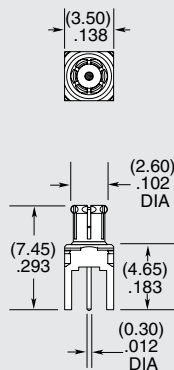

X-ON Electronics

Largest Supplier of Electrical and Electronic Components

Click to view similar products for [RF Connectors](#) / [Coaxial Connectors](#) category:

Click to view products by [Samtec](#) manufacturer:

Other Similar products are found below :

[89674-0827](#) [6059674-1](#) [630059-000](#) [6501-1071-002](#) [6769](#) [7002-1541-010](#) [7002-1572-002](#) [7004-1512-000](#) [7009-1511-004](#) [7101-1541-010](#)
[7101-1571-002](#) [7105-1521-002](#) [7203-1571-003](#) [7209-1511-011](#) [7210-1511-040](#) [7242-1511-000](#) [7405-1521-005](#) [7405-1521-802](#)
[804S01D04M040](#) [8527](#) [8547](#) [FS11V](#) [877931](#) [8808-1511-001](#) [9049-9513-000](#) [9074-9513-000](#) [PL11C-026](#) [PL40-36](#) [9408-1113-000](#) [980-](#)
[8666-005](#) [11 SMA-50-2-6 / 111 NE](#) [11 SMA-50-3-6 / 111 NE](#) [1-201144-1](#) [120919](#) [R107003010W](#) [R112186000](#) [R113053000W](#) [R113082097](#)
[R113236000](#) [R114083000](#) [R114670000W](#) [R123415000W](#) [R124076320](#) [R124076450](#) [R124175123](#) [R125075000W](#) [R125075001](#)
[R125172000W](#) [R125415030](#) [R141007161](#)