

MMCX7-J-P-GF-RA-TH1



MMCX7-J-P-GF-ST-TH1



MMCX7-P-P-GF-ST-TH1

MMCX7 SERIES

75 Ω MICRO-MINI SYSTEMS

SPECIFICATIONS

For complete specifications and recommended PCB layouts see www.samtec.com?MMCX7-TH

- Shell Material:** Brass
- Insulator Material:** PTFE
- Contact Material:** BeCu
- Pin Material:** Brass
- Operating Temp Range:** -65 °C to +125 °C
- Impedance:** 75 Ω
- Dielectric Withstanding Voltage:** 500 Vrms, 50 Hz
- Dielectric Working Voltage:** 170 Vrms, 50 Hz
- Frequency Range:** 0-6 GHz
- RoHS Compliant:** Yes

PROCESSING

Lead-Free Solderable: Yes

MMCX7

GENDER

TYPE

PLATING

ORIENTATION

TERMINATION

Mates with:
MMCX7-P, RF179,
GRF7H-C

-J
= Jack

-P
= PCB Mount

-GF
= 10 μ" (0.25 μm) Gold center contact,
3 μ" (0.08 μm) Gold outer contact

-RA
= Right-angle

-ST
= Straight

-TH1
= Through-hole

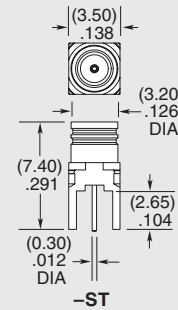
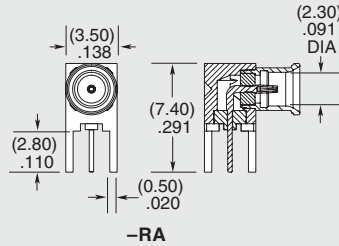

OTHER SOLUTIONS

- 75 Ω Cable Components available
- Contact Samtec.

MMCX7

GENDER

TYPE

PLATING

ST

TH1

Mates with:
MMCX7-J, RF179,
GRF7H-C

-P
= Plug

-P
= PCB Mount

-GF
= 10 μ" (0.25 μm) Gold center contact,
3 μ" (0.08 μm) Gold outer contact

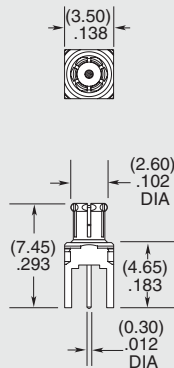

Due to technical progress, all designs, specifications and components are subject to change without notice.

X-ON Electronics

Largest Supplier of Electrical and Electronic Components

Click to view similar products for [RF Connectors / Coaxial Connectors](#) category:

Click to view products by [Samtec](#) manufacturer:

Other Similar products are found below :

[8915-1511-000](#) [89674-0827](#) [6001-7071-019](#) [6002-7051-003](#) [6002-7551-202](#) [6059674-1](#) [619550-1](#) [630059-000](#) [M39030/3-01N](#) [6500-7071-046](#) [6769](#) [CX050L2AQ](#) [7002-1541-010](#) [7002-1542-011](#) [7004-1512-000](#) [7009-1511-004](#) [7010-1511-000](#) [7029-1511-060](#) [7101-1541-010](#) [7101-1571-002](#) [7145-1521-002](#) [7203-1571-003](#) [7209-1511-011](#) [7210-1511-015](#) [7210-1511-019](#) [73137-5015](#) [73216-2241](#) [73404-2300](#) [7405-1521-005](#) [7405-1521-802](#) [8527](#) [8547](#) [FS11V](#) [877931](#) [8808-1511-001](#) [9074-9513-000](#) [9101-9573-002](#) [910A205F](#) [9130-9573-002](#) [PL11SC-026](#) [PL375-33](#) [PL40-5](#) [PL74C-221](#) [PL75MC-217](#) [PL803-7](#) [1200690078](#) [1-201144-1](#) [R107003010W](#) [R110A172100](#) [R112186000](#)