

RCU-G-02.00-AMS-AM

RCU SERIES

IP68 SEALED USB CABLE PLUG

SPECIFICATIONS

For complete specifications see www.samtec.com?RCU

- Insulator Material:** Glass Filled Thermoplastic
- Contact Material:** Phosphor Bronze
- Current Rating:** 4.2 A per pin (1 pin powered)
- Operating Temp Range:** -20 °C to +80 °C
- Shield Material:** Phosphor Bronze
- Wire:** 20 AWG (Power)
25 AWG (Signal)
28 AWG (Drain)

Mates with:
RPCU, RPBU

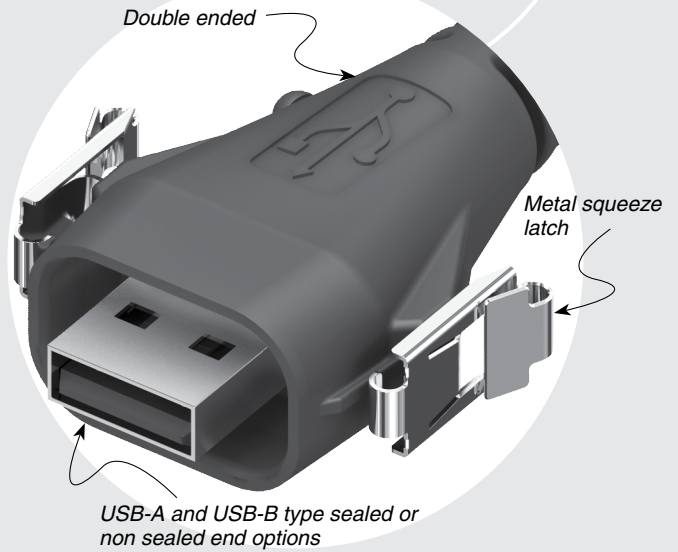

DUST CAPS

- AMS = DCA-RCU-01-01-A
- BMS = DCA-RCU-01-01-B

ALSO AVAILABLE (MOQ Required)

- Other wire lengths
- End option 2 with -AMS, -BMS or -BM

RCU	PLATING	WIRE LENGTH	END 1 OPTION	END 2 OPTION
	-G = 30 μ" (0.76 μm) Gold on contact, Nickel on shell	-01.00 = (1 m) 40" Cable -02.00 = (2 m) 79" Cable Standard lengths	-AMS = USB A Type, Sealed -BMS = USB B Type, Sealed	-AM = USB A Type, Not Sealed -BC = Blunt Cut

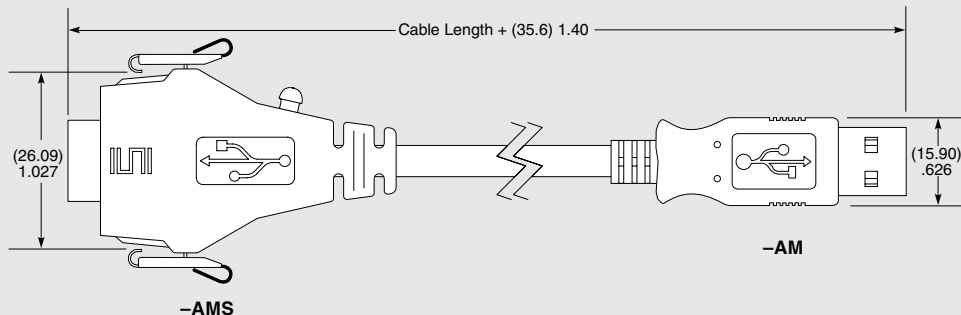

X-ON Electronics

Largest Supplier of Electrical and Electronic Components

Click to view similar products for [USB Connectors](#) category:

Click to view products by [Samtec](#) manufacturer:

Other Similar products are found below :

[65-647-8-BK-BU](#) [950](#) [952](#) [E8144-B01021-L](#) [A-USB B-TOP-C](#) [MUSBA511N5](#) [MUSBD11135](#) [217450-1](#) [KMBVX-TH-5S-B30](#) [896-30-004-00-000000](#) [KUSBVX-BS1N-W30](#) [KUSBX-AP-KIT-SCBLK](#) [KUSBX-AS2N-W](#) [KUSBX-SMT2AP1S-W](#) [KUSBX-SMT2AP1S-W30](#) [935](#) [957](#) [30-498-6](#) [SK-60A-2](#) [17-210051](#) [1734082-1](#) [30-1574](#) [30-470](#) [30-489](#) [30-541](#) [30-572-3](#) [A-USB A-2P-C](#) [MIKROE-1451](#) [USBFTV2PEM2G](#) [USBFTVC6ZN](#) [KUSBX-AS2N-W30](#) [KUSBX-SLAS1N-W](#) [KUSBX-SMT-AS1N-W30](#) [4689-1](#) [1-1734084-2](#) [E8110-001-01](#) [33UBARS1-04SW11](#) [33UBAR-04SW11](#) [USBF21ZNSCC](#) [USBBFTV6ZC](#) [10135326-001LF](#) [M9177/3-1](#) [USB-A-S-F-B-VT](#) [925](#) [4198](#) [690-024-633-031](#) [KUSBEX-BSFS1N-W](#) [USBFTVC6MRG](#) [UA-20BMFA-SL8001](#) [17-250101](#)