

RCU-G-02.00-AMS-AM

RCU SERIES

# IP68 SEALED USB CABLE PLUG

## SPECIFICATIONS

For complete specifications see [www.samtec.com?RCU](http://www.samtec.com?RCU)

- Insulator Material:** Glass Filled Thermoplastic
- Contact Material:** Phosphor Bronze
- Current Rating:** 4.2 A per pin (1 pin powered)
- Operating Temp Range:** -20 °C to +80 °C
- Shield Material:** Phosphor Bronze
- Wire:** 20 AWG (Power)  
25 AWG (Signal)  
28 AWG (Drain)

Mates with:  
RPCU, RPBU

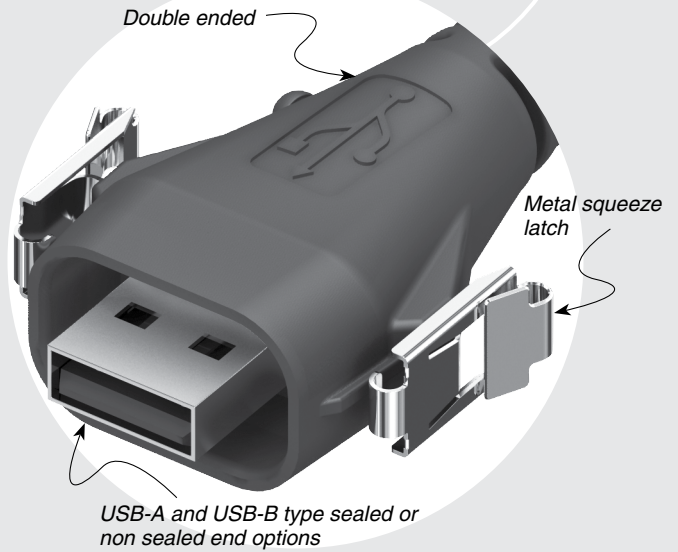

## DUST CAPS

- AMS = DCA-RCU-01-01-A
- BMS = DCA-RCU-01-01-B

## ALSO AVAILABLE (MOQ Required)

- Other wire lengths
- End option 2 with -AMS, -BMS or -BM

RCU	PLATING	WIRE LENGTH	END 1 OPTION	END 2 OPTION
	-G = 30 μ" (0.76 μm) Gold on contact, Nickel on shell	-01.00 = (1 m) 40" Cable  -02.00 = (2 m) 79" Cable Standard lengths	-AMS = USB A Type, Sealed  -BMS = USB B Type, Sealed	-AM = USB A Type, Not Sealed  -BC = Blunt Cut

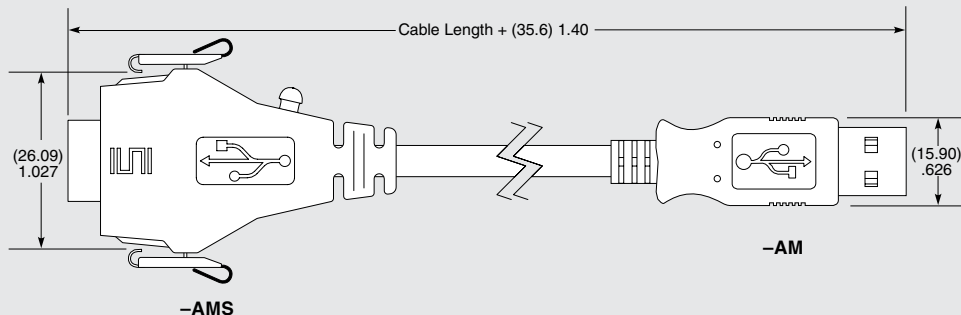

## X-ON Electronics

Largest Supplier of Electrical and Electronic Components

*Click to view similar products for [USB Connectors](#) category:*

*Click to view products by [Samtec](#) manufacturer:*

Other Similar products are found below :

[950](#) [A-USB A-LP-SMT-C](#) [A-USB B-TOP-C](#) [MUSBA511N5](#) [MUSBD11135](#) [217450-1](#) [KMBVX-TH-5S-B30](#) [896-30-004-00-000000](#)  
[KUSBX-AS2N-W](#) [KUSBX-SMT2AP1S-W30](#) [935](#) [957](#) [30-498-6](#) [SK-60A-2](#) [1734082-1](#) [CIR08AF-20-27S-F80-20](#) [CIR08F-20](#) [30-1574](#) [30-470](#) [30-489](#) [30-541](#) [30-572-3](#) [A-USB A-2P-C](#) [MIKROE-1451](#) [USBFTV2PEM2G](#) [USBFTVC6ZN](#) [USBFTVSCCG](#) [4689-1](#) [1-1734084-2](#)  
[CIR08F-20-27P-F80-VO](#) [USBF21ZNSCC](#) [USBBFTV6ZC](#) [MUSBB151341](#) [10135326-001LF](#) [M9177/3-1](#) [USB-A-S-F-B-VT](#) [925](#) [4198](#) [690-024-633-031](#) [UB-20PMFP-LC7001](#) [USBFTVC6MRG](#) [UA-20BMFA-SL8001](#) [17-200011](#) [USBFTVC7ZC](#) [UB-20AFMM-LL7A01](#)  
[USBFTVC2MN](#) [CAP-WCCMLPB1](#) [CAP-WCCMLPC1](#) [2041386-1](#) [2274475-3](#)