



## SMP TO 40 GHz

### SMP Board Connectors SMP-TH, SMP-EM

Cable Mates:  
RF405, RF255



SMP	GENDER	TYPE	PLATING	ORIENTATION	TERMINATION
	<b>-PF</b> = Plug, Full Detent  <b>-PL</b> = Plug, Limited Detent  <b>-PS</b> = Plug, Smooth Bore  <b>-PC</b> = Plug, Catcher's Mitt	<b>-P</b> = PCB Mount	<b>-GF</b> = 10 $\mu$ " (0.25 $\mu$ m) Gold center contact, Gold Flash outer contact (-TH2 only)  <b>-HH</b> = 30 $\mu$ " (0.76 $\mu$ m) Gold center and outer contact (-EM3)	<b>-ST</b> = Straight	<b>-TH2</b> = Through-hole  <b>-EM3</b> = Drop-in Edge Mount (Not available with -PC)

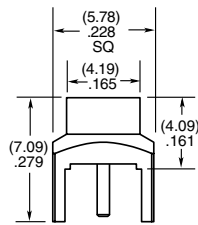

-PF/-PL/-PS-TH2

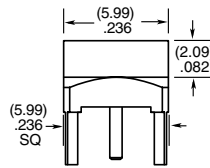

-PC-TH2

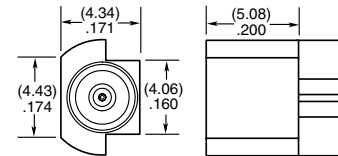

-EM3

### SMP Bullet Adaptor SMP-B



SMP	J	TYPE	PLATING	ORIENTATION	BULLET LENGTH
		<b>-B</b> = Bullet Adaptor	<b>-GF</b> = 10 $\mu$ " (0.25 $\mu$ m) Gold center contact, Gold Flash outer contact	<b>-ST</b> = Straight	<b>-0645</b> = 6.45 mm (.254")  <b>-1450</b> = 14.50 mm (.571")

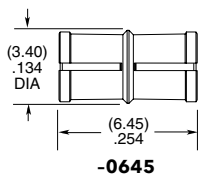

-0645

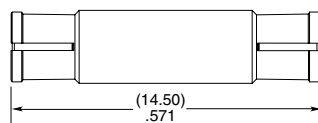

-1450

### APPLICATION

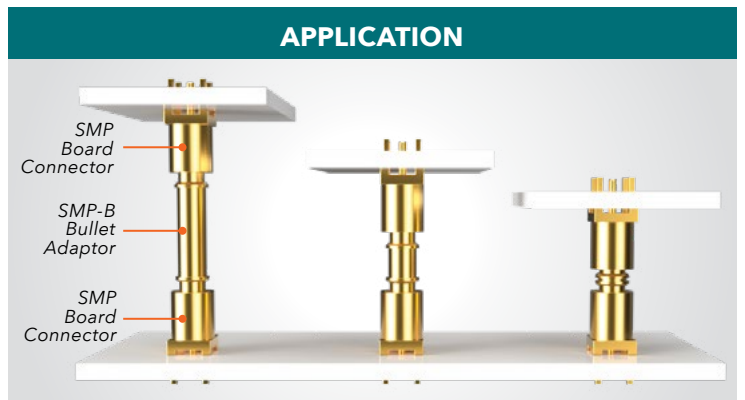

Compensates for axial & radial misalignment

## X-ON Electronics

Largest Supplier of Electrical and Electronic Components

*Click to view similar products for [RF Adapters - In Series](#) category:*

*Click to view products by [Samtec](#) manufacturer:*

Other Similar products are found below :

[5916-1103-603](#) [5919-1503-000](#) [5919-9503-000](#) [651A505](#) [82-5552](#) [9030-9523-502](#) [PN2C](#) [A0407000](#) [R114703000W](#) [R125771001](#)  
[R127871001](#) [R141710000W](#) [R141723161](#) [R141730000](#) [R143730700](#) [R143770000](#) [R161703000W](#) [R161753000W](#) [R161791530W](#)  
[R201705000](#) [R222705200](#) [R222M40010W](#) [R222M40050](#) [R223703180](#) [R316754000](#) [R405006000](#) [R443162000](#) [AD78TL](#) [HRM-513S](#)  
[1996352-2](#) [2157155-1](#) [252169-75](#) [AD158](#) [2101130-1](#) [252186](#) [R114704000W](#) [R114720000W](#) [R125705001](#) [R125705701](#) [R125771000](#)  
[R125771001W](#) [R127704001](#) [R127.870.001](#) [R127872001](#) [R141717000](#) [R142710000](#) [R142723000](#) [R143703000](#) [R143704000](#) [R143705700](#)