

(2.54 mm) .100"

TS, TD, HTS SERIES

PRECISION MACHINED TERMINAL STRIPS

SPECIFICATIONS

For complete specifications see www.samtec.com?TS, www.samtec.com?TD or www.samtec.com?HTS

Insulator Material:
Black G.F. Polyester (TS, TD)
Black Liquid Crystal Polymer (HTS)

Terminal Material:
Brass, except Style G is Phosphor Bronze

Plating:
Au over 50 μ " (1.27 μ m) Ni or Sn over 100 μ " (2.54 μ m) Cu or 50 μ " (1.27 μ m) Ni

Operating Temp Range:
-55 °C to +125 °C with Gold
-55 °C to +105 °C with Tin

RoHS Compliant:
Yes

Lead-Free Solderable:
Wave only

RECOGNITIONS

For complete scope of recognitions see www.samtec.com/quality



Mates with:
SS, SD, HSS, SL,
SDL, ESS, ESD

TYPE STRIP

1

NO. PINS PER ROW

PLATING OPTION

LEAD STYLE

TS
= Single Row Terminal Strip

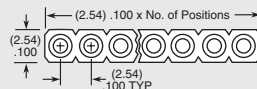

HTS
= Single Row High Temp Terminal Strip

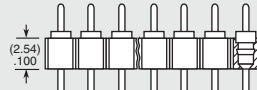

TD
= Double Row Terminal Strip

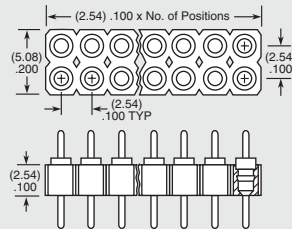

-G
= 20 μ " (0.51 μ m) Gold
Except -J & -L are 10 μ " (0.25 μ m) Gold

-T
= Tin

01 thru 32
= TS Series

01 thru 36
= HTS & TD Series

Note: Some lengths, styles and options are non-standard, non-returnable.

-AA

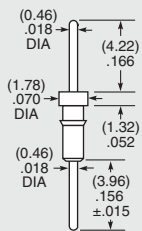

Component No. = T-1R5-

-A, -A-1, -A-2

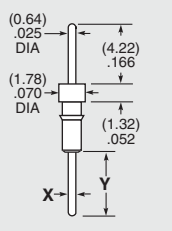

-A Component No. = T-1R0-
-A-X Component No. = T-1R7

| LEAD STYLE | X (DIA) | Y (\pm .015) |
|------------|----------------|-----------------|
| -A | (0.46) .018 | (3.96) .156 |
| -A-1 | (0.64) .025 | (5.33) .210 |
| -A-2 | (0.89) .035 | |

-C, -C-1, -C-2

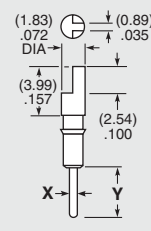

-C Component No. = T-1R2-
-C-X Component No. = T-1R9-

| LEAD STYLE | X (DIA) | Y (\pm .015) |
|------------|----------------|-----------------|
| -C | (0.46) .018 | (3.96) .156 |
| -C-1 | (0.64) .025 | (5.33) .210 |
| -C-2 | (0.89) .035 | |

-G-1

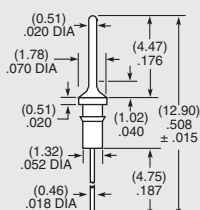

Component No. = T-1R5-

-J

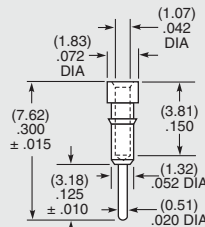

Component No. = S-1P1-

-L-1, -L-2, -L-3

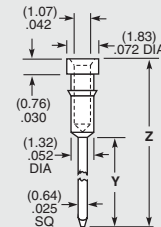

Component No. = S-1W1

| LEAD STYLE | Y (DIA) | Y (\pm .015) |
|------------|-----------------|-----------------|
| -L-1 | (12.95) .510 | (17.86) .703 |
| -L-2 | (9.14) .360 | (14.05) .553 |
| -L-3 | (6.60) .260 | (11.51) .453 |

Due to technical progress, all designs, specifications and components are subject to change without notice.

WWW.SAMTEC.COM

All parts within this catalog are built to Samtec's specifications. Customer specific requirements must be approved by Samtec and identified in a Samtec customer-specific drawing to apply.

X-ON Electronics

Largest Supplier of Electrical and Electronic Components

Click to view similar products for [Headers & Wire Housings](#) category:

Click to view products by [Samtec](#) manufacturer:

Other Similar products are found below :

[95000-104TRLF](#) [10135584-644402LF](#) [DF62W-EP2022PCA](#) [95000-106TRLF](#) [DF62W-2022SCA](#) [DF62W-EP2022PC](#) [2203348](#) [DF62W-2022SC](#) [1084018](#) [1029039](#) [1084017](#) [802-10-012-10-002000](#) [1112640](#) [1112639](#) [000-34000](#) [0009482033](#) [0009507031](#) [57102-S06-03LF](#) [57202-S52-04LF](#) [PCN6-15S-2.5E](#) [0039019024](#) [58102-G61-06LF](#) [582553-1](#) [0009485154](#) [0009508121](#) [0022285053](#) [0050291907](#) [018731A](#) [LY20-4P-DT1-P1E-BR](#) [02.125.8002.8](#) [60101931](#) [60598-1 \(Cut Strip\)](#) [M1625-3R/100](#) [61062-3](#) [61082-181009](#) [636-1427](#) [638009-1](#) [641938-9](#) [641991-4](#) [644168-1](#) [647662-1](#) [65039-019ELF](#) [65817-002LF](#) [65817-015LF](#) [65863-015LF](#) [66207-023LF](#) [67016-026LF](#) [67046-001LF](#) [67095-007LF](#) [67230-005LF](#)