

Versatile easy-mount filter



- 0.6-6.5A current ratings
- low profile case
- designed for easy-mounting
- Nennströme von 0,6 bis 6,5 A
- Flaches Gehäuse
- Einfache Montage
- courants de service de 0,6 à 6,5 A
- boîtier à hauteur réduite
- conçu pour un montage simple

Filter selection table

Choose the family FN xxx with the required current rating and features, and add /?? to determine input/output (line/load) connection style. Example: FN 422-4/13 is a 4A filter with mini fast-on connections.

Approvals



Family	Connections 	Current ratings at 40°C (25°) A	Inductance L mH
FN 42? -0.6 /??	/13	0.6 (0.7)	22.5
FN 42? -1 /??	/13	1 (1.2)	13
FN 42? -2.5 /??	/13	2.5 (3)	3.4
FN 42? -4 /??	/13	4 (4.8)	2
FN 42? -6.5 /??	/13	6.5 (7.3)	0.75

Additional specifications

Filter type	Capacitance		Res. R MΩ	Maximum leakage μA/phase	Maximum operating voltage		Operating frequency Hz	Hipot test voltage		Housing	Weight g
	C _x nF	C _y nF			VAC	Hz		PN→E VAC	P→N VDC		
FN 420 types	150	2.2	1	190	250	50/60	DC to 400	2000	1700	A7B	70
FN 422 types	150	4.7	1	190	250	50/60	DC to 400	2000	1700	A7B	70

MTBF at 40°C, 230V, per Mil-HB-217F: 625,000 hours.

Electrical schematic

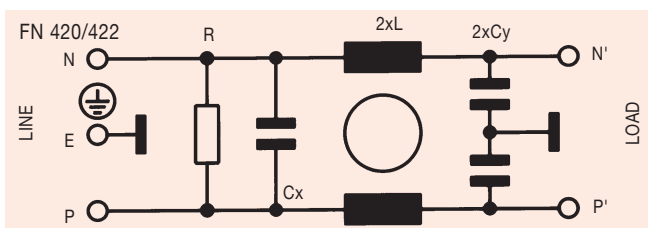

See tables for component values.

FN 420 insertion loss

Per CISPR 17; A = 50Ω/50Ω sym, B = 50Ω/50Ω asym, C = 0.1Ω/100Ω sym, D = 100Ω/0.1Ω sym

FN 420 0.6 amp types

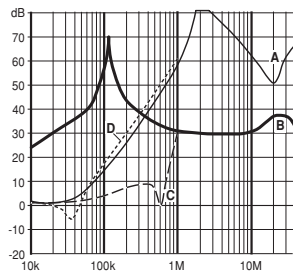

FN 420 1 amp types

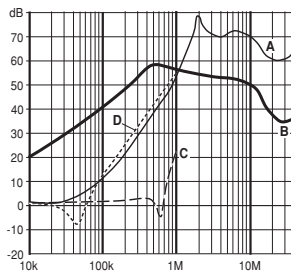

FN 420 2.5 amp types

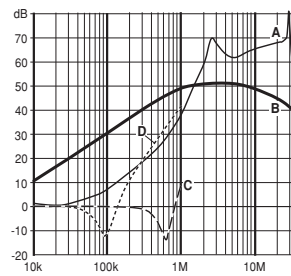

FN 420 4 amp types

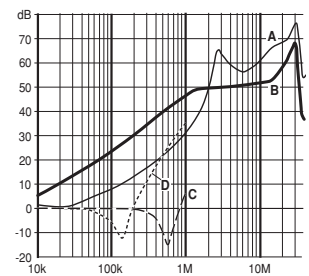

FN 420 6.5 amp types

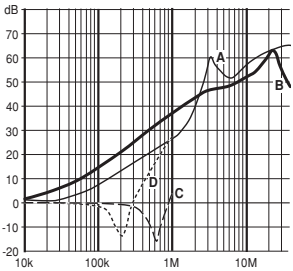

FN 422 0.6 amp types

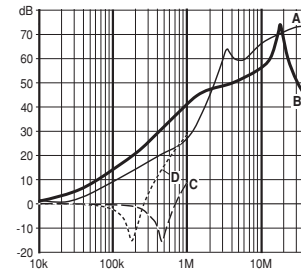

FN 422 1 amp types

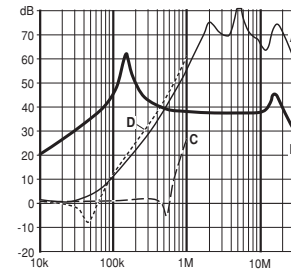

FN 422 2.5 amp types

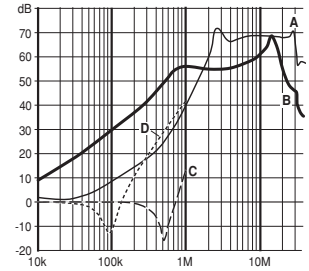

FN 422 4 amp types

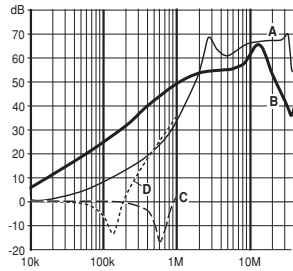

FN 422 6.5 amp types

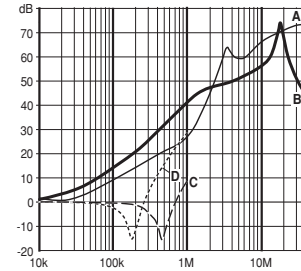

Mechanical data

		Tol. mm
A	83	± 0.5
B	41	± 0.3
C	17	± 0.3
D	65.8	± 0.2
E	31	± 0.5
F	40	± 0.2
G	5.5	± 0.3
J	15.2	± 0.3
K	1	± 0.1
M	∅5	± 0.1

FRONT VIEW

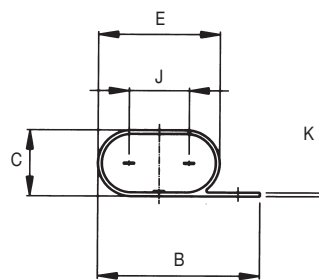

TOP VIEW

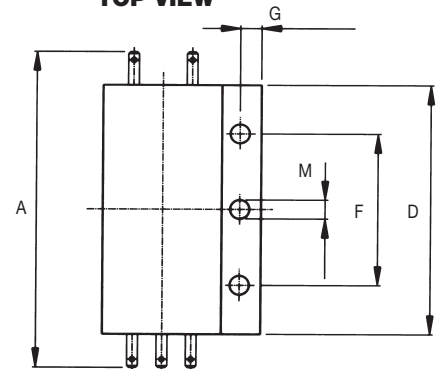

All dimensions in mm; 1 inch = 25.4 mm

X-ON Electronics

Largest Supplier of Electrical and Electronic Components

Click to view similar products for [Power Line Filters](#) category:

Click to view products by [Schaffner](#) manufacturer:

Other Similar products are found below :

[6609019-3](#) [6609026-5](#) [6609030-6](#) [6609973-2](#) [D30A](#) [7-1609090-5](#) [F2810](#) [F4456A](#) [F7382Z](#) [F7863Z](#) [FAHAV3100ZC000](#) [806276](#) [FN2020B-1-06](#) [FN2080B-10-06](#) [FN2410H-32-33](#) [FP144](#) [FS4153-20-06](#) [FS4353-500-99](#) [12-MMB-030-11-D](#) [DB4-393](#) [15811T200](#) [20B1](#) [LC630](#) [2B1](#) [1609080-2](#) [1609993-8](#) [1-6609070-1](#) [F1100AA02](#) [F1150CC10](#) [F1500CA10](#) [F1500CA15](#) [F4041Z](#) [F7585E](#) [1B1](#) [FN2070A-16-06](#) [FN2090A-20-06](#) [FN2090B-12-06](#) [FN2090Z-1-06](#) [FN2410H-25-33](#) [FN2410H-60-34](#) [FN2410H-8-44](#) [FN2412H-8-44](#) [FN323B-6-01](#) [FN3258H-130-35](#) [FN610R-3-06](#) [20EHQ7](#) [20EHZ7](#) [20K1](#) [30B6](#) [3K1](#)