

Type	Turns R.	$U_{eff}$ V	$U_p$ kV	$V_o \cdot t$ V $\mu$ s	$t_r$ $\mu$ s	$L_p$ mH	$L_{Str}$ $\mu$ H	$R_p$ $\Omega$	$R_s$ $\Omega$	$C_k$ pF	Case	Connec- tions	Weight ca. g
------	----------	----------------	-------------	----------------------------	------------------	-------------	----------------------	-------------------	-------------------	-------------	------	------------------	-----------------

**Ignition current 100 mA – 250 mA Rise time  $t_r$  at  $R_L = 40 \Omega$**

IT 235	1:1	500	4	300	1,2	3	40	0,75	0,75	7	5	8	13
IT 237	1:1	500	2,5	1'100	1	25	35	1,8	2,2	50	5	8	14
IT 238	1:1	1'000	4	300	2,3	3	80	0,8	0,8	7	5	7	13
IT 239	1:1	1'000	6	350	2,3	3	80	0,8	0,8	5	5	6	13
IT 255	1:1	750	4	250	1,1	2,2	40	0,7	0,7	8	3	3	6
IT 341	1:1	500	3,2	1'300	0,3	9	10	0,3	0,3	123	8	14	45
IT 213	1:1:1	380	2,5	450	0,4	6,5	20	1,4	1,5	40	2	2	9
IT 223	1:1:1	500	2,5	500	2,4	7	90	1,2	1,2	5	6	11	13
IT 233	1:1:1	500	4	300	1,3	3	45	0,75	0,75	7	5	9	13
IT 253	1:1:1	500	3,2	180	1,3	1,1	45	0,5	0,5	6	3	4	6
IT 312	1:1:1	380	2,5	1'200	1	21	35	2,4	2,7	30	7	13	24
IT 236	1:1:1:1	500	2,5	300	1,1	2	40	0,65	0,65	12	5	10	13
IT 248	2:1	750	3,2	350	1,8	17	80	3	1,5	9	3	3	6
IT 249	2:1:1	500	3,2	330	3,3	17	140	2,7	1,3	9	3	4	6
IT 234	3:1:1	500	4	300	1	17	40	2	0,6	9	5	9	13

**Ignition current 250 mA – 1 A Rise time  $t_r$  at  $R_L = 10 \Omega$**

IT 258	1:1	750	3,2	250	0,25	2,5	3	0,6	0,7	80	3	3	6
IT 331	1:1	380	2,5	1'300	1,6	26	15	0,6	0,6	65	7	12	32
IT 313	1:1:1	380	2,5	450	0,6	3	6	0,32	0,37	27	7	13	24
IT 332	3:1	380	2,5	1'200	1,2	200	60	6	0,5	65	7	12	33
IT 314	3:1:1	380	2,5	500	1	35	20	1,5	0,65	30	7	13	25

# Dimensions

# Connections

Type 2

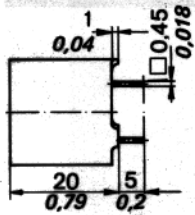
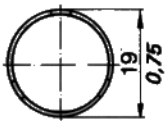

2

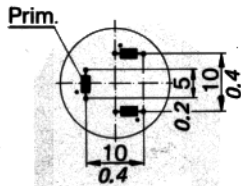

Type 3

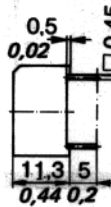
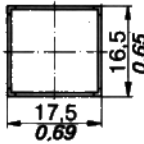

3

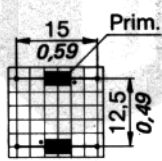

4

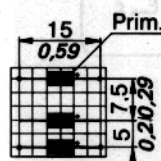

5

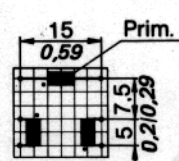

Type 5

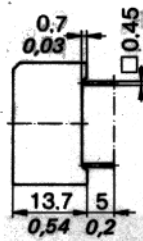
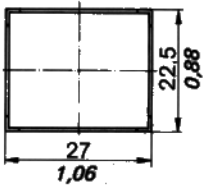

6

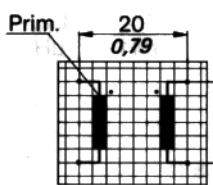

7

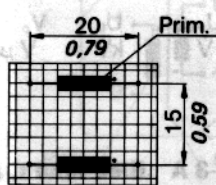

8

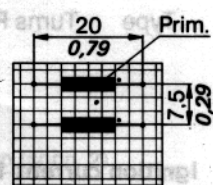

9

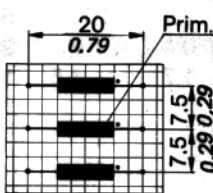

10

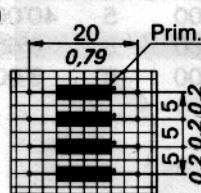

Type 6

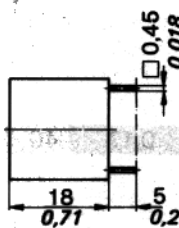
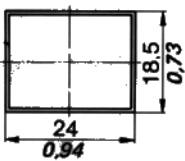

11

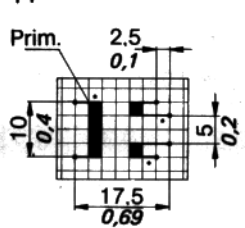

Type 7

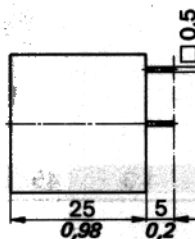
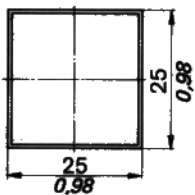

12

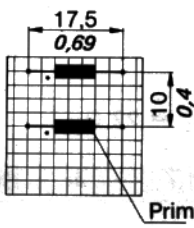

13

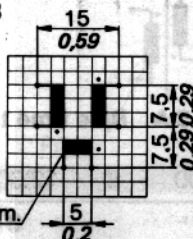

Type 8

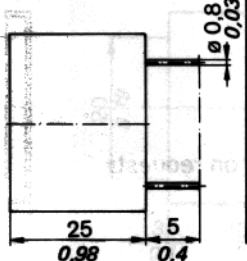
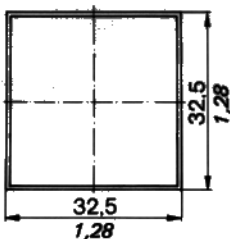

14

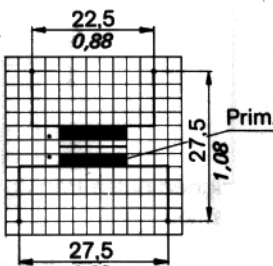

inches in italics

## X-ON Electronics

Largest Supplier of Electrical and Electronic Components

*Click to view similar products for [Pulse Transformers](#) category:*

*Click to view products by [Schaffner](#) manufacturer:*

Other Similar products are found below :

[E4001NLT](#) [1879401-1](#) [IF-18-0269-N](#) [T1042NLT](#) [T1049NL](#) [PE-68023NL](#) [PH0905NL](#) [PT4163S](#) [PT5010](#) [PA0173NLT](#) [CTX02-14608](#) [PE-65457NLT](#) [T60403-D4721-X088](#) [H1183NLT](#) [CTX33-18971-R](#) [HM2108NLT](#) [HM0068ANLT](#) [PG1427.001NLT](#) [750031353](#) [PH9400.566NLT](#) [PH9400.655ANLT](#) [PH9400.655NLT](#) [PH9385.013NLT](#) [B78307X0001](#) [B78307A2276A003](#) [HX6096FNL](#) [HX6106NLT](#) [P0926NL](#) [HX6096NL](#) [PA3493NLT](#) [P0585ANL](#) [H1183NL](#) [HU4102NL](#) [PH9385.012NLT](#) [PH9400.111NLT](#) [PH9400.211NLT](#) [PH9400.233ANLT](#) [SMQC1553-6](#) [78615/9JC-R](#) [SMQ1553-45](#) [Q1553-45](#) [Q1553-22](#) [Q1553-21](#) [PH9400.211ANLT](#) [TGM-050P3RL](#) [TGRAD-560V8LF](#) [TGMR-360V6LF](#) [P0544](#) [PA0264NLT](#) [T60403-D4215-X014](#)