

Plug union, straight

STV-GE G1/4-AG 6

Part no.:10.08.02.00205

<https://www.schmalz.com/10.08.02.00205>

Homepage > Vacuum Technology for Automation > Vacuum Components > Filters and Connections > Hoses and Connectors > Screw in Push Fittings > STV-GE G1/4-AG 6

Push-in Fitting, straight



Thread G1: G1/4"-M
 External hose diameter: 6 mm
 Material: Brass
 Surface: nickel plated
 Ambient temperature: -20 ... 80 °C

Design Data

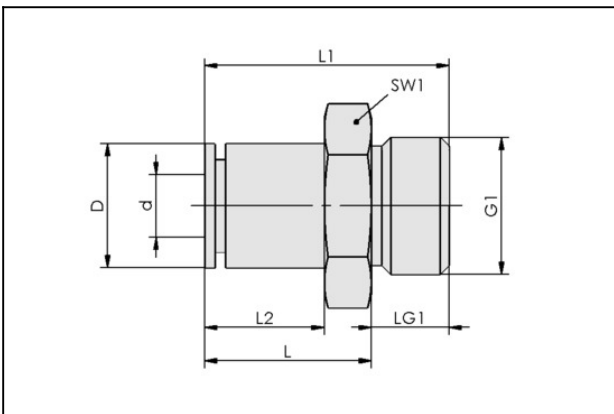

| Attribute | Value |
|-----------|----------|
| D | 11.2 mm |
| d | 6 mm |
| G1 | G1/4"-AG |
| dn | 4 mm |
| L | 15.2 mm |
| L1 | 23 mm |
| L2 | 10.7 mm |
| LG1 | 7.8 mm |
| SW1 | 17 mm |

Technical Data

Plug union, straight

STV-GE G1/4-AG 6

Part no.:10.08.02.00205

<https://www.schmalz.com/10.08.02.00205>



| Attribute | Value |
|-------------------------------------|----------------------|
| Hose type | Schlauch D = 6 d = 4 |
| Hose type | 6-4 |
| Material | Messing |
| Pressure range (operating pressure) | -0,95 ... 15,00 bar |
| Operating temperature | -20 ... 80 °C |
| Weight | 18 g |

Accessories

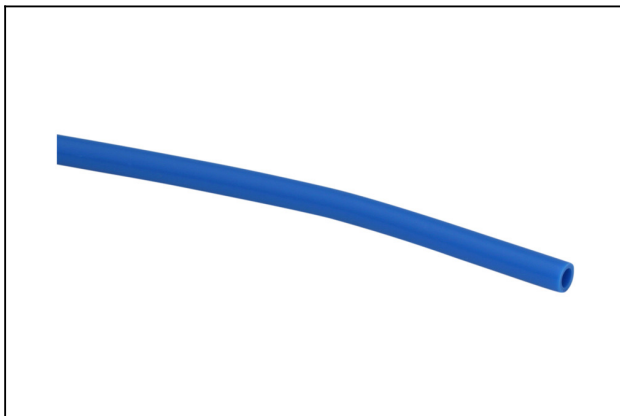

VSL 6-4 PE

Part no.10.07.09.00014

Hose for vacuum and compressed-air systems

External diameter D: 6 mm

Internal diameter d: 4 mm

Length (max): 100 m

Material: PE

Installation radius (min): 35 mm

Pressure range (operating pressure):

-0.95 ... 10.00 bar

Ambient temperature: -30 ... 70 °C



VSL 6-4 PTFE

Part no.10.07.09.00157

Hose for vacuum and compressed-air systems

External diameter D: 6 mm

Internal diameter d: 4 mm

Length (max): 50 m

Material: Polytetrafluorethylene

Installation radius (min): 35 mm

Colour: natur

Ambient temperature: -190 ... 260 °C

Plug union, straight

STV-GE G1/4-AG 6

Part no.:10.08.02.00205

<https://www.schmalz.com/10.08.02.00205>



VSL 6-4 PU

Part no.10.07.09.00002

Hose for vacuum and compressed-air systems

External diameter D: 6 mm

Internal diameter d: 4 mm

Length (max): 500 m

Material: PU

Installation radius (min): 35 mm

Pressure range (operating pressure):

-0.95 ... 10.00 bar

Ambient temperature: -20 ... 90 °C

X-ON Electronics

Largest Supplier of Electrical and Electronic Components

Click to view similar products for [Bench Top Tools](#) category:

Click to view products by [SCHMALZ](#) manufacturer:

Other Similar products are found below :

[0027](#) [6104-201-2102](#) [6104-201-2502](#) [6-1372442-6](#) [62500-1584](#) [63801-7252](#) [63801-7269](#) [69002-5525](#) [691667-1](#) [768539-1](#) [854130-1](#)
[854946-2](#) [856203-1](#) [904449-1](#) [9-22280-9](#) [986096-2](#) [992438-3](#) [1-21000-3](#) [1-21000-4](#) [1-21000-1](#) [1-25022-4](#) [1302263353](#) [1424264-1](#)
[1424267-1](#) [1428211-1](#) [1-455755-6](#) [1752324-1](#) [1752744-1](#) [18023-9](#) [189763-1](#) [1901726-1](#) [1954222-1](#) [2079747-1](#) [21001-2](#) [2119083-1](#)
[2119085-1](#) [2119371-1](#) [2161362-2](#) [2161930-1](#) [2217088-2](#) [2217339-1](#) [2217347-1](#) [22281-9](#) [22374-7](#) [240825-4](#) [992342-2](#) [2030790-2](#) [2063796-1](#) [2063799-2](#) [2119092-1](#)