

Product data sheet

Characteristics

XZCC8FCM40V

female, M8, 4-pin, elbowed connector - cable gland M9.5 x 1

Product availability: Non-Stock - Not normally stocked in distribution facility

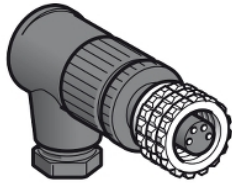

Main

Accessory / separate part category	Cabling accessories
Accessory / separate part type	Connector
Electrical connection	Elbowed female connector M8, 4 pins
Collar material	Metal
Status LED	Without
Cable connection	Vampire clip / wire size $\leq 0.25 \text{ mm}^2$ / clamping capacity $\leq 0.2 \text{ in (5 mm)}$

Complementary

Cable gland type	M9.5
Cable connector fixing	Screw-on
System Voltage	60 V AC 75 V DC
Line Rated Current	4 A
Enclosure material	Plastic
Insulating resistance	$> 1 \text{ G}\Omega$
Contact resistance	$\leq 10000 \mu\text{Ohm}$
Product weight	0.02 lb(US) (0.01 kg)

Environment

IP degree of protection	IP67
Ambient air temperature for operation	-13...158 °F (-25...70 °C)

Ordering and shipping details

Category	22483 - MACHINE CABLES
Discount Schedule	DS3
GTIN	003389110834680
Nbr. of units in pkg.	1
Package weight(Lbs)	0.02
Returnability	N
Country of origin	DE

Offer Sustainability

RoHS (date code: YYWW)	Compliant - since 0726 - Schneider Electric declaration of conformity Schneider Electric declaration of conformity
California proposition 65	WARNING: This product can expose you to chemicals including:
----- Substance 1	Diisononyl phthalate (DINP), which is known to the State of California to cause cancer, and
----- Substance 2	Di-isodecyl phthalate (DIDP), which is known to the State of California to cause birth defects or other reproductive harm.
----- More information	For more information go to www.p65warnings.ca.gov

Contractual warranty

Warranty period	18 months
-----------------	-----------

Dimensions

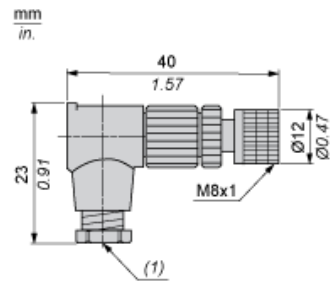

(1) Cable gland : M9.5 x 1

Connections and Schemes

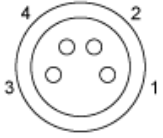

X-ON Electronics

Largest Supplier of Electrical and Electronic Components

Click to view similar products for [Schneider manufacturer](#):

Other Similar products are found below :

[ATV312H037M2](#) [LU9M1](#) [7D](#) [7S](#) [7XA1](#) [FNQR2](#) [8501RS44V24](#) [8501RSD14P14V51](#) [8501XO20V03Y414](#) [9001KR9RH13](#) [9001KXRK](#)
[9001SKR9P35RH25](#) [9001SKT35L31](#) [9003K2C003GA](#) [9007AA1](#) [9007BA1](#) [9007C54D](#) [9007C62A2](#) [9007CA11](#) [9007FA3](#) [9007HA4](#)
[9007HA6](#) [9007KA1](#) [9007KB11](#) [9007MS01S0206](#) [9012GAR4](#) [9012GAW2](#) [9012GBW1](#) [9012GDW5E3](#) [9012GFW1](#) [9012GNG1](#) [9012GNG3](#)
[9012GNG6](#) [9013FHG39J69](#) [9013FSG52J33M4](#) [9013GHG2J30](#) [9050JCK2F30V14](#) [GZ1E02](#) [ABL8MEM24003](#) [ABL8RPS24030](#)
[ATS01N206QN](#) [RSL1PRJU](#) [9001KA35](#) [9001KA3G](#) [9001KA4](#) [9001KR16H13](#) [9001KR1GH5](#) [9001KR1U](#) [9001KXSDC](#) [9007C52A2](#)