

Subminiature Fuse, 4.05 x 10 mm, Quick-Acting F, 250 VAC, 125 VDC



UL 248-14 · 250 VAC · 125 VDC · Quick-Acting F

See below:  
[Approvals and Compliances](#)

**Description**

- Low Breaking Capacity

**References**

Last order date: 30.04.2021  
 We recommend for new applications [SPT 3.6x10](#)

**Weblinks**

[pdf data sheet](#), [html datasheet](#), [General Product Information](#), [Distributor-Stock-Check](#), [Detailed request for product](#)

**Technical Data**

Rated Voltage	125 - 250 VAC, 125 VDC	Soldering Methods	Wave <a href="#">Soldering Profile</a>
Rated current	0.05 - 5 A	Solderability	235 °C / 2 sec acc. to IEC 60068-2-20, Test Ta, method 1
Breaking Capacity	50 A - 300 A	Resistance to Soldering Heat	260 °C / 5 sec acc. to IEC 60068-2-20, Test Tb, method 1A
Characteristic	Quick-Acting F		
Admissible Ambient Air Temp.	-40 °C to 85 °C		
Material: Tube	Ceramics		
Material: Axial Leads	Tin-Plated Copper		
Unit Weight	0.6 g		
Storage Conditions	0 °C to 60 °C, max. 70% r.h.		
Product Marking	, Rated current, Characteristic		

**Approvals and Compliances**

Detailed information on product approvals, code requirements, usage instructions and detailed test conditions can be looked up in [Details about Approvals](#)

SCHURTER products are designed for use in industrial environments. They have approvals from independent testing bodies according to national and international standards. Products with specific characteristics and requirements such as required in the automotive sector according to IATF 16949, medical technology according to ISO 13485 or in the aerospace industry can be offered exclusively with customer-specific, individual agreements by SCHURTER.

**Approvals**

The approval mark is used by the testing authorities to certify compliance with the safety requirements placed on electronic products.

Approval Reference Type: 172593

Approval Logo	Certificates	Certification Body	Description
	<a href="#">UL Approvals</a>	UL	UL File Number: E42088

**Product standards**

Product standards that are referenced

Organization	Design	Standard	Description
	Designed according to	UL 248-14	Low voltage fuses - Part 14: Additional fuses
	Designed according to	CSA22.2 No. 248.14	Low-Voltage Fuses - Part 14: Supplemental Fuses





**Application standards**

Application standards where the product can be used

Organization	Design	Standard	Description
	Designed for applications acc.	IEC/UL 62368-1	Audio/video, information and communication technology equipment - Part 1: Safety requirements

**Compliances**

The product complies with following Guide Lines

Identification	Details	Initiator	Description
	<a href="#">CE declaration of conformity</a>	SCHURTER AG	The CE marking declares that the product complies with the applicable requirements laid down in the harmonisation of Community legislation on its affixing in accordance with EU Regulation 765/2008.
	<a href="#">UKCA declaration of conformity</a>	SCHURTER AG	The UKCA marking declares that the product complies with the applicable requirements laid down in the British Amendment of Regulation (EC) 765/2008.
	RoHS	SCHURTER AG	Directive RoHS 2011/65/EU, Amendment (EU) 2015/863
	China RoHS	SCHURTER AG	The law SJ / T 11363-2006 (China RoHS) has been in force since 1 March 2007. It is similar to the EU directive RoHS.
	REACH	SCHURTER AG	On 1 June 2007, Regulation (EC) No 1907/2006 on the Registration, Evaluation, Authorization and Restriction of Chemicals 1 (abbreviated as "REACH") entered into force.

**Dimension [mm]**

10 mm

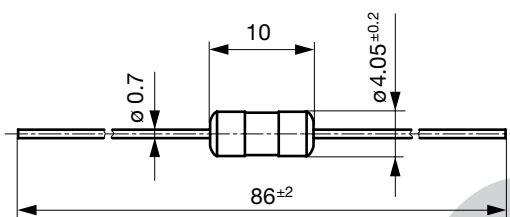

**Pre-Arcing Time**

Rated Current In	1.0 x In min.	2.0 x In max.	3.0 x In max.
0.05 A - 5 A	4 h	60 s	100 ms

Time-Current-Curves

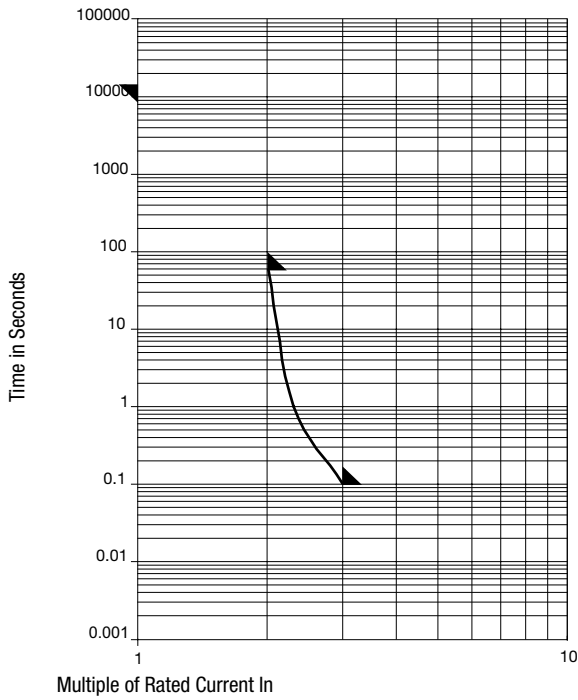

All Variants

Rated Current [A]	Rated Voltage [VAC]	Rated Voltage [VDC]	Breaking Capacity	Voltage Drop 1.0 I <sub>n</sub> typ. [mV]	Melting I <sup>2</sup> 10.0 I <sub>n</sub> typ. [A <sup>2</sup> s]	Order Number
0.05	250	125	1)	1150	0.00011	7010.1740.46
0.063	250	125	1)	735	0.00035	7010.1750.46
0.08	250	125	1)	950	0.00039	7010.1760.12
0.1	250	125	1)	875	0.00079	7010.1770.12
0.1	250	125	1)	875	0.00079	7010.1770.46
0.125	250	125	1)	870	0.0013	7010.1780.12
0.125	250	125	1)	870	0.0013	7010.1780.46
0.15	250	125	1)	545	0.0029	7010.1790.12
0.15	250	125	1)	545	0.0029	7010.1790.46
0.2	250	125	1)	520	0.0071	7010.1910.12
0.2	250	125	1)	520	0.0071	7010.1910.46
0.3	250	125	1)	920	0.021	7010.1920.12
0.3	250	125	1)	920	0.021	7010.1920.46
0.4	250	125	1)	725	0.057	7010.1930.12
0.4	250	125	1)	725	0.057	7010.1930.46
0.5	250	125	1)	725	0.069	7010.1800.46
0.6	250	125	1)	205	0.059	7010.1810.12
0.6	250	125	1)	205	0.059	7010.1810.46
0.8	250	125	1)	150	0.095	7010.1820.12
0.8	250	125	1)	150	0.095	7010.1820.46
1	250	125	1)	185	0.12	7010.1830.46
1.25	250	125	1)	125	0.29	7010.1840.12
1.25	250	125	1)	125	0.29	7010.1840.46
1.6	250	125	1)	135	0.48	7010.1850.12
1.6	250	125	1)	135	0.48	7010.1850.46
2	250	125	1)	110	0.95	7010.1860.12
2	250	125	1)	110	0.95	7010.1860.46
2.5	250	125	1)	145	1.2	7010.1870.12

Rated Current [A]	Rated Voltage [VAC]	Rated Voltage [VDC]	Breaking Capacity	Voltage Drop 1.0 I <sub>n</sub> typ. [mV]	Melting I <sup>2</sup> t 10.0 I <sub>n</sub> typ. [A <sup>2</sup> s]	Order Number
2.5	250	125	1)	145	1.2 ●	7010.1870.46
3	250	125	1)	220	1.8 ●	7010.1880.12
3	250	125	1)	220	1.8 ●	7010.1880.46
4	250	125	1)	130	3.4 ●	7010.1890.12
4	250	125	1)	130	3.4 ●	7010.1890.46
5	250	125	1)	105	7.7 ●	7010.1900.12
5	250	125	1)	105	7.7 ●	7010.1900.46

Availability for all products can be searched real-time: <https://www.schurter.com/en/Stock-Check/Stock-Check-SCHURTER>

1) 50 A @ 250 VAC/DC; 300 A @ 125 VAC/DC

#### Packaging Unit

.xx = .12  
.xx = .46

Plastic Bag (50 pcs.)  
Taped 19 cm Reel (1000 pcs.)

## X-ON Electronics

Largest Supplier of Electrical and Electronic Components

*Click to view similar products for* [Fuses with Leads - Through Hole](#) *category:*

*Click to view products by* [Schurter](#) *manufacturer:*

Other Similar products are found below :

[89096-013](#) [89096-015](#) [A170100400](#) [252010](#) [25202.5](#) [252.062](#) [263.500](#) [265.750](#) [272.005](#) [273.600V](#) [274.250](#) [SR-5H-5A-BK](#) [SS-5-800MA-AP](#) [SS-5F-3.15A-AP](#) [252004](#) [263.750](#) [273.005](#) [3701630000](#) [LKB-3](#) [0473004.MAT1L](#) [0473.750HAT1L](#) [0473001.HAT1L](#) [0473002.HAT1L](#) [0473.500HAT1L](#) [SS-5-1.6A-AP](#) [SS-5F-2.5A-AP](#) [SS-5-6.3A-BK](#) [SR-5H-4A-AP](#) [RST 5-AMMO](#) [SR-5H-3.15A-BK](#) [SR-5H-2A-BK](#) [89096-005](#) [SR-5F-1-6A-BK](#) [SS-5FH-3.15A-AP](#) [SS-5-630MA-AP](#) [047301.5HAT1L](#) [SS-5H-1-25A-APH](#) [SR-5H-800MA-APH](#) [0034.722](#) [34.732](#) [MSF 4A 250V](#) [22D03-200](#) [883324G](#) [883220G](#) [883317G](#) [883217G](#) [0263004.HAT1L](#) [0263.750HAT1L](#) [0473003.MXL](#) [0697-0100-01](#)