

8843 Line Filter • AC Inlet • Interchangeable Fusedrawer for 1/4 x 1 1/4" or 5 x 20mm Fuses

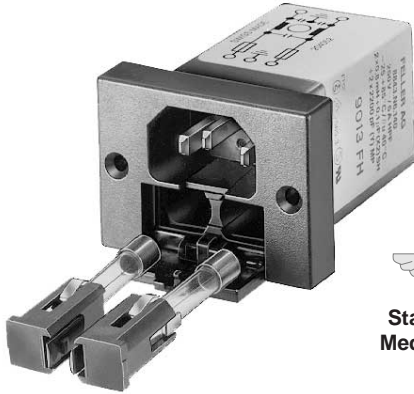

- For cold connections 70° C, Protection Class I
- Quick-connect terminals 250 x .032" (6.3 x 0.8mm)
- For attenuation graphs, see pages 66-71
- For general information on filters, see page 50
- For materials, options and accessories, see page 30
- For further description see unfiltered 8843, see page 37



UL	recognition	1A-10A/250V	File #E72928
CSA	certification	1A-10A/250V (standard filter only)	File #LR97784
VDE	approval	1A-10A/250V	File #32561
SEV	approval	1A-10A/250V	File number on request

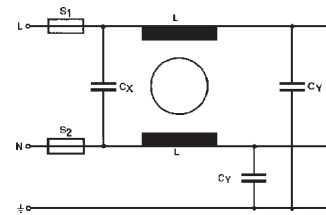

Standards: UL 1283; CSA C22.2/8; DIN/VDE 0565; IEC 320/C14; EN 60320

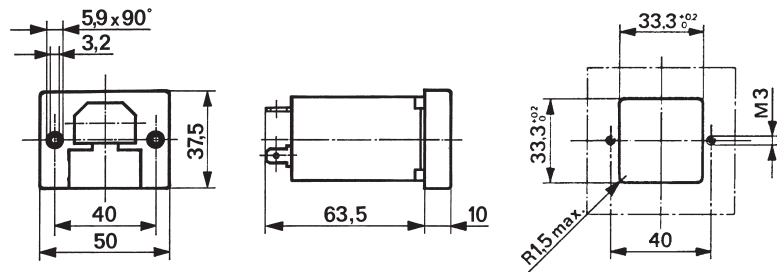

Order Number (type)

Note: Casing and fuseholders must be ordered separately. To order fuses, please see page 102.

Casing with standard RFI filter

8843 2-pole fusing	In (A) Ta 40°C	Un (V)	Max. leakage curr. @ 250V / 50Hz	Cx2 (nF)	Cy (nF)	L (mH)	Test voltage L,N E L N	Fuseholder inserts (2 inserts must be ordered for 2-pole fusing)
8843.8123.1 (8843.N1.140.60)	1A	up to 250V	< 0.5 mA	47	2.2	11	2700V DC 2 sec.	8843.0901 for 1/4 x 1 1/4" (8843-901.60) 8843.0902 for 5 x 20mm (8843-902.60)
8843.8323.1 (8843.N3.140.60)	3A	max.	< 0.5 mA	47	2.2	1.6		
8843.8623.1 (8843.N6.140.60)	6A	50/60 Hz	< 0.5 mA	47	2.2	0.8		
8843.8923.1 (8843.N10.140.60)	10A		< 0.5 mA	47	2.2	0.4		

Values of fuses (time-lag): IsI ≤ In : Operable at 400 Hz (increase leakage current by factor 8 at 250V and 4 at 125V)

Casing with medical RFI filter (low leakage)

8843 2-pole fusing	In (A) Ta 40°C	Un (V)	Max. leakage curr. @ 250V / 50Hz	Cx2 (nF)	L (mH)	Test voltage L,N E L N	Fuseholder inserts (2 inserts must be ordered for each casing)
8843.8123.3 (8843.N1.144.60)	1A	up to 250V	< 5 µA	47	11	2700V DC 2 sec.	8843.0901 for 1/4 x 1 1/4" (8843-901.60) 8843.0902 for 5 x 20mm (8843-902.60)
8843.8323.3 (8843.N3.144.60)	3A	max.	< 5 µA	47	1.6		
8843.8623.3 (8843.N6.144.60)	6A	50/60 Hz	< 5 µA	47	0.8		
8843.8923.3 (8843.N10.144.60)	10A		< 5 µA	47	0.4		

X-ON Electronics

Largest Supplier of Electrical and Electronic Components

Click to view similar products for [AC Power Entry Modules](#) category:

Click to view products by [Schurter](#) manufacturer:

Other Similar products are found below :

[0098.0050](#) [6167.0002](#) [6609100-2](#) [7-6609955-2](#) [FKI2-50-6/M5](#) [FN361-6-06](#) [FN389-4-22](#) [FN9226B-6-02](#) [FN9233S1-10-06](#) [FN9233S1-8-06](#)
[FN9233S1B-8-06](#) [FN9233S1R-1-06](#) [FN9233S1R-12-06](#) [FN9233SB-1-06](#) [FN9233SB-12-06](#) [FN9233SB-8-06](#) [FN9233SR-10-06](#) [FN9244B-15-06HI](#) [FN9244EB-3-06](#) [FN9244EB-8-06](#) [FN9244ER-15-06](#) [FN9244ER-8-06](#) [FN9244ES1-8-06](#) [FN9244ESB-8-06](#) [FN9244R-12-06](#)
[FN9244S1-12-06](#) [FN9244S1R-3-06](#) [FN9244SB-8-06](#) [FN9244SR-6-06](#) [FN9244U-3-06](#) [FN9244U-8-06](#) [8-6609940-2](#) [PE00SSSXB](#) [Fuse-H-EUR-1](#) [Fuse-H-USA-1](#) [PM00XD000](#) [A-0701-HT-H](#) [15EJMS8](#) [1-6609941-2](#) [200JM6-2](#) [CA121003-6](#) [SK-1015\(F1-5\)](#) [161-R3015-E](#) [1-6609153-2](#) [FN323-1-05](#) [FN9233B-8-06](#) [FN9233EB-1-06](#) [FN9233ES1R-10-06](#) [FN9233R-12-06](#) [FN9233S-10-06](#)