

Universal Door Strike

SD-996C-NUQ

12/24 VDC, Fail-Safe or Fail-Secure

The **SECO-LARM®** Universal Door Strike can be used with virtually any cylindrical-locking system and can be configured for use in wood, aluminum, or metal doors. Included are three different-sized faceplates that can be easily installed on the strike to match the specific type of door frame.

Features:

- Includes 3 faceplates for nearly any door type
- UL 1304 Burglary
- Field-selectable for fail-safe or fail-secure operation
- Field-selectable dual-voltage 12/24 VDC operation
- Powered by a solenoid
- Reversible non-handed design fits either right-hand or left-hand doors
- Low profile: Strike is only 1 1/4" deep for use with hollow aluminum frames
- Includes trim plate to hide gaps in installation
- Optional lip-extension brackets available:
 - SD-995C-LE25 - 1" Extension
 - SD-995C-LE50 - 2" Extension

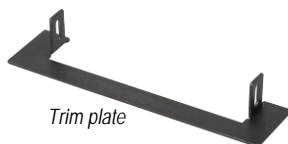

Specifications:

Model	SD-996C-NUQ	
Operating voltage	12 or 24 VDC ± 15%	
Current draw	12VDC	280mA@12VDC
	24VDC	140mA@24VDC
Operating temperature	14°~113° F (-10°~45° C)	
Operating humidity	85% ± 15%	
Jaw strength	2,000-lb	
Dimensions	Aluminum	4 7/8" x 1 1/4" (124x32 mm)
	Hollow metal	4 7/8" x 1 1/4" (124x32 mm)
	Wood	7 15/16" x 1 7/16" (202x37 mm)



Power Connector
for easier installation

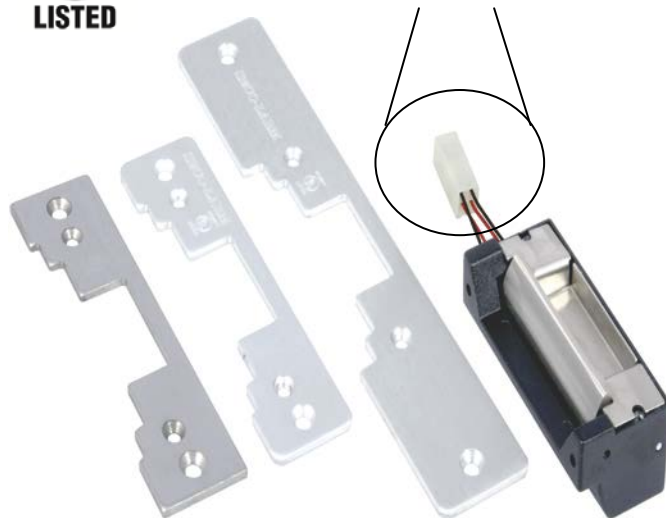

Also Available from SECO-LARM®:



SD-995C
SD-995C24
Electric Door Strike
for Metal Doors



SD-995C
SD-995C24
Electric Door Strike
for Wood Doors

SECO-LARM® U.S.A., Inc.

16842 Millikan Avenue, Irvine, CA 92606

Phone: (949) 261-2999 | (800) 662-0800 Fax: (949) 261-7326

Website: www.seco-larm.com Email: sales@seco-larm.com



Copyright 2015 © SECO-LARM U.S.A., Inc. All rights reserved. All trademarks are the property of SECO-LARM U.S.A., Inc. or their respective owners. The SECO-LARM policy is one of continual development. For that reason, SECO-LARM reserves the right to change prices and specifications without notice. SECO-LARM is not responsible for misprints.

SECO-LARM® ENFORCER® CRIMEBUSTER® CBA SLI®

PiSD-996C-NUQ_151006.docx

X-ON Electronics

Largest Supplier of Electrical and Electronic Components

Click to view similar products for [SECO-LARM](#) manufacturer:

Other Similar products are found below :

[SD-7202GC-PEQ](#) [SS-040Q WHITE](#) [NE-SE01-020Q](#) [SM-226RQ](#) [E-941SA-1200](#) [CA-1616Q](#) [SS-090-2H1](#) [RA-4961-DSQ](#) [SL-1301-BAQ/B](#)
[SM-4303-TQ/W](#) [SS-090-2H0](#) [E-936-S45RRGQ](#) [SA-027WQ](#) [SD-997B-GBQ](#) [SL-126Q/A](#) [SM-4201-LQ](#) [SL-1301-BAQ/C](#) [SK-1011-SDQ](#)
[SM-4601-LQ](#) [SA-025Q](#) [SM-200Q/BR](#) [NJ-P101M-PQ](#) [SL-126Q/B](#) [SL-126Q/C](#) [SM-207-5Q/BR](#) [SL-1301-BAQ/R](#) [SM-4601-L3Q](#) [SL-1312-](#)
[SA/R](#) [SM-205Q/BR](#) [SM-4105-LQ/B](#) [SS-073Q](#) [SL-126Q/R](#) [SM-216Q/GY](#) [CA-1610-3FLQ](#) [SM-4301-TQW](#) [SM-226LQ](#) [SM-4105-LQ/W](#)
[CA151T](#) [SM-300Q/W](#) [SM-204Q/W](#) [SM-226L-3Q](#) [E-941SA-80Q](#) [CA-161T](#) [SS-072Q](#)