

Argon ONE

Pi 4
V2

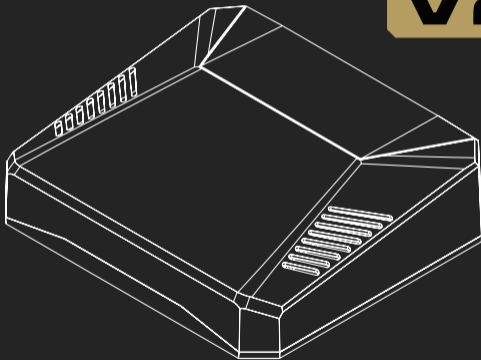

ARGON ONE PI 4 V2 PARTS

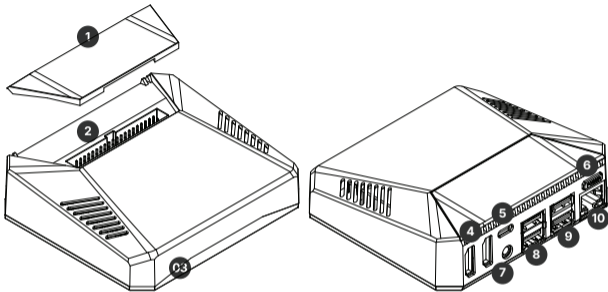

1 Magnetic Removable Top Cover

2 40 Pin GPIO Access

3 SD Card Slot

4 2 x Full HDMI

5 USB-C Power In

6 Power Button

7 Audio Out

8 2 x USB 2.0

9 2 x USB 3.0

10 Gigabit Ethernet

ASSEMBLY INSTRUCTIONS

- 1 Connect Raspberry Pi to HDMI-Audio Board and stick Silicon Thermal Pads.

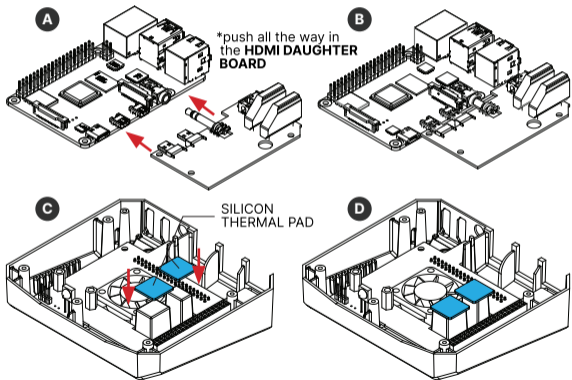

- 2 Carefully connect Raspberry Pi GPIO to Power and Cooling Board. Press POWER ON button to start.

Please make sure that the microSD Card is NOT inserted to the Raspberry Pi during assembly.

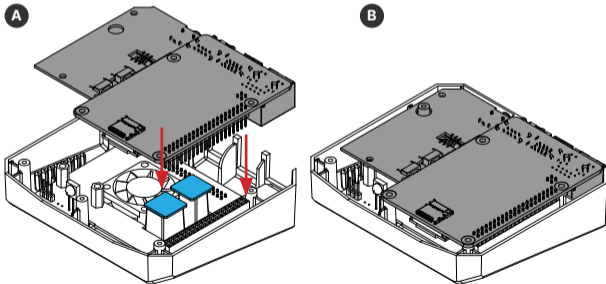

- 3 Use shorter **flat head screws** to fasten Raspberry Pi and HDMI Board assembly to top case.

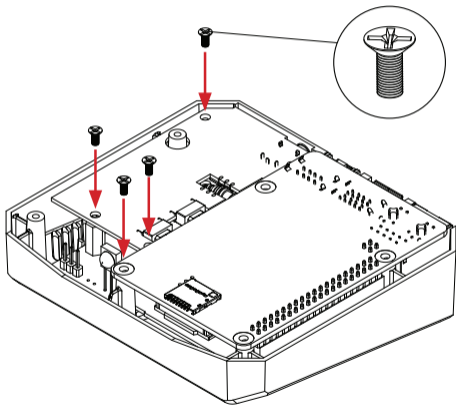

4 Select the **Argon ONE** Power Button Management Mode:

JUMPER PIN SETTING	MODE	BEHAVIOUR
Pin 1-2	Default Setting (Mode 1)	You need to PRESS button to Power ON from shutdown or power outage.
Pin 2-3	Always ON (Mode 2)	Power current will flow directly to Raspberry Pi. NO need to PRESS button to power ON from power outage

see Next Page

ARGON ONE PI 4 V2 JUMPER PIN SETTING

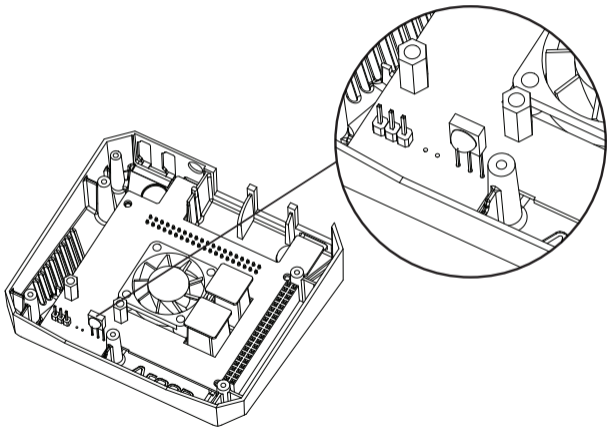

- 5 Use longer **round head screws** to fasten bottom cover and place **rubber footings**.

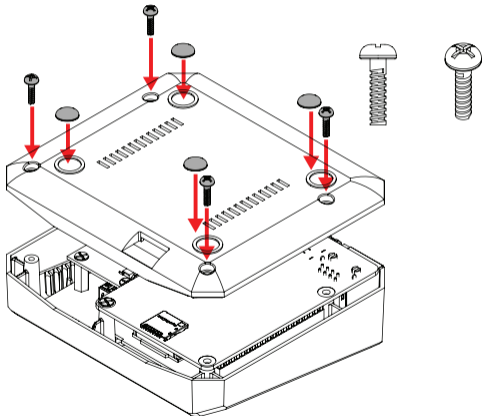

- 6 Insert SD Card in SD Card slot. Plug HDMI and Power Supply.

Don't forget to PRESS Power Button to TURN ON

A

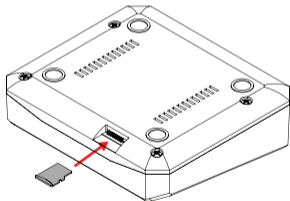

B

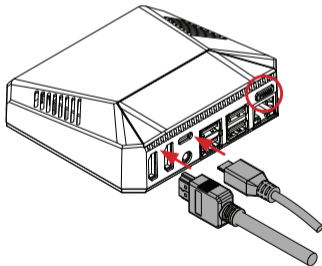

HOW TO INSTALL ARGON ONE PI 4 V2 POWER BUTTON & FAN CONTROL

Coding

Maker
Alert

1. Connect to the internet.
2. Open "Terminal" in Raspbian.
3. Type the text below in the "Terminal" to initiate installation of **Argon ONE Pi 4** script.

```
curl https://download.argon40.com/argon1.sh | bash
```

4. Reboot.

ARGON ONE PI 4 V2

POWER BUTTON FUNCTIONS

The process above will automatically install the configuration that will activate the **Argon ONE Pi 4** Power Button with the following functions.

ARGON ONE Pi 4 STATE	ACTION	FUNCTION
OFF	Short Press	Turn ON
ON	Long Press (≥ 3 s)	Soft Shutdown and Power Cut
ON	Short press (< 3 s)	Nothing
ON	Double tap	Reboot
ON	Long Press (≥ 5 s)	Forced Shutdown

ARGON ONE PI 4 V2 FAN SPEED

Upon installation of the **Argon ONE Pi 4** script by default, the settings of the **Argon ONE Pi 4** cooling system are as follows:

CPU TEMP	FAN POWER
55 C	10%
60 C	55%
65 C	100%

Coding

Maker
Alert

However, you may change or configure the FAN to your desired settings by clicking the **Argon ONE Pi 4 Config** icon on your Desktop.

Or via "Terminal" by typing and following the specified format:

```
argonone-config
```

UNINSTALLING ARGON ONE PI 4 V2 SCRIPT

To uninstall the **Argon ONE Pi 4** script you may do so by clicking the **Argon ONE Pi 4** Uninstall icon on your Desktop.

You may also remove the script via “Terminal” by typing:

```
argonone-uninstall
```

Always reboot after changing any configuration or uninstallation for the revised settings to take effect.

BUILT-IN INFRARED RECEIVER

The latest version has a programmable Infrared Receiver installed that can turn ON and OFF the device using the proprietary Argon 40 remote.

To configure the **Infrared Receiver ON/OFF signal of Argon ONE V2 and M.2** type in the Terminal App:

```
argonone-ir
```

Then follow the instructions indicated.

For more information please visit:

<https://www.argon40.com/learn/>

X-ON Electronics

Largest Supplier of Electrical and Electronic Components

Click to view similar products for [Enclosures, Boxes & Cases](#) *category:*

Click to view products by [Seed Studio](#) *manufacturer:*

Other Similar products are found below :

[585-R-WH-PK](#) [60221-01](#) [60566-01-000](#) [HPL-9VB BATT DOOR](#) [M18-PLTD](#) [M-21-PLATED](#) [63310-01-000](#) [6711GSKT](#) [71884-29-028](#)
[LH45-100 Black](#) [72868-510-000](#) [CNS-0000 Black](#) [72883-510-000](#) [CNS-0101 Black](#) [72906-510-000](#) [CNS-0407 Black](#) [73092-510-000](#) [CNM-](#)
[0101 Black](#) [73105-510-000](#) [CNL-0101 Black](#) [73108-510-000](#) [CNL-0303 Black](#) [73395-510-039](#) [CNS-0006 Bone](#) [74016-510-000](#) [CNL-0006](#)
[Black](#) [74257-510-000](#) [CNL-0004](#) [MDC-1183-PLAIN-ALUM](#) [MDC-1183-PTD](#) [MDC-13104-PTD](#) [MDC-321-PTD](#) [MDC-973-PTD](#) [76](#)
[77153-01-028](#) [FLX6030](#) [83535-01-508](#) [90026-501-000](#) [PS36-200](#) [116-508](#) [120-407](#) [120-910](#) [127-908](#) [130-008](#) [1301170079](#) [1322GSKTEP](#)
[1325GSKT3](#) [138-PLAIN](#) [1434-1210](#) [EAS-500 \(BLACK ANO\)](#) [1804RP-RB-PK](#) [190-005](#) [2202307](#) [KAB3321 BLACK](#) [KAB3421](#) [2697466](#)
[S52213](#) [2901123](#) [2901699](#) [A0645271](#) [A20P20](#) [2106-IR](#)