

Description

Planar Maximum Efficiency General Application (MEGA) schottky barrier diode with an integrated guard ring for stress protection encapsulated in a SOD-923 small package.

Feature

- Small body outline dimensions
- Very low forward voltage
- Forward current: 0.5A
- MLS: Lever 1 – unlimited

Application

- Ultra high-speed switching
- Voltage clamping
- Protection circuits
- Low voltage rectification
- High efficiency DC-to-DC conversion
- Low power consumption applications

Typical Applications

General purpose use in ac-to-dc bridge full wave rectification for Switching Power Supply, Home Appliances, Office Equipment, Industrial Automation applications

Maximum Ratings and Electrical Characteristics

Ratings at 25°C ambient temperature unless otherwise specified.

Parameter	Symbols	Conditions	Min	Max	Units
Continuous reverse voltage	V_{RRM}			20	V
Repetitive peak forward current	I_{FRM}	$t_p \leq 1\text{ms};$ $\delta \leq 0.25$		2.5	A
Continuous forward current	I_F			0.5	A
Non-repetitive peak forward current	I_{FSM}	$t=8\text{ms}$ square wave		3.0	A
Junction temperature	T_j			150	°C
Operating ambient temperature	I_{amb}		-65	+150	°C
Storage temperature	T_{stg}		-65	+150	°C

Notes: For Schottky barrier diodes thermal run-away has to be considered, as in some applications the reverse power losses PR are a significant part of the total power losses. Nomograms for determining the reverse power losses PR and IF(AV) rating will be available on request.

S2005ELD

Reverse Voltage 20 Volts
Forward Current 0.5 Amperes

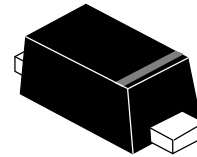

SOD-923

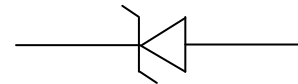

Schematic Diagram

Characteristics

T_{amb}=25°C unless otherwise specified

Parameter	Symbols	Conditions	Typ	Max	Units
Continuous forward voltage	V _F	I _F =0.1mA	125	180	mV
		I _F =1mA	185	240	mV
		I _F =10mA	250	290	mV
		I _F =100mA	325	380	mV
		I _F =500mA	450	500	mV
Continuous reverse current	I _R	V _R =10V	4	30	μA
Diode capacitance	C _d	V _R =1V;f=1MHz	24	30	pF

Pulse test:tp≤300μs; δ≤0.02

Typical Performance Curves

Fig.1 Forward current as a function of forward Voltage;typical values

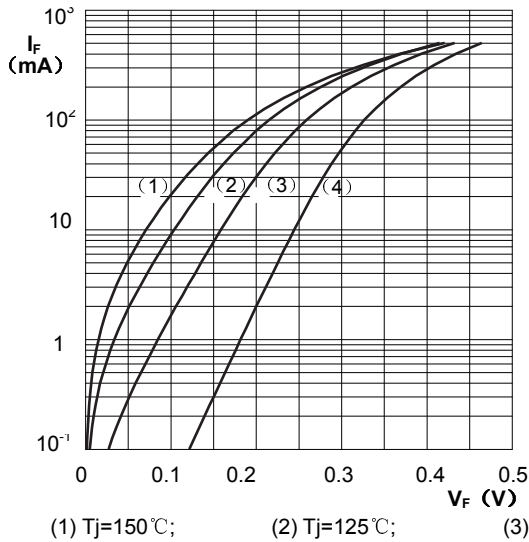

Fig.2 Reverse current as a function of reverse voltage;typical values

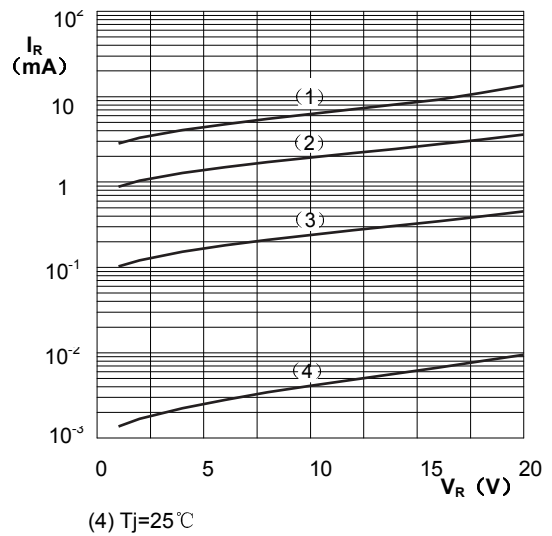
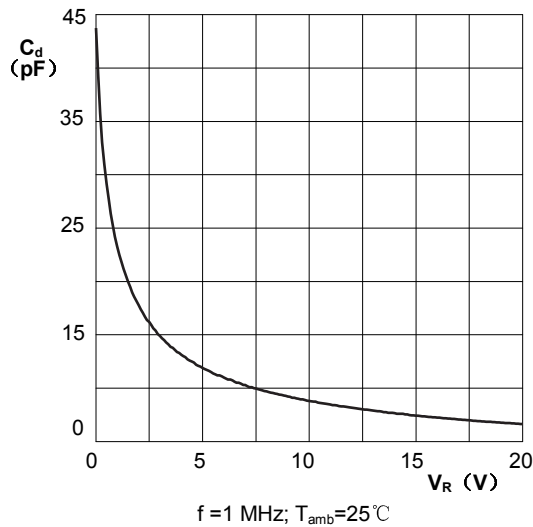
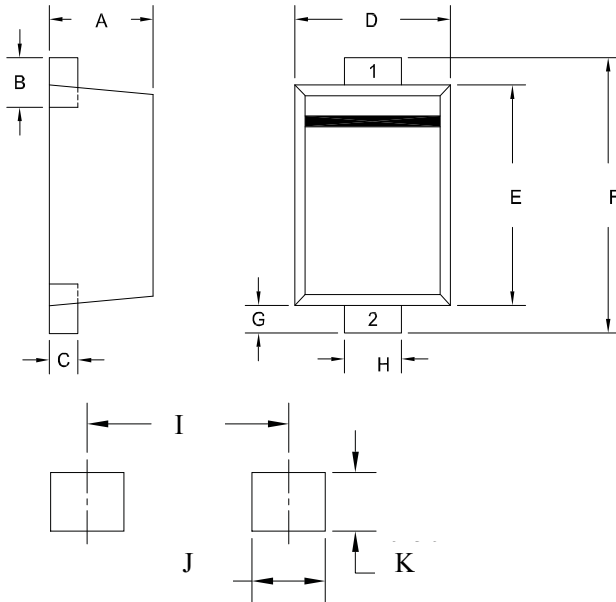

Fig.3 Diode capacitance as a function of reverse Voltage;typical values



Product Dimension



Dim	millimeters	
	min	max
A	0.39	0.41
B	0.10	0.26
C	0.08	0.14
D	0.55	0.65
E	0.75	0.85
F	0.90	1.10
G	0.05	0.15
H	0.17	0.27
I	0.90	
J	0.40	
K	0.30	

Package Informations

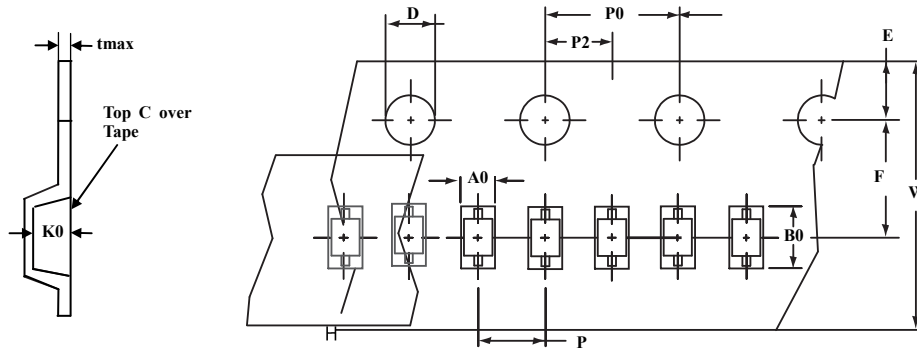

A0	B0	K0	D	E	F	W	P0	P2	P	tmax
0.70 ± 0.05	1.12 ± 0.05	0.48 ± 0.05	1.50 ± 0.10	1.75 ± 0.10	3.50 ± 0.05	8.00 ± 0.20	4.00 ± 0.10	2.00 ± 0.05	2.00 ± 0.05	0.25

Part Number System

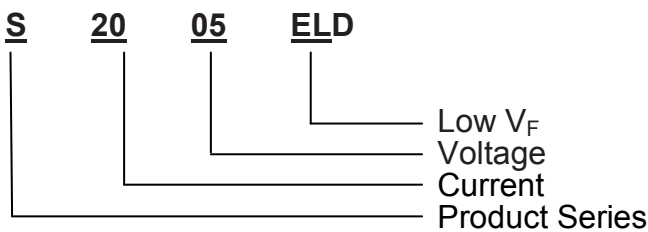

Marking

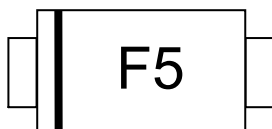

Order Information

Device	Package	Net Weight	Carrier	Quantity	HSF Status
S2005ELD	SOD-923	0.0006g	Tape & Reel	5000pcs	RoHS compliant

Revision history

Date	Revision	Description of changes
13-September-2011	A	First issue

CAUTION / WARNING

- Information in this document is believed to be accurate and reliable. However, SEMITEL does not give any representations or warranties, expressed or implied, as to the accuracy or completeness of such information and shall have no liability for the consequences of use of such information.
- Users should independently evaluate the suitability of and test each product selected for their own applications, and SEMITEL assumes no liability whatsoever relating to the choice, selection or use of the SEMITEL products and services described herein.
- SEMITEL reserves the right to change or update, without notice, any information contained in this publication; to change, without notice, the design, construction, processing, or specification of any product; and to discontinue or limit production or distribution of any product.
- Information in this document supersedes and replaces all information previously supplied.
- Products are not designed, authorized or warranted to be suitable for use in medical, military, aircraft, space or life support equipment, nor in applications where failure or malfunction of an SEMITEL product can reasonably be expected to result in personal injury, death or severe property or environmental damage. SEMITEL accepts no liability for inclusion and/or use of SEMITEL products in such equipment or applications and therefore such inclusion and/or use is at the customer's own risk.
- This document as well as the item(s) described herein may be subject to export control regulations. Export might require a prior authorization from national authorities.
- Resale of SEMITEL products with provisions different from the statements and/or technical features set forth in this document shall immediately void any warranty granted by SEMITEL for the SEMITEL product or service described herein and shall not create or extend in any manner whatsoever, any liability of SEMITEL.
- SEMITEL expressly disclaims all implied warranties regarding the information contained herein, including, but not limited to, any implied warranties of merchantability or fitness for a particular purpose. SEMITEL only obligations are those in the SEMITEL Standard Terms and Conditions of Sale and in no case will SEMITEL be liable for any incidental, indirect, or consequential damages arising from the sale, resale, use, or misuse of its products.

Specifications are subject to change without notice

© Copyright 2005, Semitel Electronics



. © is a registered trademark of Semitel Electronics

All rights reserved

X-ON Electronics

Largest Supplier of Electrical and Electronic Components

Click to view similar products for [Schottky Diodes & Rectifiers](#) category:

Click to view products by [Semitel](#) manufacturer:

Other Similar products are found below :

[MA4E2039](#) [MA4E2508M-1112](#) [MBR10100CT-BP](#) [MBR1545CT](#) [MMBD301M3T5G](#) [GS1JE-TP](#) [RB160M-50TR](#) [BAS 3010S-02LRH E6327](#)
[BAT 54-02LRH E6327](#) [NSR05F40QNXT5G](#) [NSVR05F40NXT5G](#) [NTE555](#) [JANS1N6640](#) [SB07-03C-TB-H](#) [SBAT54CWT1G](#) [SK310-T](#)
[SK33A-TP](#) [SK34B-TP](#) [SS3003CH-TL-E](#) [PDS3100Q-7](#) [GA01SHT18](#) [CRS10I30A\(TE85L,QM](#) [MA4E2501L-1290](#) [MBRB30H30CT-1G](#)
[BAS 70-02L E6327](#) [DMJ3940-000](#) [SB007-03C-TB-E](#) [SK32A-TP](#) [SK33B-TP](#) [SK35A-TP](#) [SK38B-LTP](#) [SK38B-TP](#) [NTE505](#)
[NTSB30U100CT-1G](#) [VS-6CWQ10FNHM3](#) [CRG04\(T5L,TEMQ\)](#) [ACDBA1100LR-HF](#) [ACDBA1200-HF](#) [ACDBA140-HF](#) [ACDBA2100-HF](#)
[ACDBA240-HF](#) [ACDBA3100-HF](#) [CDBQC0530L-HF](#) [BAT54-13-F](#) [ACDBA340-HF](#) [ACDBA260LR-HF](#) [ACDBA1100-HF](#) [MA4E2502L-](#)
[1246](#) [10BQ060-M3/5BT](#) [10BQ040-M3/5BT](#)