



# HS103DR SERIES ASSEMBLIES

DIN RAIL MOUNT



## Features

- 55 amp AC output @ 40°C
- Single Channel or 3 Phase output
- 3 to 32 VDC input control voltage
- DIN Rail mounted
- UL, CSA, VDE, CE approved SSRs
- Epoxy free design



## SPECIFICATIONS

### Output <sup>(1)</sup>

Description	HS103DR-D2490	HS103DR-HD6090
<b>Operating Voltage (47-63Hz) [Vrms]</b>	24-280	48-660
<b>Transient Overvoltage [Vpk]</b>	600	1200
<b>Maximum Off-State Leakage Current @ Rated Voltage [mArms]</b>	1.0	1.0
<b>Minimum Off-State dv/dt @ Maximum Rated Voltage [V/μsec] <sup>(2)</sup></b>	500	500
<b>Maximum Load Current [Arms]</b>	55	55
<b>Minimum Load Current [Arms]</b>	150	150
<b>Maximum Surge Current (16.6ms) [Apk]</b>	1200	1200
<b>Maximum On-State Voltage Drop @ Rated Current [Vac]</b>	1.15	1.15
<b>Maximum I<sup>2</sup>t for Fusing (8.3 msec) [A<sup>2</sup> sec]</b>	6000	6000
<b>Minimum Power Factor (with Maximum Load)</b>	0.5	0.5

## Input<sup>(1)</sup>

Description	HS103DR-D2490	HS103DR-HD6090
<b>Control Voltage Range</b>	3-32 VDC	4-32 VDC
<b>Minimum Turn-On Voltage</b>	3.0 VDC	4.0 VDC
<b>Minimum Turn-Off Voltage</b>	1.0 VDC	1.0 VDC
<b>Maximum Reverse Voltage</b>	-32 VDC	-32 VDC
<b>Minimum Input Current</b>	7.0 mA	7.0 mA
<b>Maximum Input Current</b>	12 mA	12 mA
<b>Nominal Input Impedance</b>	Curent Regulated	Curent Regulated
<b>Maximum Turn-On Time [msec]</b>	1/2 Cycle	1/2 Cycle
<b>Maximum Turn-Off Time [msec]</b>	1/2 Cycle	1/2 Cycle

## General

Description	HS103DR-Dxx90
<b>Dielectric Strength, Input/Output/Base (50/60Hz)</b>	4000 Vrms
<b>Minimum Insulation Resistance (@ 500 V DC)</b>	10 9 Ohms
<b>Maximum Capacitance, Input/Output</b>	8 pF
<b>Ambient Operating Temperature Range</b>	-40 to 80°C
<b>Ambient Storage Temperature Range</b>	-40 to 125°C
<b>Status Indicator Display</b>	None
<b>Weight (typical)</b>	1.36 lb. (619 g)
<b>Recommended Terminal Screw Torque Range: (in-lbs/Nm)</b>	6-32 Screws - 13-15/1.5-17. 8-32 Screws - 18-20/2-2.2. (Screws dry without grease)
<b>Thermal pad installed</b>	Yes

## PRODUCT SELECTION

Description	55A	55A
<b>3-32 VDC Control</b>	HS103DR-D2490	HS103DR-HD6090

## GENERAL NOTES

<sup>(1)</sup> All parameters at 25°C unless otherwise specified.

<sup>(2)</sup> Off-State dv/dt test method per EIA/NARM standard RS-443, paragraph 13.11.1



## DIMENSIONS

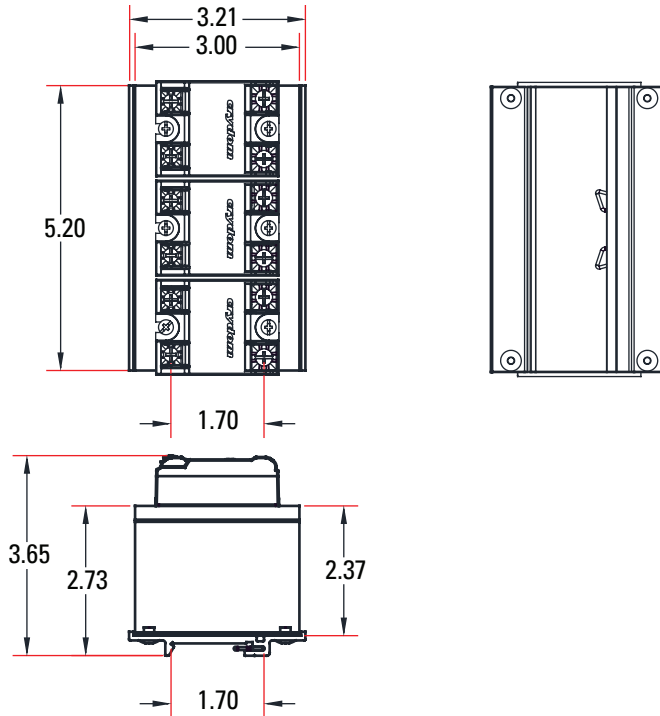

## THERMAL DERATE INFORMATION

HS103DR w/90A SSR or  
1-25A 3-Phase SSR

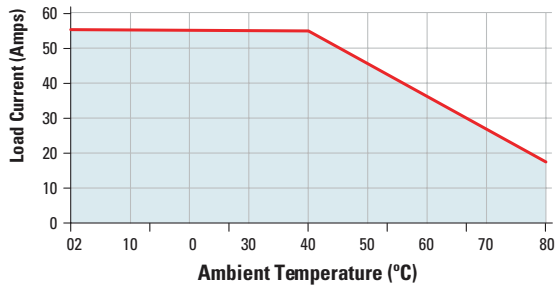

## AGENCY APPROVALS & CERTIFICATIONS

Designed in accordance with the requirements of IEC 62314  
Agency approvals are for relay only.

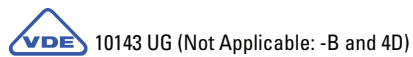



## WARNINGS



### RISK OF MATERIAL DAMAGE AND HOT ENCLOSURE

- The product's side panels may be hot, allow the product to cool before touching
- Follow proper mounting instructions including torque values
- Do not allow liquids or foreign objects to enter this product

**Failure to follow these instructions can result in serious injury, or equipment damage.**



### HAZARD OF ELECTRIC SHOCK, EXPLOSION OR ARC FLASH

- Disconnect all power before installing or working with this equipment
- Verify all connections and replace all covers before turning on power

**Failure to follow these instructions will result in death or serious injury.**

Sensata Technologies, Inc. ("Sensata") data sheets are solely intended to assist designers ("Buyers") who are developing systems that incorporate Sensata products (also referred to herein as "components"). Buyer understands and agrees that Buyer remains responsible for using its independent analysis, evaluation and judgment in designing Buyer's systems and products. Sensata data sheets have been created using standard laboratory conditions and engineering practices. Sensata has not conducted any testing other than that specifically described in the published documentation for a particular data sheet. Sensata may make corrections, enhancements, improvements and other changes to its data sheets or components without notice.

Buyers are authorized to use Sensata data sheets with the Sensata component(s) identified in each particular data sheet. HOWEVER, NO OTHER LICENSE, EXPRESS OR IMPLIED, BY ESTOPPEL OR OTHERWISE TO ANY OTHER SENSATA INTELLECTUAL PROPERTY RIGHT, AND NO LICENSE TO ANY THIRD PARTY TECHNOLOGY OR INTELLECTUAL PROPERTY RIGHT, IS GRANTED HEREIN. SENSATA DATA SHEETS ARE PROVIDED "AS IS". SENSATA MAKES NO WARRANTIES OR REPRESENTATIONS WITH REGARD TO THE DATA SHEETS OR USE OF THE DATA SHEETS, EXPRESS, IMPLIED OR STATUTORY, INCLUDING ACCURACY OR COMPLETENESS. SENSATA DISCLAIMS ANY WARRANTY OF TITLE AND ANY IMPLIED WARRANTIES OF MERCHANTABILITY, FITNESS FOR A PARTICULAR PURPOSE, QUIET ENJOYMENT, QUIET POSSESSION, AND NON-INFRINGEMENT OF ANY THIRD PARTY INTELLECTUAL PROPERTY RIGHTS WITH REGARD TO SENSATA DATA SHEETS OR USE THEREOF.

All products are sold subject to Sensata's terms and conditions of sale supplied at [www.sensata.com](http://www.sensata.com) SENSATA ASSUMES NO LIABILITY FOR APPLICATIONS ASSISTANCE OR THE DESIGN OF BUYERS' PRODUCTS. BUYER ACKNOWLEDGES AND AGREES THAT IT IS SOLELY RESPONSIBLE FOR COMPLIANCE WITH ALL LEGAL, REGULATORY AND SAFETY-RELATED REQUIREMENTS CONCERNING ITS PRODUCTS, AND ANY USE OF SENSATA COMPONENTS IN ITS APPLICATIONS, NOTWITHSTANDING ANY APPLICATIONS-RELATED INFORMATION OR SUPPORT THAT MAY BE PROVIDED BY SENSATA.

Mailing Address: Sensata Technologies, Inc., 529 Pleasant Street, Attleboro, MA 02703, USA.

## CONTACT US

### Americas

+1 (877) 502 5500 – Option 2  
[sales.crydom@sensata.com](mailto:sales.crydom@sensata.com)

### Europe, Middle East & Africa

+44 (1202) 416170  
[ssr-info.eu@sensata.com](mailto:ssr-info.eu@sensata.com)

### Asia Pacific

[sales.isasia@list.sensata.com](mailto:sales.isasia@list.sensata.com)  
 China +86 (21) 2306 1500

Japan +81 (45) 277 7117

Korea +82 (31) 601 2004

India +91 (80) 67920890

Rest of Asia +886 (2) 27602006  
 ext 2808

## X-ON Electronics

Largest Supplier of Electrical and Electronic Components

*Click to view similar products for [Solid State Relays - Industrial Mount](#) category:*

*Click to view products by [Sensata](#) manufacturer:*

Other Similar products are found below :

[D2440-C](#) [H10CA4890](#) [D4875C](#) [1395831-1](#) [1616010-6](#) [BR312BY](#) [A-1326](#) [H10CA4850](#) [H12CA4890VL](#) [RA2410-D06](#) [RA2410HA06T](#)  
[D1202F](#) [D53TP50-10](#) [W230E-1-12](#) [W230T-3-12](#) [1-1617030-3](#) [1-1617033-7](#) [MS2-D2420](#) [MS2-D2430](#) [A-1440](#) [RJ1P60V50E](#) [HS501DR-](#)  
[D2425](#) [RN1F48I50](#) [70.362.1028.0](#) [7-1393030-8](#) [Z5.509.0828.0](#) [G3DZ-4B DC24](#) [G3DZ-F4B DC12](#) [2912138](#) [SSRDAC10](#) [SSR-10048RD1](#)  
[RV8S-L-A240-D24](#) [RV8S-L-A240-D6](#) [RV8S-S-A240-D6](#) [RV8S-S-A240Z-D24](#) [RV8S-S-D24-A240](#) [RV8S-S-D48-A120](#) [RN1F12V50](#)  
[RJ1P60I30E](#) [RJ1P60V30E](#) [SO967860](#) [SMT8628521](#) [SO869970](#) [SOD867180](#) [SAL961360](#) [SO867970](#) [SOB863860](#) [SOB867640](#) [G3PH-](#)  
[5150B DC5-24](#) [G3PH-2075B DC5-24](#)