





### Absolute Maximum Rating

Symbol	Parameter	Value	Units
$V_{ESD}$	ESD per IEC 61000-4-2 (Air) ESD per IEC 61000-4-2 (Contact)	$\pm 30$ $\pm 30$	kV
$I_{PP}$	Peak Pulse Current(8/20us)	12	A
$P_{PK}$	Peak Pulse Power (8/20 $\mu$ s)	400	W
$T_{STG} / T_{OPT}$	Storage Temperature / Operating Temperature	-55/+150	$^{\circ}C$
$T_L$	Lead Soldering Temperature	260 (10 sec.)	$^{\circ}C$

### Electrical Characteristics (T = 25 $^{\circ}C$ )

Symbol	Parameter
$V_{RWM}$	Nominal Reverse Working Voltage
$I_R$	Reverse Leakage Current @ $V_{RWM}$
$V_{t1}$	Trigger Voltage
$I_{t1}$	Trigger Current @ $V_{t1}$
$V_h$	Holding Voltage
$I_h$	Holding Current @ $V_h$
$V_C$	Clamping Voltage @ $I_{PP}$
$V_{CR}$	Reverse Clamping Voltage @ $I_{PP}$
$I_{PP}$	Maximum Peak Pulse Current
$C_{ESD}$	Parasitic Capacitance

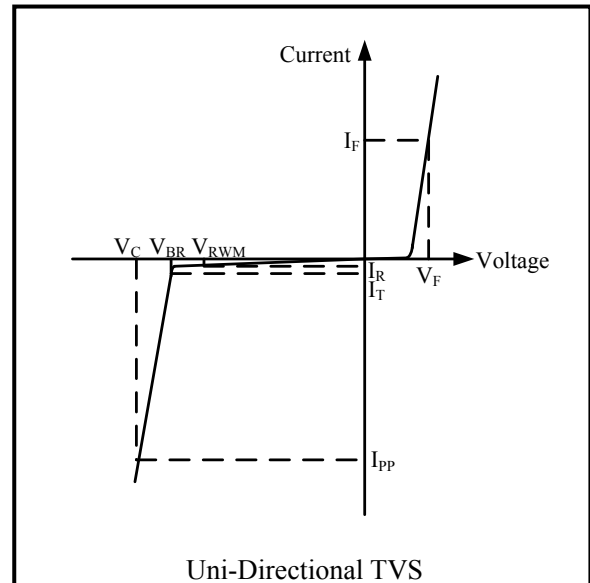

Symbol	Test Condition	Minimum	Typical	Maximum	Units
$V_{RWM}$				18.0	V
$I_R$	$V_{RWM} = 18V, T = 25^{\circ}C$		0.01	0.1	$\mu A$
$V_{BR}$	$I_T = 1mA$	18	19		V
$V_C$	$I_{PP} = 12A, t_p = 8/20\mu s$			35	V
$C_{ESD}$	$V_R = 0V, f = 1MHz$		80		pF



Package Outline

Outline Drawing (SOD523)

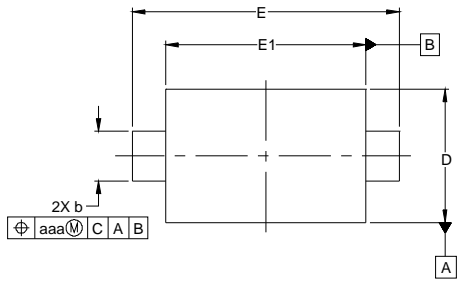

DI	INCHES			MILLIMETERS		
	MIN	NO	MA	MIN	NO	MA
A	.019	.023	.027	0.50	0.60	0.70
b	.009	-	.013	0.25	-	0.35
c	.003	-	.008	0.10	-	0.20
D	.027	.031	.035	0.70	0.80	0.90
E	.059	.063	.067	1.50	1.60	1.70
E1	.043	.047	.051	1.10	1.20	1.30
L	.003	.008	.011	0.10	0.20	0.30
L1	.003	.005	.008	0.10	0.15	0.20
aaa	.008			0.20		

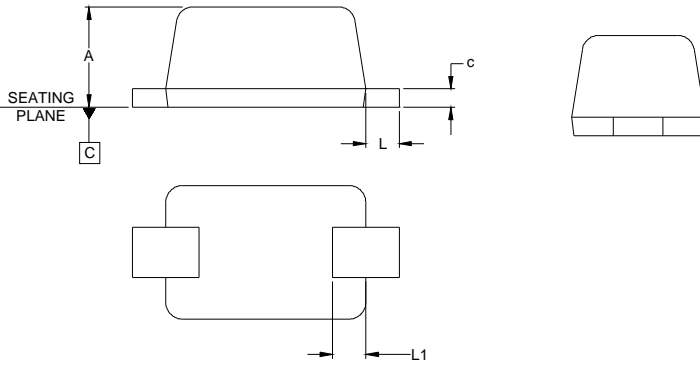

NOTES:

1. CONTROLLING DIMENSIONS ARE IN MILLIMETERS (ANGLES IN DEGREES).
2. DIMENSIONS "E1" AND "D" DO NOT INCLUDE MOLD FLASH, PROTRUSIONS OR GATE BURRS.

Land Pattern

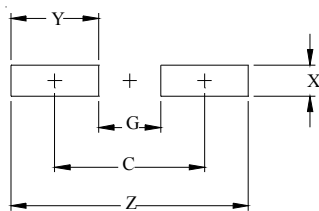

DIMENSIONS		
DIM	INCHES	MILLIMETERS
C	(.057)	(1.45)
G	.024	0.60
X	.018	0.45
Y	.033	0.85
Z	.090	2.30

NOTES:

1. THIS LAND PATTERN IS FOR REFERENCE PURPOSES ONLY



Tape and Reel Specification

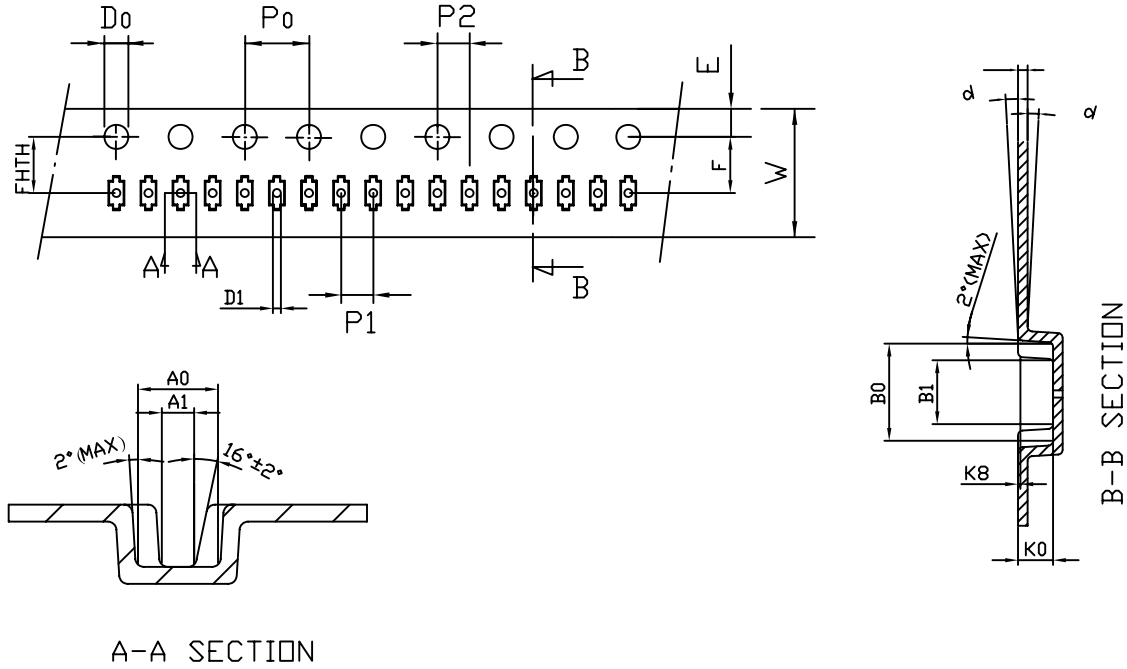

unit:mm

symbol	A0	B0	K0	P0	P1	P2	A1	T
Spec	0.90±0.05	1.95±0.05	0.73±0.05	4.0±0.10	2.0±0.05	2.0±0.05	0.39±0.05	0.20±0.02
symbol	E	F	D0	D1	B2	W	10P0	K8
Spec	1.75±0.10	3.50±0.05	1.50 <sup>+0.10</sup> <sub>0</sub>	0.50±0.05	1.40±0.05	8.0 <sup>+0.3</sup> <sub>-0.1</sub>	40.0±0.10	0.15MAX
symbol	FHTH							
Spec	3.50±0.05							

Marking Codes

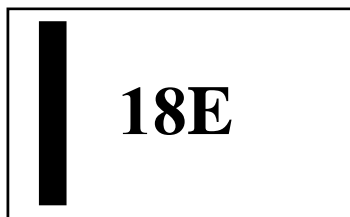

Ordering Information

Part Number	Working Voltage	Quantity Per Reel	Reel Size
TS1811LD-C	18V	3,000	7 Inch

Note:

- (1) "E" is part number, fi
- (2) "XX" is the internal c

## X-ON Electronics

Largest Supplier of Electrical and Electronic Components

*Click to view similar products for [ESD Suppressors / TVS Diodes](#) category:*

*Click to view products by [Shenzhen JingYang](#) manufacturer:*

Other Similar products are found below :

[60KS200C](#) [D18V0L1B2LP-7B](#) [D5V0F4U5P5-7](#) [NTE4902](#) [P4KE27CA](#) [P6KE11CA](#) [P6KE8.2A](#) [SA60CA](#) [SA64CA](#) [SMBJ12CATR](#)  
[SMBJ33CATR](#) [SMBJ6.5A](#) [SMBJ8.0A](#) [ESD101-B1-02ELS E6327](#) [ESD112-B1-02EL E6327](#) [ESD7451N2T5G](#) [19180-510](#) [CPDT-5V0USP-](#)  
[HF](#) [3.0SMCJ33CA-F](#) [3.0SMCJ36A-F](#) [HSPC16701B02TP](#) [JANTX1N6126A](#) [D3V3Q1B2DLP3-7](#) [D55V0M1B2WS-7](#) [SCM1293A-04SO](#)  
[ESD200-B1-CSP0201 E6327](#) [SM12-7](#) [CEN955 W/DATA](#) [VESD12A1A-HD1-GS08](#) [CPDQC5V0-HF](#) [D1213A-01LP4-7B](#) [ESD101-B1-02EL](#)  
[E6327](#) [AOZ8808DI-03](#) [5KP15A](#) [5KP48A](#) [5KP90A](#) [ESD3V3D7-TP](#) [15KPA36A-LF](#) [P4KE56CA](#) [P4KE68A](#) [P4KE91CATR](#) [P6KE120A](#)  
[P6KE13CA](#) [P6KE43CA](#) [P6KE6.8CA](#) [P6KE8.2](#) [P6SMBJ20CA](#) [JANTX1N6072A](#) [SR2835ESKG](#) [SA90CA](#)