

Features

- Transient protection for high-speed data lines
 IEC61000 -4-2 (ESD) ±15kV (Air)
 ±13kV(Contact)
- IEC 61000-4-5 (Lightning) 6.0A (8/20µs)
- Cable Discharge Event (CDE)
- Array of surge rated diodes with internal TVS diode
- Small package saves board space
- Protects four I/O lines
- Low capacitance: 0.2pF@0V(Typical)
- Low leakage current: 0.1µA @ VRWM (Typical)
- Low clamping voltage
- Each I/O pin can withstand over 1000 ESD strikes for ±8kV contact discharge

Circuit Diagram



Description

TT1821SAX is a low-capacitance Transient Voltage Suppressor (TVS) designed to provide electrostatic discharge (ESD) protection for high-speed data interfaces. With typical capacitance of 0.20pF only, TT1821SAX is designed to protect parasitic-sensitive systems against over-voltage and over-current transient events. It complies with IEC61000-4-2 (ESD), Level 4 (±15kV air, ±8kV contact discharge).

Pin Configuration

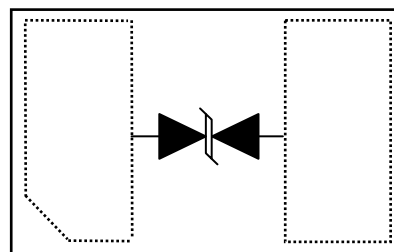

DFN0603-2L
(Top View)

Mechanical Characteristics

- Package: DFN0603-2L
- Marking: Part number
- Packaging: Tape and Reel
- ROHS compliant

Absolute Maximum Rating

Symbol	Parameter	Value	Units
I_{PP}	Peak Pulse Current (8/20 μ s)	6	A
P_{PK}	Peak Pulse Power (8/20 μ s)	30	W
V_{ESD}	ESD per IEC61000-4-2 (Air) ESD per IEC61000-4-2 (Contact)	± 15 ± 13	kV
T_{OPT}	Operating Temperature	-55/+125	$^{\circ}$ C
T_{STG}	Storage Temperature	-55/+150	$^{\circ}$ C

Electrical Characteristics (T = 25 $^{\circ}$ C)

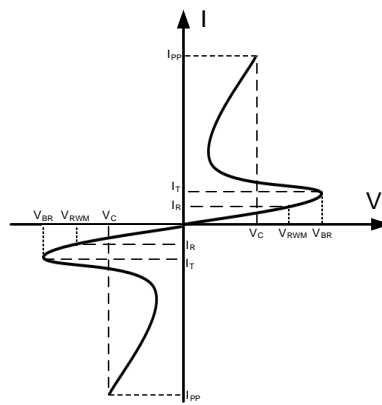
Symbol	Parameter	Diagram
V_{RWM}	Nominal Reverse Working Voltage	
I_R	Reverse Leakage Current @ V_{RWM}	
V_{BR}	Reverse Breakdown Voltage @ I_T	
I_T	Test Current for Reverse Breakdown	
V_C	Clamping Voltage @ I_{PP}	
I_{PP}	Maximum Peak Pulse Current	
C_{ESD}	Parasitic Capacitance	

Symbol	Test Condition	Minimum	Typical	Maximum	Units
V_{RWM}				18	V
I_R	$V_{RWM} = 18V, T = 25^{\circ}C$			0.1	μ A
V_{BR}	$I_T = 10\mu A$	20.0	23.0		V
V_C	$I_{PP} = 6A, t_p = 8/20\mu s$		4.8		V
V_C	$I_{PP} = 8.0A, t_p = 100ns^{(1)}$		4.70		V
	$I_{PP} = 16.0A, t_p = 100ns^{(1)}$		6.40		V
R_{dyn}	$I_{PP} = 12.0A, t_p = 100ns^{(1)}$		0.21		Ω
C_{ESD}	$V_R = 0V, f = 1MHz$		0.20		pF

Notes:(1)Measurements performed using a 100ns Transmission Line Pulse(TLP) system.

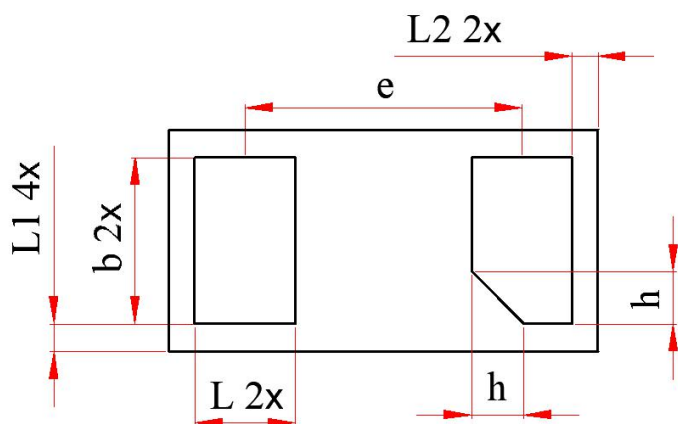
Package Outline, DFN0603-2L

Bottom View

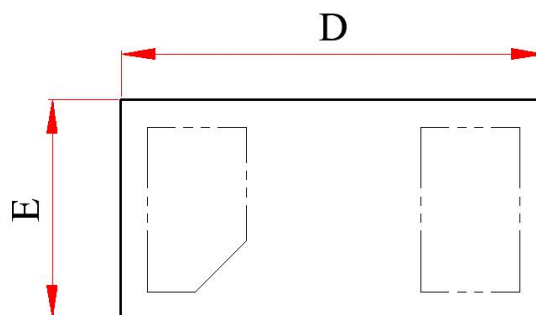

Top View

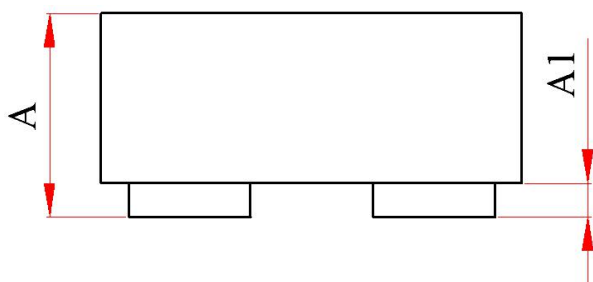

Side View

Symbol	Dimension In Millimeters			Dimension In Inches		
	Normal	Min	Max	Normal	Min	Max
A	--	0.270	0.330	--	0.011	0.013
A1	--	--	0.050	--	--	0.002
D	0.620	0.600	0.640	0.024	0.023	0.025
E	0.320	0.300	0.340	0.012	0.011	0.013
b	0.245	0.215	0.275	0.010	0.008	0.011
L	0.145	0.115	0.175	0.006	0.005	0.007
L1	0.038 REF			0.001 REF		
L2	0.038 REF			0.001 REF		
h	0.075 REF			0.003 REF		
e	0.400 BSC			0.016 BSC		

Tape and Reel Specification

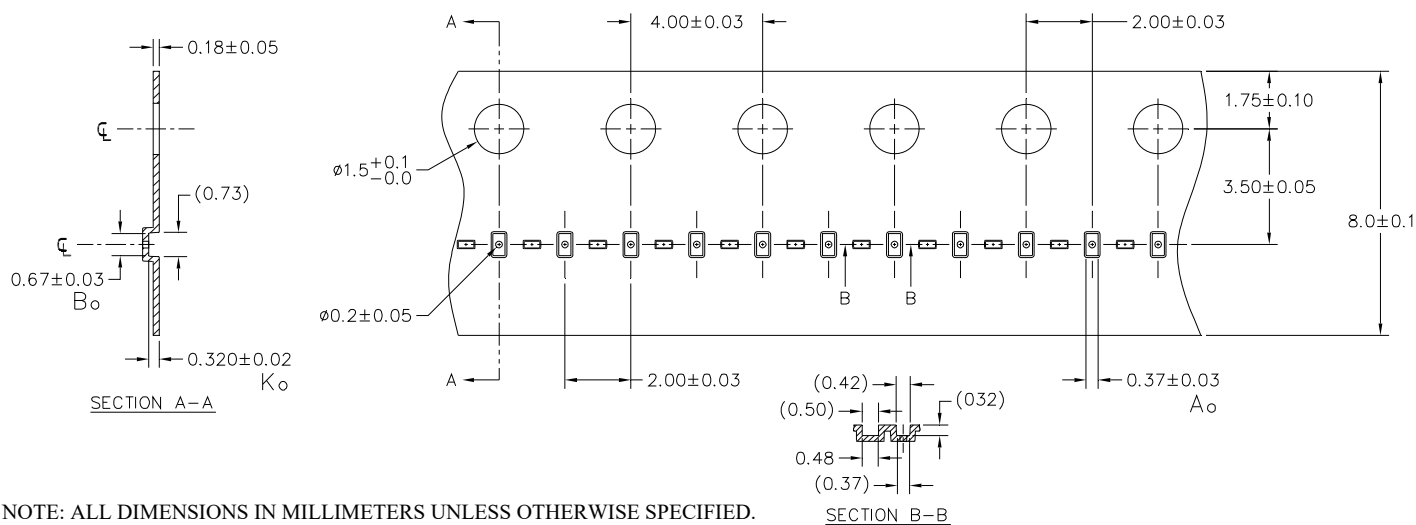

Device Orientation in Tape

A0	B0	K0
0.37 +/-0.03	0.67 +/-0.03	0.32 +/-0.02 mm

Note: All dimensions in mm unless otherwise specified

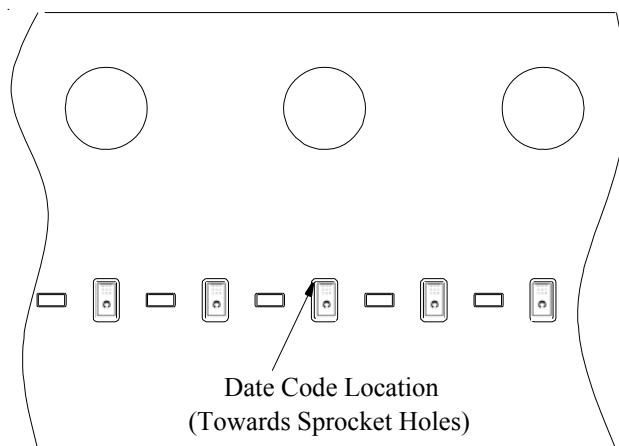

Marking Codes



Note:

- (1) "C" is part number.
- (2) "X" is the internal code.

Ordering Information

Part Number	Working Voltage	Quantity Per Reel	Reel Size
TT1821SAX	18V	10,000	7 Inch

X-ON Electronics

Largest Supplier of Electrical and Electronic Components

Click to view similar products for [ESD Suppressors / TVS Diodes](#) category:

Click to view products by [Shenzhen JingYang](#) manufacturer:

Other Similar products are found below :

[60KS200C](#) [D18V0L1B2LP-7B](#) [D5V0F4U5P5-7](#) [NTE4902](#) [P4KE27CA](#) [P6KE11CA](#) [P6KE8.2A](#) [SA60CA](#) [SA64CA](#) [SMBJ12CATR](#)
[SMBJ33CATR](#) [SMBJ6.5A](#) [SMBJ8.0A](#) [ESD101-B1-02ELS](#) [E6327](#) [ESD112-B1-02EL](#) [E6327](#) [ESD7451N2T5G](#) [19180-510](#) [CPDT-5V0USP-](#)
[HF](#) [3.0SMCJ33CA-F](#) [3.0SMCJ36A-F](#) [HSPC16701B02TP](#) [JANTX1N6126A](#) [D3V3Q1B2DLP3-7](#) [D55V0M1B2WS-7](#) [SCM1293A-04SO](#)
[ESD200-B1-CSP0201](#) [E6327](#) [SM12-7](#) [CEN955 W/DATA](#) [VESD12A1A-HD1-GS08](#) [CPDQC5V0-HF](#) [D1213A-01LP4-7B](#) [ESD101-B1-02EL](#)
[E6327](#) [AOZ8808DI-03](#) [5KP15A](#) [5KP48A](#) [5KP90A](#) [ESD3V3D7-TP](#) [15KPA36A-LF](#) [P4KE56CA](#) [P4KE68A](#) [P4KE91CATR](#) [P6KE120A](#)
[P6KE13CA](#) [P6KE43CA](#) [P6KE6.8CA](#) [P6KE8.2](#) [P6SMBJ20CA](#) [JANTX1N6072A](#) [SR2835ESKG](#) [SA90CA](#)