

负温度系数(NTC)热敏电阻器

Negative temperature coefficient (NTC) thermistor

MF72功率型NTC热敏电阻系列
MF72 Power NTC Thermistor series



江苏省高新技术产品
The Hi & Tech product of Jiangsu province

- 特点
 - 体积小、功率大，抑制浪涌电流能力强
 - 反应速度快
 - 材料常数（B值）大，残余电阻小
 - 寿命长，可靠性高
 - 系列全，应用范围宽
- 应用范围
 - 转换电源，开关电源，UPS电源
 - 电子节能灯，镇流器及各类加热器
 - 各类显像管、显示器
 - 白炽灯，其它照明灯具
- 安规认证 Approvals

- Characteristics
 - Small size, strong power and strong capability of surge current protection
 - Fast response to surge current
 - Big material constant (B value), Small remain resistance
 - Longevity of service, High reliability
 - Integral series, extensive operating range
- Applications
 - Conversion power-supply, switch power, ups power
 - Electronic energy saving lamps, electronic ballast and all kinds of electric heater
 - All kinds of RT, display
 - Bulb and other lighting lamps
- 产品标志说明 Specification



- UL 1434 认证 (File # E 241319)
- CQC 认证 (File # 04001010556)
- TUV 认证 (File # R50245892)

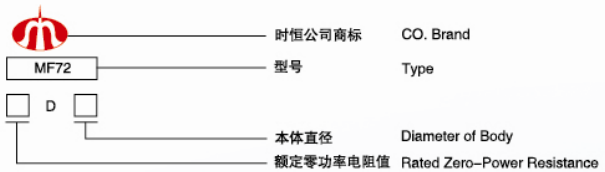

● 外形尺寸 Dimensions(mm)

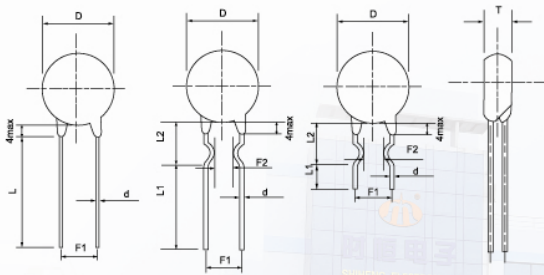

直引线 Straight lead 弯引线 Curved lead

| 尺寸 Dim(mm) 代号 Sym 型号 Part No | Dmax | T max | d ±0.05 | F1 ±1 | F2 ±1.5 | 直引线 Straight lead | | 弯引线 Curved lead | |
|---|------|----------|------------|----------|------------|----------------------|--------------------|--------------------|--|
| | | | | | | Lmin | L ₁ min | L ₂ ±2 | |
| MF72-□D5 | 7.0 | 5 | 0.6/0.45 | 5/2.5 | 3 | 25 | 17/5 | 8/5 | |
| MF72-□D7 | 9.0 | 5 | 0.6 | 5 | 3 | 25 | 17/5 | 8/5 | |
| MF72-□D9 | 11.0 | 5.5 | 0.8/0.6 | 7.5/5 | 5/3 | 25 | 17/5 | 8/5 | |
| MF72-□D11 | 13.0 | 5.5 | 0.8 | 7.5/5 | 5/3 | 25 | 17/5 | 8/5 | |
| MF72-□D13 | 15.5 | 6 | 0.8 | 7.5 | 5 | 25 | 17/5 | 8/5 | |
| MF72-□D15 | 17.5 | 6 | 0.8 | 10/7.5 | 5 | 25 | 17/5 | 8/5 | |
| MF72-□D20 | 22.5 | 7 | 1.0 | 10/7.5 | / | 25 | / | / | |
| MF72-□D25 | 27.5 | 8 | 1.0 | 10/7.5 | / | 25 | / | / | |

MF72功率型NTC热敏电阻系列

MF72 Power NTC Thermistor series

● 主要技术参数 Main Techno-Parameter

| 型号 Part No MF72 | R ₂₅ (Ω) | 最大稳态电流 (A) Max. Steady State Current | 最大电流时近似 电阻值 (Ω) Approx. R of Max. Cur.(Ω) | 耗散系数 约 (mW/°C) Dissi. Coef. (mW/°C) | 热时间常数 约 (s) Thermal time Constant(S) | 工作温度 (°C) Operating Temp. (°C) | | |
|-----------------------|------------------------|---|--|--|---|---|----|------------|
| 5D5 | 5 | 1 | 0.353 | 15 | 17 | -40 ~ +150 | | |
| 10D5 | 10 | 0.7 | 0.771 | | | | | |
| 60D5 | 60 | 0.3 | 1.878 | | | | | |
| 200D5 | 200 | 0.1 | 18.70 | | | | | |
| 5D7 | 5 | 2 | 0.283 | 16 | 27 | | | |
| 8D7 | 8 | 1 | 0.539 | | | | | |
| 10D7 | 10 | 1 | 0.616 | | | | | |
| 12D7 | 12 | 1 | 0.816 | | | | | |
| 16D7 | 16 | 0.7 | 1.003 | | | | | |
| 22D7 | 22 | 0.6 | 1.108 | | | | | |
| 33D7 | 33 | 0.5 | 1.485 | | | | | |
| 200D7 | 200 | 0.2 | 11.65 | | | | | |
| 3D9 | 3 | 4 | 0.120 | | | 16 | 38 | -40 ~ +170 |
| 4D9 | 4 | 3 | 0.190 | | | | | |
| 5D9 | 5 | 3 | 0.210 | | | | | |
| 6D9 | 6 | 2 | 0.315 | | | | | |
| 8D9 | 8 | 2 | 0.400 | | | | | |
| 10D9 | 10 | 2 | 0.458 | | | | | |
| 12D9 | 12 | 1 | 0.652 | | | | | |
| 16D9 | 16 | 1 | 0.802 | | | | | |
| 20D9 | 20 | 1 | 0.864 | | | | | |
| 22D9 | 22 | 1 | 0.950 | | | | | |
| 30D9 | 30 | 1 | 1.022 | | | | | |
| 33D9 | 33 | 1 | 1.124 | | | | | |
| 50D9 | 50 | 1 | 1.252 | | | | | |
| 60D9 | 60 | 0.8 | 1.502 | | | | | |
| 80D9 | 80 | 0.8 | 2.010 | | | | | |
| 120D9 | 120 | 0.8 | 3.015 | | | | | |
| 200D9 | 200 | 0.5 | 5.007 | | | | | |
| 400D9 | 400 | 0.2 | 30.30 | | | | | |
| 2.5D11 | 2.5 | 5 | 0.095 | 17 | 43 | -40 ~ +170 | | |
| 3D11 | 3 | 5 | 0.100 | | | | | |
| 4D11 | 4 | 4 | 0.150 | | | | | |
| 5D11 | 5 | 4 | 0.156 | | | | | |
| 6D11 | 6 | 3 | 0.240 | | | | | |
| 8D11 | 8 | 3 | 0.255 | | | | | |
| 10D11 | 10 | 3 | 0.275 | | | | | |
| 12D11 | 12 | 2 | 0.462 | | | | | |
| 16D11 | 16 | 2 | 0.470 | | | | | |
| 20D11 | 20 | 2 | 0.512 | | | | | |
| 22D11 | 22 | 2 | 0.563 | | | | | |
| 30D11 | 30 | 1.5 | 0.667 | | | | | |
| 33D11 | 33 | 1.5 | 0.734 | | | | | |
| 50D11 | 50 | 1.5 | 1.021 | | | | | |
| 60D11 | 60 | 1.5 | 1.215 | | | | | |
| 80D11 | 80 | 1.2 | 1.656 | | | | | |
| 1.3D13 | 1.3 | 7 | 0.062 | 18 | 66 | | | |

| 型号 Part No MF72 | R ₂₅ (Ω) | 最大稳态电流 (A) Max. Steady State Current | 最大电流时近似 电阻值 (Ω) Approx. R of Max. Cur.(Ω) | 耗散系数 约 (mW/°C) Dissi. Coef. (mW/°C) | 热时间常数 约 (s) Thermal time Constant(S) | 工作温度 (°C) Operating Temp. (°C) | |
|-----------------------|------------------------|---|--|--|---|---|-----|
| 1.5D13 | 1.5 | 7 | 0.073 | 18 | 66 | -40 ~ +200 | |
| 2.5D13 | 2.5 | 6 | 0.088 | | | | |
| 3D13 | 3 | 6 | 0.092 | | | | |
| 4D13 | 4 | 5 | 0.120 | | | | |
| 5D13 | 5 | 5 | 0.125 | | | | |
| 6D13 | 6 | 4 | 0.170 | | | | |
| 7D13 | 7 | 4 | 0.188 | | | | |
| 8D13 | 8 | 4 | 0.194 | | | | |
| 10D13 | 10 | 4 | 0.206 | | | | |
| 12D13 | 12 | 3 | 0.316 | | | | |
| 15D13 | 15 | 3 | 0.335 | | | | |
| 16D13 | 16 | 3 | 0.338 | | | | |
| 20D13 | 20 | 3 | 0.372 | | | | |
| 30D13 | 30 | 2.5 | 0.517 | | | | |
| 47D13 | 47 | 2 | 0.810 | | | | |
| 120D13 | 120 | 1.2 | 2.124 | | | | |
| 1.3D15 | 1.3 | 8 | 0.048 | 21 | 75 | | |
| 1.5D15 | 1.5 | 8 | 0.052 | | | | |
| 2.5D15 | 2.5 | 7 | 0.065 | | | | |
| 3D15 | 3 | 7 | 0.075 | | | | |
| 5D15 | 5 | 6 | 0.112 | | | | |
| 6D15 | 6 | 5 | 0.155 | | | | |
| 7D15 | 7 | 5 | 0.173 | | | | |
| 8D15 | 8 | 5 | 0.178 | | | | |
| 10D15 | 10 | 5 | 0.180 | | | | |
| 12D15 | 12 | 4 | 0.250 | | | | |
| 15D15 | 15 | 4 | 0.268 | | | | |
| 16D15 | 16 | 4 | 0.276 | | | | |
| 20D15 | 20 | 4 | 0.288 | | | | |
| 30D15 | 30 | 3.5 | 0.438 | | | | |
| 47D15 | 47 | 3 | 0.680 | | | | |
| 120D15 | 120 | 1.8 | 1.652 | | | | |
| 0.7D20 | 0.7 | 11 | 0.018 | 28 | 113 | | |
| 1.3D20 | 1.3 | 9 | 0.037 | | | | |
| 3D20 | 3 | 8 | 0.055 | | | | |
| 5D20 | 5 | 7 | 0.087 | | | | |
| 6D20 | 6 | 6 | 0.113 | | | | |
| 8D20 | 8 | 6 | 0.142 | | | | |
| 10D20 | 10 | 6 | 0.162 | | | | |
| 12D20 | 12 | 5 | 0.195 | | | | |
| 16D20 | 16 | 5 | 0.212 | | | | |
| 0.7D25 | 0.7 | 12 | 0.014 | | | 30 | 130 |
| 1.5D25 | 1.5 | 10 | 0.027 | | | | |
| 3D25 | 3 | 9 | 0.044 | | | | |
| 5D25 | 5 | 8 | 0.070 | | | | |
| 8D25 | 8 | 7 | 0.114 | | | | |
| 10D25 | 10 | 7 | 0.130 | | | | |
| 12D25 | 12 | 6 | 0.156 | | | | |
| 16D25 | 16 | 6 | 0.160 | | | | |

注：若非特别指出，R₂₅的允许偏差为±20%

Remark: Unless the particular indication, the allowable tolerance of R₂₅ is ±20%.

X-ON Electronics

Largest Supplier of Electrical and Electronic Components

Click to view similar products for [NTC \(Negative Temperature Coefficient\) Thermistors](#) category:

Click to view products by [Shiheng](#) manufacturer:

Other Similar products are found below :

[118-253FAJ-P01](#) [121-202EAC-P01](#) [123-802EAJ-P01](#) [128-105NDP-Q02](#) [135-503LAD-J01](#) [B57250V2104F360](#) [B57250V2473F560](#)
[B57620C472K962](#) [NTCLE410E3103F](#) [A1004SG22P0](#) [199-303KAF-A02](#) [30054-4](#) [M09N038F](#) [B57423V2473H062](#) [B57471V2474H062](#)
[B57620C5223J062](#) [500-52AA04-101](#) [526-31AA19-104](#) [526-31AN12-202](#) [103AT-5-1P-FT](#) [10K3A542I](#) [112-103FAG-H02](#) [112-104KAG-](#)
[B01](#) [11028414-00](#) [111-182CAG-H01](#) [112-103FAF-H01](#) [112-104KBF-F01](#) [118-202CAJ-P01](#) [526-31AA79-102](#) [B57442V5103J62](#)
[B57401V2103H62](#) [B57621C5472J62](#) [194303KEVA01](#) [NTCACAPE3C90193](#) [USP11595](#) [B57359V2224J260](#) [B57343V5103J360](#) [50070974-](#)
[003-01](#) [189-602LDR-A01](#) [B57621C5472K062](#) [B57421V2153J062](#) [B57230V2103H260](#) [B57471V2684H062](#) [B57471V2333H062](#) [126-](#)
[153YJC-B01](#) [NTCS0603E3333FHT](#) [118-802EAJ-P01](#) [121-103FAC-Q02](#) [144-101FAG-001](#) [526-31AD07-153](#)