

GLASS PASSIVATED BRIDGE RECTIFIERS

REVERSE VOLTAGE - 50 to 1000 Volts

FORWARD CURRENT - 3.0 Amperes

KBP

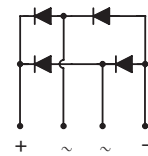
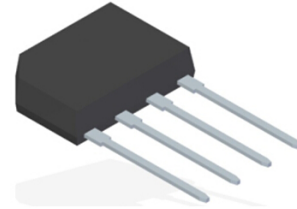

FEATURES

- Rating to 1000V PRV
- Ideal for printed circuit board
- Reliable low cost construction utilizing molded plastic technique
- The plastic material has UL flammability classification 94V#0

MECHANICAL DATA

- Polarity : As marked on body
- Weight : 0.05 ounces, 1.52 grams
- Mounting position : Any

MAXIMUM RATINGS AND ELECTRICAL CHARACTERISTICS

Ratings at 25°C ambient temperature unless otherwise specified.

| CHARACTERISTICS | SYMBOL | KBP 3005G | KBP 301G | KBP 302G | KBP 304G | KBP 306G | KBP 308G | KBP 310G | UNIT |
|---|---|-----------|----------|----------|----------------|----------|----------|----------|----------------------|
| Maximum Repetitive Peak Reverse Voltage | V_{RRM} | 50 | 100 | 200 | 400 | 600 | 800 | 1000 | V |
| Maximum RMS Voltage | V_{RMS} | 35 | 70 | 140 | 280 | 420 | 560 | 700 | V |
| Maximum DC Blocking Voltage | V_{DC} | 50 | 100 | 200 | 400 | 600 | 800 | 1000 | V |
| Maximum Average Forward Rectified Current @ $T_C=105^\circ\text{C}$ (With heatsink) (Without heatsink) | $I_{(AV)}$ | | | | 3.0 1.9 | | | | A |
| Peak Forward Surge Current 8.3ms single half sine-wave @ $T_j = 25^\circ\text{C}$ | I_{FSM} | | | | 75 | | | | A |
| Peak Forward Surge Current 1.0ms single half sine-wave @ $T_j = 25^\circ\text{C}$ | I_{FSM} | | | | 150 | | | | A |
| Maximum Forward Voltage at 3.0A DC | V_F | | | | 1.1 | | | | V |
| Maximum DC Reverse Current at rated Blocking Voltage @ $T_j=25^\circ\text{C}$ @ $T_j=125^\circ\text{C}$ | I_R | | | | 5.0 500 | | | | μA |
| I^2t Rating for fusing ($3\text{ms} \leq t \leq 8.3\text{ms}$) | I^2t | | | | 26.5 | | | | A^2S |
| Typical Junction Capacitance per element (Note 1) | C_j | | | | 50 | | | | pF |
| Typical thermal resistance (Unit mounted on 30mmx30mmx1mm Copper plate heatsink.) | $R_{\theta JC}$ $R_{\theta JL}$ $R_{\theta JA}$ | | | | 10 12 30 | | | | $^\circ\text{C/W}$ |
| Typical thermal resistance (without heatsink) | $R_{\theta JC}$ $R_{\theta JL}$ $R_{\theta JA}$ | | | | 12 18 40 | | | | $^\circ\text{C/W}$ |
| Operation Temperature Range | T_j | | | | -55 to +150 | | | | $^\circ\text{C}$ |
| Storage Temperature Range | T_{STG} | | | | -55 to +150 | | | | $^\circ\text{C}$ |

Note: (1) Measured at 1.0MHz and applied reverse voltage of 4.0V DC.

FIG.1- FORWARD CURRENT DERATING CURVE

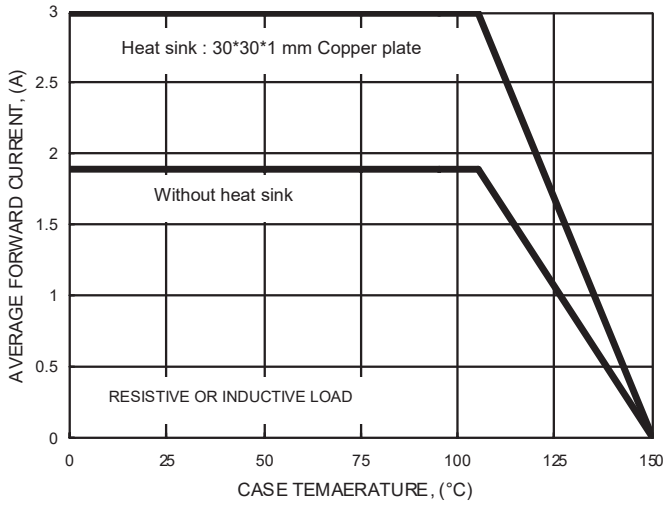

FIG.2- MAXIMUM NON-REPETITIVE SURGE CURRENT

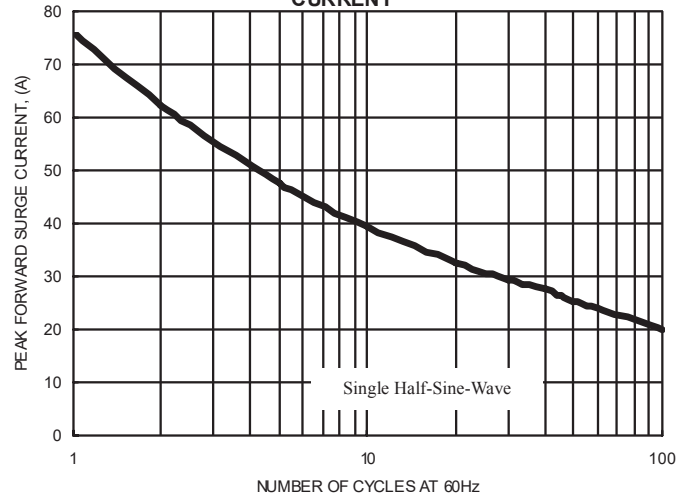

FIG.3- TYPICAL JUNCTION CAPACITANCE

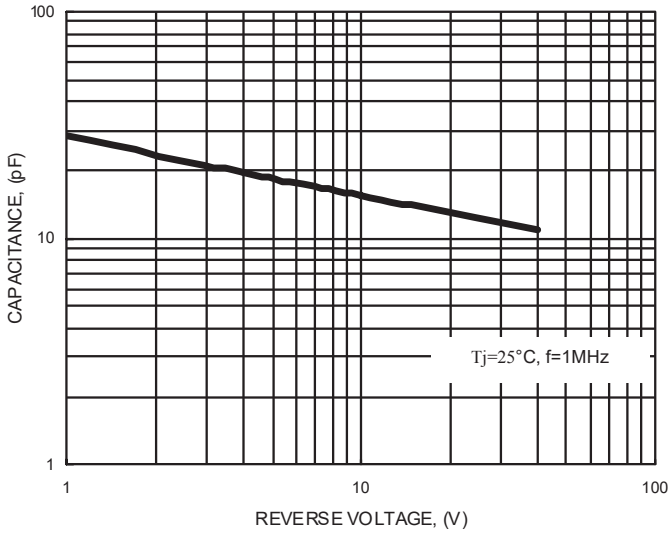

FIG.4- TYPICAL FORWARD CHARACTERISTICS

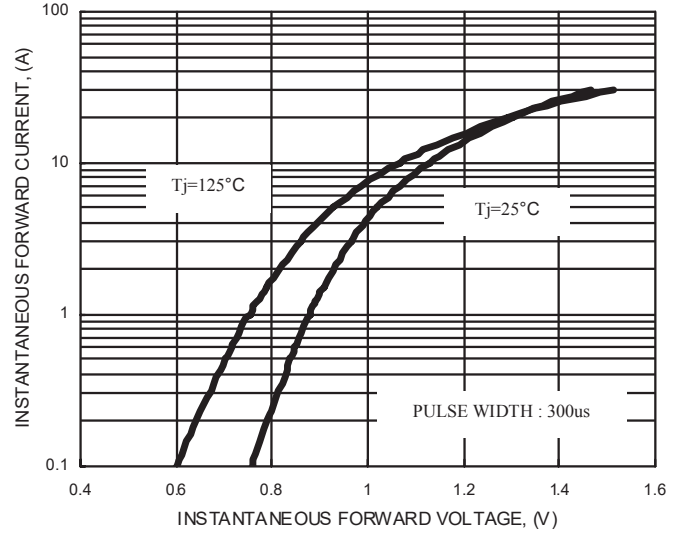
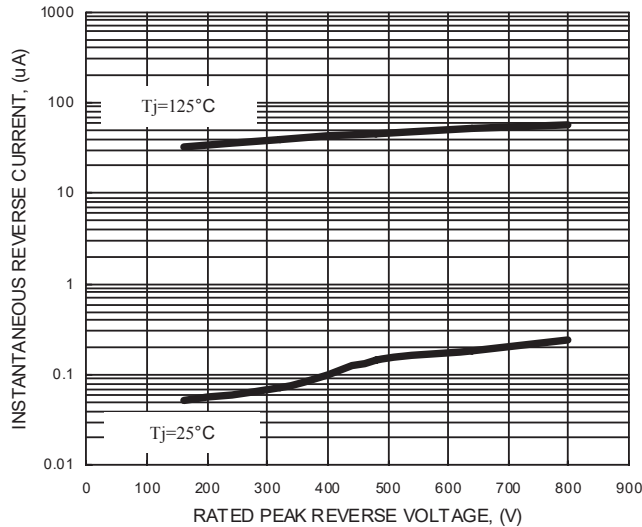
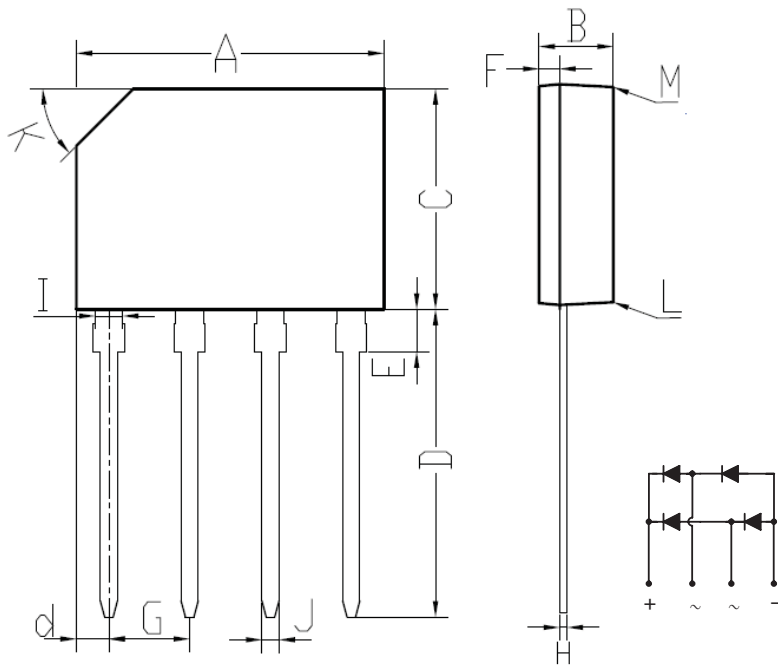

FIG.5- TYPICAL REVERSE CHARACTERISTICS



KBP Package Outline Dimensions



| KBP | | |
|------------------------------|-----------------|-------|
| DIM. | MIN. | MAX. |
| A | 14.25 | 14.75 |
| B | 3.35 | 3.65 |
| C | 10.20 | 10.60 |
| D | 14.25 | 14.73 |
| d | 1.40 | 1.70 |
| E | 1.80 | 2.20 |
| F | 0.80 | 1.10 |
| G | 3.56 | 4.06 |
| H | 0.35 | 0.55 |
| I | 1.22 | 1.42 |
| J | 0.76 | 0.86 |
| K | 2.7 x 45° (Typ) | |
| L | # | 3° |
| M | # | 2° |
| All Dimensions in millimeter | | |

X-ON Electronics

Largest Supplier of Electrical and Electronic Components

Click to view similar products for [Bridge Rectifiers](#) category:

Click to view products by [Shikues](#) manufacturer:

Other Similar products are found below :

[MB252](#) [MB356G](#) [MB358G](#) [MP358-BP](#) [GBJ1504-BP](#) [GBU10B-BP](#) [GBU15J-BP](#) [GBU15K-BP](#) [GBU4A-BP](#) [GBU4D-BP](#) [GSIB680-E3/45](#)
[DB101-BP](#) [DF01](#) [DF10SA-E345](#) [BU1508-E3/45](#) [BU1510-E3/45](#) [KBPC50-10S](#) [RS405GL-BP](#) [26MT120](#) [G5SBA60-E3/51](#) [GBJ1502-BP](#)
[GBU10J-BP](#) [GBU4J-BP](#) [GBU6M](#) [GBU8D-BP](#) [GBU8J-BP](#) [GSIB1520-E3/45](#) [TB102M](#) [MB1510](#) [MB6M-G](#) [MB86](#) [TL401G](#) [MDA920A2](#)
[TU602](#) [TU810](#) [MP501W-BP](#) [MP502-BP](#) [BR1005-BP](#) [BR101-BP](#) [BR84DTP204](#) [BU1010A-E3/51](#) [BU1508-E3/51](#) [BU2006-E3/45](#) [BU2008-](#)
[E3/51](#) [US15KB80R-7000](#) [KBPC25-02](#) [VS-60MT120KPBF](#) [DB105-BP](#) [DBF10TG](#) [DF1510S](#)