

S3H RELAY

SHORI

◆ Features

- S3H Series Relay covers switching capacity by 10A in spite of miniature size to comply with user's wide selection.
- The employment of suitable plastic materials is applied under high temperature condition and various chemical solutions.
- SPNO, SPNC, SPDT and sealed flux free & sealed Washable type are available.



◆ Coil Data [at 20°C]

- Standard Type

Rated voltage (V)	Coil Resistance ±10% (Ω)	Rated Current ±10% (mA)	Pick up Voltage (Max)	Drop out Voltage (Min)	Max continuous Voltage	Power consumption At rated Voltage
3	25	120	75% of rated voltage	10% of rated voltage	130% Max of Rated voltage	Approx.0.36W
5	70	72				
6	100	60				
9	225	40				
12	400	30				
24	1600	15				
48	6400	7.5				

- High sensitivity Type

Rated voltage (V)	Coil Resistance ±10% (Ω)	Rated Current ±10% (mA)	Pick up Voltage (Max)	Drop out Voltage (Min)	Max continuous Voltage	Power consumption At rated Voltage
3	37.5	120	75% of rated voltage	10% of rated voltage	130% Max of Rated voltage	Approx.0.24W
5	104.2	72				
6	150	60				
9	337.5	40				
12	600	30				
24	2400	15				
48	9600	7.5				

◆ Contact Rating

Resistive load	10A 277VAC, 15A 125VAC, 7A 30VDC, 16A 24VDC, 20A 14VDC,TV-5 125VAC
----------------	--

◆ Type List

Terminal style	Contact form	Designation(provided with)	
		Sealed type	Sealed type washable
PCB terminal	1A (SPNO)	S3H-12-1A	S3H-12-1AS
	1B (SPNC)	S3H-12-1B	S3H-12-1BS
	1C(SPDT)	S3H-12-1C	S3H-12-1CS

◆ Ordering information

S3H - 12B - 1A S
 1 2 3 4

1. S3H -- Basic series designation

3.1A -- Form A, normally open (SPNO)

1B -- Form B, normally closed(SPNC)

1C -- Form C, double-throw(SPDT)

2. 12 -- Coil Voltage (3V~48V)

4. S -- Sealed type washable

B -- High sensitivity Type

Blank -- Sealed type

◆ Specification

Contact material	Ag Alloy	
Contact resistance	100 mΩ Max	
Operate time	10 ms Max	
Release time	5 ms Max	
Insulation resistance	100 MΩ Min. (DC 500V)	
Dielectric strength	Between open contact : AC 500V ,50/60Hz 1 min.	
	Between contact and coil : AC 1500V, 50/60Hz 1 min.	
Vibration resistance	Operating extremes	10~50Hz, amplitude 1.5 mm
	Damage limits	10~50Hz, amplitude 1.5 mm
Shock resistance	Operating extremes	10G
	Damage limits	100G
Life expectancy	Mechanical	10,000,000 operations (frequency 18,000 operations/hr)
	Electrical	100,000 operations (frequency 1,200 operations/hr)
Operating ambient temperature	-30~+85°C (no freezing)	
Weight	Approx. 9.5 g	

S3H RELAY

SHORI

◆ Safety Approval

Certified	UL/CUL	TUV
File No.	E188091	R50025857

◆ Safety Approval Rating

	UL/CUL	TUV
1A	10A 277VAC, 15A 125VAC, TV-5/125VAC, 1/3HP 120VAC	10A 240VAC , 15A 125VAC, 20A 14VDC
1B	10A 277VAC, 15A 125VAC, TV-5/125VAC	10A 240VAC , 15A 125VAC, 20A 14VDC
1C	7A 277VAC, 7A 30VDC, 15A 125VAC, 10A 24VDC	7A 240VAC , 15A 125VAC, 7A 30VDC, 12A 24VDC

◆ Outline Dimensions

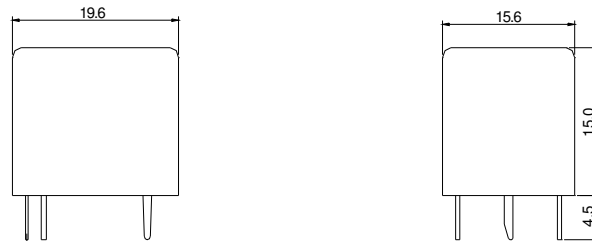

◆ Wiring Diagram

BOTTOM VIEW

1A

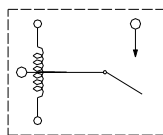

1B

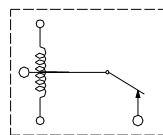

1C

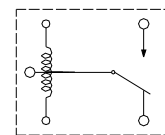

◆ PC BOARD LAYOUT

BOTTOM VIEW

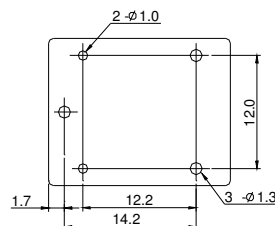

◆ Engineering Data

Coil temperature rise

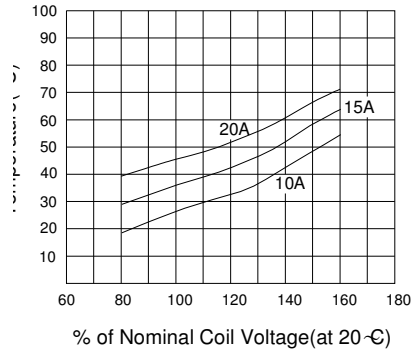

Coil temperature rise

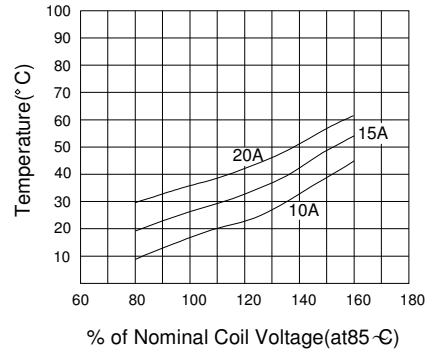

Life expectancy

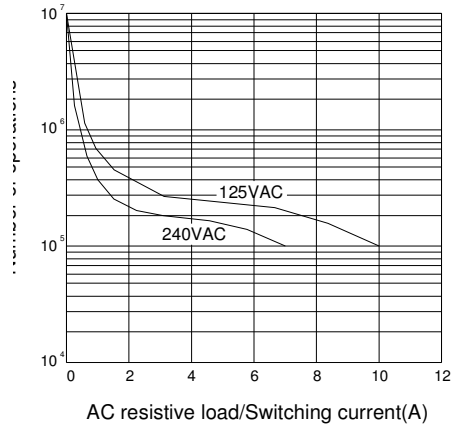

Operate time/Release time

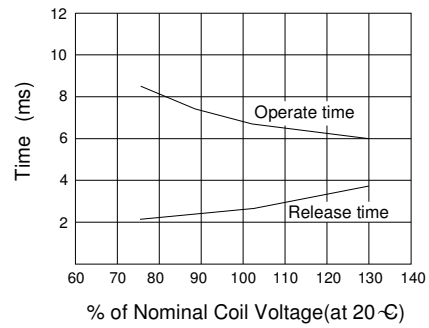

X-ON Electronics

Largest Supplier of Electrical and Electronic Components

Click to view similar products for [General Purpose Relays](#) category:

Click to view products by [Shori](#) manufacturer:

Other Similar products are found below :

[APF30318](#) [JVN1AF-4.5V-F](#) [PCN-105D3MHZ](#) [5JO-10000S-SIL](#) [5JO-1000CD-SIL](#) [5JO-400CD-SIL](#) [LY2S-AC220/240](#) [LYQ20DC12](#)
[6031007G](#) [6131406HQ](#) [6-1393099-3](#) [6-1393099-8](#) [6-1393122-4](#) [6-1393123-2](#) [6-1393767-1](#) [6-1393843-7](#) [6-1415012-1](#) [6-1419102-2](#) [6-](#)
[1423698-4](#) [6-1608051-6](#) [6-1608067-0](#) [6-1616170-6](#) [6-1616248-2](#) [6-1616282-3](#) [6-1616348-2](#) [6-1616350-1](#) [6-1616350-8](#) [6-1616358-7](#) [6-](#)
[1616359-9](#) [6-1616360-9](#) [6-1616931-6](#) [6-1617039-1](#) [6-1617052-1](#) [6-1617090-2](#) [6-1617090-5](#) [6-1617347-5](#) [6-1617353-3](#) [6-1617801-8](#) [6-](#)
[1617802-2](#) [6-1618107-9](#) [6-1618248-4](#) [M83536/1-027M](#) [CX-4014](#) [MAHC-5494](#) [MAVCD-5419-6](#) [703XCX-120A](#) [7-1393100-5](#) [7-1393111-7](#)
[7-1393144-5](#) [7-1393767-8](#)