

| REV. | ECN | DESCRIPTION | MDFD | DATE |
|------|-----|-------------|------|------|
|      |     | 新订图面        |      |      |

备注 (NOTE):

1. 材质:
- 1.1 胶芯: LCP UL94 V-0
  - 1.2 端子: C2680, T=0.2mm; 镍底, 镀金
  - 1.3 外壳: 不锈钢201-H 表面镀镍
2. 电气特性:
- 2.1 接触区: 接触电阻40mΩ Max, 允许10mΩ变化量. 测试条件: 20mv, 100mA下测量.
  - 2.2 接触电流: 3A VBUS引脚; 1.25A用于GND引脚; 其他引脚为0.25A.
  - 2.3 额定电压: 5V.
  - 2.4 耐电电压: 100VAC.
  - 2.5 绝缘电阻: 至少100兆欧.
3. 机械性能:
- 3.1 插入力: 0.5-2.0Kg
  - 3.2 拔出力: 0.6-2.04Kg
  - 3.3 插拔次数: 5000次.
  4. 工作环境: -20°C to +85°C.
  5. 耐焊接热: 端子浸入250±5°C的锡槽中; 历时3-5S±0.5Sec, 沾锡面积95%以上
  6. 外观: 部件可以承受以下焊接条件: 温度250°C, 时间8-10秒, 外观无损坏变形
  7. 包装: 编带, 1000pcs一盘

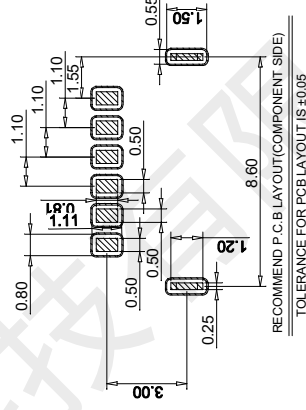
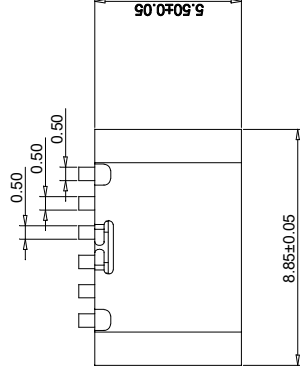
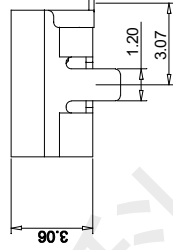
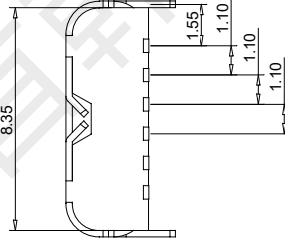
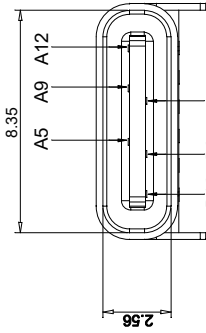
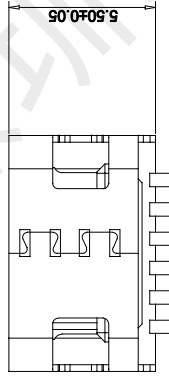
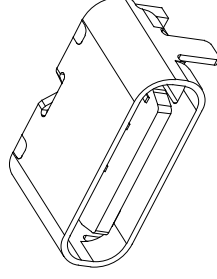

RECOMMEND P.C.B LAYOUT (COMPONENT SIDE)  
TOLERANCE FOR PCB LAYOUT IS ±0.05

USB TYPE C PIN ASSIGNMENTS

| PIN NUMBER | SIGNAL NAME | PIN NUMBER | SIGNAL NAME |
|------------|-------------|------------|-------------|
| B12        | GND         | B9         | VBUS        |
| A5         | CC1         | B5         | CC2         |
| A9         | VBUS        |            |             |
| A12        | GND         |            |             |

TABLE:

| NO | PART            | QTY | Material                          |
|----|-----------------|-----|-----------------------------------|
| 1  | SHELL           | 1   | ZINC ALLOY,Ni30u"Min PLATED       |
| 2  | CONTACT         | 6   | C2680,TIN80u"/Au1u"/Ni30u" PLATED |
| 3  | 1MD HOUSING     | 1   | LCP UL94 V-0 BLACK                |
| 4  | CAP             | 1   | LCP UL94 V-0 BLACK                |
| 5  | WATERPROOF RING | 1   | SILICONE UL94 V-0 BLACK           |

**首韩** 深圳市首韩科技有限公司

品名 (ITEM NO) TYPE-C 6P WTL5.5 108

料号 (PART NO)

图号 (DWG NO) A1

页码 (SHEET) 1 单位 (UNIT): MM

版本 (REV) A1 比例 (SCALE) 1:1

日期 (DATE) 2023.5.26

设计 (DESIGN) 李春风

审核 (CHECKED) 钟华华

核准 (APPROVED) 罗孝金

公差 (TOLERANCE UNSPECIFIED)  
X.X ±0.20  
X.XX ±0.15  
X.XXX ±0.10  
X.XX° ±5°  
X.X° ±2°



深圳市首韩科技有限公司  
SHENZHEN SHOUHAN TECHNOLOGY CO., LTD  
Tel: 0755-27597601 Fax: 0755-27597491

**承 认 书**  
**SPECIFICATION FOR APPROVAL**

客 户 Customer:

\_\_\_\_\_

产品名称 Project:

TYPE-C

\_\_\_\_\_

规格型号 Part No:

TYPE-C 6P WTL5.5 108

\_\_\_\_\_

**贵公司承认印 Approval signatures**

| 料 号/Part No. | 签 章/Signatures |
|--------------|----------------|
|              |                |

日期 Date:

|             |     |  |
|-------------|-----|--|
| 拟制/Drawn    | 李春风 |  |
| 审核/Check    | 钟华华 |  |
| 批准/Approved | 罗孝金 |  |



|  |                               |   |  |
|--|-------------------------------|---|--|
| RATING (额定值)                             |                               | 5 V 3 A   |  |
| PRACTICAL TEMPERATURE RANGE<br>使用温度范围    |                               | -20°C~85°C<br>在-20°C~85°C温度内使用  |  |
| STANDARD ATMOSPHEIC CONDITIONS<br>测试标准状况 |                               | <p>UNLESS OTHERWISE SPECIFIED<br/>THE STANDARD RANGE OF ATMOSPHERIC CONDITIONS FOR MAKING MEASUREMENTS AND TESTS ARE AS FOLLOWS:</p> <p>(1) BETWEEN BODY AND CONDUCTOR: 5. C TO 35°C<br/>(2) BETWEEN CONDUCTORS NOT TO BE CONTACT: 45% TO 85%<br/>(3) PRESSURE: 86Kpa TO 106Kpa</p> <p>在没有指定的情况下测试温度、湿度、气压如下:</p> <p>(1) 温度为 5°C~35°C<br/>(2) 湿度为 45%~85%<br/>(3) 气压为 86 Kpa~106Kpa</p> |  |
| MECHANICAL (机械性能)                        |                               |   |  |
| ITEM 项目                                  |                               | TEST CONDITIONS 测试条件  | PERFORMANCE 规格   |
| 1  | CONNECTION FORCE<br>插入力度      | MEASUREMENT SHALL BE MADE AFTER CONNECTING AND DISCONNECTING USING STANDARD PLUG GAUGE 3 TIMES.<br>依据标准的 PLUG GAUGE 做第 3 次拔插后测定   | 0.5~2.0Kgf   |
|  | DISCONNECTI ON FORCE<br>拔出力度  | MEASUREMENT SHALL BE MADE AFTER CONNECTING AND DISCONNECTING USING STANDARD PLUG GAUGE 3 TIMES.<br>依据标准的 PLUG GAUGE 做第 3 次拔插后测定   | 0.6~2.04Kgf  |
| 2  | TERMINAL STRENGTH<br>端子强度     | A STATIC LOAD OF 0.1N/m(1kgf/cm)SHALL BE APPLIED TO THE TIP OF THE TERMINAL FOR 1 MIN IN ANY DIRECTION<br>向排脚先端的任意一个方向加 1 分钟 0.1N/m(1kgf/cm)的力度.  | THERE SHALL BE NO DAMAGE TO THE TERMINAL SUCH AS CRACKS, LOOSENESS OR PLAY ELECTRICAL ,AND MECHANICAL CHARACTERISTICS SHALL BE SATISFIED<br>在排脚中没有裂开、松动等异常, 满足于机械、电气性能 |
| ELECTRICAL (电气性能)                        |                               |   |  |
| ITEM 项目                                  |                               | TEST CONDITIONS 测试条件  | PERFORMANCE 规格   |
| 3.1                                      | CONTACT RESISTANCE<br>接触电阻    | MEASURED AT SMALL CURRENT (100mA OR LESS) 1000Hz<br>在微小电流 (100 m A) 以下测试  | 40mΩ MAX   |
| 3.2                                      | INSULATION RESISTANCE<br>绝缘电阻 | <p>APPLY A VOLTAGE OF 100V DC FOR 1 MIN TO FOLLOWING PORTIONS AFTER WHICH MEASUREMENT SHALL BE MADE:</p> <p>(1) BETWEEN BODY AND CONDUCTOR<br/>(2) BETWEEN CONDUCTORS NOT TO BE CONTACT<br/>(3) BETWEEN CONDUCTORS NOT TO BE WHEN PLUG IS INSERTED DC100V 1 MIN</p> <p>输入 100V DC 电压 1 分钟, 按以下接触方法测试:</p> <p>(1) 插座体与排脚之间<br/>(2) 不接触的排脚之间<br/>(3) 插头插入时不接触排脚之间</p>                     | 100MΩ MIN  |

|     |                            |  |  |
|-----|----------------------------|--|--|
| 3.3 | DIELECTRIC STRENGTH<br>耐电压 | AC 100V rms(50~60Hz)FOR 1 MIN TRIP CURRENT:0.5mA<br>(1) BETWEEN BODY AND CONDUCTOR<br>(2) BETWEEN CONDUCTORS NOT TO BE CONTACT<br>(3) BETWEEN CONDUCTORS NOT TO BE WHEN PLUG IS INSERTED DC 100V 1 MIN<br>输入 AC 100V (50Hz) /min 电压 1 分钟感度电流为 0.5mA,<br>按以下接触方法测试:<br>(1) 插座体与排脚之间<br>(2) 不接触的排脚之间<br>(3) 插头插入时不接触排脚之间 | WITHOUT DAMAGE TO PARTS ARCING OR BREAKDOWN ETC<br>没有绝缘破坏等异常 |
|-----|----------------------------|--|--|

URABILITY (耐久性)

| ITEM 项目 | TEST CONDITIONS 测试条件                       | PERFORMANCE 规格   |
|---------|--|--|
| 4.1     | SOLDERABILITY TEST<br>可焊性试验                | (1) SOLDER WETTING TIME SHALL BE 3 SEC OR LESS<br>焊接时间应少于 3 秒<br>(2) THE AREA OF SOLDERING SHOULD BE OVER 75%<br>焊接面积应有 75%以上      |
| 4.2     | RESISTANCE TO SOLDERING HEAT TEST<br>耐焊性试验 | WITHOUT DEFOR MATION OF CASE OR EXCESSIVE LOOSENESS OF TEMINALS ELECTRICAL CHARACTERISTICS SHALL BE SATISFIED<br>本体无变形, 满足于机械、电气性能 |

REFLOW SOLDERING CONDITIONS:

PREHEAT: TEMPERATURE ON THE COPPER FOIL SURFACE SHOULD REACH 180°C. 120S AFTER THE P.C.B ENTERED INTO THE SOLDERING EQUIPMENT.

TALLEST TEMPERATURE: TEMPERATURE ON THE COPPER FOIL SURFACE SHOULD REACH THE PEAK TEMPERATURE OF 260±5°C WITH IN 20 SECONDS.

过回流焊条件:

预热: 电镀层表面的温度应达到 180°C, 120s 后电路板进入回流焊设备。

最高温度: 电镀层表面温度最高为 260±5°C 且停留不超过 20 秒。

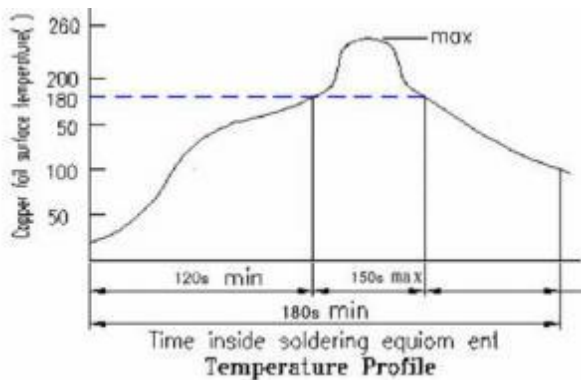

|      |  |   |   |
|------|--|---|---|
| 4. 2 | RESISTANCE TO SOLDERING HEAT TEST<br>耐焊性试验 | <p>SOLDERING IRON METHOD:<br/>BIT TEMPERATURE <math>330 \pm 5^{\circ}\text{C}</math> APPLICATION TIME OF SOLDERING IRON <math>3 \pm 0.5</math> SEC<br/>HOWEVER EXCESSIVE PRESSURE SHALL NOT BE APPLIED TO THE TERMINAL<br/>手焊接的时候温度需控制在 <math>330 \pm 5^{\circ}\text{C}</math> ,时间为 <math>3 \pm 0.5</math> 秒, 但不能在排脚上施加异常压力。</p>  | <p>WITHOUT DEFORMATION OF CASE OR EXCESSIVE LOOSENESS OF TEMINALS ELECTRICAL CHARACTERISTICS SHALL BE SATISFIED<br/>本体无变形, 满足于机械、电气性能</p>   |
| 4. 3 | HUMIDITY TEST<br>潮湿试验                      | <p>THE JACK SHALL BE STORED ATA TEMPERATURE OF <math>40 \pm 2^{\circ}\text{C}</math> AND A HUMIDITY OF 90% TO 96% FOR 96 Hr, THEN THE JACK SHALL BE MAINTAINED AT STANDARD ATMOSPHERIC CONDITION FOR 1 Hr FOR OTHER PROCEDURES<br/>放置 <math>40 \pm 2^{\circ}\text{C}</math> 的相应湿度为 90~96% Hr 环境中 96 小时后, 再将样板放在正常环境中 1 小时后进行测试</p>  | <p>THERE SHALL BE NO DAMAGE ON APPEARANCE.<br/>MECHANICAL AND ELECTRICAL CHARACTERISTICS SHALL BE SATISFIED<br/>外观无异常, 满足于机械、电气性能。</p>  |
| 4.4  | HEAT TEST<br>耐热试验                          | <p>THE JACK SHALL BE STORED ATA TEMPERATURE OF <math>70 \pm 2^{\circ}\text{C}</math> FOR 96 HOURS, AND THEN IT SHALL BE SUBJECTED TO THE CONTROLLED RECOVERY MBASURBM<br/>放置在温度 <math>70 \pm 2^{\circ}\text{C}</math> 中测试 96 小时后, 再放置正常室温中 1 小时来测定</p>  | <p>THERE SHALL BE NO DAMAGE ON APPEARANCE<br/>MECHANICAL AND ELECTRICAL CHARACTERISTICS SHALL BE SATISFIED<br/>外观无异常, 满足于机械、电气性能。</p>   |
| 4. 5 | COLD TEST<br>耐寒试验                          | <p>THE JACK SHALL BE STORED ATA TEMPERATURE OF <math>-25 \pm 3^{\circ}\text{C}</math> FOR 96 HOURS AND THEN IT SHALL BE SUBJECTED TO THE CONTROLLED RECOVERY CONDITIONS FOR 1 HOUR AFTER WHICH<br/>放置在温度 <math>-25 \pm 3^{\circ}\text{C}</math> 中 96 小时后, 再放置常温常湿中 1 小时来测定</p>  | <p>THERE SHALL BE NO DAMAGE ON APPEARANCE<br/>MECHANICAL AND ELECTRICAL CHARACTERISTICS SHALL BE SATISFIED<br/>外观无异常, 满足于机械、电气性能</p>  |
| 4. 6 | LIFE TEST<br>寿命试验                          | <p>WITHOUT LOAD CONNECTION AND DISCONNECTION SHALL BE MADE WITH THE MATING PLUGS AND JACKS FOR 5000 CYCLES AT A SPEED OF 10 TO 25 CYCLES/MIN<br/>无负荷<br/>将结合了的标准Plug(尽量要近于中心的)在1分钟内以10-25的速度, 进行5000次插入, 拔出<br/>LOAD:<br/>AT RATING CONDITION (NON-INDUCTIVE LOAD) CONNECTION AND DISCONNECTION SHALL BE MADE 5000 CYCLES AT A SPEED 10 TO 20 CYCLES / MIN<br/>负荷<br/>以定格状态(无诱导负荷)在1 分钟内以10-20次的速度进行 5000次插入、拔出</p> | <p>(1) CONTACT RESISTANCE SHALL BE <math>\leq 0.1 \Omega</math><br/>(2) DISCONNECTION FORCE SHALL BE 0.8 TO 2.0N<br/>(3) MECHANICAL AND ELECTRICAL CHARACTERISTICS SHALL BE SATISFIED<br/>(1) 接触电阻 <math>\leq 0.1 \Omega</math><br/>(2) 拔出力是 0.8~2.0N<br/>(3) 其它:满足于机械、电气性能</p> |

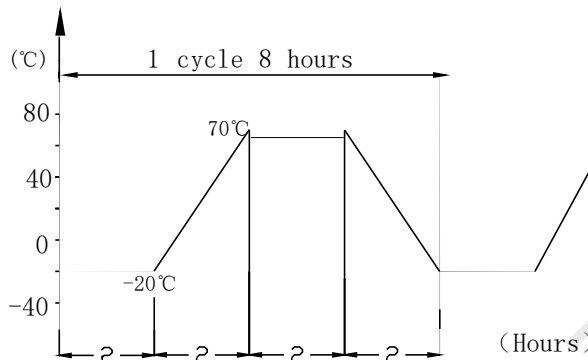
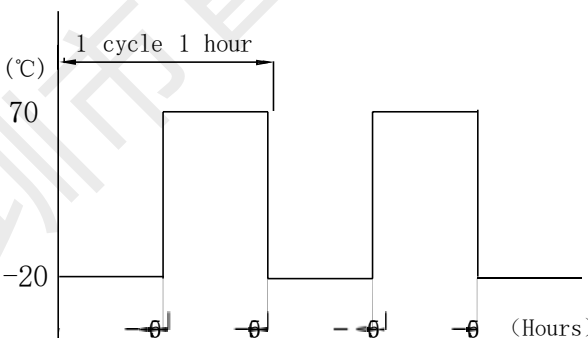
|            |  |  |   |
|------------|--|--|---|
| <p>4.7</p> | <p>TEMPERATURE CYCLING TEST<br/>温度循环测试</p> | <p>THE JACK SHALL BE SUB JECTED TO 5 CYCLES OF THE FOLLOWING CONDITIONS SHOWED IN THE FIGURE,AND THEN SHALL RETURNED ALLOWED TO REMAIN IN ROOM AMBIENT CONDITION FOR 30 MINUTES<br/>将插座以下列条件作 5 个循环， 然后放回室内环境 30 分钟<br/>Temp(°C)</p>        | <p>THERE SHALL BE NO DEFORMATION OR CRACKS IN MOLDED PART.<br/>INSERTION &amp; EXTRACTION FORCE:3 TO 20N<br/>CONTACT RESISTANCE:MAX.30M Ω<br/>INSULATION RESISTANCE: MIN.100 M Ω<br/>DIELECTRIC WITHSTANDING VOLTAGE: 100VAC/MIN(BETWEEN TERMINALS)</p> <p>产品不能变形与破裂<br/>插拔力: 3N 至 20N<br/>接触电阻: 最大 30m Ω<br/>绝缘电阻: 最小 100 M Ω<br/>绝缘耐压: 最小 100VAC (端子之间)</p> |
| <p>4.8</p> | <p>COLD&amp;HEAT SHOCK TEST<br/>冷热冲击测试</p> | <p>THE JACK SHALL BE SUBJECTED TO 5 CYCLES OF THE FOLLOWING CONDITIONS SHOWED IN THE FIGURE,AND THEN SHALL RETURNED AND ALLOWED TO REMAIN IN ROOM AMBIENT CONDITION FOR 30 MINUTES<br/>将插座以下列条件作 5 个循环， 然后放回室内环境 30 分钟<br/>TEMP (°C)</p>  | <p>THERE SHALL BE NO DEFORMATION OR CRACKS IN MOLDED PART.<br/>INSERTION &amp; EXTRACTION FORCE:3 TO 25N<br/>CONTACT RESISTANCE:MAX.30M Ω<br/>INSULATION RESISTANCE: MIN.100 M Ω<br/>DIELECTRIC WITHSTANDING VOLTAGE: 500VAC/MIN(BETWEEN TERMINALS)</p> <p>产品不能变形与破裂<br/>插拔力: 3N 至 25N<br/>接触电阻: 最大 30m Ω<br/>绝缘电阻: 最小 100 M Ω<br/>绝缘耐压: 最小 500VAC (端子之间)</p> |

## X-ON Electronics

Largest Supplier of Electrical and Electronic Components

*Click to view similar products for [USB Connectors](#) category:*

*Click to view products by [SHOU](#) manufacturer:*

Other Similar products are found below :

[950](#) [A-USB A-LP-SMT-C](#) [A-USB B-TOP-C](#) [MUSBD11135](#) [17-200721](#) [217450-1](#) [KMBVX-TH-5S-B30](#) [KUSBX-AS2N-W](#) [KUSBX-SMT2AP1S-W30](#) [935](#) [957](#) [30-498-6](#) [SK-60A-2](#) [1734082-1](#) [30-470](#) [30-489](#) [30-541](#) [MIKROE-1451](#) [USBFTVSCCG](#) [1-1734084-2](#) [10135326-001LF](#) [4198](#) [USB-A-D-VT](#) [USB-A-S-RA-TSMT](#) [1310-1023-02](#) [690-024-633-031](#) [UB-20PMFP-LC7001](#) [17-200011](#) [UB-20AFMM-LL7A01](#) [1040870124](#) [CAP-WCCMLPB1](#) [2274475-3](#) [UB-20BMFA-SL8001](#) [914-614A2025S10200](#) [ZX40-B-5S-1500-STDA\(30\)](#) [GSB3116344HR](#) [USB3FTV2SAZNF459](#) [U221-041N-1WVS62-F5D](#) [HYCW153-USBD05-500B](#) [HYCW219-USBD05-075B](#) [HYCW148-USBD05-117B](#) [HYCW149-USBD05-740B](#) [HYCW204-USBD05-108B](#) [HYCW214-USBA04-113B](#) [HYCW213-USBA04-113B](#) [UB-20AMFM-SL7A01](#) [KMMX-BSMT35S-1-B30TR](#) [2345986-1](#) [10082141-N340LF](#) [10117836-011LF](#)