

Withdrawable drive for contactors 3RT105, 3RT145 AC (50...60 Hz) / DC operation, 220 ... 240 V Operating mechanism: Standard,economy circuit Screw terminal

product brand name	SIRIUS
product category	Solenoid coils
product designation	Changeover operating mechanism
Substance Prohibitance (Date)	05/01/2012
type of voltage of the control supply voltage	AC/DC
control supply voltage 1 at AC	
• at 50 Hz	220 ... 240 V
• at 60 Hz	220 ... 240 V
control supply voltage 2 at AC	
• at 50 Hz rated value	240 V
• at 60 Hz rated value	240 V
control supply voltage 1 at DC	
•	220 ... 240 V
control supply voltage 2 at DC rated value	240 V
apparent pick-up power of magnet coil at AC	
• at 50 Hz	300 VA
• at 60 Hz	300 VA
inductive power factor with closing power of the coil	
• at 50 Hz	0.9
• at 60 Hz	0.9
apparent holding power of magnet coil at AC	
• at 50 Hz	5.8 VA
• at 60 Hz	5.8 VA
inductive power factor with the holding power of the coil	
• at 50 Hz	0.8
• at 60 Hz	0.8

Approvals Certificates

General Product Approval



[Confirmation](#)



EMV

Test Certificates

Marine / Shipping



[Special Test Certificate](#)

[Type Test Certificates/Test Report](#)





[Confirmation](#)

[Miscellaneous](#)

[Special Test Certificate](#)

[Environmental Confirmations](#)

Further information

Information on the packaging

<https://support.industry.siemens.com/cs/ww/en/view/109813875>

Information- and Downloadcenter (Catalogs, Brochures,...)

<https://www.siemens.com/ic10>

Industry Mall (Online ordering system)

<https://mall.industry.siemens.com/mall/en/en/Catalog/product?mlfb=3RT1955-5AP31>

Cax online generator

<http://support.automation.siemens.com/WW/CAXorder/default.aspx?lang=en&mlfb=3RT1955-5AP31>

Service&Support (Manuals, Certificates, Characteristics, FAQs,...)

<https://support.industry.siemens.com/cs/ww/en/ps/3RT1955-5AP31>

Image database (product images, 2D dimension drawings, 3D models, device circuit diagrams, EPLAN macros, ...)

http://www.automation.siemens.com/bilddb/cax_de.aspx?mlfb=3RT1955-5AP31&lang=en

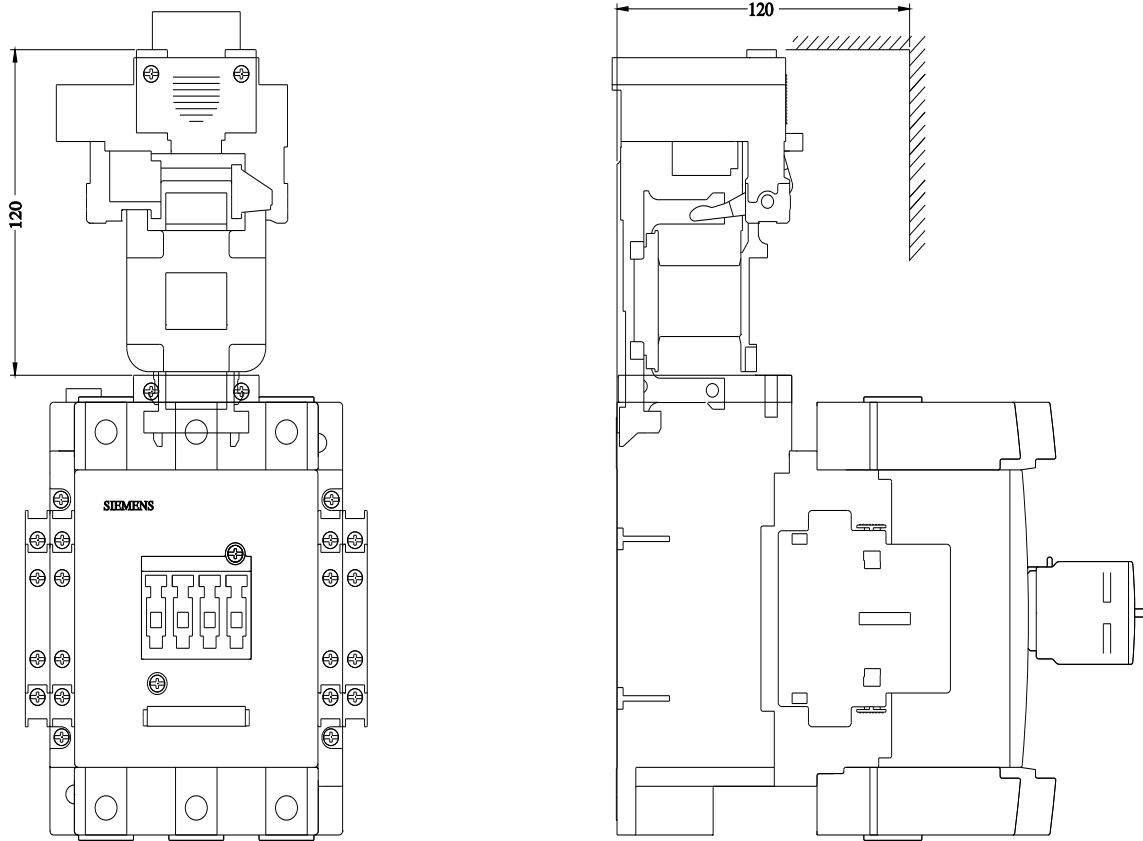

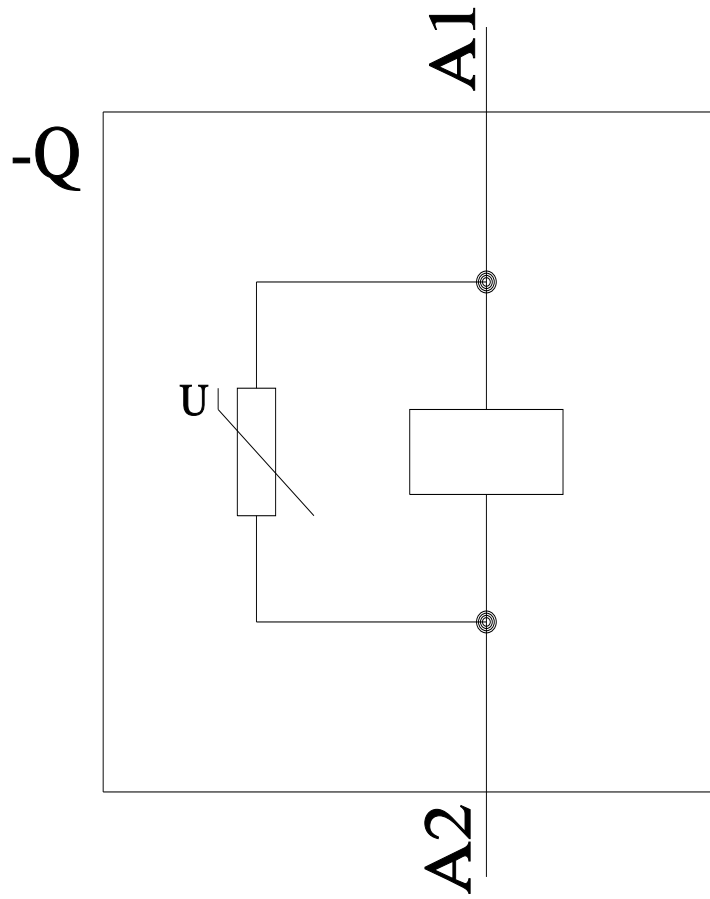

last modified:

1/10/2024 ↻

X-ON Electronics

Largest Supplier of Electrical and Electronic Components

Click to view similar products for [Contactor Accessories](#) category:

Click to view products by [Siemens](#) manufacturer:

Other Similar products are found below :

[3RT1945-5AP61](#) [YC9Z-RHU10A16P](#) [YC9Z-RHU5A1P6](#) [YC9Z-CI6](#) [YC9Z-CNA211M](#) [1SAX351001R1101](#) [1SBN050100R1002](#)
[1SBN050020R1003](#) [022.63](#) [F4-22](#) [EH04-11N](#) [CA4-31E](#) [CAL5X-11](#) [F5-T0](#) [CA5X-22M](#) [YC9Z-LCU38A24](#) [YC9Z-RHU5A2P5](#) [49AB20](#)
[75D73251A](#) [022.18.1](#) [022.26](#) [11BA167124V203](#) [LADN04](#) [LADN10](#) [1SAX121001R1103](#) [1SBN020010R1003](#) [1SBN050020R1000](#)
[1SBN050200R1002](#) [1SBN081313R2000](#) [3RA2912-2H](#) [3RA2913-2AA1](#) [3RA2922-2H](#) [3RA2923-2AA1](#) [3RA2923-2BB1](#) [3RF2900-3PA88](#)
[3RT1916-4KA1](#) [3RT2926-3AB31](#) [CAL5-11](#) [DB42](#) [1SBN020314R1000](#) [1SBN082306T1000](#) [CA5-22M](#) [DB80](#) [EHTK210](#) [LDC4](#) [MS325-](#)
[SM1](#) [GCA95A48VDC](#) [GUR02](#) [13222574](#) [SW182B-1](#)