

## ■ Switching Diode

### ■ Features

- Small Package
- Low forward voltage :  $V_{F(3)} = 0.9 \text{ V(Typ.)}$
- Fast Reverse Recovery Time :  $t_{rr} = 1.6 \text{ ns(Typ.)}$
- Small Total Capacitance :  $C_T = 0.9\text{pF(Typ.)}$

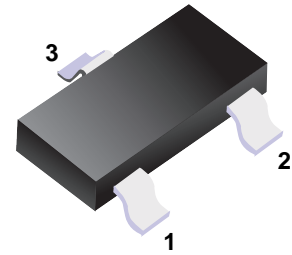

■ Simplified outline(SOT-23)

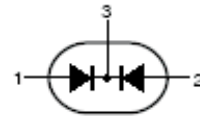

### ■ Marking

Marking	B3
---------	----

### ■ Absolute Maximum Ratings $T_a = 25^\circ\text{C}$

Parameter	Symbol	Rating	Unit
Peak Reverse voltage	$V_{RM}$	85	V
DC Blocking Voltage	$V_R$	80	
Average Rectified Output Current	$I_o$	100	mA
Peak forward surge current	$I_{FM}$	300	
Power Dissipation	$P_D$	150	mW
Junction Temperature	$T_J$	125	$^\circ\text{C}$
Storage temperature range	$T_{stg}$	-55 to 150	

### ■ Electrical Characteristics $T_a = 25^\circ\text{C}$

Parameter	Symbol	Test Conditions	Min	Typ	Max	Unit
Reverse breakdown voltage	$V_R$	$I_R = 100 \text{ }\mu\text{A}$	80			V
Forward voltage	$V_{F1}$	$I_F = 1 \text{ mA}$		0.6		
	$V_{F2}$	$I_F = 10\text{mA}$		0.72		
	$V_{F3}$	$I_F = 100 \text{ mA}$		0.9	1.2	
Reverse voltage leakage current	$I_{R1}$	$V_R = 30 \text{ V}$			0.1	$\mu\text{A}$
	$I_{R2}$	$V_R = 80 \text{ V}$			0.5	
Capacitance between terminals	$C_T$	$V_R = 0 \text{ V, } f = 1 \text{ MHz}$		0.9	3	pF
Reverse recovery time	$t_{rr}$	$I_F = 10\text{mA}$		1.6	4	ns

## ■ Typical Characteristics

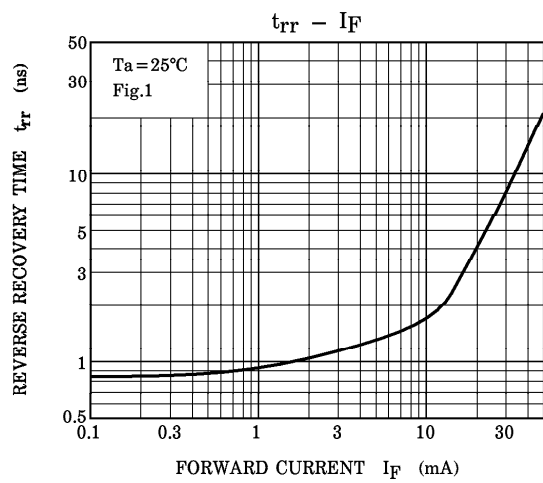
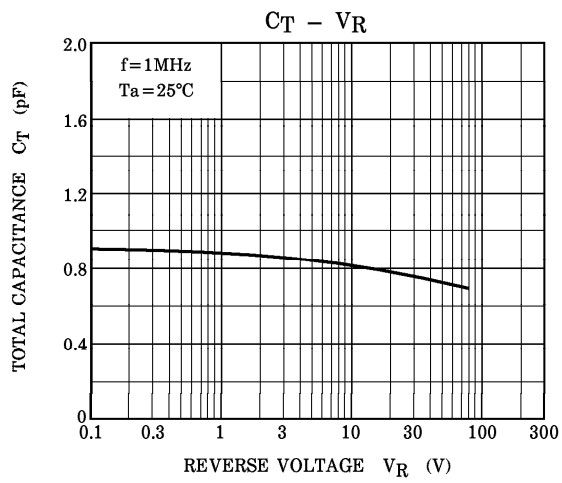
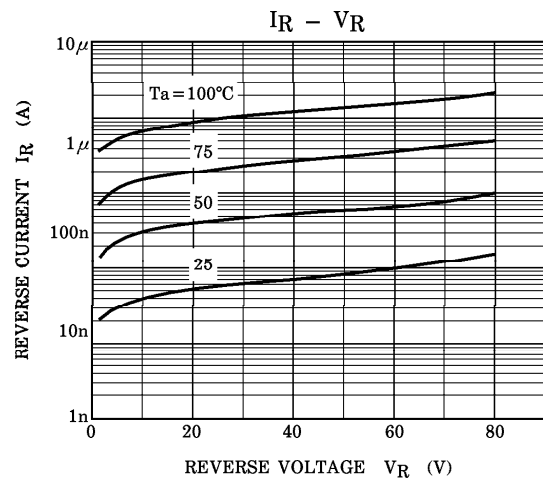
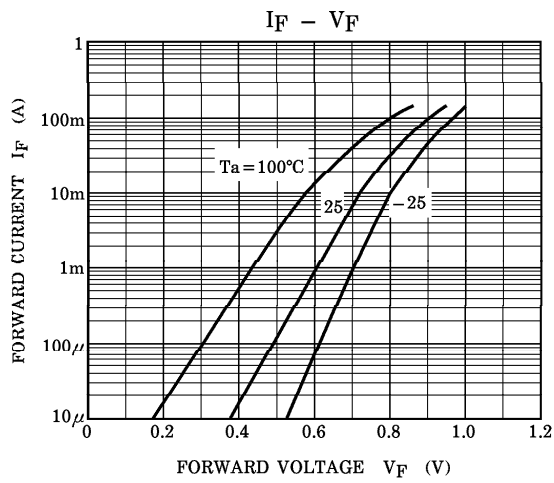

■ SOT-23

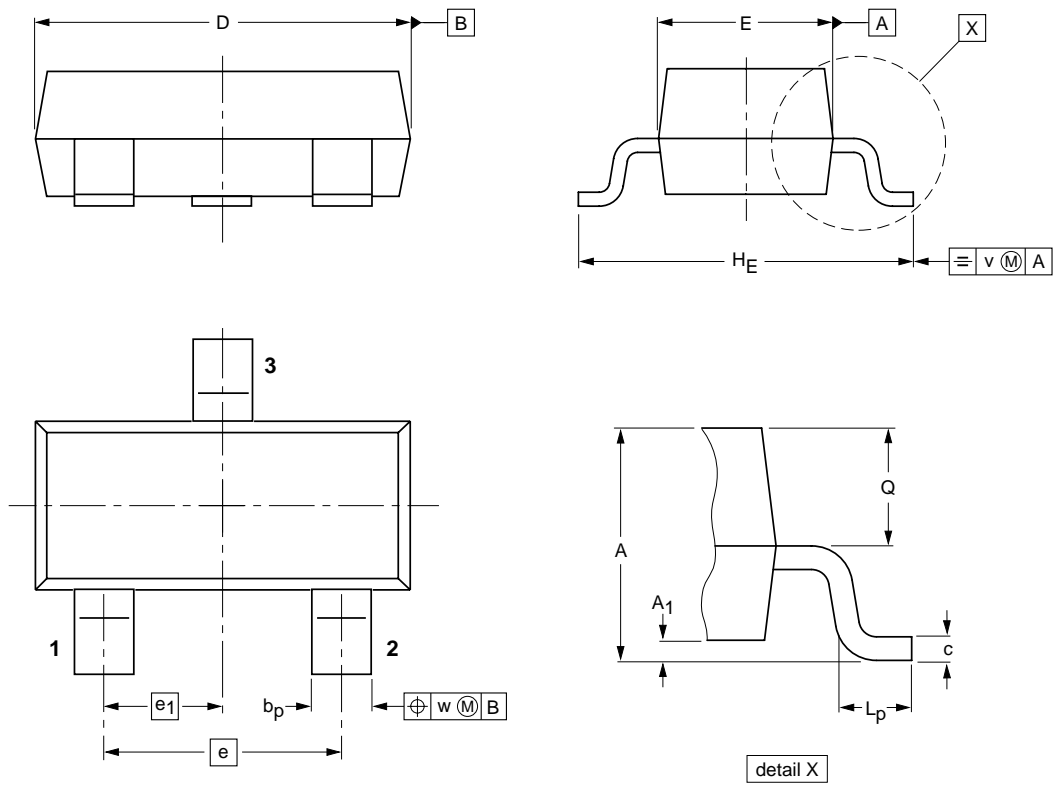

**DIMENSIONS (mm are the original dimensions)**

UNIT	A	A <sub>1</sub> max.	b <sub>p</sub>	c	D	E	e	e <sub>1</sub>	H <sub>E</sub>	L <sub>p</sub>	Q	v	w
mm	1.1 0.9	0.1	0.48 0.38	0.15 0.09	3.0 2.8	1.4 1.2	1.9	0.95	2.5 2.1	0.45 0.15	0.55 0.45	0.2	0.1

## X-ON Electronics

Largest Supplier of Electrical and Electronic Components

*Click to view similar products for* [Diodes - General Purpose, Power, Switching category:](#)

*Click to view products by* [SLKORMICRO manufacturer:](#)

Other Similar products are found below :

[MCL4151-TR3](#) [MMBD3004S-13-F](#) [RD0306T-H](#) [1N3611](#) [NTE156A](#) [NTE574](#) [NTE6244](#) [1SS193,LF](#) [1SS400CST2RA](#) [SDAA13](#)  
[SHN2D02FUTW1T1G](#) [LS4151GS08](#) [1N4449](#) [1N456A](#) [1N4934-E3/73](#) [1N914BTR](#) [RFUH20TB3S](#) [D291S45T](#) [BAV300-TR](#) [BAW56DWQ-](#)  
[7-F](#) [BAW56M3T5G](#) [BAW75-TAP](#) [MM230L-CAA](#) [IDW40E65D1](#) [JAN1N3600](#) [JAN1N4454UR-1](#) [LL4151-GS18](#) [SMMSD4148T3G](#)  
[BYW95B/A52A](#) [NSVDAN222T1G](#) [CDSZC01100-HF](#) [LL4150-M-08](#) [1N4454-TR](#) [BAV70HDW-7](#) [BAS28-7](#) [JANTX1N6640](#) [BAW56HDW-](#)  
[13](#) [BAS28 TR](#) [VS-HFA04SD60STR-M3](#) [NSVM1MA152WKT1G](#) [1SS388-TP](#) [RGP30D-E3/73](#) [VS-8EWF02S-M3](#) [BAV99TQ-13-F](#)  
[BAV99HDW-13](#) [MMDB30-E28X](#) [IDP20C65D2XKSA1](#) [LS4148](#) [IDV15E65D2](#) [NSVM1MA152WAT1G](#)