

# SCHOTTKY BARRIER DIODE

**PINNING**

PIN	DESCRIPTION
1	Cathode
2	Anode

**FEATURES**

- Small surface mounting type
- Low reverse current and low forward voltage
- High reliability



**■ Maximum Ratings and Electrical Characteristics, Single Diode @Ta=25°C**

Parameter	Symbol	Limit	Unit
DC reverse voltage	$V_R$	30	V
Mean rectifying current	$I_O$	100	mA
Non-repetitive Peak forward surge current @ t=8.3ms	$I_{FSM}$	500	mA
Power dissipation	$P_D$	100	mW
Thermal Resistance Junction to Ambient	$R_{\theta JA}$	1000	°C/W
Operating Junction Temperature Range	$T_j$	-40 ~ +125	°C
Storage Temperature Range	$T_{stg}$	-55 ~ +150	°C

**■ Electrical Ratings @Ta=25°C**

Parameter	Symbol	Test Condition	Min	Typ	Max	Unit
Reverse breakdown voltage	$V_{(BR)}$	$I_R=10\mu A$	30			V
Reverse current	$I_R$	$V_R=10V$			2	$\mu A$
Forward voltage	$V_F$	$I_F=10mA$			0.40	V
		$I_F=100mA$			0.60	V

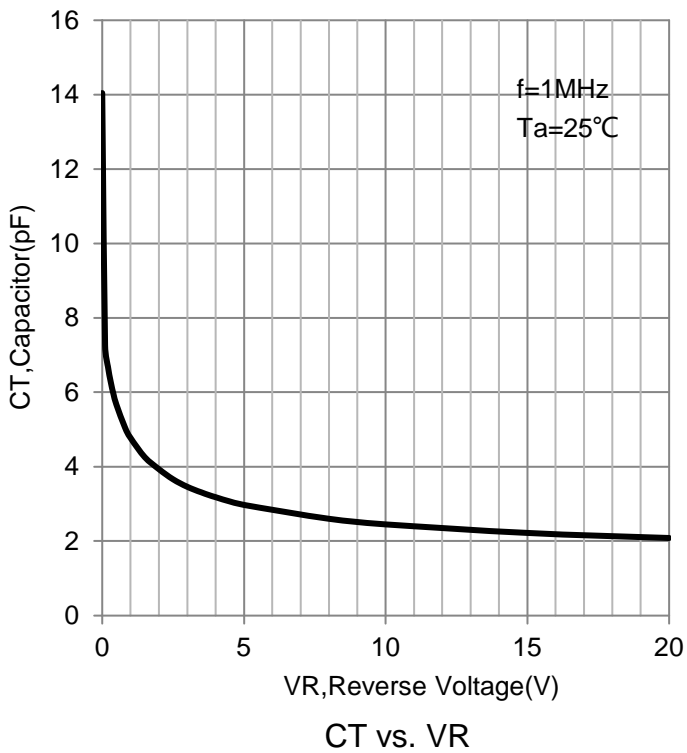
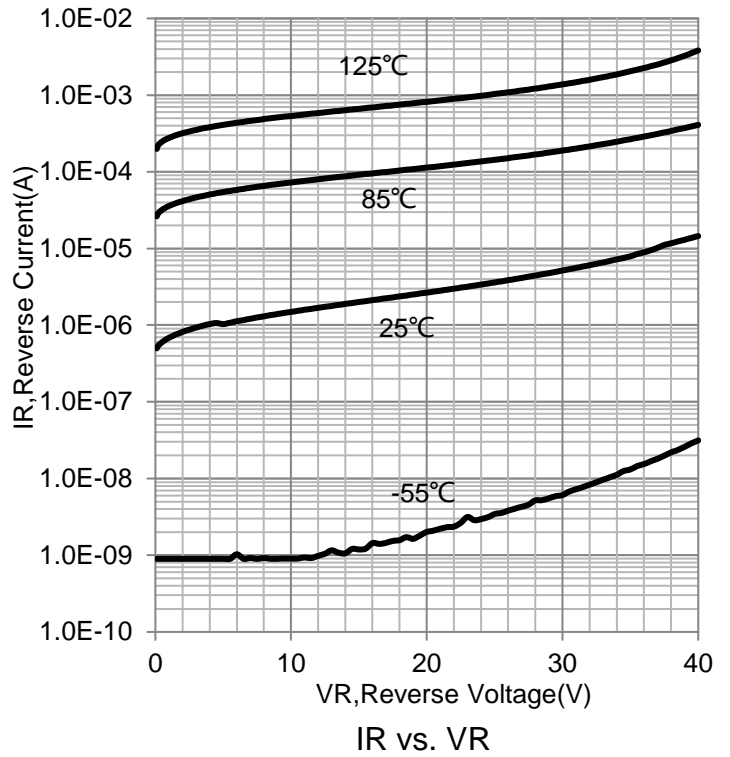
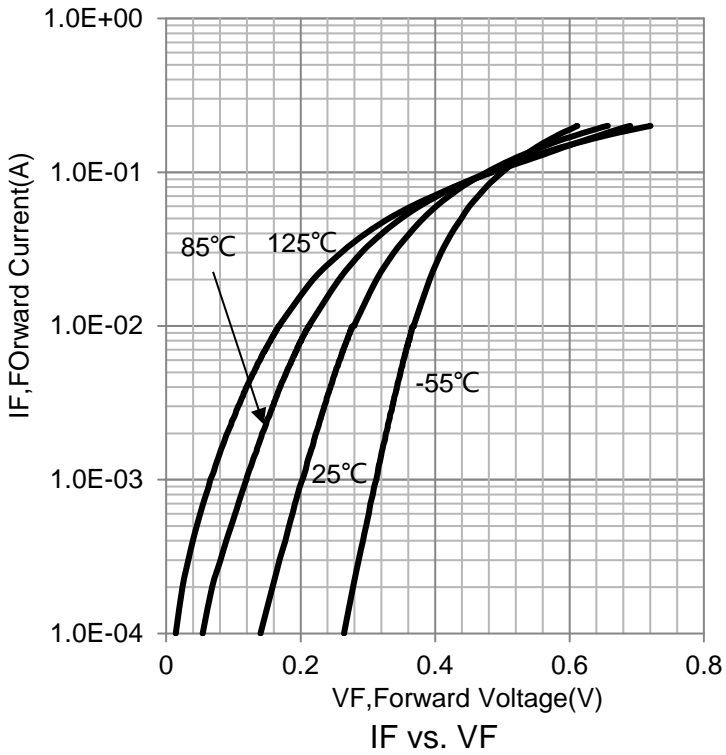
## Typical Characteristics

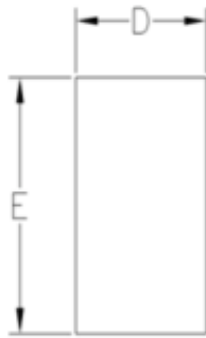
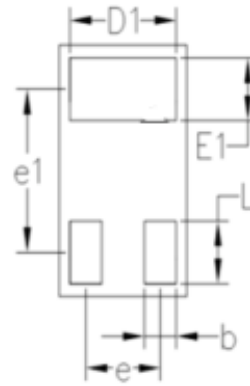
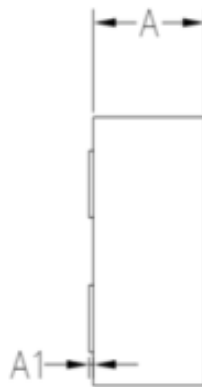

**DFN0603-2L Package Outline Dimensions**

**TOP VIEW**

**BOTTOM VIEW**

**SIDE VIEW**

SYMBOL	DIMENSIONS IN MM		
	MIN	NOM	MAX
A	0.45	0.50	0.55
A1	0.00	—	0.05
D	0.55	0.60	0.65
E	0.95	1.00	1.05
D1	0.45	0.50	0.55
E1	0.20	0.25	0.30
L	0.20	0.25	0.30
b	0.10	0.15	0.20
e	0.35BSC		
e1	0.65BSC		

## X-ON Electronics

Largest Supplier of Electrical and Electronic Components

*Click to view similar products for [Schottky Diodes & Rectifiers](#) category:*

*Click to view products by [SLKORMICRO](#) manufacturer:*

Other Similar products are found below :

[MA4E2039](#) [MA4E2508M-1112](#) [MBR0530L-TP](#) [MBR10100CT-BP](#) [MBR1545CT](#) [MMBD301M3T5G](#) [RB160M-50TR](#)  
[BAS16E6433HTMA1](#) [BAS 3010S-02LRH E6327](#) [BAT 54-02LRH E6327](#) [IDL02G65C5XUMA1](#) [NSR05F40QNXT5G](#) [NSVR05F40NXT5G](#)  
[NTE555](#) [JANS1N6640](#) [SB07-03C-TB-H](#) [SB1003M3-TL-W](#) [SBM30-03-TR-E](#) [SBS818-TL-E](#) [SK310-T](#) [SK33A-TP](#) [SK34B-TP](#) [SS3003CH-](#)  
[TL-E](#) [PDS3100Q-7](#) [GA01SHT18](#) [CRS10I30A\(TE85L,QM](#) [MA4E2501L-1290](#) [MBRA140TRPBF](#) [MBRB30H30CT-1G](#) [JANTX1N5712-1](#)  
[SB007-03C-TB-E](#) [SK33B-TP](#) [SK35A-TP](#) [SK38B-LTP](#) [NTE505](#) [NTSB30U100CT-1G](#) [VS-6CWQ10FNHM3](#) [CRG04\(T5L,TEMQ\)](#)  
[ACDBA1100LR-HF](#) [ACDBA1200-HF](#) [ACDBA240-HF](#) [ACDBA3100-HF](#) [CDBQC0530L-HF](#) [ACDBA260LR-HF](#) [ACDBA1100-HF](#)  
[MA4E2502L-1246](#) [10BQ015-M3/5BT](#) [10BQ060-M3/5BT](#) [NRVB130LSFT1G](#) [CRS08TE85LQM](#)