

PLANAR SCHOTTKY BARRIER DIODE

PINNING

| PIN | DESCRIPTION |
|-----|-------------|
| 1 | Cathode |
| 2 | Anode |

FEATURES

- Small surface mounting type
- Low reverse current and low forward voltage
- High reliability



■ Maximum Ratings and Electrical Characteristics, Single Diode @Ta=25°C

| Parameter | Symbol | Limit | Unit |
|---|-----------------|------------|------|
| DC reverse voltage | V_R | 30 | V |
| Mean rectifying current | I_O | 100 | mA |
| Non-repetitive Peak forward surge current @ t=8.3ms | I_{FSM} | 500 | mA |
| Power dissipation | P_D | 200 | mW |
| Thermal Resistance Junction to Ambient | $R_{\theta JA}$ | 500 | °C/W |
| Operating Junction Temperature Range | T_j | -40 ~ +125 | °C |
| Storage Temperature Range | T_{stg} | -55 ~ +150 | °C |

■ Electrical Ratings @Ta=25°C

| Parameter | Symbol | Test Condition | Min | Typ | Max | Unit |
|---------------------------|------------|----------------|-----|-----|------|---------|
| Reverse breakdown voltage | $V_{(BR)}$ | $I_R=10\mu A$ | 30 | | | V |
| Reverse current | I_R | $V_R=10V$ | | | 2 | μA |
| Forward voltage | V_F | $I_F=10mA$ | | | 0.40 | V |
| | | $I_F=20mA$ | | | 0.45 | V |
| | | $I_F=100mA$ | | | 0.60 | V |
| | | $I_F=200mA$ | | | 0.70 | V |

Typical Characteristics

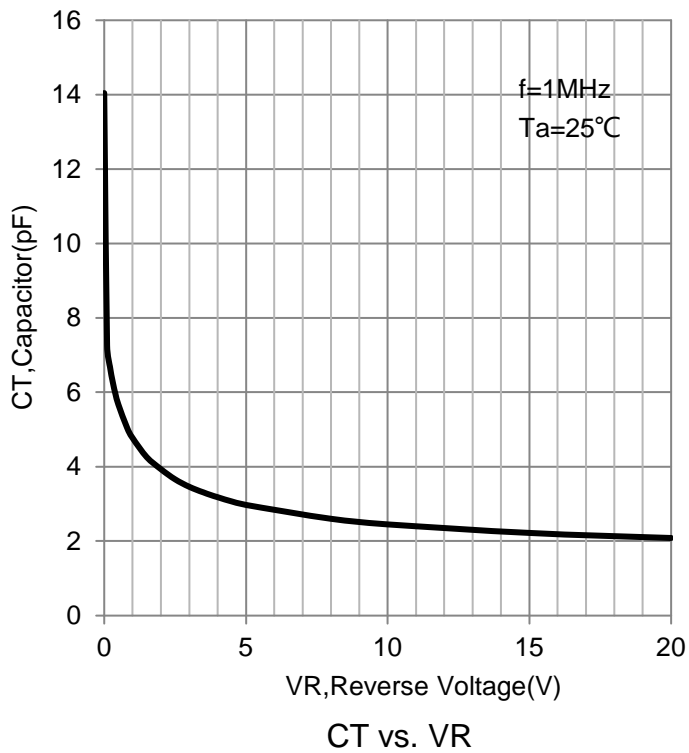
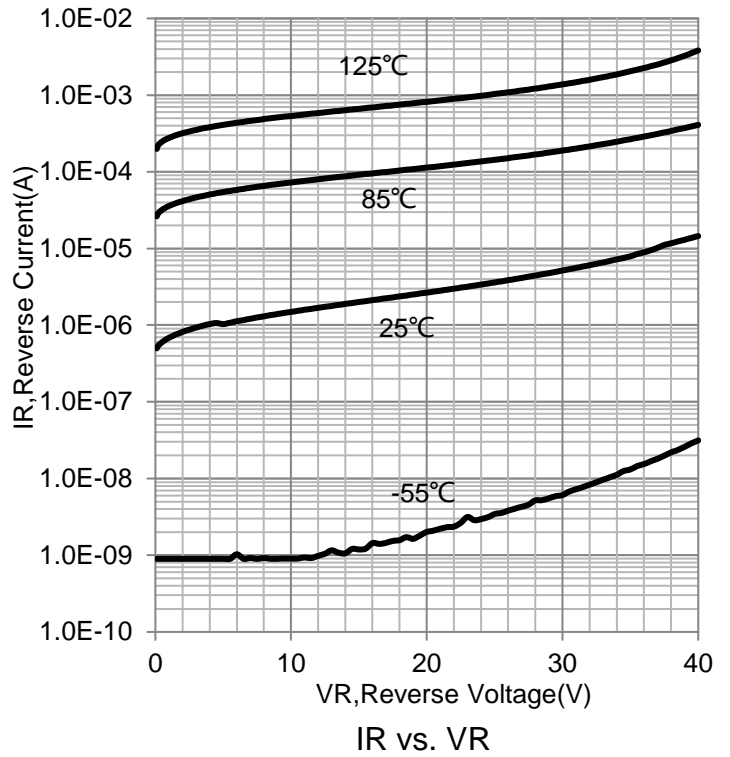
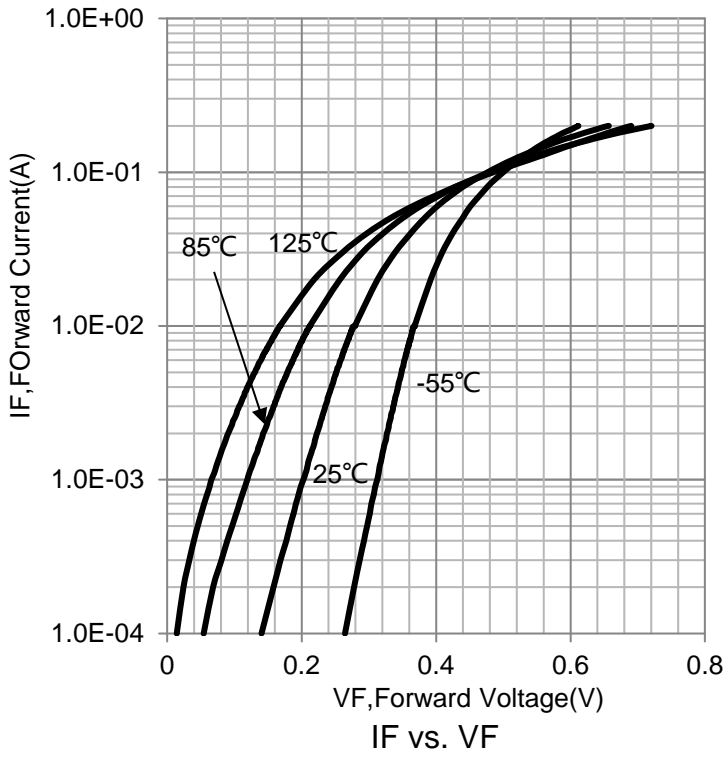

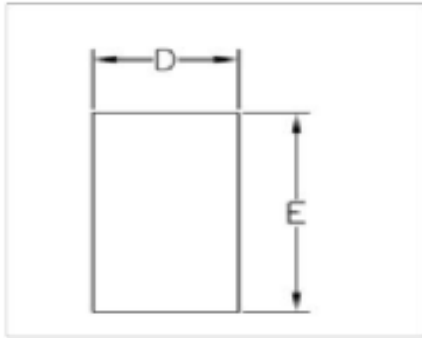
DFN1006-2L Package Outline Dimensions

TOP VIEW

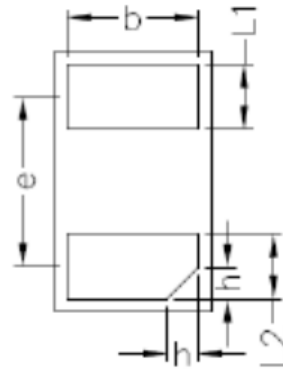

BOTTOM VIEW

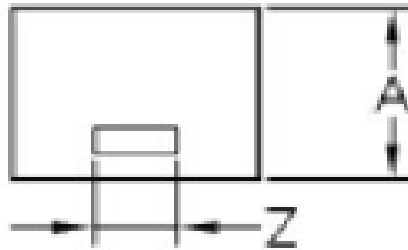

SIDE VIEW

| Symbol | Dimensions In Millimeters | | |
|--------|---------------------------|------|------|
| | Min | Nom | Max |
| D | 0.55 | 0.60 | 0.65 |
| E | 0.95 | 1.00 | 1.05 |
| L1 | 0.20 | 0.25 | 0.30 |
| L2 | 0.20 | 0.25 | 0.30 |
| A | 0.45 | 0.50 | 0.55 |
| Z | 0.15 | 0.20 | 0.25 |
| b | 0.45 | 0.50 | 0.55 |
| e | 0.64BSC | | |
| h | 0.07 | 0.12 | 0.17 |

X-ON Electronics

Largest Supplier of Electrical and Electronic Components

Click to view similar products for [Schottky Diodes & Rectifiers](#) category:

Click to view products by [SLKORMICRO](#) manufacturer:

Other Similar products are found below :

[MA4E2039](#) [MA4E2508M-1112](#) [MBR0530L-TP](#) [MBR10100CT-BP](#) [MBR1545CT](#) [MMBD301M3T5G](#) [RB160M-50TR](#)
[BAS16E6433HTMA1](#) [BAS 3010S-02LRH E6327](#) [BAT 54-02LRH E6327](#) [IDL02G65C5XUMA1](#) [NSR05F40QNXT5G](#) [NSVR05F40NXT5G](#)
[NTE555](#) [JANS1N6640](#) [SB07-03C-TB-H](#) [SK310-T](#) [SK33A-TP](#) [SK34B-TP](#) [SS3003CH-TL-E](#) [PDS3100Q-7](#) [GA01SHT18](#)
[CRS10I30A\(TE85L,QM](#) [MA4E2501L-1290](#) [MBRB30H30CT-1G](#) [JANTX1N5712-1](#) [SB007-03C-TB-E](#) [SK33B-TP](#) [SK35A-TP](#) [SK38B-LTP](#)
[NTE505](#) [NTSB30U100CT-1G](#) [VS-6CWQ10FNHM3](#) [CRG04\(T5L,TEMQ\)](#) [ACDBA1100LR-HF](#) [ACDBA1200-HF](#) [ACDBA240-HF](#)
[ACDBA3100-HF](#) [CDBQC0530L-HF](#) [ACDBA260LR-HF](#) [ACDBA1100-HF](#) [MA4E2502L-1246](#) [10BQ015-M3/5BT](#) [10BQ060-M3/5BT](#)
[NRVB130LSFT1G](#) [CRS08TE85LQM](#) [PMAD1108-LF](#) [B120Q-13-F](#) [1N5819T-G](#) [B0530WSQ-7-F](#)