

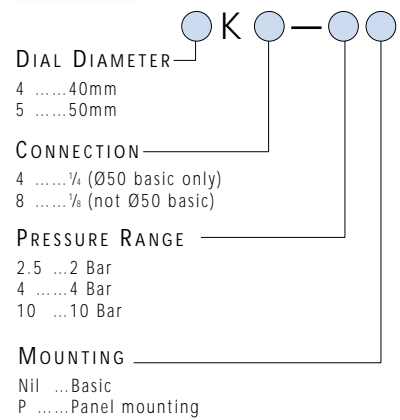

## PRESSURE GAUGES

- ✓ 3 pressure ranges
- ✓ Centre back or panel mount
- ✓ 1/8" or 1/4" connection
- ✓ 40 or 50mm diameter face

### HOW TO ORDER PRESSURE GAUGES



### NOTE

For Air Preparation series AR/AW1000, use SMC gauge part number:

**G27-10-R1** 1/8" connection

**STOCKED PRODUCTS**  
 FOR A LIST OF STOCKED PRODUCTS,  
 PLEASE SEE THE CURRENT SMC PRICE LIST

### DIMENSIONS 4K8-10/4/2.5

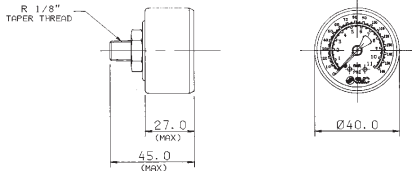

NOTE: TAPER THREADS TO I

### DIMENSIONS 5K4-10/4/2.5

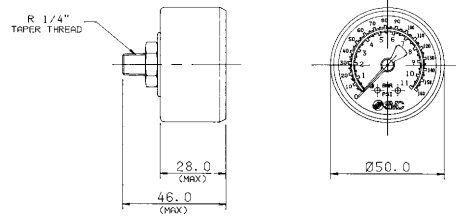

NOTE: TAPER THREADS TO I

### DIMENSIONS 5K8-10P/4P/2.5P

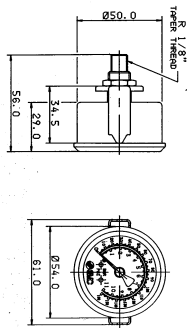

### DIMENSIONS 4K8-10P/4P/2.5P

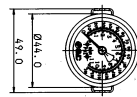

### DIMENSIONS G27-10-R1

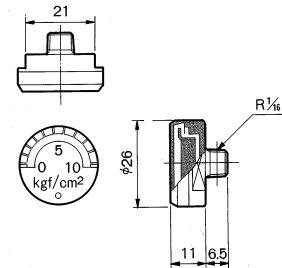

SEE INSIDE FRONT COVER FOR  
 DETAILS OF YOUR LOCAL SALES OFFICE



FOR FURTHER TECHNICAL  
 DETAILS ON THIS  
 PRODUCT REQUEST  
 CATALOGUE REFERENCE  
 E5G

### HIGH NOISE REDUCTION TYPE SILENCER SERIES ANA1/ANB1

- ✓ Standardised thread and one-touch connection
- ✓ Choice of two orifice sizes
- ✓ Compact, robust construction
- ✓ Minimum flow restriction for low back pressure
- ✓ Wide range of options
- ✓ High noise reduction (40dB(A) for ANA1)
- ✓ Higher flow rate from ANB1: ideal for use on common exhaust ports of valve manifolds

Note:

- avoid outdoor operation
- avoid lateral loading
- whilst compressor oil will not clog these silencers, grease and other poor flowing oils in the exhaust will clog and cause deterioration



#### TECHNICAL SPECIFICATIONS

Series	A1	B1
Max. operating pressure	1.0MPa(10.2kgf/cm <sup>2</sup> )	1.0MPa(10.2kgf/cm <sup>2</sup> )
Noise reduction effect	40dB(A)	38dB(A)
Ambient and fluid temperature	5-60°C	5-60°C
Thread	R(PT)	R(PT)



How To ORDER  
ANA1/ANB1 SERIES



- PORT SIZE (SCREW-IN)
- |                   |                      |
|-------------------|----------------------|
| 01 ...1/8         | <b>One Touch</b>     |
| 02 ...1/4         | C06 ...Ø6 (B1 only)  |
| 03 ...3/8         | C08 ...Ø8            |
| 04 ...1/2         | C10 ...Ø10           |
| 06 ...3/4         | C12 ...Ø12 (A1 only) |
| 10 ...1           |                      |
| 12 ...1 1/4       |                      |
| 14 ...1 1/2       |                      |
| 20 ...2 (A1 only) |                      |

**STOCKED PRODUCTS**  
FOR A LIST OF STOCKED PRODUCTS,  
PLEASE SEE THE CURRENT SMC PRICE LIST

#### DIMENSIONS

MODEL (THREAD CONNECTION)

	orifice (mm <sup>2</sup> )	(g)	A	B	C
ANA1-01	1/4	10	4	37	16
ANA1-02	1/4	15	14	64	22
ANA1-03	3/8	35	22	84	25
ANA1-04	1/2	60	36	98	30
ANA1-06	3/4	90	110	111	46
ANA1-10	1	160	180	132	50
ANA1-12	1 1/4	280	544	200	74
ANA1-14	1 1/2	450	612	230	74
ANA1-20	2	610	873	271	86
ANB1-01	1/4	15	10	51	22
ANB1-02	1/4	35	22	81	25
ANB1-03	3/8	60	35	93	30
ANB1-04	1/2	90	94	107	46
ANB1-06	3/4	160	175	133	50
ANB1-10	1	280	462	190	74
ANB1-12	1 1/4	450	612	230	74
ANB1-14	1 1/2	610	871	271	86

#### DIMENSIONS

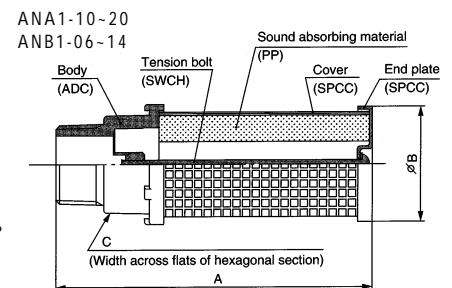
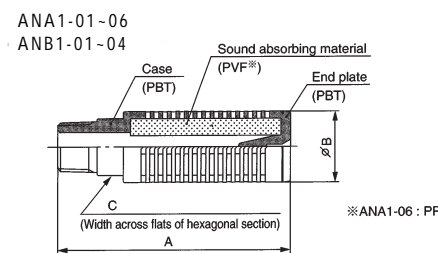

#### DIMENSIONS

MODEL (ONE TOUCH FITTINGS CONNECTION)

Model	Applicable one touch fittings size	Effective orifice (mm <sup>2</sup> )	Weight (g)	Dimensions (mm)
ANA1-C08	Ø8	11	5	58 16
ANA1-C10	Ø10	15	13	76 22
ANA1-C12	Ø12	33	19	95 25
ANB1-C06	Ø6	8	5	52 16
ANB1-C08	Ø8	13	12	73 22
ANB1-C10	Ø10	28	18	94 25

Notes:

- To install threaded versions screw in hand tight then spanner tighten 1/4 turn only.
- Avoid contact with solvents or corrosive gases.

#### DIMENSIONS

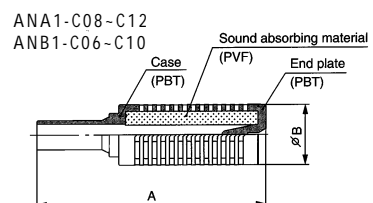

OTHER SILENCERS AVAILABLE ARE SERIES AN, EBKX SEE ALSO AVAILABLE SECTION



FOR FURTHER TECHNICAL  
DETAILS ON THIS  
PRODUCT REQUEST  
CATALOGUE REFERENCE  
E134-A

# EXHAUST CLEANER SERIES AMC

## SERIES AMC EXHAUST CLEANER

### TECHNICAL SPECIFICATIONS

Max operating temperature	60°C
Noise reduction	35dB or more
Oil mist removal	99.9% or more
Exhaust of oil mist	Drain cock
Option	Bracket*
*Bracket not available on AMC810 and 910	

- ✓ Ensures clean plant air and noise reduction of distributing noise contamination
- ✓ Over 35 dB noise reduction
- ✓ Over 99.9% oil mist removal
- ✓ Male or female inlet



### SYMBOLS



### DIMENSIONS SERIES AMC EXHAUST CLEANER FEMALE TYPE

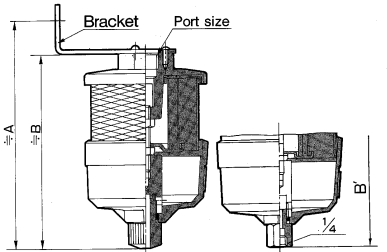
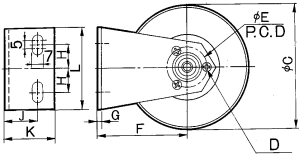

Threaded Drain Port(Female)

### DIMENSIONS SERIES AMC EXHAUST CLEANER MALE TYPE

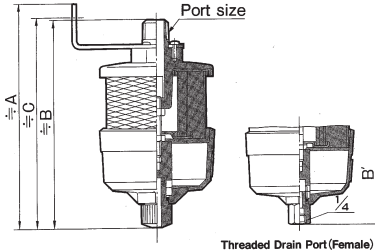
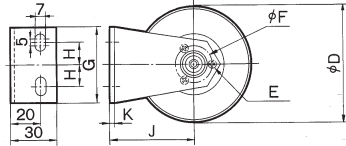

Threaded Drain Port(Female)

### ACCESSORIES

#### SERIES AMC EXHAUST CLEANER

Element .....See "How To Order"  
Bracket .....See "How To Order"

**STOCKED PRODUCTS**  
FOR A LIST OF STOCKED PRODUCTS,  
PLEASE SEE THE CURRENT SMC PRICE LIST

Model	Port size	A	B	øD	Bracket							
					D	øE	F	G	H	J	K	L
AMC220	1/4"	100	88	56	M3x0.5 Depth-8	22	40	2.3	15	12	20	50
AMC320	1/4•1/8"	140.5	120.5	75	M3x0.5 Depth-8	24	55	2.3	15	20	30	50
AMC520	1/4•1/8"	193.5	173.5	102	M4x0.7 Depth-8	40	70	3.2	20	20	30	70

\*A 1/4 fitting can be mounted when removed drain cock on AMC220

Model	Port size	A	B	C	øD	Bracket					
						E	øF	G	H	J	K
AMC310	3/8"	150.5	138.5	140.5	75	M3x0.6 Depth-8	24	50	15	55	2.3
AMC510	3/8"	203.5	196.5	193.5	102	M4x0.7 Depth-8	40	70	20	70	3.2
AMC610	1	229.5	224.5	219.5	118	M4x0.7 Depth-10	48	70	20	80	3.2
AMC810	1 1/2	-	270	-	135	-	-	-	-	-	-
AMC910	2	-	327	-	153	-	-	-	-	-	-

### HOW TO ORDER AMC SERIES

Model	Male					Female		
	AMC310	AMC510	AMC610	AMC810	AMC910	AMC220	AMC320	AMC520
Port size	3/8"	1/4"	1	1 1/2	2	1/4"	1/4•3/8"	1/2•3/4"
Max air flow (Nl/min)	300	1,000	3,000	6,000	10,000	200	300	1,000
Effective orifice mm <sup>2</sup> (Cv)	16 (0.88)	55 (3.1)	165 (9.2)	330 (18.3)	550 (31)	12 (0.66)	16 (0.88)	55 (3.1)
Element model no.	635321	635521	635619	635812P	635917P	635322	635321	635521
Bracket model no.	BE30	BE50	BE60	-	-	BE20	BE30	BE50

**STOCKED PRODUCTS**  
FOR A LIST OF STOCKED PRODUCTS,  
PLEASE SEE THE CURRENT SMC PRICE LIST

### HOW TO ORDER SERIES AMC

AMC ○ ○ ○ - ○ ○ ○

#### BODY SIZE

- 2 .....1/4
- 3 .....3/8
- 4 .....1/2
- 5 .....3/4
- 6 .....1
- 8 .....1 1/2
- 9 .....2

#### INLET THREAD

- 1 .....Male
- 2 .....Female

#### SUFFIX

- Nil ...Standard drain cock
- D .....Female thread drain port

#### PORT SIZE

- 02 ...1/4
- 03 ...3/8
- 04 ...1/2
- 06 ...3/4
- 10 ...1
- 14 ...1 1/2
- 20 ...2



SEE INSIDE FRONT COVER FOR  
DETAILS OF YOUR LOCAL SALES OFFICE



FOR FURTHER TECHNICAL  
DETAILS ON THIS  
PRODUCT REQUEST  
CATALOGUE REFERENCE  
E5G

## X-ON Electronics

Largest Supplier of Electrical and Electronic Components

*Click to view similar products for [smc manufacturer](#):*

Other Similar products are found below :

[G46-10-02-LN](#) [AC20A-F01-A](#) [AC20A-F02C-A](#) [AKM2000-F02-A](#) [AL40-F06-A](#) [AR30-F03H-A](#) [EAV4000-F04-5YO-Q](#) [KQ2E23-00NJ](#)  
[KQ2H04-M5A](#) [KQ2L02-M3G](#) [KQ2Z06-02AS](#) [KQ2ZT10-02AS](#) [AFD20-F02C-A](#) [SY5220-5DO-01F-Q](#) [SY7220-5DO-02F-Q](#) [SY9320-5YO-](#)  
[C10F-Q](#) [T0425BU-20](#) [T0425Y-20](#) [T1075W-100](#) [T1075W-20](#) [T1075Y-20](#) [T1209R-20](#) [TIA01W-20](#) [TU0212BU-20](#) [TU0212R-20](#) [TU0604B-](#)  
[100](#) [TU0604C-100](#) [TU0604G-20](#) [TU0604YR-100](#) [TU0604YR-20](#) [TU0805G-20](#) [TU0805YR-20](#) [TU1065C-100](#) [TU1610C-20](#) [KQ2D06-02AS](#)  
[KQ2LU06-02AS](#) [KQ2N06-M5A](#) [KQ2P-12](#) [KQ2W06-M5A](#) [EAV2000-F02-4YO-Q](#) [SY5420-5YO-C8F-Q](#) [T0425R-20](#) [T0604B-20](#) [T0806W-](#)  
[20](#) [PF2W720-N04-67](#) [AF20-FO2C](#) [TU0805W-20](#) [TU0805R-100](#) [TU0805C-100](#) [TU0604Y-100](#)