

# 承 认 书

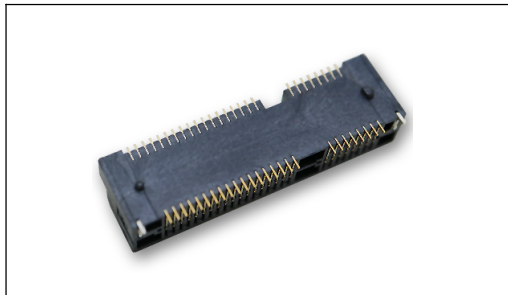

## 特点:

- MINI-PCI EXPRESS CONNECTORS, 适用于芯片、PCI 總線內部鏈接应用机器。
- 90° SMD 装の外接。

## 用途:

- 应用于移动、视听、汽车电子、多媒体、电器等各类相关产品。

## 東莞市碩方電子科技有限公司

[DONGGUAN SOFNG ELECTRONIC TECHNOLOGY Co., LTD]

## 樣品承認專項 [Sample Approval Drawing]

客戶名稱[Customer]	客戶料號[Customer P/N]
部品型號[Parts Model] PCIE-52P -52H 式	技術參數[Parameters] 環境に優しい材料

承認單位 [ 3 Research Institute ]:

工程部 [R&D]	品保部 [Q C]	采购部 [Purchase]

客戶判定 [Customer Determine]:

工程部 [R&D]	品保部 [Q C]	采购部 [Purchase]
[章 承]	[章 承]	[章 承]

说明 [Remnrk] 媒体排出方式: 双响键式。

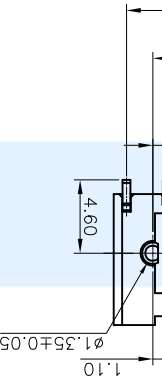

OPTIONAL



52 PLC

PIN 2

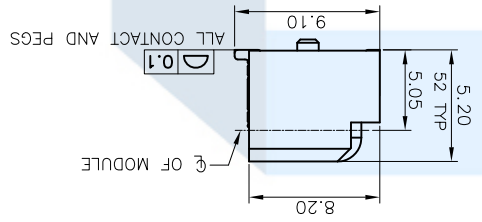
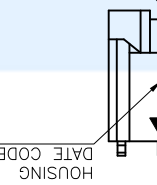

NO.	PART NAME	DESCRIPTION
3	HOLDDOWN	Brass C2680, Tin Plated
2	CONTACT	Phosphor Bronze C5210, Contact Area: Gold Flash Over Nickel
1	HOUSING	LCP UL94V-0, Black

SPECIFICATION:

1. ELECTRICAL
  - 1.1 Current Rating: 0.5A per pin
  - 1.2 Voltage Rating: 50V DC
  - 1.3 Contact Resistance: 5mΩ Max
  - 1.4 Insulation Resistance: 50MΩ Min
  - 1.5 Dielectric Withstanding Voltage: 300VAC
2. MECHANICAL
  - 2.1 Durability: 100 Cycle
  - 2.2 Insertion Force: 2.3kgf max.
  - 2.3 Extraction Force: 2.3kgf max.
3. ENVIRONMENTAL
  - 3.1 Operating temperature range: -40°C ~ +85°C
  - 3.2 Storage temperature range: -40°C ~ +85°C
  - 4.1 Recommended IR Reflow Temperature: 260°C 10Sec
4. SOLDER ABILITY

UNLESS OTHERWISE SPECIFIED TOLERANCE

UNIT: DECIMAL LINEAR ANGLES

mm	
X	±0.50
XX	±0.25
XXX	±0.12

DRAWN: Fros

CHECKED: Ron

APPROVED: Albert

SCALE: 3.2

SHEET: 1/3

SIZE: A4

Mini PCI Express Socket H: X.Xmm

PCIE-52P52H

DRAWN NAME: www.sofng.com

SOFTNG 碩方電子科技股份有限公司  
開關, 連接器

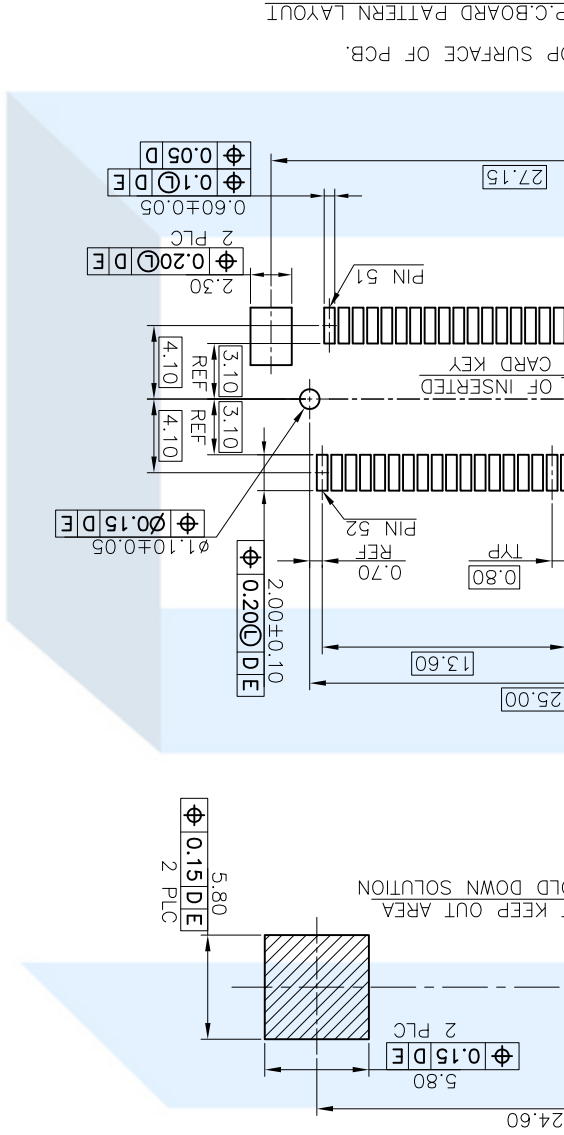

UNLESS OTHERWISE SPECIFIED TOLERANCE		mm	
UNIT:	DECIMAL	LINEAR	ANGLES
X.	±0.50	±3°	
X.X	±0.25	±1°	
X.XX	±0.12		
DRAWN: Fros			
CHECKED: Ron			
APPROVED: Albert			
SCALE	3.2	SHEET	2/3
SIZE	A4	PRODUCT NO. PCI-E-52P52H	

GENERAL TOLERANCE: ±0.05

DRAWN NAME: Fros		DRAWN NAME: www.sofng.com	
CHECKED: Ron		Mini PCI Express Socket H: X.Xmm	
APPROVED: Albert		PRODUCT NO. PCI-E-52P52H	
SCALE	3.2	SHEET	2/3
SIZE	A4	DRAWN NAME: www.sofng.com	

**SOFNG** 碩方電子科技股份有限公司  
 開關, 連接器  
 www.sofng.com

NO.	DESCRIPTION	DRAWN	DATE
	SEE SHEET 1		

UNLESS OTHERWISE SPECIFIED TOLERANCE		mm		X.XX ±0.12 ±1°		DRAWN		Fros		2014/12/12	
DECIMAL		LINEAR		ANGLES		X.X ±0.25 ±3°		CHECKED		Ron	
X.XX ±0.50 ±5°						APPROVED		Albert		2014/12/12	
		SCALE		SHEET		SIZE		PRODUCT NO.		PCIE-52P52H	
		1:25		3/3		A4					

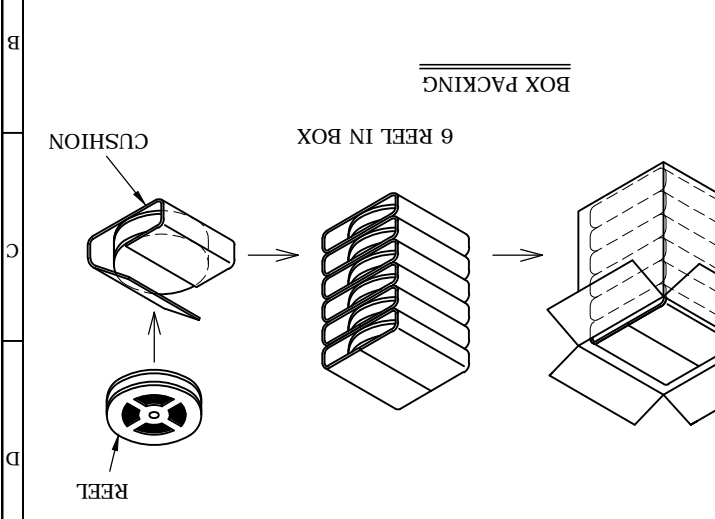

PACKING TABLE		P/N	Q'TY/ REEL	Q'TY/ CARTON
PCIE-52P80H	400 PCS			
PCIE-52P52H	550 PCS			3,300 PCS
PCIE-52P40H	700 PCS			4,200 PCS

- NOTE:
1. PEELING RESISTANCE: 0.1N~0.13N (10gf~130gf)  
PEELING ANGLE: 165°~180°  
PEELING SPEED: 300mm/min.
  2. PACKING STYLE  
6 REEL/CARTON

NO.	DESCRIPTION	DRAWN	DATE
	SEE SHEET 1		

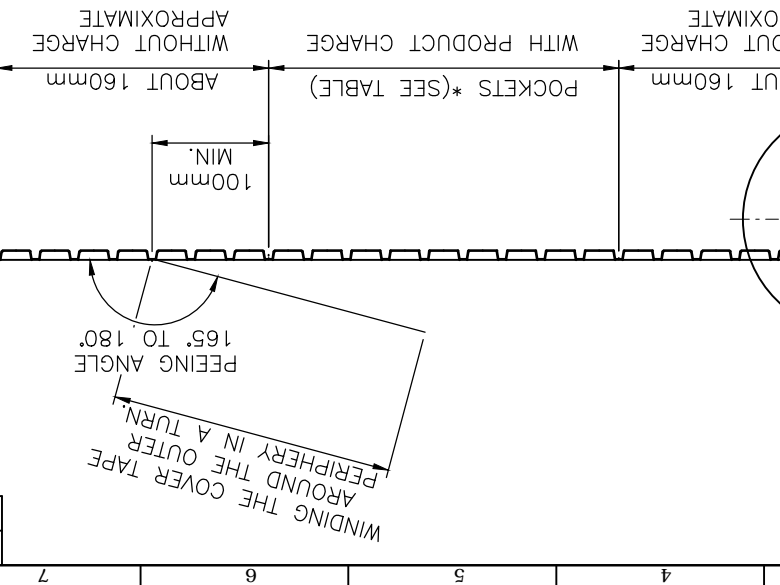

## X-ON Electronics

Largest Supplier of Electrical and Electronic Components

*Click to view similar products for [Standard Card Edge Connectors](#) category:*

*Click to view products by [SOFNG](#) manufacturer:*

Other Similar products are found below :

[6565204-6](#) [PKC-156](#) [1437274-4](#) [147889-1](#) [1489165-4](#) [EBT156-12B1X](#) [EBT15622B2X](#) [EBT156-22R2W](#) [1-582587-1](#) [1-582589-1](#) [2-6437275-9](#) [284-0102-12100](#) [306022901000000](#) [307-012-502-202](#) [307-024-526-201](#) [307-056-520-300](#) [307-080-526-208](#) [1926088-2](#) [245-062-520-350](#) [287-0032-12101](#) [306-010-500-112](#) [306-028-525-102](#) [306-240-318](#) [307-036-502-202](#) [307-036-521-301](#) [307-072-526-202](#) [345-060-559-303](#) [368-004-520-201](#) [392-008-559-201](#) [534671-1](#) [5-530501-5](#) [341-240-317](#) [345-029-520-300](#) [345-030-500-301](#) [345-044-500-300](#) [345-220-058](#) [346-240-318](#) [357-030-526-201](#) [387-012-523-300](#) [395-044-520-300](#) [395-100-524-300](#) [50-12B-10](#) [50-6SN-5](#) [09-07-2032](#) [10035388-106LF](#) [10035388-802LF](#) [10115859-011LF](#) [10122859-009LF](#) [101269333204245CLF](#) [10127905-B04B24BLF](#)