

SONOFF

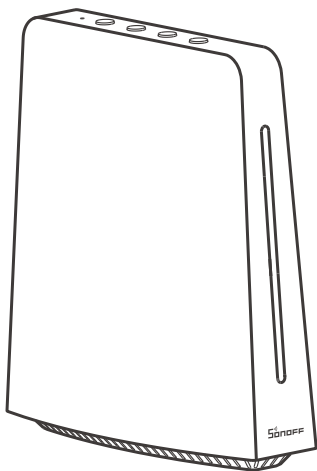

iHost

User manual V1.0



Smart Home Hub

中文-----1-6

English-----7-12

Warning-----13-14

产品介绍

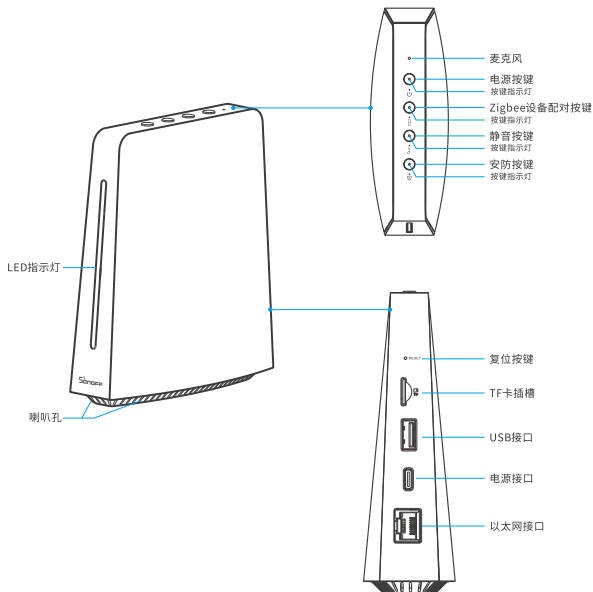

LED指示灯状态及说明

LED指示灯状态	说明
红色跑马灯	启动中状态
红色常亮	启动完成, 未连接网络
蓝色常亮	连接网络成功
黄色呼吸	子设备配对状态
红色快闪	关机中状态
蓝色双闪(循环两次)	进入密码重置状态
黄色快闪	升级中

按键操作说明

按键	操作说明
电源按键	1.短按开机, 按键指示灯亮。 2.长按3秒关机, 按键指示灯灭。
Zigbee设备配对按键	短按-进入Zigbee设备配对状态, 按键指示灯亮且LED指示灯呈黄色呼吸状态。 注: 配对状态下, 短按该按键即退出配对状态, 按键指示灯灭。
安防按键	1.短按按键进入布防状态, 按键指示灯亮起。再次短按按键可撤防, 按键指示灯灭。 2.布防或撤防状态下, 扬声器响起和按键指示灯闪烁时, 短按按键进行消音和取消指示灯闪烁。 注: 可在iHost中控台设置布防及撤防
复位按键	1.双击按键即进入密码重置状态(在中控台登录页面选择"忘记密码"进行重新设置) 2.长按10s恢复出厂设置

功能特点

iHost是一款由中控台通过局域网控制zigbee子设备, 无需接入云端即实现设备的接入、控制、场景联动, 可开启智能安防模式, 或根据不同场景设置报警, 查看对应设备或场景相关日志的本地智能网关。



智能安防



本地智能场景



开放API接口



Zigbee 3.0 网关



局域网控制



数据本地存储



支持多端控制



兼容多种设备类型

使用说明

1. 开机

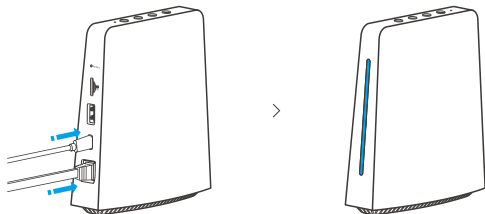

插入Type-C供电线及网线, 听到 iHost 发出提示音且指示灯呈蓝色常亮状态, 表示 iHost 启动及连接网络成功。

2. 登录iHost中控台

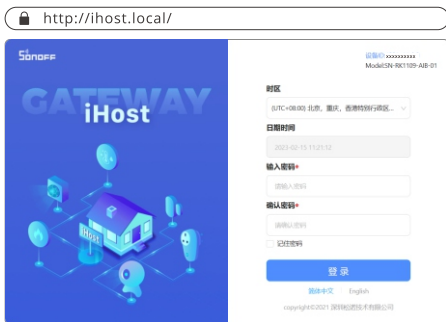

在电脑端输入网址 `http://ihost.local/`, 首次登录需要设置密码。

- ⊗ iHost和电脑端连接的网络必须为同一局域网。
- ⊗ 如网址 `http://ihost.local/` 无法访问, 请通过访问路由器后台查询到iHost的IP地址后, 打开浏览器输入对应的IP地址即可。

3. 添加设备

3-1. 添加zigbee子设备

方法1: 通过中控台添加Zigbee子设备



1. 在中控台点击添加Zigbee子设备, 此时iHost LED指示灯呈黄色呼吸状态。
2. 设置Zigbee子设备进入配置状态(参照子设备说明书)。
3. 添加完成后, 网关发出语音提示。

方法2: 通过本地按键快速添加Zigbee子设备

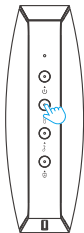

1. 短按iHost“Zigbee子设备配对按键”, 此时iHost LED指示灯呈黄色呼吸状态。
2. 设置Zigbee子设备进入配置状态(参照子设备说明书)。
3. 添加完成后, 网关发出语音提示。

⚠ 超时 (180s) 则退出网关指示灯效果。

⚠ 建议添加zigbee子设备数量上限为128个(实验室实测数据)。

3-2 添加摄像头



支持的摄像机: ONVIF摄像机/ RTSP摄像机/ ESP32-CAM。

⚠ 暂时只支持在多台设备上查看同一摄像头。

产品参数

型号	AlBridge, AlBridge-26
输入	5V---2A
电源接口类型	Type-C
网络接口类型	RJ45
无线连接	Wi-Fi IEEE 802.11 b/g/n 2.4GHz , Zigbee 3.0
储存方式	TF卡 (TF卡最大支持256GB)
工作温度	-10°C~40°C
工作湿度	5%~95% RH , 无冷凝
外壳材料	ABS
产品规格	120x135.5x41mm



<https://sonoff.tech/ihost-user-guides>

请扫描二维码或输入URL以查看设备的用户指南。

Product introduction

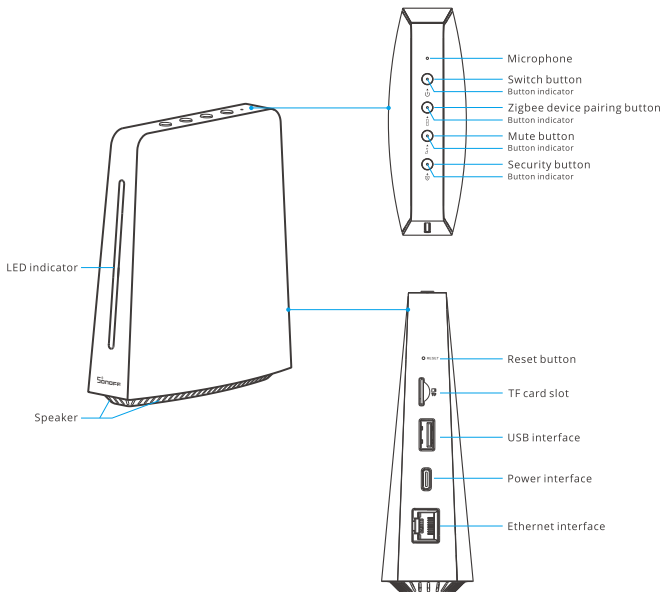

Instruction of LED indicator status

LED indicator status	Instruction
Flashes red	Powering on
Solid red	Powered on, no network connection
Solid blue	Network connection successfully
Breathing yellow	Sub-device
Flashes red quickly	Powering off
Double flashes blue (Twice)	Entered password reset status
Flashed yellow quickly	Upgrading

Instruction of buttons operation

Button	Instruction
Switch button	<ol style="list-style-type: none"> 1. Press to power on and the LED indicator is on. 2. Press and hold the button for 3s, LED indicator is off.
Zigbee device pairing button	<p>Press to enter the device pairing status, the button indicator is on and the LED indicator is breathing yellow.</p> <p>*In pairing status, press again to exit the pairing status and the button indicator will be off.</p>
Security button	<ol style="list-style-type: none"> 1. Press to enter the arm status and the button indicator is on. Press again to disarm and the button indicator is off. 2. When the speaker is sounding and the button indicator is flashing during the arming or disarming status, press the button to silence and stop the LED indicator flashes. <p>*Set the Arm and Disarm can be set in the centre admin console.</p>
Reset button	<ol style="list-style-type: none"> 1. Double press the reset button to reset the password (select "Forgot Password" in iHost centre admin console to reset the password). 2. Press for 10s to reset.

Features

iHost is a local smart home hub that controls the devices in the centre admin console through the LAN, enabling device adding, control and smart scene setting without connecting to the cloud, allowing to set smart security or set alarms for various smart scenes, and checking the Logs of devices or smart scenes.



Smart Security



Local Smart Scene



Open API Interface



Zigbee 3.0 Hub



LAN Control



Data Local Storage



Support Multiple Terminal Control



Compatible with Multiple Devices Type

Instruction

1. Power on

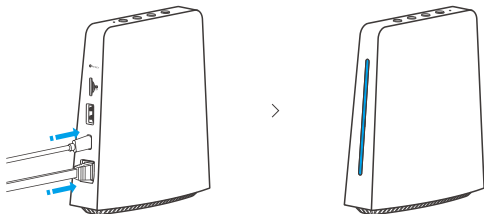

Plug in the Type-C charger cable and network cable, you will hear the beep and see the solid blue LED indicator when the iHost is powered on and connected to the network successfully.

2. Log in to iHost centre admin console

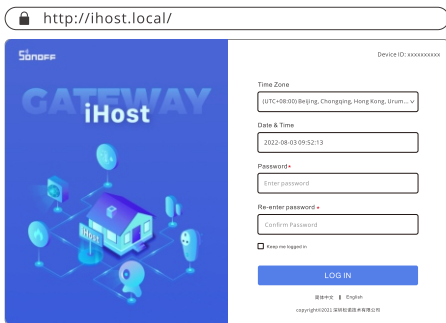

Enter the URL <http://ihost.local/> on the PC end, and set the password when you first log in.

- ⚠ iHost and the PC end are required to use the same LAN.
- ⚠ If the URL <http://ihost.local/> cannot be accessed, please check the iHost IP address by visiting the backend of the router and then accessing the corresponding IP address on your browser.

3. Add Device

3-1.Add Zigbee Device

Method 1: Add Zigbee sub-devices through iHost centre admin console

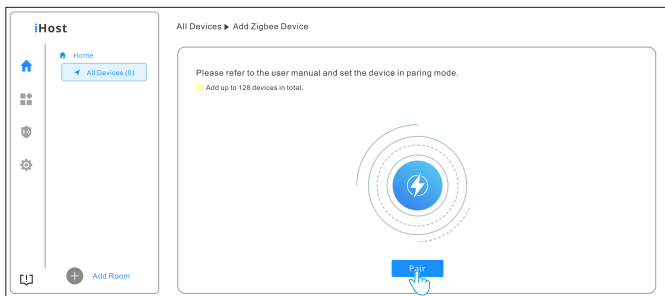

1. Add Zigbee sub-devices on iHost centre admin console, the LED indicator flashes yellow slowly.
2. Set Zigbee devices in pairing status (refer to the corresponding user manuals).
3. iHost will make the voice prompt when adding completely.

Method 2: Add Zigbee devices quickly through the local button

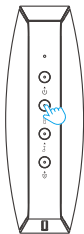

1. Press "Zigbee device pairing button" on the device, then the LED indicator flashes breathing yellow.
2. Set Zigbee devices in pairing mode (refer to the corresponding user manuals).
3. iHost will make the voice prompt when adding completely.

- ⚠ If the device cannot be added within 180s, it will exit the pairing status.
- ⚠ Proposed max limit of 128 Zigbee sub-devices (Laboratory data).

3-2 Add cameras

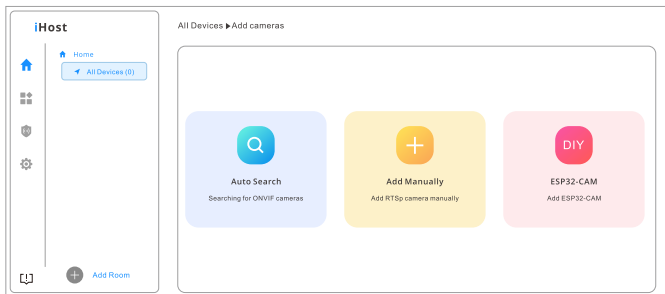

Supported cameras: ONVIF camera/RTSP camera/ESP32-CAM

⚠ Support viewing the same camera on multiple devices at the same time temporarily.

Specifications

Model	AlBridge, AlBridge-26
Input	5V---2A
Power interface	Type-C
Antenne interface	RJ45
Wireless connection	Wi-Fi IEEE 802.11 b/g/n 2.4GHz, Zigbee 3.0
Storage method	TF card (TF card supports up to 256GB)
Working temperature	-10°C~40°C
Working humidity	5%~95% RH, non-condensing
Casing material	ABS
Product dimension	120x135.5x41mm



<https://sonoff.tech/ihost-user-guides>

Please scan the QR code or enter the URL to view the user guides of the device.

FCC compliance statement

1.This device complies with part 15 of the FCC Rules. Operation is subject to the following two conditions:

(1) This device may not cause harmful interference, and

(2) This device must accept any interference received, including interference that may cause undesired operation.

2.Changes or modifications not expressly approved by the party responsible for compliance could void the user's authority to operate the equipment.

Note: This equipment has been tested and found to comply with the limits for a Class B digital device, pursuant to part 15 of the FCC Rules. These limits are designed to provide reasonable protection against harmful interference in a residential installation. This equipment generates, uses and can radiate radio frequency energy and, if not installed and used in accordance with the instructions, may cause harmful interference to radio communications. However, there is no guarantee that interference will not occur in a particular installation. If this equipment does cause harmful interference to radio or television reception, which can be determined by turning the equipment off and on, the user is encouraged to try to correct the interference by one or more of the following measures:

—Reorient or relocate the receiving antenna.

—Increase the separation between the equipment and receiver.

—Connect the equipment into an outlet on a circuit different from that to which the receiver is connected.

—Consult the dealer or an experienced radio/TV technician for help.

FCC Radiation Exposure statement:

This equipment complies with FCC radiation exposure limits set forth for an uncontrolled environment.

This equipment should be installed and operated with minimum distance of 20 cm between the radiator and your body.

This transmitter must not be co-located or operating in conjunction with any other antenna or transmitter.

ISED Notice

This device contains licence-exempt transmitter(s)/receiver(s) that comply with Innovation, Science and Economic Development Canada's licence-exempt RSS(s). Operation is subject to the following two conditions:

- (1) This device may not cause interference.
- (2) This device must accept any interference, including interference that may cause undesired operation of the device.

This Class B digital apparatus complies with Canadian ICES-003(B).

This device complies with RSS-247 of Industry Canada. Operation is subject to the condition that this device does not cause harmful interference.

L'émetteur/récepteur exempt de licence contenu dans le présent appareil est conforme aux CNR d'Innovation, Sciences et Développement économique Canada applicables aux appareils radio exempts de licence. L'exploitation est autorisée aux deux conditions suivantes :

- (1) L'appareil ne doit pas produire de brouillage;
- (2) L'appareil doit accepter tout brouillage radioélectrique subi, même si le brouillage est susceptible d'en compromettre le fonctionnement.

Cet appareil numérique de la Classe B conforme à la norme NMB-003(B) du Canada. Cet appareil est conforme à la norme RSS - 247 d'Industrie Canada. Le fonctionnement est soumis à la condition que cet appareil ne provoque pas d'interférences nuisibles.

ISED Radiation Exposure Statement

This equipment complies with ISED radiation exposure limits set forth for an uncontrolled environment.

This equipment should be installed and operated with minimum distance of 20 cm between the radiator and your body.

This transmitter must not be co-located or operating in conjunction with any other antenna or transmitter.

Cet équipement est conforme aux limites d'exposition aux rayonnements de la ISED établies pour un environnement non contrôlé.

Cet équipement doit être installé et fonctionner à au moins 20cm de distance d'un radiateur ou de votre corps.

Cet émetteur ne doit pas être co-localisé ou fonctionner en conjonction avec une autre antenne ou un autre émetteur.



WEEE Disposal and Recycling Information

All products bearing this symbol are waste electrical and electronic equipment (WEEE as in directive 2012/19/EU) which should not be mixed with unsorted household waste. Instead, you should protect human health and the environment by handing over your waste equipment to a designated collection point for the recycling of waste electrical and electronic equipment, appointed by the government or local authorities. Correct disposal and recycling will help prevent potential negative consequences to the environment and human health. Please contact the installer or local authorities for more information about the location as well as terms and conditions of such collection points.

EU Declaration of Conformity

Hereby, Shenzhen Sonoff Technologies Co., Ltd. declares that the radio equipment type AiBridge/AiBridge-26 is in compliance with Directive 2014/53/EU. The full text of the EU declaration of conformity is available at the following internet address:

<https://sonoff.tech/usermanuals>

For CE Frequency

Operation frequency Range:

2405-2480MHz(Zigbee)

2402-2480MHz(BLE)

Wi-Fi Operation Frequency:

802.11 b/g/n20 2412-2472 MHz

802.11 n40: 2422-2462 MHz

RF Output Power:

9.72dBm(Zigbee)

6.74dBm(BLE)

18.01dBm(802.11b), 15.93dBm(802.11g), 14.96dBm(802.11n20), 15.44dBm(802.11n40)(Wi-Fi)

SAR Warning

Under normal use of condition, this equipment should be kept a separation distance of at least 20 cm between the antenna and the body of the user.

Dans des conditions normales d'utilisation, cet équipement doit être maintenu à une distance d'au moins 20 cm entre l'antenne et le corps de l'utilisateur.

Scatola	Scatola	Manuale	Borsa
PAP 20	PAP 21	PAP 22	CPE7
Carta	Carta	Carta	Plastica
RACCOLTA DIFFERENZIATA			
Verifica le disposizioni del tuo Comune. Separa le componenti e conferiscile in modo corretto.			

SONOFF

Shenzhen Sonoff Technologies Co., Ltd.

3F & 6F, Bldg A, No. 663, Bulong Rd, Shenzhen, Guangdong, China

ZIP code: 518000

Website: sonoff.tech

Service email: support@itead.cc

MADE IN CHINA



Points de collecte sur www.quefairedemesdechets.fr
Privilégiez la réparation ou le don de votre appareil !

X-ON Electronics

Largest Supplier of Electrical and Electronic Components

Click to view similar products for [Specialist Controllers](#) category:

Click to view products by [Sonoff](#) manufacturer:

Other Similar products are found below :

[CV500SLK21](#) [H2CRSAC110B](#) [R88ARR080100S](#) [E53E01](#) [E53E8C](#) [E5GNQ03PFLKACDC24](#) [B300LKL21](#) [NSCXDC1V3](#)
[NT20SST122BV1](#) [C40PEDRA](#) [K31S5](#) [K31S6](#) [K3TX-AD31A](#) [L595020](#) [26546803](#) [26546805](#) [H7HP-C8D](#) [PWRA440A](#) [CPM1AETL03CH](#)
[3G2A5BI081](#) [3G2A5IA122](#) [3G2A5OD211](#) [3G2A5RM001EV1](#) [3G2A5RT002EV1](#) [3G2A6-ID217](#) [3G2A6LK202EV1](#) [3G2A9AL004E](#)
[C200HETL01E](#) [C200PCPD024](#) [3G2A5AD001](#) [3G2A5BI051](#) [3G2A5IA121](#) [3G2A5ID112](#) [3G2A5ID213](#) [3G2A5ID219](#) [3G2A5MR431](#)
[3G2A5OC221](#) [3G2A5PS222E](#) [3G2A6IM213](#) [3G2A6-OD412](#) [3G2A9AL001](#) [3G2C7LK202EV1](#) [3G5A2OC221E](#) [LDP2TA2B115](#)
[3G3DV130B4294](#) [E53E04](#) [E53Q4Q4](#) [E54E8CT](#) [C200HWCOM06EV1](#) [NT30KBA04](#)