





|                     |             |                       |   |            |     |
|---------------------|-------------|-----------------------|---|------------|-----|
| 文件编号<br>File Number | SRD-WI-3659 | 版本号<br>Version Number | A | 页码<br>page | 1/4 |
|---------------------|-------------|-----------------------|---|------------|-----|

### 1、外形尺寸 Dimension :

单位Unit: mm

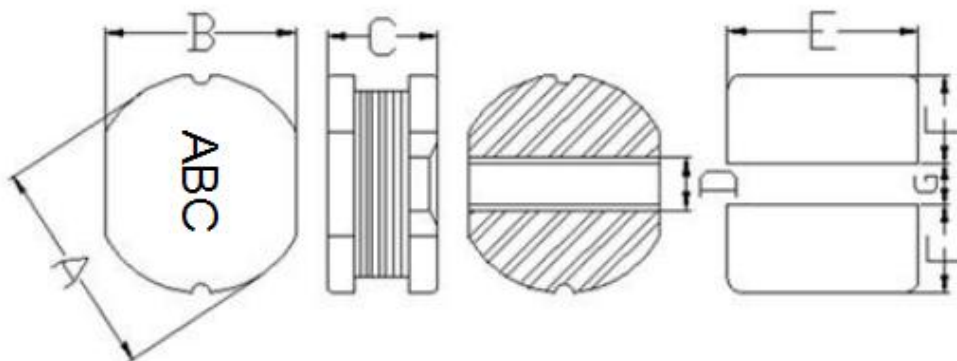

|   |         |
|---|---------|
| A | 7.8±0.3 |
| B | 7.0±0.3 |
| C | 5.0±0.3 |
| D | 2.4Ref. |
| E | 7.5Ref. |
| F | 3.0Ref. |
| G | 2.4Ref. |

### 2、产品品名构成 Product Spec. Model

SR 75 Y F - 2R2 M

a b c d e f

a: 系列名称 Series name

b: 产品尺寸 Product dimensions (A x B x C)

c: 密封方式 Sealing way (L: 冷封 Cold seal Y: 热封 Heat seal)

d: 印字方向 Lettering direction ▶

e: 电感值 Inductance Value

(1R0:1.0uH; 100: 10uH; 101:100uH)

f: 电感公差 Inductance Tolerance (K:10% ; M:20% ; N:30%)

#### ▶ Lettering direction



### 3、结构 Structure



### 4、材料清单 MATERIAL LIST

| NO. | PARTS  | MATERIAL   | UL FILE NO. | TEMP. CLASS |
|-----|--------|--|-------------|-------------|
| 1   | CORE   | Ni-Zn CORE OR EQUIVALENT                         | NA          | NA          |
| 2   | WIRE   | POLYURETHANE ENAMELLED COPPER WIRE OR EQUIVALENT | E258243     | 180°C       |
| 3   | SOLDER | Sn99.3-Cu0.7 OR EQUIVALENT                       | NA          | NA          |

\*NA:NOT APPLICABLE.

|                     |             |                       |   |            |     |
|---------------------|-------------|-----------------------|---|------------|-----|
| 文件编号<br>File Number | SRD-WI-3659 | 版本号<br>Version Number | A | 页码<br>page | 2/4 |
|---------------------|-------------|-----------------------|---|------------|-----|

## 5、电性能参数表 Electrical Characteristics List

| 规格型号<br>Part NO.    | 电感量<br>Tolerance( $\mu$ H) | 测试频率<br>Test Freq. (kHz/v) | 直流电阻<br>DCR<br>Max ( $\Omega$ ) | 饱和电流<br>Isat (A) |
|---------------------|----------------------------|----------------------------|---------------------------------|------------------|
| SCD.7850.DYF1R0MT00 | 1.0                        | 100 / 0.25                 | 0.013                           | 5.20             |
| SCD.7850.DYF1R5MT00 | 1.5                        | 100 / 0.25                 | 0.014                           | 5.00             |
| SCD.7850.DYF2R2MT00 | 2.2                        | 100 / 0.25                 | 0.015                           | 4.80             |
| SCD.7850.DYF2R7MT00 | 2.7                        | 100 / 0.25                 | 0.017                           | 4.60             |
| SCD.7850.DYF3R3MT00 | 3.3                        | 100 / 0.25                 | 0.020                           | 4.00             |
| SCD.7850.DYF3R9MT00 | 3.9                        | 100 / 0.25                 | 0.023                           | 4.00             |
| SCD.7850.DYF4R7MT00 | 4.7                        | 100 / 0.25                 | 0.026                           | 3.80             |
| SCD.7850.DYF5R6MT00 | 5.6                        | 100 / 0.25                 | 0.027                           | 3.10             |
| SCD.7850.DYF6R8MT00 | 6.8                        | 100 / 0.25                 | 0.033                           | 2.80             |
| SCD.7850.DYF8R2MT00 | 8.2                        | 100 / 0.25                 | 0.039                           | 2.52             |
| SCD.7850.DYF100KT00 | 10                         | 1.0 / 0.25                 | 0.042                           | 2.31             |
| SCD.7850.DYF120KT00 | 12                         | 1.0 / 0.25                 | 0.049                           | 2.00             |
| SCD.7850.DYF150KT00 | 15                         | 1.0 / 0.25                 | 0.072                           | 1.81             |
| SCD.7850.DYF180KT00 | 18                         | 1.0 / 0.25                 | 0.085                           | 1.59             |
| SCD.7850.DYF220KT00 | 22                         | 1.0 / 0.25                 | 0.091                           | 1.50             |
| SCD.7850.DYF270KT00 | 27                         | 1.0 / 0.25                 | 0.107                           | 1.28             |
| SCD.7850.DYF300KT00 | 30                         | 1.0 / 0.25                 | 0.115                           | 1.24             |
| SCD.7850.DYF330KT00 | 33                         | 1.0 / 0.25                 | 0.120                           | 1.20             |
| SCD.7850.DYF390KT00 | 39                         | 1.0 / 0.25                 | 0.150                           | 1.08             |
| SCD.7850.DYF470KT00 | 47                         | 1.0 / 0.25                 | 0.176                           | 1.05             |
| SCD.7850.DYF560KT00 | 56                         | 1.0 / 0.25                 | 0.208                           | 0.93             |
| SCD.7850.DYF680KT00 | 68                         | 1.0 / 0.25                 | 0.238                           | 0.83             |
| SCD.7850.DYF820KT00 | 82                         | 1.0 / 0.25                 | 0.273                           | 0.78             |
| SCD.7850.DYF101KT00 | 100                        | 1.0 / 0.25                 | 0.325                           | 0.73             |
| SCD.7850.DYF121KT00 | 120                        | 1.0 / 0.25                 | 0.390                           | 0.65             |
| SCD.7850.DYF151KT00 | 150                        | 1.0 / 0.25                 | 0.520                           | 0.58             |
| SCD.7850.DYF181KT00 | 180                        | 1.0 / 0.25                 | 0.598                           | 0.51             |
| SCD.7850.DYF221KT00 | 220                        | 1.0 / 0.25                 | 0.793                           | 0.48             |
| SCD.7850.DYF271KT00 | 270                        | 1.0 / 0.25                 | 0.884                           | 0.40             |

※公差Tolerance: N:±30%、M:±20%、K:±10%.

※工作温度Operating temperature rang: -40 °C to +125°C (Including Self-heating)

※储存温度Storage temperature rang: -40 °C to +125°C

Isat电流: 指使电感量比初始值下降10% ( The rated DC current is that which cause at 10% inductance reduction from the initial value ) 。



## 6、产品包装 Packaging

### 1) 载带包装示意图 Tape packing diagram

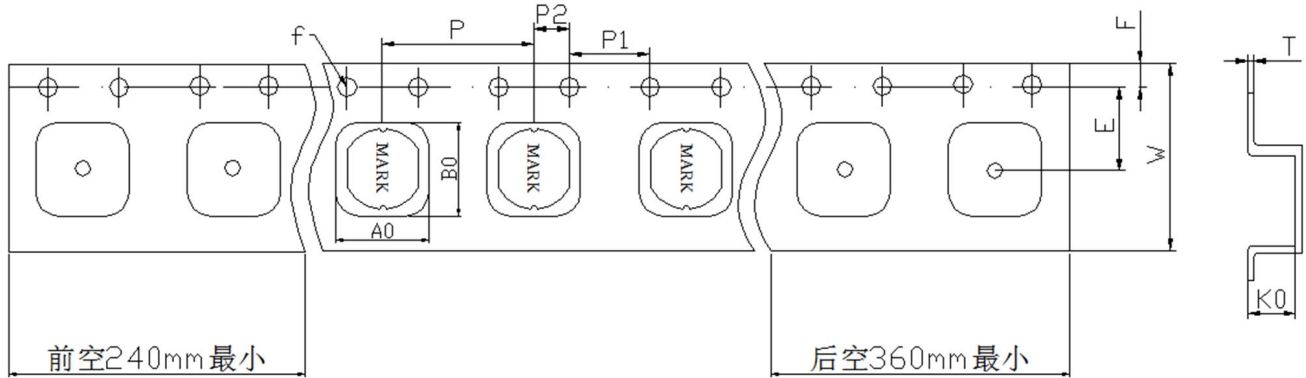

| ITEM | W     | A0   | B0   | K0   | P     | E    | F    | D0   | P0   | P2   | T     |
|------|-------|------|------|------|-------|------|------|------|------|------|-------|
| DIM  | 16.00 | 8.20 | 7.50 | 5.40 | 12.00 | 7.50 | 1.75 | 1.50 | 4.00 | 2.00 | 0.40  |
| TOLE | ±0.3  | ±0.1 | ±0.1 | ±0.1 | ±0.1  | ±0.1 | ±0.1 | +0.1 | ±0.1 | ±0.1 | ±0.05 |

### 2) 卷盘包装示意图 Tape packing diagram

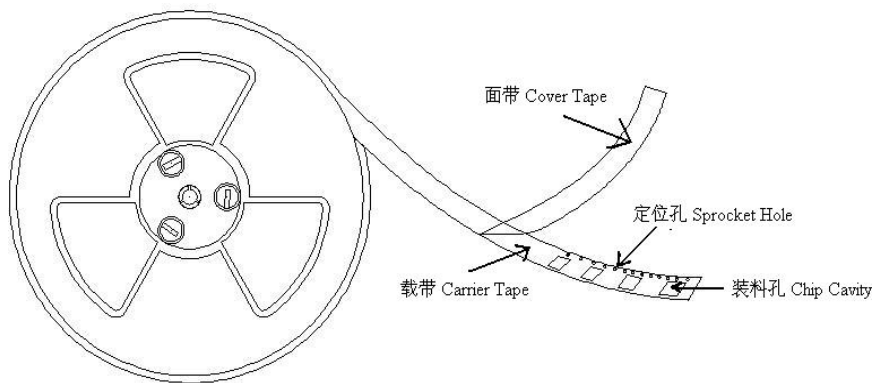

### 3) 剥离强度要求 Peeling required

- ① F 力大小: 20~100g;
- ② 面带剥离角度: 165°~180°。

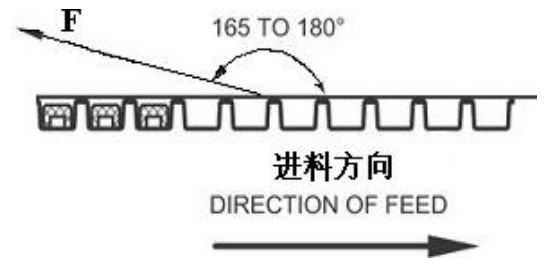

### 4) 包装数量 Packing quantity

| 项目 | 数量 (PCS) | 尺寸规格 (mm)         |
|----|----------|-------------------|
| 盘  | 1000     | 13"               |
| 内盒 | 3000     | 340mm*340mm*65mm  |
| 外箱 | 6000     | 360mm*360mm*160mm |

## X-ON Electronics

Largest Supplier of Electrical and Electronic Components

*Click to view similar products for [Fixed Inductors](#) category:*

*Click to view products by [SOREDE](#) manufacturer:*

Other Similar products are found below :

[CR32NP-151KC](#) [CR32NP-180KC](#) [CR32NP-181KC](#) [CR32NP-1R5MC](#) [CR32NP-390KC](#) [CR32NP-3R9MC](#) [CR32NP-680KC](#) [CR32NP-820KC](#) [CR32NP-8R2MC](#) [CR43NP-390KC](#) [CR43NP-560KC](#) [CR43NP-680KC](#) [CR54NP-181KC](#) [CR54NP-470LC](#) [CR54NP-820KC](#) [CR54NP-8R5MC](#) [70F224AI](#) [MGDQ4-00004-P](#) [MHL1ECTTP18NJ](#) [MHQ1005P10NJ](#) [MHQ1005P1N0S](#) [MHQ1005P2N4S](#) [MHQ1005P3N6S](#) [MHQ1005P5N1S](#) [MHQ1005P8N2J](#) [PE-51506NL](#) [PE-53601NL](#) [PE-53602NL](#) [PE-53630NL](#) [PE-53824SNLT](#) [PE-92100NL](#) [PG0434.801NLT](#) [PG0936.113NLT](#) [9220-20](#) [9310-16](#) [PM06-2N7](#) [PM06-39NJ](#) [A01TK](#) [1206CS-471XJ](#) [HC2LP-R47-R](#) [HC2-R47-R](#) [HC3-2R2-R](#) [HCF1305-3R3-R](#) [1206CS-151XG](#) [RCH664NP-140L](#) [RCH664NP-4R7M](#) [RCH8011NP-221L](#) [RCP1317NP-332L](#) [RCP1317NP-391L](#) [RCR1010NP-470M](#)